



**RESIDENTIAL SUBDIVISION BUILDING PERMIT APPLICATION**

Project Address: 11 White Lily Court Assessor Parcel # 274-0570-048  
Lot Number: 608 Subdivision Natomas West Village 1

**OWNER INFORMATION:**

Legal Property Owner: KB Home Phone# 707-469-2464  
Owner Address: 611 Orange dr City Vacaville State CA Zip 95687

**CONTRACTOR INFORMATION:**

Contractor: KB Home Lic. # 761970 Phone # 707-469-2464 Fax 469-2405

**PROJECT INFORMATION:**

Land Use Zone RIA Occupancy Group R3 Construction Type VN Fed Code 1A  
No. of Stories: 1 No. of Rooms: \_\_\_\_\_ Street Width: \_\_\_\_\_  
1<sup>st</sup> Floor Area 1270 2<sup>nd</sup> Floor Area \_\_\_\_\_ Basement \_\_\_\_\_ Roof Material \_\_\_\_\_

AREA IN SQUARE FOOT OF:

Dwelling/Living	<u>1270</u>
Garage/Storage	<u>226</u>
Docks/Balconies	<u>154</u>
Carports	_____

SCOPE OF WORK: New Single Family Dwelling

FOR OFFICE USE ONLY

<input type="checkbox"/> Information Above Complete	<input type="checkbox"/> AR Flood Waiver Required	<input type="checkbox"/> Planning Approval
<input type="checkbox"/> Violation Files Checked	<input type="checkbox"/> Flood Elevation Certificate Required	<input type="checkbox"/> Design Review Approval
<input type="checkbox"/> Standard Setbacks	<input type="checkbox"/> Water Development Infill Area	<input type="checkbox"/> Special Fee Districts Apply:
<input type="checkbox"/> County Sewer		_____

— THE FOLLOWING MUST BE PROVIDED IN ORDER TO SUBMIT FOR PERMIT —

2 COMPLETE PLOT PLANS, LEGIBLE & DRAWN TO SCALE  
 11 X 17 COPY OF FLOOR PLAN WITH FOLLOWING INFORMATION

a) Assessor's Parcel Number	c) Owners Name
b) New Floor Area	d) Project Address

# CERTIFICATION OF INSULATION

PART I GENERAL  
PART II AREAS INSULATED  
PART III CERTIFICATION

ADDRESS OR TRACT <div style="font-size: 2em; font-family: cursive;">K &amp; B</div> <div style="margin-left: 200px;">LOT # 68</div>	SACRAMENTO INSULATION CONTRACTORS <input checked="" type="checkbox"/> P.O. BOX 854, WEST SACRAMENTO, CA 95691 LIC. #202026 <input type="checkbox"/> 1309 MELODY ROAD, MARYSVILLE, CA 95901 LIC. #202026 <input type="checkbox"/> P.O. BOX 9651, FRESNO, CA 93793-9651 LIC. #202026 <input type="checkbox"/> P.O. BOX 1631, RENO, NV 89505 LIC. #10675 <input type="checkbox"/> 3326 A PONDEROSA WAY, LAS VEGAS, NV 89118 LIC. #10675 DATE INSULATION COMPLETED
CALIFORNIA GARDENS	

WALLS		CEILING			FLOORS		
SQUARE FEET		SQUARE FEET			SQUARE FEET		
TYPE OF INSULATION		TYPE OF INSULATION			TYPE OF INSULATION		
MATERIAL <b>FIBERGLASS</b>		MATERIAL <b>FIBERGLASS</b>			MATERIAL <b>FIBERGLASS</b>		
FORM <b>BATTS</b>		FORM <b>BATTS &amp; BLOW</b>			FORM <b>BATTS</b>		
MANUFACTURER'S PRODUCT I.D.		MANUFACTURER'S PRODUCT I.D.			MANUFACTURER'S PRODUCT I.D.		
MANUFACTURER		MANUFACTURER			MANUFACTURER		
<b>OCF</b>		<b>OCF</b>			<b>OCF</b>		
R-VALUE INSTALLED		APPLIED THICKNESS		MIN. INSTALLED WEIGHT PER SQUARE FOOT		R-VALUE INSTALLED	
13		3 5/8"		38			
				12 1/4"			
				14 3/4"			

KNEE WALLS IF R-VALUE IS OTHER THAN WALLS ABOVE

MATERIAL <b>FIBERGLASS</b>	FORM <b>BATTS</b>	R-VALUE	MANUFACTURER <b>OCF</b>
-------------------------------	----------------------	---------	----------------------------

AIR INFILTRATION SEALANT

MATERIAL <b>FOAM</b>	MANUFACTURER <b>W R GRACE</b>
-------------------------	----------------------------------

THIS IS TO CERTIFY THAT INSULATION AND/OR SEALANT HAS BEEN INSTALLED IN CONFORMANCE WITH APPLICABLE CODES, MATERIAL STANDARDS AND REGULATIONS.

SIGNATURE—INSULATION CONTRACTOR <i>Jeff Cobb</i>	TITLE MANAGER	DATE 2/11/02
SIGNATURE—GENERAL CONTRACTOR	TITLE	DATE

REMARKS

**The Spink Corporation**  
2590 VENTURE OAKS WAY  
SACRAMENTO, CA 95833  
PH (916)925-5550 FAX (916)921-9274

**NATOMAS WEST**  
**VILLAGE 2**  
**LOT 68**  
**PLAN HP**

**CALIFORNIA GARDENS**  
CITY OF SACRAMENTO, CA  
CLIENT: KAUFMAN & BROAD

DATE: 5-10-01  
A.P.N.: 274-0570-048  
ADDRESS: 11 WHITE LILY COURT

LOT AREA: 3,729 SF  
LOT COVERAGE: 37%

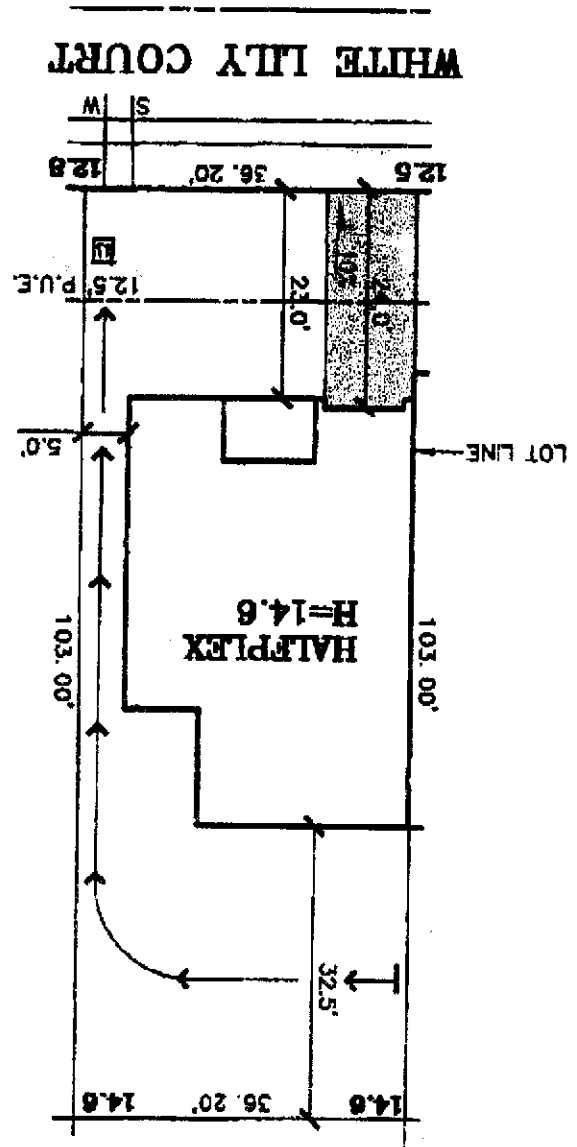

1. The lot area and coverage shown on this plan are based on the information provided by the applicant and the City of Sacramento. The City of Sacramento is not responsible for the accuracy of the information provided by the applicant.

2. The lot area and coverage shown on this plan are based on the information provided by the applicant and the City of Sacramento. The City of Sacramento is not responsible for the accuracy of the information provided by the applicant.

3. The lot area and coverage shown on this plan are based on the information provided by the applicant and the City of Sacramento. The City of Sacramento is not responsible for the accuracy of the information provided by the applicant.