

CITY OF SACRAMENTO
1231 I Street, Sacramento, CA 95814

Permit No: 0010276
Insp Area: 4

Site Address: 2059 BLACKRIDGE AV SAC
Parcel No: 225-1400-036 NORTHPT PK 8 LOT 36

Sub-Type: NSFR
Housing (Y/N): N

CONTRACTOR
MOURIER JOHN CONSTRUCTION INC.
1830 VERNON ST
SUITE 9 95687

OWNER

ARCHITECT

Nature of Work: NSFR MP2447 2 STORY 11 RMS

CONSTRUCTION LENDING AGENCY : I hereby affirm under penalty of perjury that there is a construction lending agency for the performance of the work for which this permit is issued (Sec. 3097, Civ. C).

Lender's Name _____ Lender's Address _____

LICENSED CONTRACTORS DECLARATION: I hereby affirm under penalty of perjury that I am licensed under provisions of Chapter 9 (commencing with section 7000) of Division 3 of the Business and Professions Code and my license is in full force and effect.

License Class F License Number 22224 Date 9/3/00 Contractor Signature R. Collins

OWNER-BUILDER DECLARATION: I hereby affirm under penalty of perjury that I am exempt from the contractors License Law for the following reason (Sec. 7031.5, Business and Professions Code: any city or county which requires a permit to construct, alter, improve, demolish, or repair any structure, prior to its issuance, also requires the applicant for such permit to file a signed statement that he or she is licensed pursuant to the provisions of the Contractors License Law (Chapter 9 (commencing with Section 7000) of Division 8 of the Business and Professions Code) or that he or she is exempt therefrom and the basis for the alleged exemption. Any violation of Section 7031.5 by any applicant for a permit subjects the applicant to a civil penalty of not more than five hundred dollars (\$500.00).

I, as a owner of the property, or my employees with wages as their sole compensation, will do the work, and the structure is not intended or offered for sale (Sec. 7044, Business and Professional Code: The Contractors License Law does not apply to an owner of property who builds or improves thereon, and who does such work himself or herself or through his/her own employees, provided that such improvements are not intended or offered for sale. If, however, the building or improvement is sold within one year of completion, the owner-builder will have the burden of proving that he/she did not build or improve for the purpose of sale.)

I, as owner of the property, am exclusively contracting with licensed contractors to construct the project (Sec. 7044, Business and Professions Code: The Contractors License Law does not apply to an owner of property who builds or improves thereon, and who contracts for such projects with a contractor(s) licensed pursuant to the Contractors License Law).

I am exempt under Sec _____ B & PC for this reason: _____

Date _____ Owner Signature _____

IN ISSUING THIS BUILDING PERMIT, the applicant represents, and the city relies on the representation of the applicant, that the applicant verified all measurements and locations shown on the application or accompanying drawings and that the improvement to be constructed does not violate any law or private agreement relating to permissible or prohibited locations for such improvements. This building permit does not authorize any illegal location of any improvement or the violation of any private agreement relating to location of improvements.

I certify that I have read this application and state that all information is correct. I agree to comply with all city and county ordinances and state laws relating to building construction and hereby authorize representative(s) of this city to enter upon the above-mentioned property for inspection purposes.

Date 9/3/00 Applicant/Agent Signature R. Collins

WORKER'S COMPENSATION DECLARATION: I hereby affirm under penalty of perjury one of the following declarations:

I have and will maintain a certificate of consent to self-insure for workers' compensation as provided for by Section 3700 of the Labor Code, for the performance of work for which the permit is issued.

I have and will maintain workers' compensation insurance, as required by Section 3700 of the Labor Code, for the performance of the work for which this permit is issued. My workers' compensation insurance carrier and policy number are:

Carrier FINANCIAL PACIFIC INS. CO. Policy Number 920137C

PAID
CITY OF SACRAMENTO
SEP 03 2000
Exp Date 10/1/2000
NEIGHBORHOODS, PLANNING
AND DEVELOPMENT SERVICES

(This section need not be completed if the permit is for \$100 or less) I certify that in the performance of this permit I shall not employ any person in any manner so as to become subject to the workers' compensation laws of California and agree that if I should become subject to the workers' compensation provisions of Section 3700 of the Labor Code, I shall forthwith comply with those provisions.

Date 9/3/00 Applicant Signature R. Collins

WARNING - FAILURE TO SECURE WORKER'S COMPENSATION COVERAGE IS UNLAWFUL AND SHALL SUBJECT AN EMPLOYER TO CRIMINAL PENALTIES AND CIVIL FINES UP TO ONE HUNDRED THOUSAND DOLLARS (\$100,000) IN ADDITION TO THE COST OF COMPENSATION, DAMAGES AS PROVIDED FOR IN SECTION 3706 OF THE LABOR CODE, INTEREST AND ATTORNEY'S FEE.

THIS PERMIT SHALL EXPIRE BY LIMITATION IF WORK IS NOT COMMENCED WITHIN 180 DAYS.

RESIDENTIAL SUBDIVISION BUILDING PERMIT APPLICATION

Project Address: 2059 Blackridge Av Assessor Parcel # _____
Lot Number: 36 Subdivision _____

OWNER INFORMATION:

Legal Property Owner: _____ Phone# _____
Owner Address: _____ City _____ State _____ Zip _____

CONTRACTOR INFORMATION:

Contractor: _____ Lic. # _____ Phone # _____ Fax _____

PROJECT INFORMATION:

Land Use Zone R1A Occupancy Group R3 Construction Type VN Fed Code 1A
No. of Stories: 2 No. of Rooms: _____ Street Width: _____
1st Floor Area _____ 2nd Floor Area _____ Basement _____ Roof Material _____
AREA IN SQUARE FOOT OF:
Dwelling/Living 2447
Garage/Storage 565
Decks/Balconies 127
Carports _____
SCOPE OF WORK: _____

FOR OFFICE USE ONLY

- Information Above Complete AR Flood Waiver Required Planning Approval
- Violation Files Checked Flood Elevation Certificate Required Design Review Approval
- Standard Setbacks Water Development Infill Area Special Fee Districts Apply:
- County Sewer _____

THE FOLLOWING MUST BE PROVIDED IN ORDER TO SUBMIT FOR PERMIT

- 2 COMPLETE PLOT PLANS, LEGIBLE & DRAWN TO SCALE
- 11 X 17 COPY OF FLOOR PLAN WITH FOLLOWING INFORMATION
 - a) Assessor's Parcel Number c) Owners Name
 - b) New Floor Area d) Project Address

Date: _____ Received by: (staff) _____ Permit # _____

OMEGA PRODUCTS CORP.

DIAMOND WALL INSULATING STUCCO SYSTEM

ADDRESS:

ICBO Report #4004

S.M. Court Yard
2059 BLACK RIDGE

Date of Job Completion 3/9/01

PLASTERING CONTRACTOR:

Name: STUCCO WORKS INC.

Address: 5900 WAREHOUSE WAY, SACRAMENTO, CALIFORNIA 95826

Telephone No: (916) 383-6699

Contractor Number of Diamond Wall System 2175

This is to certify that the exterior coating system on the building exterior at the above address has been installed in accordance with the evaluation report specified above and the manufacturer's instructions.

3/20/01
Date

[Signature]
Signature of authorized representative of
Plastering Contractor

This installation card must be presented to the building inspector after completion of work and before final inspection.



INSULATION CONTRACTORS ASSOCIATION OF AMERICA

INSULATION CERTIFICATE

62077

1321 DUKE STREET, SUITE 303 • ALEXANDRIA, VA 22314 • (703) 739-0356

THIS IS TO CERTIFY THAT INSULATION HAS BEEN INSTALLED IN CONFORMANCE WITH CURRENT ENERGY REGULATIONS, CALIFORNIA ADMINISTRATIVE CODE, TITLE 24, STATE OF CALIFORNIA, IN THE BUILDING LOCATED AT:

STREET J.M.C. Natoma's LOT # 36 TRACT # Park
2059 Black Ridge CITY Sac

EXTERIOR WALLS

MANUFACTURER

E H

THICKNESS TYPE

R- 13/14
VALUE

CEILING

BATTS

C H

THICKNESS TYPE

R- 30
VALUE

BLOWN IN

Fasul III

MINIMUM THICKNESS 12

R- 50
VALUE

SQUARE FOOTAGE COVERED 733 NUMBER OF BAGS USED 13

FLOORS

MANUFACTURER

THICKNESS TYPE

R- VALUE

SLAB ON GRADE

MANUFACTURER

THICKNESS/TYPE

R- VALUE

WIDTH OF INSULATION _____ INCHES

FOUNDATION WALLS:

MANUFACTURER

THICKNESS/TYPE

R- VALUE

GENERAL CONTRACTOR _____
CALIFORNIA CONTRACTORS LICENSE # _____

DATE _____

SIGNATURE

TITLE

INSULATION CONTRACTOR **ARCADE INSULATION**

CALIFORNIA CONTRACTORS LICENSE #263784

R. Beaulieu

SIGNATURE

Mr

TITLE

DATE 3-22-1

Pacific Consulting Engineers

2150 Bell Ave., Suite 145 • Sacramento, CA 95838 • (916) 564-6028 • Fax: (916) 564-6029

November 22, 1999

Sam Haymart
John Mourier Construction Inc
1830 Vernon St., Suite 9
Roseville, CA 95678

RE: Electrical panels in shear walls. This Letter is our Job#99-1364.

Dear Mr. Haymart:

Please be advised that following detail may be used on any houses for which I have prepared the engineering:

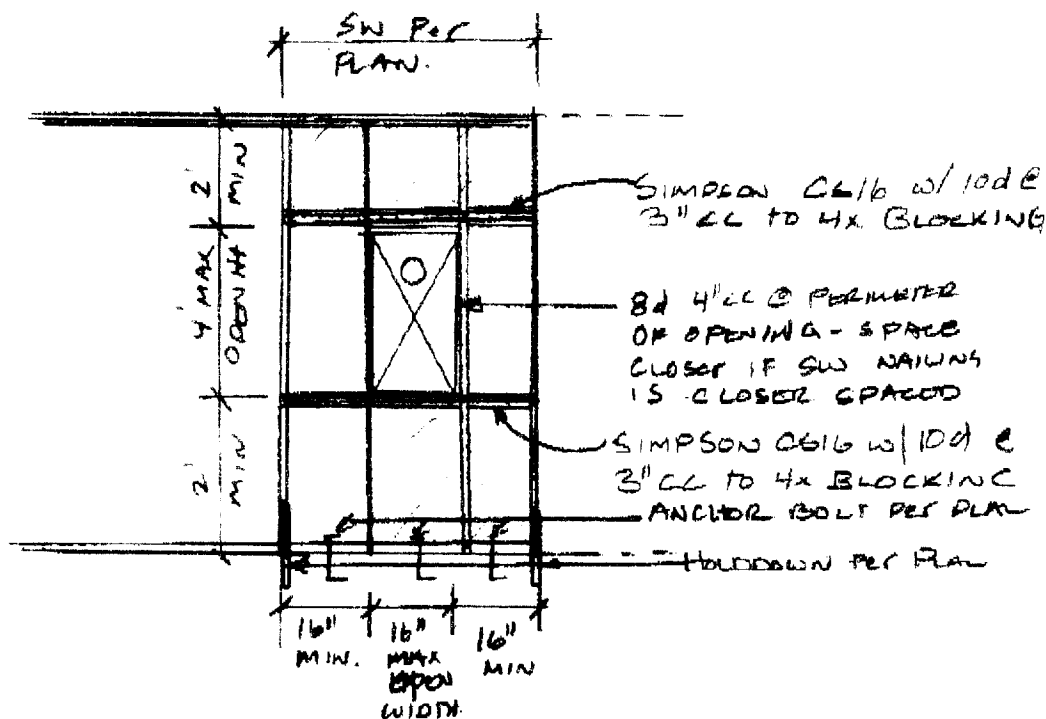

If there are any questions or further clarification needed on these matters please feel free to contact me at (916) 564-6028

Sincerely,

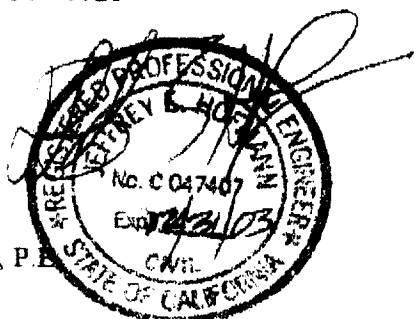

Jeffrey E. Hofmann, P.E.

NORTHPOINTE 8-1

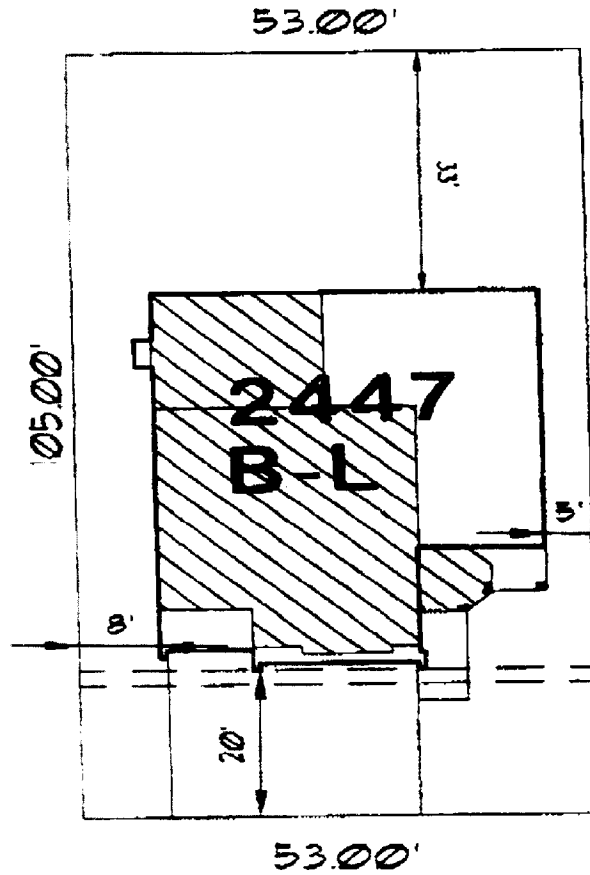

LOT: 36 SITE ADDRESS: 2059 BLACKRIDGE AVE.

WHEN USED FOR SALES OR CONTRACT PURPOSES THIS DOCUMENT DOES NOT GUARANTEE ANY DIMENSIONS, DISTANCES, BEARINGS OR SETBACKS. JMC RESERVES THE RIGHT TO MAKE CHANGES AT ANY TIME WITHOUT PRIOR NOTICE AND IS NOT RESPONSIBLE FOR IRREGULARITIES OR DIFFERENCES IN ACTUAL OR "AS-BUILT" LOT CHARACTERISTICS.

SCALE: 1"=20'
 LOT SIZE: 5565 +/-
 NP81-36 JM 082200

COVERAGE: 32%
 APN: 225-0140-036
 1930 VERNON ST. N.E.
 ROSEVILLE, GA 30070
 916-782-8970
 CA. Lic. 019004

