

CITY OF SACRAMENTO
1231 I Street, Sacramento, CA 95814

Permit No: 0102387
Insp Area: 4

Site Address: 5124 BISSETT WY SAC
Parcel No: 225-1510-057 NORTHPT PK 17 LOT 57

Sub-Type: NSFR
Housing (Y/N): N

CONTRACTOR
JOHN LAING HOMES
1536 EUREKA RD STE 100
ROSEVILLE CA. 95661

OWNER

ARCHITECT

Nature of Work: NSFR MP 2225/OPT 10 RMS 2 STORY

CONSTRUCTION LENDING AGENCY: I hereby affirm under penalty of perjury that there is a construction lending agency for the performance of the work for which this permit is issued (Sec. 3097, Civ. C.)

Lender's Name _____ Lender's Address _____

LICENSED CONTRACTORS DECLARATION: I hereby affirm under penalty of perjury that I am licensed under provisions of Chapter 9 commencing with section 7000) of Division 3 of the Business and Professions Code and my license is in full force and effect.

License Class B License Number 48274 Date 3/2/01 Contractor Signature N. Collins

OWNER-BUILDER DECLARATION: I hereby affirm under penalty of perjury that I am exempt from the contractors License Law for the following reason (Sec. 7031.5, Business and Professions Code, any city or county which requires a permit to construct, alter, improve, demolish, or repair any structure, prior to its issuance, also requires the applicant for such permit to file a signed statement that he or she is licensed pursuant to the provisions of the Contractors License Law (Chapter 9 (commencing with Section 7000) of Division 8 of the Business and Professions Code) or that he or she is exempt therefrom and the basis for the alleged exemption. Any violation of Section 7031.5 by any applicant for a permit subjects the applicant to a civil penalty of not more than five hundred dollars (\$500.00).

I, as a owner of the property, or my employees with wages as their sole compensation, will do the work, and the structure is not intended or offered for sale (Sec. 7044, Business and Professional Code. The Contractors License Law does not apply to an owner of property who builds or improves thereon, and who does such work himself or herself or through his/her own employees, provided that such improvements are not intended or offered for sale. If, however, the building or improvement is sold within one year of completion, the owner-builder will have the burden of proving that he/she did not build or improve for the purpose of sale.)

I, as owner of the property, am exclusively contracting with licensed contractors to construct the project (Sec. 7044, Business and Professions Code. The Contractors License Law does not apply to an owner of property who builds or improves thereon, and who contracts for such projects with a contractor(s) licensed pursuant to the Contractors License Law).

I am exempt under Sec. _____ B & PC for this reason: _____

Date _____ Owner Signature _____

IN ISSUING THIS BUILDING PERMIT, the applicant represents, and the city relies on the representation of the applicant, that the applicant verified all measurements and locations shown on the application or accompanying drawings and that the improvement to be constructed does not violate any law or private agreement relating to permissible or prohibited locations for such improvements. This building permit does not authorize any illegal location of any improvement or the violation of any private agreement relating to location of improvements.

I certify that I have read this application and state that all information is correct. I agree to comply with all city and county ordinances and state laws relating to building construction and hereby authorize representative(s) of this city to enter upon the abovementioned property for inspection purposes.

Date 3/2/01 Applicant Agent Signature N. Collins

WORKER'S COMPENSATION DECLARATION: I hereby affirm under penalty of perjury one of the following declarations:

I have and will maintain a certificate of consent to self-insure for workers' compensation as provided for by Section 3700 of the Labor Code, for the performance of work for which the permit is issued.

I have and will maintain workers' compensation insurance, as required by Section 3700 of the Labor Code, for the performance of the work for which this permit is issued. My workers' compensation insurance carrier and policy number are:

Carrier EAGLE PACIFIC INSURANCE COMPANY Policy Number 1S0002200 Exp Date 04/15/2001

(This section need not be completed if the permit is for \$100 or less. I shall not employ any person in any manner so as to become subject to the workers' compensation laws of California and agree that if I should become subject to the workers' compensation provisions of Section 3700 of the Labor Code, I shall forthwith comply with those provisions.

Date 3/2/01 Applicant Signature N. Collins

WARNING - FAILURE TO SECURE WORKER'S COMPENSATION COVERAGE IS UNLAWFUL AND SHALL SUBJECT AN EMPLOYER TO CRIMINAL PENALTIES AND CIVIL FINES UP TO ONE HUNDRED THOUSAND DOLLARS (\$100,000) IN ADDITION TO THE COST OF COMPENSATION, DAMAGES AS PROVIDED FOR IN SECTION 3706 OF THE LABOR CODE, INTEREST AND ATTORNEY'S FEE.

THIS PERMIT SHALL EXPIRE BY LIMITATION IF WORK IS NOT COMMENCED WITHIN 180 DAYS.



**INSULATION CONTRACTORS
ASSOCIATION
OF AMERICA**

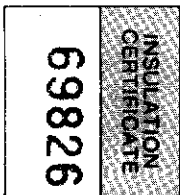

1321 DUKE STREET, SUITE 303 • ALEXANDRIA, VA 22314 • (703) 739-0356

THIS IS TO CERTIFY THAT INSULATION HAS BEEN INSTALLED IN CONFORMANCE WITH CURRENT ENERGY REGULATIONS, CALIFORNIA ADMINISTRATIVE CODE, TITLE 24, STATE OF CALIFORNIA, IN THE BUILDING LOCATED AT:

John & Amy White Lot # 57 TRACT # CA44150
STREET 5124 Pilsbry CITY San Antonio

EXTERIOR WALLS:

MANUFACTURER IM THICKNESS/TYPE 3 5/8 R- VALUE 13

CEILINGS:

BATTS: MANUFACTURER IM THICKNESS/TYPE 10 R- VALUE 30

BLOWN IN: MANUFACTURER CT MINIMUM THICKNESS 12 R- VALUE 20

SQUARE FOOTAGE COVERED 1424 NUMBER OF BAGS USED 26

FLOORS:

MANUFACTURER _____ THICKNESS/TYPE _____ R- VALUE _____

SLAB ON GRADE: MANUFACTURER _____ THICKNESS/TYPE _____ R- VALUE _____

MANUFACTURER _____ THICKNESS/TYPE _____ R- VALUE _____

WIDTH OF INSULATION _____ INCHES

FOUNDATION WALLS: MANUFACTURER _____ THICKNESS/TYPE _____ R- VALUE _____

MANUFACTURER _____ THICKNESS/TYPE _____ R- VALUE _____

GENERAL CONTRACTOR _____
CALIFORNIA CONTRACTORS LICENSE # _____ DATE _____

SIGNATURE _____ TITLE _____

INSULATION CONTRACTOR **ARCADE INSULATION** _____
CALIFORNIA CONTRACTORS LICENSE #263794 _____ DATE 9-18-01

SIGNATURE _____ TITLE _____

OMEGA PRODUCTS CORP.

DIAMOND WALL INSULATING STUCCO SYSTEM

Lot 57

JOB ADDRESS:

ICBO Report #4004

5124 BISSETT WY

SACRAMENTO CA 95835

Date of Job Completion 9-11-01

PLASTERING CONTRACTOR:

Name: STUCCO WORKS INC.

Address: 5900 WAREHOUSE WAY, SACRAMENTO, CALIFORNIA 95826

Telephone No: (916) 383-6699

Contractor Number of Diamond Wall System 2175

This is to certify that the exterior coating system on the building exterior at the above address has been installed in accordance with the evaluation report specified above and the manufacturer's instructions.

9-25-01

Date

Signature of authorized representative of
Plastering Contractor

This installation card must be presented to the building inspector after completion of work and before final inspection.

SIGNET

Testing Labs, Inc.

TE: 7-9-01
 OBJECT NO. _____
 OBJECT: Calypso
 LOCATION: _____

DSA FILE/APPL. NO. _____
 OSHPD NO. _____
 PERMIT NO. _____
 WEATHER: _____ TEMP: _____

PROOF LOAD **TORQUE** **WITNESSING**

Testing was performed on the following items. All tests were performed with the following calibrated equipment:

RAM: SV # 244 GAGE: SV # 1004 TORQUE WRENCH: _____
 RAM: _____ GAGE: _____ TORQUE WRENCH: _____

LOCATION OF TEST	TYPE / SIZE	# TESTED	% of TOTAL	LOAD lb or Ft Lbs	GAGE (PSI)	# ACC.	# REJ.	# RETEST
<u>HD10A - perimeter of Lot # 56</u>	<u>7/8</u>	<u>20</u>		<u>7660</u>	<u>2970</u>	<u>20</u>	<u>0</u>	<u>0</u>
<u>HD10A - Lot # 57</u>	<u>7/8</u>	<u>8</u>		<u>7660</u>	<u>2970</u>	<u>8</u>	<u>0</u>	<u>0</u>
<u>HD10A - Lot # 58</u>	<u>7/8</u>	<u>17</u>		<u>7660</u>	<u>2970</u>	<u>17</u>	<u>0</u>	<u>0</u>

- Type of epoxy / grout used: _____ Method of application / cleaning: _____
- Visual inspection was performed on _____
- Show up / Stand by time. Job Canceled / Delayed due to: _____
- All non-compliance items were brought to the attention of: _____ at the job site.

NON-COMPLIANCE REPORT ATTACHED ADDITIONAL TESTS ATTACHED

NOTES: _____

To the best of my knowledge, the above ~~WAS~~ **WAS NOT** performed in accordance with the approved plans, specifications, and regulatory requirements.

Superintendent/Representative: _____ Inspector: [Signature]

RESIDENTIAL BUILDING PERMIT APPLICATION

- New Construction
 Addition
 Remodels
 Other

Project Address: 5124 Bissett Way Assessor Parcel # 225-150-057

OWNER INFORMATION: Lot 57

Legal Property Owner: John Laing Homes Phone # 780-1222
 Owner Address: 1536 Eureka Rd. #100 City Boscville State Ca. Zip 95661

CONTRACTOR INFORMATION: Northpointe Park Unit #17

Contractor: John Laing Homes Lic. # 687596 Phone # 780-1222 Fax# 780-1333

PROJECT INFORMATION:

Land Use Zone _____ Occupancy Group _____ Construction Type VN Fed Code A1
 No. of stories: 2 No. of rooms: 10 Street width: _____
 1st Floor Area _____ 2nd Floor Area _____ Basement _____ Roof Material _____

AREA IN SQUARE FOOT OF:	EXISTING	NEW
Dwelling/Living	_____	<u>2389</u>
Garage/Storage	_____	<u>580</u>
Decks/Balconies	_____	<u>137</u>
Carports	_____	_____

SCOPE OF WORK: _____

FOR OFFICE USE ONLY:

- | | | |
|---|---|--|
| <input type="checkbox"/> Information above complete | <input type="checkbox"/> AR Flood Waiver required | <input type="checkbox"/> Planning Approval |
| <input type="checkbox"/> Violation files checked | <input type="checkbox"/> Flood Elevation Certificate Required | <input type="checkbox"/> Design Review Approval |
| <input type="checkbox"/> Standard setbacks | <input type="checkbox"/> Water Development Infill Area | <input type="checkbox"/> Special Fee Districts Apply : _____ |
| <input type="checkbox"/> County Sewer | | |

NEW STRUCTURES & ADDITIONS

❖ THE FOLLOWING MUST BE PROVIDED IN ORDER TO SUBMIT FOR PLAN REVIEW

- | | |
|---|---|
| <input type="checkbox"/> 2 COMPLETE PLANS, LEGIBLE & DRAWN TO SCALE
<input type="checkbox"/> 3 SETS IF PROJECT IS IN A DESIGN REVIEW AREA

<input type="checkbox"/> Title 24 Energy Compliance documentation
<input type="checkbox"/> Grading and Erosion Control Questionnaire | ❖ Plans to include: site plan, floor plan, elevations, roof/ceiling plan, foundation and structural framing details, and structural calculations for non-conforming structures.

<input type="checkbox"/> 11" x 17" copy of floor plan for County Assessor
<input type="checkbox"/> Plan Review Fees |
|---|---|

Date: _____

Received by: (staff) _____

ACTIVITY/PERMIT #

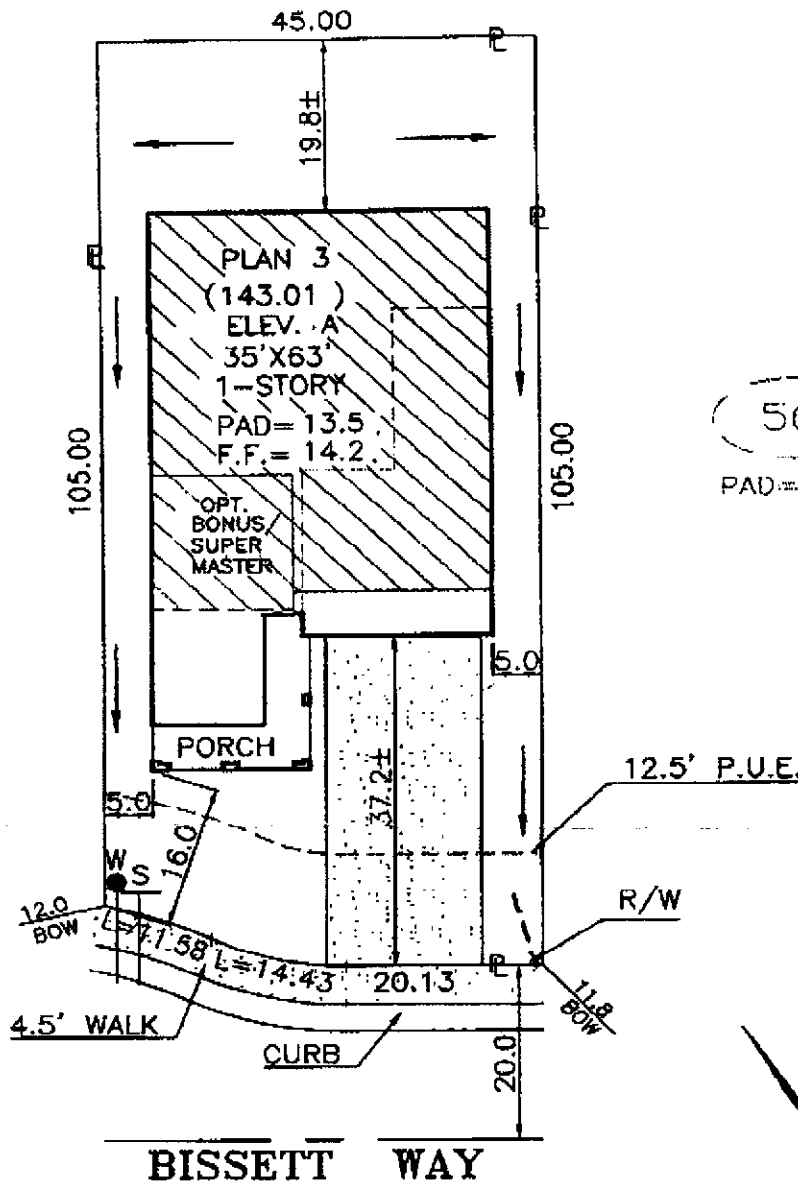

58
PAD=13.9

56
PAD=13.3

This set of plans and specifications must be kept on the job at all times and it is unlawful to make any changes or alterations from the same without written permission from the Building Inspection Division. The approval of this plan and specification SHALL NOT be held to permit or approve the violation of any City Ordinance or State Law.

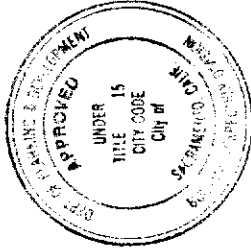

BISSETT WAY

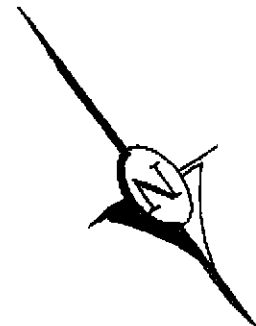

DIMENSIONS SHOWN ARE APPROXIMATE EXCEPT FOR MINIMUMS REQUIRED BY ORDINANCE. THIS PLOT DOES NOT REFLECT AS BUILT CONDITIONS AND MAY VARY FROM THIS PLAN.

John Laing Homes 1538 EUREKA ROAD SUITE 100 ROSEVILLE, CALIFORNIA 95661 (TEL.) 916-780-1222 (FAX.) 916-780-1333		CALYPSO		PLOT PLAN	
		NORTHPOINTE PARK VILLAGE NO. 17 CITY OF SACRAMENTO CALIFORNIA		NOTES: CURVED LINES ARE CHORD MEASUREMENTS.	
ADDRESS: 5124 BISSETT WAY		LOT COV: 32.0 %		APN: 225-151-57	
PLAN NO.: 3-A		LOT SQ. FT.: 4,652.23		REAR YARD COVERAGE: %	
DRAWN BY: R.P.		APPROVED BY:		DATE: 2/28/01 SCALE: 1"=20'	
LOT 57					