

CITY OF SACRAMENTO

1231 I Street, Sacramento, CA 95814

Permit No: 9903284

Insp Area: 4

Site Address: 28 HEATHMERE CT SAC

Parcel No: 274-0470-037

HERITAGE PLACE LOT 62

Sub-Type: NSFR

Housing (Y/N): N

CONTRACTOR

EPICK INC.
1263 THE ESPLANADE
CHICO, CA 95926

OWNER

ARCHITECT

Nature of Work: NEW HOME, MP1543, 7 ROOMS

CONSTRUCTION LENDING AGENCY: I hereby affirm under penalty of perjury that there is a construction lending agency for the performance of the work for which this permit is issued (Sec. 3097, Civ. C).

Lender's Name 1st Bank Lender's Address 1525 Douglas Blvd Roseville

LICENSED CONTRACTORS DECLARATION: I hereby affirm under penalty of perjury that I am licensed under provisions of Chapter 9 (commencing with section 7000) of Division 3 of the Business and Professions Code and my license is in full force and effect.

License Class B License Number 663708 Date 4/13/99 Contractor Signature [Signature]

OWNER-BUILDER DECLARATION: I hereby affirm under penalty of perjury that I am exempt from the contractors License Law for the following reason (Sec. 7031.5, Business and Professions Code; any city or county which requires a permit to construct, alter, improve, demolish, or repair any structure, prior to its issuance, also requires the applicant for such permit to file a signed statement that he or she is licensed pursuant to the provisions of the Contractors License Law (Chapter 9 (commencing with Section 7000) of Division 8 of the Business and Professions Code) or that he or she is exempt therefrom and the basis for the alleged exemption. Any violation of Section 7031.5 by any applicant for a permit subjects the applicant to a civil penalty of not more than five hundred dollars (\$500.00);

I, as a owner of the property, or my employees with wages as their sole compensation, will do the work, and the structure is not intended or offered for sale (Sec. 7044, Business and Professional Code: The Contractors License Law does not apply to an owner of property who builds or improves thereon, and who does such work himself or herself or through his/her own employees, provided that such improvements are not intended or offered for sale. If, however, the building or improvement is sold within one year of completion, the owner-builder will have the burden of proving that he/she did not build or improve for the purpose of sale.)

I, as owner of the property, am exclusively contracting with licensed contractors to construct the project (Sec. 7044, Business and Professions Code: The Contractors License Law does not apply to an owner of property who builds or improves thereon, and who contracts for such projects with a contractor(s) licensed pursuant to the Contractors License Law).

I am exempt under Sec. _____ B & PC for this reason: _____
Date 4/13/99 Owner Signature [Signature]

IN ISSUING THIS BUILDING PERMIT, the applicant represents, and the city relies on the representation of the applicant, that the applicant verified all measurements and locations shown on the application or accompanying drawings and that the improvement to be constructed does not violate any law or private agreement relating to permissible or prohibited locations for such improvements. This building permit does not authorize any illegal location of any improvement or the violation of any private agreement relating to location of improvements.

I certify that I have read this application and state that all information is correct. I agree to comply with all city and county ordinances and state laws relating to building construction and hereby authorize representative(s) of this city to enter upon the abovementioned property for inspection purposes.

Date 4/13/99 Applicant/Agent Signature [Signature]

WORKER'S COMPENSATION DECLARATION: I hereby affirm under penalty of perjury one of the following declarations:

I have and will maintain a certificate of consent to self-insure for workers' compensation as provided for by Section 3700 of the Labor Code, for the performance of work for which the permit is issued.

I have and will maintain workers' compensation insurance, as required by Section 3700 of the Labor Code, for the performance of the work for which this permit is issued. My workers' compensation insurance carrier and policy number are:

Carrier STATE FUND Policy Number 1442812-98 Exp Date 10/01/1999

(This section need not be completed if the permit is for \$100 or less) I certify that in the performance of the work for which this permit is issued, I shall not employ any person in any manner so as to become subject to the workers' compensation laws of California and agree that if I should become subject to the workers' compensation provisions of Section 3700 of the Labor Code, I shall forthwith comply with those provisions.

Date 4/13/99 Applicant Signature [Signature]

WARNING: FAILURE TO SECURE WORKER'S COMPENSATION COVERAGE IS UNLAWFUL AND SHALL SUBJECT AN EMPLOYER TO CRIMINAL PENALTIES AND CIVIL FINES UP TO ONE HUNDRED THOUSAND DOLLARS (\$100,000) IN ADDITION TO THE COST OF COMPENSATION, DAMAGES AS PROVIDED FOR IN SECTION 3706 OF THE LABOR CODE, INTEREST AND ATTORNEY'S FEE.

THIS PERMIT SHALL EXPIRE BY LIMITATION IF WORK IS NOT COMMENCED WITHIN 180 DAYS.

NATOMAS UNIFIED SCHOOL DISTRICT

1515 Sports Drive, #1 • Sacramento, CA 95834

Phone 916/641-3300 • Fax 916/928-1629

CERTIFICATION OF COMPLIANCE

SCHOOL DISTRICT DEVELOPMENT FEES

PART I: TO BE COMPLETED BY APPLICANT

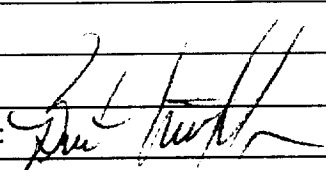
PROPERTY OWNER'S NAME	Epick Homes # 1 LLC		
OWNER'S ADDRESS	1263 The Esplanade Ste C Chico Ca. 95926		
PROJECT ADDRESS	28 Heathmere Ct / Lot 62		
PARCEL NUMBER	274 - 0470 - 037		
SUBDIVISION NAME	Heritage Place / Riverdale		
NUMBER OF UNITS	173		
PRINT APPLICANT'S NAME	Burt W. Zelberger	APPLICANT'S SIGNATURE:	
TITLE OF APPLICANT	Job Supt.		
DATE	4/6/99	TELEPHONE NUMBER	(530) 891-4757

PART II: TO BE COMPLETED BY BUILDING DEPARTMENT

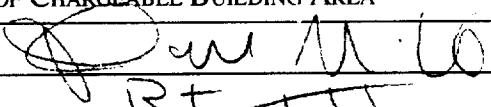
PLAN IDENTIFICATION NUMBER	M.P. 1543		
BUILDING TYPE (CHECK ONE)	<input checked="" type="checkbox"/> RESIDENTIAL <input type="checkbox"/> APARTMENT/CONDOMINIUM <input type="checkbox"/> COMMERCIAL/INDUSTRIAL		
SQUARE FEET OF CHARGEABLE BUILDING AREA	1543		
SIGNATURE			
TITLE	RE ITT	DATE	3-4-99

PART III: TO BE COMPLETED BY NATOMAS UNIFIED SCHOOL DISTRICT

DISTRICT CERTIFICATION NUMBER	327		
FEES COLLECTED			
RESIDENTIAL	1543	Sq. Ft. X \$ 1.93	= \$ 2977.99
APARTMENT/CONDOMINIUM		Sq. Ft. X \$	= \$
COMMERCIAL/INDUSTRIAL		Sq. Ft. X \$	= \$

This certification covers only the amount of square footage indicated above. Any additions or corrections to the square footage for this project will require an amendment to the Certificate of Compliance.

As the authorized school district official, I hereby certify that the requirements of Government Code Section 65995 have been complied with by the above signed applicant.

AUTHORIZED SCHOOL DISTRICT OFFICIAL:

SIGNATURE: 
TITLE: Facilities Planner DATE: 4-7-99

WHITE - SCHOOL DISTRICT

YELLOW - SCHOOL DISTRICT

PINK - BUILDING DEPARTMENT

GOLD - APPLICANT

COUNTY SANITATION DISTRICT NO. 1
SACRAMENTO REGIONAL COUNTY SANITATION DISTRICT
SEWER IMPACT FEE
PERMIT AND CALCULATION SHEET

APPLICATION NO: <u>CITY</u>		BLDG PERMIT NO:	
GENERAL INFORMATION <u>4-7-99</u>		THIS PERMIT GOOD ONLY WHEN VALIDATED BY THE CASHIER DEPT 25 \$2,855.00 RECEIVED 4/7/99	
FEE CALCULATION		BUILDING USE	
INSPECTION		RESIDENTIAL SF <input checked="" type="checkbox"/>	MF <input type="checkbox"/>
CSD-1	<u>470-</u>	COMMERCIAL USE	UNITS
SRCSD	<u>2385-</u>		
CONSTRUCTION			
IN-LIEU			
TOTAL FEE	<u>2855</u>		
APN: <u>274-0470-037</u>			
DESCRIPTION/SUBDIVISION <u>Heritage Place / Riverside</u> LOT: <u>62</u>			
PROPERTY ADDRESS <u>28 Heathmere Ct.</u>			
OWNER ABC <u>Spick Homes #1 LLC</u>			
MAILING ADDRESS <u>1263 The Esplanade Ste. C</u>			
CITY-STATE-ZIP <u>Chico, Ca. 95926</u> PHONE <u>(530) 941-4757</u>			
ADDITIONAL FEES MAY BE DUE IF CHANGES IN USE INCREASE SEWER IMPACT.			
APPLICANT SIGNATURE <u>[Signature]</u>			
CONSOLIDATED UTILITY BILLING USE ONLY			
ACCT _____ INPUT _____ START _____			
BILLING COPY			



INSULATION CONTRACTORS ASSOCIATION OF AMERICA

INSULATION CERTIFICATE
53422

1321 DUKE STREET, SUITE 303 • ALEXANDRIA, VA 22314 • (703) 739-0356

TO CERTIFY THAT INSULATION HAS BEEN INSTALLED IN CONFORMANCE WITH THE REQUIREMENTS OF CALIFORNIA ADMINISTRATIVE CODE, TITLE 24, STATE BUILDING STANDARDS, AND IS LOCATED AT:

Project Name Wick James LOT # 62 TRACT # _____
STREET 28 Heathmere Ct CITY Santa

EXTERIOR WALLS:

MANUFACTURER CH THICKNESS/TYPE 3/4" R-VALUE 13

CEILINGS:

BATTS: MANUFACTURER CH THICKNESS/TYPE 10" R-VALUE 30

BLOWN IN: MANUFACTURER CH MINIMUM THICKNESS 12" R-VALUE 30

SQUARE FOOTAGE COVERED 1227 NUMBER OF BAGS USED 22

FLOORS: MANUFACTURER _____ THICKNESS/TYPE _____ R-VALUE _____

SLAB ON GRADE: MANUFACTURER _____ THICKNESS/TYPE _____ R-VALUE _____

WIDTH OF INSULATION _____ INCHES

FOUNDATION WALLS: MANUFACTURER _____ THICKNESS/TYPE _____ R-VALUE _____

GENERAL CONTRACTOR _____

CALIFORNIA CONTRACTORS LICENSE # _____ DATE _____

SIGNATURE _____ TITLE _____

INSULATION CONTRACTOR **ARCADE INSULATION**
CALIFORNIA CONTRACTORS LICENSE #263784

10-1-99 DATE

[Signature] SIGNATURE Blow TITLE

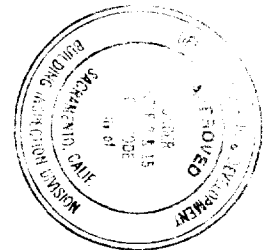
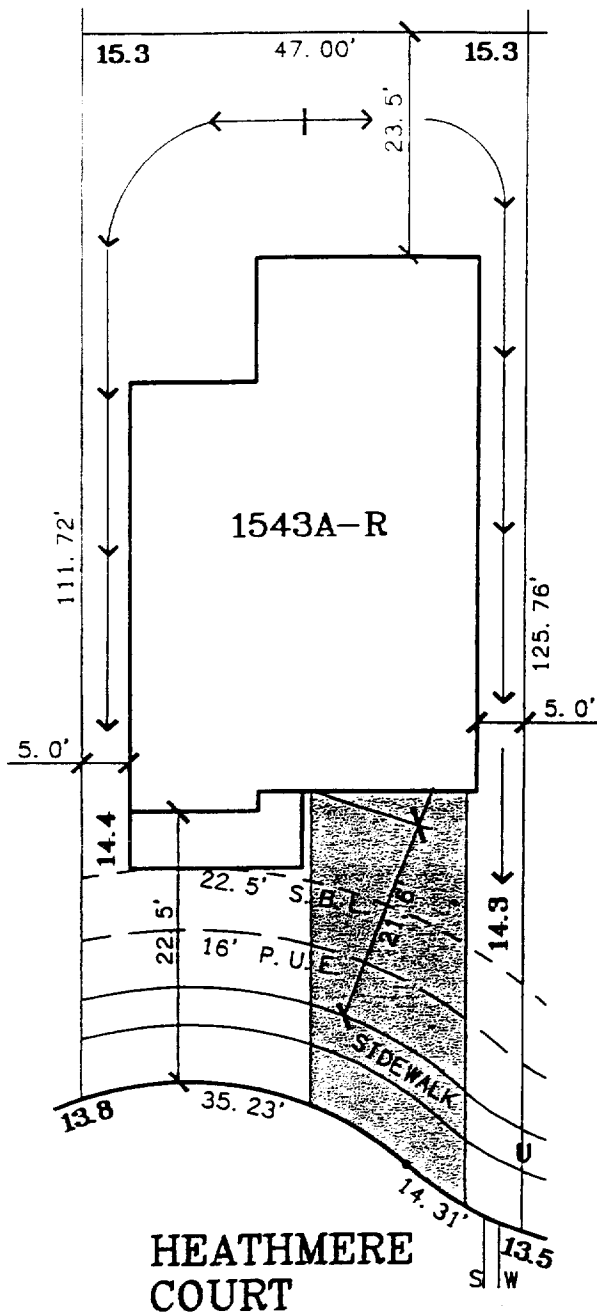

This set of plans and specifications must be kept on the job at all times and it is unlawful to make any changes or alterations from the same without written permission from the Building Inspection Division.
 The approval of this plan and specification SHALL NOT be held to permit or approve the violation of any City Ordinance or State Law.

SCALE: 1" = 20'

LOT AREA: 5,401 SQ.FT.

DRAWN: 3-4-99 REV

A. P. N. :

ADDRESS : HEATHMERE COURT

APPROVED BY _____

The Spink Corporation

2590 VENTURE OAKS WAY
 SACRAMENTO, CA 95833

PH:(916)925-5550 FAX:(916)921-9274

HERITAGE PLACE
 UNIT NO. 2

LOT 62
 PLAN 1543A

RIVERSGATE

CITY OF SACRAMENTO, CA.
 CLIENT: EPICK HOMES #1, L.L.C.

JOB NO.: 2808-004