

**CITY OF SACRAMENTO**  
1231 I Street, Sacramento, CA 95814

**Permit No: 9909592**  
**Insp Area: 3**

**Site Address: 5151 FREEPORT BL SAC**  
Parcel No 018-0191-004

Sub-Type: ACOM  
Housing (Y/N): N

**CONTRACTOR**  
MYONG K KIM CONSTRUCTION  
2927 MERRIAM LN  
FOUSOM CA 95762

**OWNER**  
FADD COMPANY, A GENERAL PARTNERSHIP  
510 WILHAGGIN DR  
SACRAMENTO CA 95864

**ARCHITECT**

**Nature of Work:** REMOVE BRICK STORE FRONT,CUT IN WINDOWS

**CONSTRUCTION LENDING AGENCY:** I hereby affirm under penalty of perjury that there is a construction lending agency for the performance of the work for which this permit is issued (Sec. 3097, Civ. C)

Lender's Name \_\_\_\_\_ Lender's Address \_\_\_\_\_

**LICENSED CONTRACTORS DECLARATION:** I hereby affirm under penalty of perjury that I am licensed under provisions of Chapter 9 (commencing with section 7000) of Division 3 of the Business and Professions Code and my license is in full force and effect.

License Class \_\_\_\_\_ License Number \_\_\_\_\_ Date \_\_\_\_\_ Contractor Signature \_\_\_\_\_

**OWNER-BUILDER DECLARATION:** I hereby affirm under penalty of perjury that I am exempt from the contractors License Law for the following reason (Sec. 7031.5, Business and Professions Code: any city or county which requires a permit to construct, alter, improve, demolish, or repair any structure, prior to its issuance, also requires the applicant for such permit to file a signed statement that he or she is licensed pursuant to the provisions of the Contractors License Law (Chapter 9 (commencing with Section 7000) of Division 3 of the Business and Professions Code) or that he or she is exempt therefrom and the basis for the alleged exemption. Any violation of Section 7031.5 by any applicant for a permit subjects the applicant to a civil penalty of not more than five hundred dollars (\$500.00):

I, as a owner of the property, or my employees with wages as their sole compensation, will do the work, and the structure is not intended or offered for sale (Sec. 7044, Business and Professional Code: The Contractors License Law does not apply to an owner of property who builds or improves thereon, and who does such work himself or herself or through his/her own employees, provided that such improvements are not intended or offered for sale. If, however, the building or improvement is sold within one year of completion, the owner-builder will have the burden of proving that he/she did not build or improve for the purpose of sale.)

I, as owner of the property, am exclusively contracting with licensed contractors to construct the project (Sec. 7044, Business and Professions Code). The Contractors License Law does not apply to an owner of property who builds or improves thereon, and who contracts for such projects with a contractor(s) licensed pursuant to the Contractors License Law.

I am exempt under Sec. \_\_\_\_\_ B & PC for this reason: \_\_\_\_\_

Date 8/27/99 Owner Signature Myong K. Kim

**IN ISSUING THIS BUILDING PERMIT,** the applicant represents, and the city relies on the representation of the applicant, that the applicant verified all measurements and locations shown on the application or accompanying drawings and that the improvement to be constructed does not violate any law or private agreement relating to permissible or prohibited locations for such improvements. This building permit does not authorize any illegal location of any improvement or the violation of any private agreement relating to location of improvements.

I certify that I have read this application and state that all information is correct. I agree to comply with all city and county ordinances and state laws relating to building construction and hereby authorize representative(s) of this city to enter upon the abovementioned property for inspection purposes.

Date 8/27/99 Applicant/Agent Signature Myong K. Kim

**WORKER'S COMPENSATION DECLARATION:** I hereby affirm under penalty of perjury one of the following declarations:

I have and will maintain a certificate of consent to self-insure for workers' compensation as provided for by Section 3700 of the Labor Code, for the performance of work for which the permit is issued.

I have and will maintain workers' compensation insurance, as required by Section 3700 of the Labor Code, for the performance of the work for which this permit is issued. My workers' compensation insurance carrier and policy number are:

Carrier \_\_\_\_\_ Policy Number \_\_\_\_\_ Exp Date \_\_\_\_\_

This section need not be completed if the permit is for \$100 or less) I certify that in the performance of the work for which this permit is issued, I shall not employ any person in any manner so as to become subject to the workers' compensation laws of California and agree that if I should become subject to the workers' compensation provisions of Section 3700 of the Labor Code, I shall forthwith comply with those provisions.

Date 8/27/99 Applicant Signature Myong K. Kim

**WARNING:** FAILURE TO SECURE WORKER'S COMPENSATION COVERAGE IS UNLAWFUL AND SHALL SUBJECT AN EMPLOYER TO CRIMINAL PENALTIES AND CIVIL FINES UP TO ONE HUNDRED THOUSAND DOLLARS (\$100,000) IN ADDITION TO THE COST OF COMPENSATION, DAMAGES AS PROVIDED FOR IN SECTION 3706 OF THE LABOR CODE, INTEREST AND ATTORNEY'S FEE.

**THIS PERMIT SHALL EXPIRE BY LIMITATION IF WORK IS NOT COMMENCED WITHIN 180 DAYS.**

LILY'S HAIR DESIGN

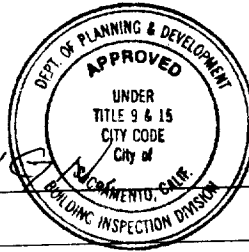

This set of plans and specifications must be kept on the job at all times and it is unlawful to make any changes or alterations from the same without written permission from the Building Inspection Division.

The approval of this plan and specification SHALL NOT be held to permit or approve the violation of any City Ordinance or State Law.

TOP (3) 5/8" x 6" Wedge anchor w/ min 3/4 embedment. countersunk @ post for window frame.

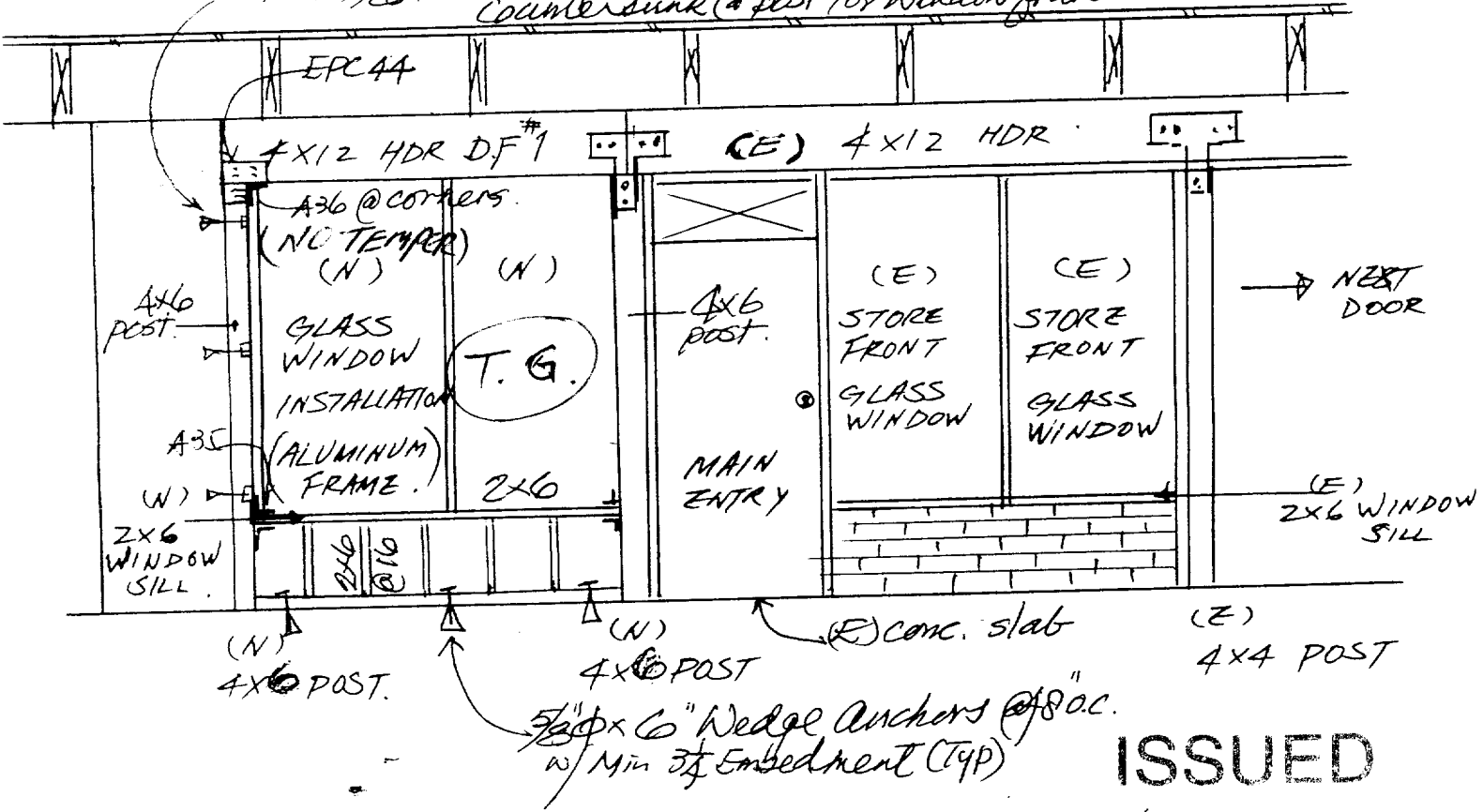

ISSUED

STORE FRONT GLASS INSTALLATION AUG 27 1999

CITY OF SACRAMENTO  
DEVELOPMENT SERVICES DIV

5151 FREEPORT BLVD  
SACRAMENTO CA.

MYONG K. KIM: 499-0921.

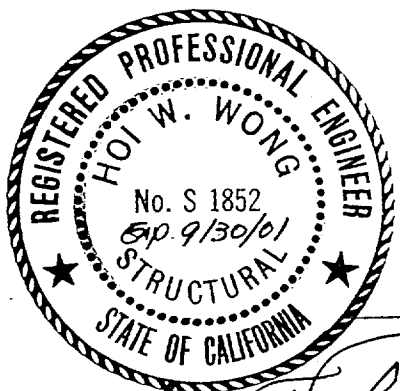

*[Handwritten signature]*

990959Z

*[Handwritten signature: John Tang]*

UN

\*\*\*\*\* SIMPLY SUPPORTED BEAM \*\*\*\*\*

PAN (FT.)=? 12.5  
 DEAD LOAD (LBS)=? 223  
 LIVE LOAD (LBS)=? 300  
 ALLOW FB (PSI)=? 1350  
 ALLOW FV (PSI)=? 95  
 DURATION FACTOR=? 1.25  
 APPROX. HEIGHT=? 12  
 MODULUS OF ELASTICITY=? 1.6e6



*Handwritten signature*

MOMENT (FT-LB)= 10214.84  
 SHEAR (LBS.) = 3268.75  
 DEFLECT. MODULUS = 72.6389  
 AREA RE'QD = 34.68316  
 RIGIDITY RE'QD= 247.1924  
                   = 226.0437

*Use 4x12 D.F. #1 leader*

DO YOU WANT TO CALCULATE CAMBER?  
 no  
 \*\*\*\*\*  
 Want to revise the design  
 no  
 ok

*Wind =  $9.5 \times \frac{1}{2} \times 15 \text{ #} = 71.25 \text{ #/ft}$*

*$N = \frac{1}{2} \times 71.25 \times 8.25^2 = 606 \text{ #}$*

*S = 4.05      use 2x6      S = 7.56      O.K.*

*R = 294 #      use A36 @ corners.      O.K.*

DAD"postc6pmp

κ  
JN

\*\*\*\*\*  
Allowable Compressive Stress in Post \*  
\*\*\*\*\*

By Hoi Wong S.E.

Vertical Load (lbs) ? 5490  
Height of post (ft) ? 9.5  
Least post dimension ? 3.5  
Width of post (in) ? 3.5  
Compressive stress parallel to grain (psi)=? 925  
Modifiers for duration/moisture/temp/size? 1.25,1,1,1

Allowable Compressive Stress= 407.9629 psi  
Actual Compressive Stress = 448.1633 psi

Section need to be increased

Vertical Load (lbs) ? 5490  
Height of post (ft) ? 9.5  
Least post dimension ? 5.5  
Width of post (in) ? 3.5  
Compressive stress parallel to grain (psi)=? 925  
Modifiers for duration/moisture/temp/size? 1.25/,1,1,1

Allowable Compressive Stress= 785.1072 psi  
Actual Compressive Stress = 285.1948 psi

The Section 5.5 x 3.5 is adequate

*use 4x6 post.*



### Design of header bm.

Dead load	$12' \times 15' = 180$	#
ceiling	$2.5 \times 5 = 13$	#
Misc.	$2 \times 15 = 30$	#
	<hr/>	
LL	$20 \times 15 = 300$	#
	$223$	#
	$= 300$	#

$$M = \frac{1}{2} \times \sqrt{23} \times 12.5^2 = 10214 \text{ #}^2$$

$$S = \frac{10214 \times 12}{1350 \times 12.5} = 72.6 \text{ in}^3$$

$$V = \frac{1}{2} \times \sqrt{23} \times 12.5 = 3268$$

$$A = 41.28$$

$$I_{LL} = \frac{300 \times 12.5^3}{2500} = 234 \text{ in}^4$$

**4x12 DF #1**  
 $S = 73.8 ; A = 39.4 ; I = 415$

OK

$$\text{Post } P = \frac{1}{2} (8.5' + 12.5') @ 523 \text{ #} = 5491 \text{ #}$$



PARCEL NO:  
018-0191-004

FREEPORT BLVD.

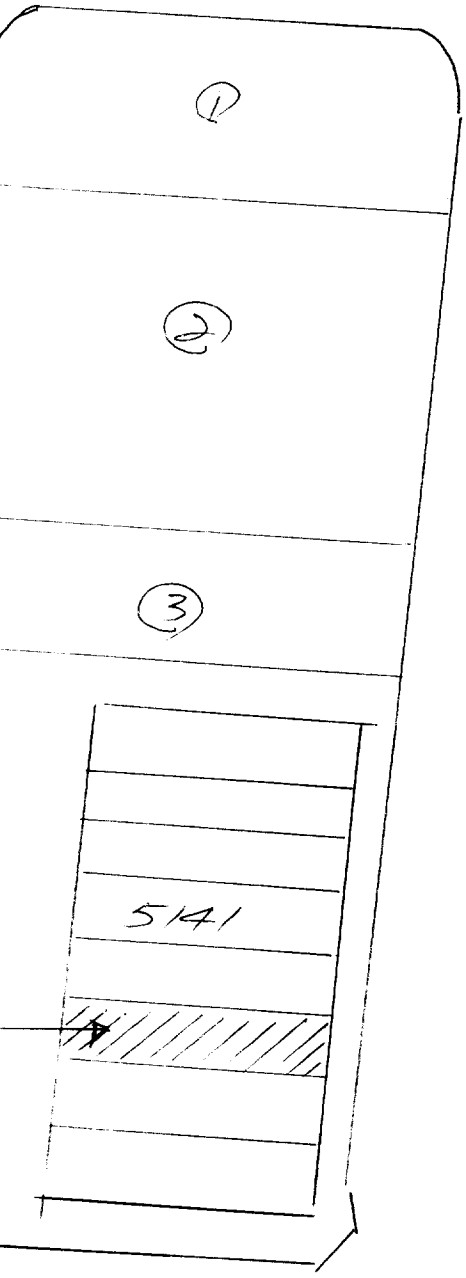

SITE,  
5151 FREEPORT  
BLVD  
SACRAMENTO