

CITY OF SACRAMENTO
1231 I Street, Sacramento, CA 95814

Permit No: 0102379
Insp Area: 4

Site Address: 5157 NANTUCKET WY SAC
Parcel No: 225-1510-085 NORTHPT PK 17 LOT 85

Sub-Type: NSFR
Housing (Y/N): N

CONTRACTOR
JOHN LAING HOMES
1536 EUREKA RD STE 106
ROSEVILLE CA. 95661

OWNER

ARCHITECT

Nature of Work: NSFR MP1895/OPT 9 RMS

CONSTRUCTION LENDING AGENCY: I hereby affirm under penalty of perjury that there is a construction lending agency for the performance of the work for which this permit is issued (Sec. 3097 Civ. C).

Lender's Name _____ Lender's Address _____

LICENSED CONTRACTORS DECLARATION: I hereby affirm under penalty of perjury that I am licensed under provisions of Chapter 9 (commencing with section 7000) of Division 3 of the Business and Professions Code and my license is in full force and effect.

License Class B License Number 680090 Date 3/2/01 Contractor Signature N. Collins

OWNER-BUILDER DECLARATION: I hereby affirm under penalty of perjury that I am exempt from the contractors License Law for the following reason (Sec. 7031.5, Business and Professions Code: any city or county which requires a permit to construct, alter, improve, demolish, or repair any structure, prior to its issuance, also requires the applicant for such permit to file a signed statement that he or she is licensed pursuant to the provisions of the Contractors License Law (Chapter 9 (commencing with Section 7000) of Division 8 of the Business and Professions Code) or that he or she is exempt therefrom and the basis for the alleged exemption. Any violation of Section 7031.5 by any applicant for a permit subjects the applicant to a civil penalty of not more than five hundred dollars (\$500.00).

I, as a owner of the property, or my employees with wages as their sole compensation, will do the work, and the structure is not intended or offered for sale (Sec. 7044, Business and Professional Code. The Contractors License Law does not apply to an owner of property who builds or improves thereon, and who does such work himself or herself or through his/her own employees, provided that such improvements are not intended or offered for sale. If, however, the building or improvement is sold within one year of completion, the owner-builder will have the burden of proving that he/she did not build or improve for the purpose of sale.)

I, as owner of the property, am exclusively contracting with licensed contractors to construct the project (Sec. 7044, Business and Professions Code. The Contractors License Law does not apply to an owner of property who builds or improves thereon, and who contracts for such projects with a contractor(s) licensed pursuant to the Contractors License Law)

I am exempt under Sec. _____ B & P for this reason: _____

Date _____ Owner Signature _____

IN ISSUING THIS BUILDING PERMIT, the applicant represents, and the city relies on the representation of the applicant, that the applicant verified all measurements and locations shown on the application or accompanying drawings and that the improvement to be constructed does not violate any law or private agreement relating to permissible or prohibited locations for such improvements. This building permit does not authorize any illegal location of any improvement or the violation of any private agreement relating to location of improvements.

I certify that I have read this application and state that all information is correct. I agree to comply with all city and county ordinances and state laws relating to building construction and hereby authorize representative(s) of this city to enter upon the abovementioned property for inspection purposes.

Date 3/2/01 Applicant/Agent Signature N. Collins

WORKER'S COMPENSATION DECLARATION: I hereby affirm under penalty of perjury one of the following declarations:

I have and will maintain a certificate of consent to self-insure for workers' compensation as provided for by Section 3700 of the Labor Code, for the performance of work for which the permit is issued

I have and will maintain workers' compensation insurance, as required by Section 3700 of the Labor Code, for the performance of the work for which this permit is issued. My workers' compensation insurance carrier and policy number are:

Carrier EAGLE PACIFIC INSURANCE COMPANY Policy Number NS0002200 Exp Date 04/15/2001

(This section need not be completed if the permit is for a residential project.) I certify that in the performance of the work for which this permit is issued, I shall not employ any person in any manner so as to become subject to the workers' compensation laws of California and agree that if I should become subject to the workers' compensation provisions of Section 3700 of the Labor Code, I shall forthwith comply with those provisions.

Date 3/2/01 Applicant Signature N. Collins

WARNING: FAILURE TO SECURE WORKER'S COMPENSATION COVERAGE IS UNLAWFUL AND SHALL SUBJECT AN EMPLOYER TO CRIMINAL PENALTIES AND CIVIL FINES UP TO ONE HUNDRED THOUSAND DOLLARS (\$100,000) IN ADDITION TO THE COST OF COMPENSATION, DAMAGES AS PROVIDED FOR IN SECTION 3706 OF THE LABOR CODE, INTEREST AND ATTORNEY'S FEE.

THIS PERMIT SHALL EXPIRE BY LIMITATION IF WORK IS NOT COMMENCED WITHIN 180 DAYS.

RESIDENTIAL BUILDING PERMIT APPLICATION

New Construction Addition Remodels Other

Project Address: 5157 Nantucket Way Assessor Parcel # 0225-1510-085

OWNER INFORMATION:

Lot 85

Legal Property Owner: John Laing Homes Phone # 780-1222
 Owner Address: 1536 Curcha Rd. #100, City ROSEVILLE, State CA, Zip 95661

CONTRACTOR INFORMATION:

Northpointe Park Unit #17

Contractor: John Laing Homes Lic. # 687596 Phone # 780-1222 Fax# 780-1333

PROJECT INFORMATION:

Land Use Zone _____ Occupancy Group _____ Construction Type VN Fed Code A1

No. of stories: 1 No. of rooms: 9 Street width: _____

1st Floor Area _____ 2nd Floor Area _____ Basement _____ Roof Material _____

AREA IN SQUARE FOOT OF:

EXISTING

NEW

Dwelling/Living

1895

Garage/Storage

417

Decks/Balconies

104

Carports

SCOPE OF WORK:

FOR OFFICE USE ONLY

- Information above complete AR Flood Waiver required Planning Approval
 Violation files checked Flood Elevation Certificate Required Design Review Approval
 Standard setbacks Water Development Infill Area Special Fee Districts Apply : _____
 County Sewer

NEW STRUCTURES & ADDITIONS

✦ THE FOLLOWING MUST BE PROVIDED IN ORDER TO SUBMIT FOR PLAN REVIEW

- 2 COMPLETE PLANS, LEGIBLE & DRAWN TO SCALE ✦ Plans to include: site plan, floor plan, elevations, roof/ceiling plan, foundation and structural framing details, and structural calculations for non-conforming structures.
 3 SETS IF PROJECT IS IN A DESIGN REVIEW AREA
 Title 24 Energy Compliance documentation 11" x 17" copy of floor plan for County Assessor
 Grading and Erosion Control Questionnaire Plan Review Fees

Date: _____

Received by: (staff) _____

ACTIVITY/PERMIT #



**INSULATION CONTRACTORS
ASSOCIATION
OF AMERICA**

INSULATION
CERTIFICATE

63976

1321 DUKE STREET, SUITE 303 • ALEXANDRIA, VA 22314 • (703) 739-0356

THIS IS TO CERTIFY THAT INSULATION HAS BEEN INSTALLED IN CONFORMANCE WITH CURRENT ENERGY REGULATIONS, CALIFORNIA ADMINISTRATIVE CODE, TITLE 24, STATE OF CALIFORNIA, IN THE BUILDING LOCATED AT:

3000 Lakeside LOT # 85 TRACT # 011111

STREET 5157 Nantucket CITY San Diego

EXTERIOR WALLS:

MANUFACTURER 199 THICKNESS/TYPE _____ R- 13/19
VALUE _____

CEILINGS:

BATTS: _____ R- 30
THICKNESS/TYPE _____ VALUE _____

MANUFACTURER 199 THICKNESS/TYPE _____ R- 30
BLOWN IN: _____ MINIMUM _____ VALUE _____
MANUFACTURER 199 THICKNESS _____ R- 30
THICKNESS/TYPE _____ VALUE _____

SQUARE FOOTAGE COVERED 600 NUMBER OF BAGS USED _____

FLOORS: _____ R- _____
THICKNESS/TYPE _____ VALUE _____

MANUFACTURER _____ R- _____
THICKNESS/TYPE _____ VALUE _____

SLAB ON GRADE: _____ R- _____
THICKNESS/TYPE _____ VALUE _____

MANUFACTURER _____ R- _____
THICKNESS/TYPE _____ VALUE _____

WIDTH OF INSULATION _____ INCHES

FOUNDATIONS WALLS: _____ R- _____
THICKNESS/TYPE _____ VALUE _____

MANUFACTURER _____ R- _____
THICKNESS/TYPE _____ VALUE _____

GENERAL CONTRACTOR _____ R- _____
THICKNESS/TYPE _____ VALUE _____

CALIFORNIA CONTRACTORS LICENSE # 263784 DATE 2-24-1

INSULATION CONTRACTOR **ARCADE INSULATION** TITLE _____
SIGNATURE [Signature] DATE _____

SIGNATURE

TITLE

LOT 85

OMEGA PRODUCTS CORP.

DIAMOND WALL INSULATING STUCCO SYSTEM

JOB ADDRESS:

ICBO Report #4004

5157 NANTUCKET WY
SACRO CA 95835

Date of Job Completion 8-15-01

PLASTERING CONTRACTOR:

Name: STUCCO WORKS INC.

Address: 5900 WAREHOUSE WAY, SACRAMENTO, CALIFORNIA 95826

Telephone No: (916) 383-6699

Contractor Number of Diamond Wall System 2175

This is to certify that the exterior coating system on the building exterior at the above address has been installed in accordance with the evaluation report specified above and the manufacturer's instructions.

8-22-01
Date

[Signature]
Signature of authorized representative of
Plastering Contractor

This installation card must be presented to the building inspector after completion of work and before final inspection.

ROBERTSON ENGINEERING

8536 Elder Creek Rd., Sacramento, CA 95828
Phone: (916) 388-0866 Fax: (916) 388-0740

April 27, 2001

Building Department
City of Sacramento

Re: John Laing Homes
Calypso
All Plans

Dear Sir or Madam:

The following issues have been brought to my attention.

1. Where slab ties have been used to connect the first pour footing to the slab pour, anchor bolts need only be embedded 7" from the top of the slab.
2. Slab ties need only extend 24" into slab for this project.
3. A 1" layer of sand is acceptable for the layer between the vapor barrier and the slab.
4. Wall top plates are not to have lap splice nailing on each side of intersecting walls. If chord force transfer is a consideration, provide edge nailing to both plates at shear walls or nail chords together at shear walls using the 16d nailing schedule given in the shear wall schedule.

Sincerely,



Richard M. Robertson, P.E.

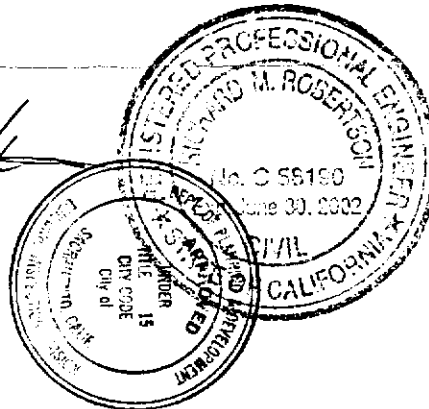

This set of plans and specifications must be kept on the job at all times and it is unlawful to make any changes or alterations from the same without written permission from the Building Inspection Division.
The approval of this plan and specification SHALL NOT be held to permit or approve the violation of any City Ordinance or State Law.

ROBERTSON ENGINEERING

8536 Elder Creek Rd., Sacramento, CA 95828
Phone: (916) 388-0866 Fax: (916) 388-0740

June 7, 2001

Building Department
City of Sacramento

Re: John Laing Homes - Calypso
All Plans

Dear Sir or Madam:

The concrete spall located beneath the center of a P3 shear wall does not compromise the integrity of the shearwall provided that the spall does not occur near any ho/downs or within 3" of any anchor bolts.

Sincerely,



Richard M. Robertson, P.E.

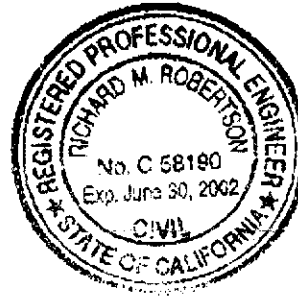

ROBERTSON ENGINEERING

8536 Elder Creek Rd., Sacramento, CA 95828
Phone: (916) 388-0866 Fax: (916) 388-0740

June 7, 2001

Building Department
City of Sacramento

Re: John Laing Homes - Calypso
All Plans

Dear Sir or Madam:

The following schedule may be used on all plans for the installation of misplaced holdowns.

Holdown Type	All-thread diameter	Embedment depth
HTT22	5/8"	10"
PHD2	5/8"	10"
PHD5	5/8"	10"
PHD6	7/8"	12"
PHD8	7/8"	12"
HD10A	7/8"	12"

All bolts to be installed with Simpson Epoxy-Set adhesive. Install all bolts per Simpson specifications.

As a repair for missing or damaged HPAHD22 holdowns, install a PHD2 or HTT22 holdown per the installation schedule above.

if you have any other questions, please call me at the above number.

Sincerely,



Richard M. Robertson, P.E.



SIGNET
Testing Labs, Inc.

DATE: 6-6-01
PROJECT NO. _____
PROJECT: Calipso
LOCATION: _____

DSA FILE/APPL. NO. _____
OSHPD NO. _____
PERMIT NO. _____
WEATHER: _____ TEMP: _____

I performed torque testing on 5/8" A.B
@ Lots # 84, 85, 86, 87, All tests met the required
Strength of 60 Ft lbs.

Lot # 84 - 24 torque tests
86 - 6 torque tests
85 - 18 torque tests
85 - 9 torque tests

All tests met the required strength.

To the best of my knowledge, the above ~~WAS~~ WAS NOT performed in accordance with the approved plans, specifications, and regulatory requirements.

Except As Noted

Superintendent/Representative: _____

Inspector: MM Alt

3121 Diablo Avenue
Hayward CA 94545

4741 Pell Drive #8
Sacramento CA 95838

520 Mercantile Street #A
Cotati, CA 94931

310 W 5th Street #203
Santa Ana CA 92710

JOB SITE COPY

FORM 309

86
PAD=13.1

84
PAD=13.0

This set of plans and specifications must be kept on the job at all times and it is unlawful to make any changes or alterations from the same without written permission from the Building Inspection Division.
The approval of this plan and specification SHALL NOT be held to permit or approve the violation of any City Ordinance or State Law.

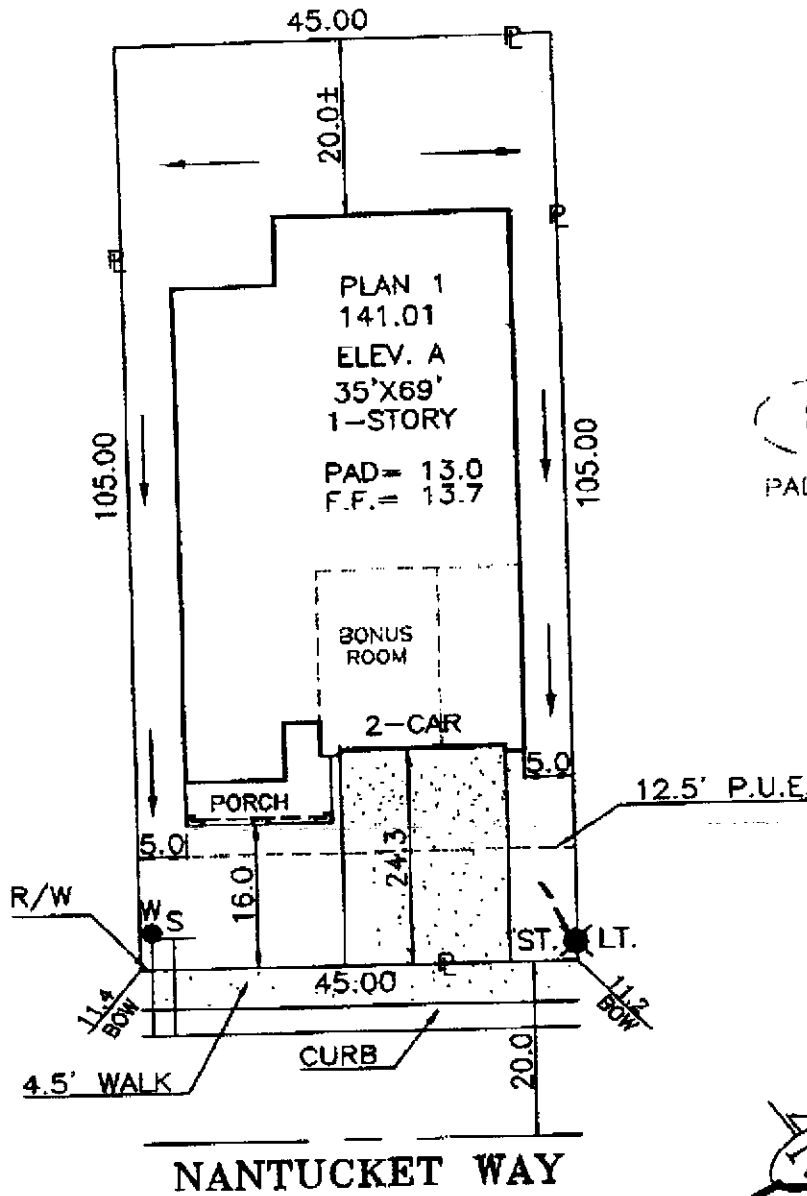
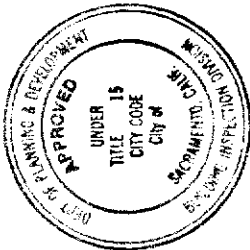

DIMENSIONS SHOWN ARE APPROXIMATE EXCEPT FOR MINIMUMS REQUIRED BY ORDINANCE. THIS PLOT DOES NOT REFLECT AS BUILT CONDITIONS AND MAY VARY FROM THIS PLAN.

John Laing Homes 1536 BUREKA ROAD SUITE 100 ROSEVILLE, CALIFORNIA 95661 (TEL.) 916-780-1222 (FAX.) 916-780-1333		CALYPSO		PLOT PLAN	
		NORTHPOINTE PARK VILLAGE NO. 17 CITY OF SACRAMENTO CALIFORNIA		NOTES: CURVED LINES ARE CHORD MEASUREMENTS.	
ADDRESS: 5157 NANTUCKET WAY		LOT COV: 39.2 %	APN: 225-151-85	LOT 85	
PLAN NO.: 1-A	LOT SQ. FT.: 4,725	REAR YARD COVERAGE: %			
DRAWN BY: R.P.	APPROVED BY:	DATE: 2/28/01	SCALE: 1"=20'		