

CITY OF SACRAMENTO
1231 I Street, Sacramento, CA 95814

Permit No: **0309739**
Insp Area: 4
Thos Bros: 257-C4

Site Address: **5676 BRIDGECROSS DR SAC** Sub-Type: NSFR
Parcel No: 201-0790-019 NORTHPOINTE PARK VIL. 30A LOT 38 Housing (Y/N):
N

CONTRACTOR
BEAZER HOMES
3009 DOUGLAS BL #150
ROSEVILLE CA 95661

OWNER

ARCHITECT

Nature of Work: MP 1910 1 STORY 9 ROOM SFR

CONSTRUCTION LENDING AGENCY: I hereby affirm under penalty of perjury that there is a construction lending agency for the performance of the work for which this permit is issued (Sec. 3097, Civ. C).

Lender's Name _____ Lender's Address _____

LICENSED CONTRACTORS DECLARATION: I hereby affirm under penalty of perjury that I am licensed under provisions of Chapter 9 (commencing with section 7000) of Division 3 of the Business and Professions Code and my license is in full force and effect.

License Class B License Number 724191 Date 7/9/03 Contractor Signature Sheuyf Van Maeren

OWNER-BUILDER DECLARATION: I hereby affirm under penalty of perjury that I am exempt from the contractors License Law for the following reason (Sec. 7031.5, Business and Professions Code; any city or county which requires a permit to construct, alter, improve, demolish, or repair any structure, prior to its issuance, also requires the applicant for such permit to file a signed statement that he or she is licensed pursuant to the provisions of the Contractors License Law (Chapter 9 (commencing with Section 7000) of Division 8 of the Business and Professions Code) or that he or she is exempt therefrom and the basis for the alleged exemption. Any violation of Section 7031.5 by any applicant for a permit subjects the applicant to a civil penalty of not more than five hundred dollars (\$500.00);

____ I, as a owner of the property, or my employees with wages as their sole compensation, will do the work, and the structure is not intended or offered for sale (Sec. 7044, Business and Professional Code: The Contractors License Law does not apply to an owner of property who builds or improves thereon, and who does such work himself or herself or through his/her own employees, provided that such improvements are not intended or offered for sale. If, however, the building or improvement is sold within one year of completion, the owner-builder will have the burden of proving that he/she did not build or improve for the purpose of sale.)

____ I, as owner of the property, am exclusively contracting with licensed contractors to construct the project (Sec. 7044, Business and Professions Code: The Contractors License Law does not apply to an owner of property who builds or improves thereon, and who contracts for such projects with a contractor(s) licensed pursuant to the Contractors License Law).

____ I am exempt under Sec. _____ B & PC for this reason: _____
Date _____ Owner Signature _____

IN ISSUING THIS BUILDING PERMIT, the applicant represents, and the city relies on the representation of the applicant, that the applicant verified all measurements and locations shown on the application or accompanying drawings and that the improvement to be constructed does not violate any law or private agreement relating to permissible or prohibited locations for such improvements. This building permit does not authorize any illegal location of any improvement or the violation of any private agreement relating to location of improvements.

I certify that I have read this application and state that all information is correct. I agree to comply with all city and county ordinances and state laws relating to building construction and hereby authorize representative(s) of this city to enter upon the above-mentioned property for inspection purposes.

Date 7/9/03 Applicant/Agent Signature Sheuyf Van Maeren

WORKER'S COMPENSATION DECLARATION: I hereby affirm under penalty of perjury one of the following declarations:

____ I have and will maintain a certificate of consent to self-insure for workers' compensation as provided for by Section 3700 of the Labor Code, for the performance of work for which the permit is issued.

I have and will maintain workers' compensation insurance, as required by Section 3700 of the Labor Code, for the performance of the work for which this permit is issued. My workers' compensation insurance carrier and policy number are:

Carrier LIBERTY MUTUAL INS CO. Policy Number WA2-65D-004147-082 Exp Date 04/01/2004

____ (This section need not be completed if the permit is for \$100 or less) I certify that in the performance of the work for which this permit is issued, I shall not employ any person in any manner so as to become subject to the workers' compensation laws of California and agree that if I should become subject to the workers' compensation provisions of Section 3700 of the Labor Code, I shall forthwith comply with those provisions.

Date 7/9/03 Applicant Signature Sheuyf Van Maeren

WARNING: FAILURE TO SECURE WORKER'S COMPENSATION COVERAGE IS UNLAWFUL AND SHALL SUBJECT AN EMPLOYER TO CRIMINAL PENALTIES AND CIVIL FINES UP TO ONE HUNDRED THOUSAND DOLLARS (\$100,000) IN ADDITION TO THE COST OF COMPENSATION, DAMAGES AS PROVIDED FOR IN SECTION 3706 OF THE LABOR CODE, INTEREST AND ATTORNEY'S FEE.

THIS PERMIT SHALL EXPIRE BY LIMITATION IF WORK IS NOT COMMENCED WITHIN 180 DAYS.

THIS PLOT PLAN IS NOT FOR SALES PURPOSES. THIS PLOT PLAN IS FOR THE PURPOSES OF INDICATING COMPLIANCE WITH ZONING SET BACKS, GENERAL DRAINAGE DIRECTION, AND APPROXIMATE UTILITY CONNECTION. ALL OTHER DATA SHOWN HEREON IS CONCEPTUAL. THIS PLOT PLAN DOES NOT REFLECT AS-BUILT CONDITION, RETAINING WALL ARE OPTIONAL AND MAY OR MAY NOT BE CONSTRUCTED.

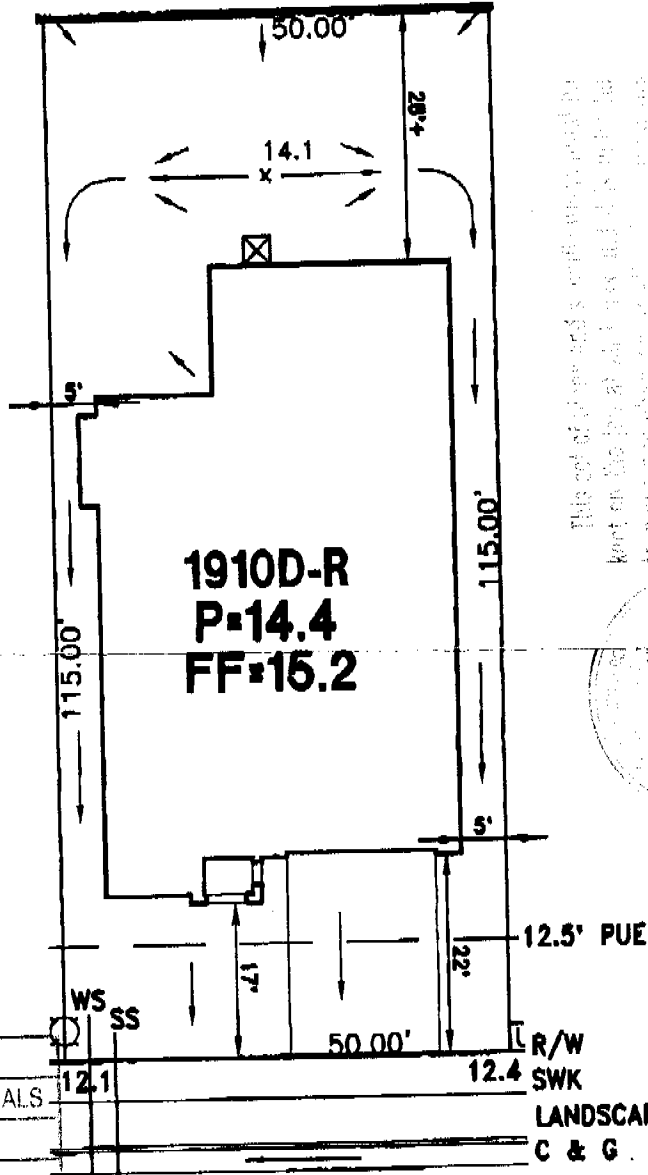
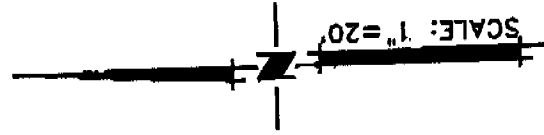

This plot plan is prepared in accordance with the requirements of the City of Sacramento, California, and is intended to show compliance with the zoning code. It is not intended to show any other information, and it is not to be used for any other purpose. The engineer or architect is not responsible for any errors or omissions in this plot plan, and the user is advised to verify all information shown hereon.

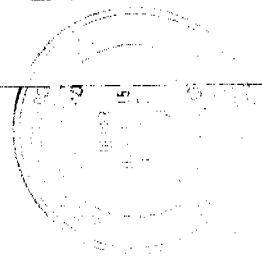

ROUTING/APPROVAL		INITIALS
President	✓	
Project Management		
Engineering		
Operating	✓	GR
Admin.		
Accounting		

- LEGEND**
- STREET LIGHT
 - TRANSFORMER
 - UTILITY BOX
 - FIRE HYDRANT
 - STOP SIGN

PLOT PLAN
LOT 38
 SHEFFIELD GARDENS
 AT NORTHPOINTE PARK VILLAGE 30A
 FOR
 BEAZER HOMES
 CITY OF SACRAMENTO CALIFORNIA

WOOD RODGERS
 ENGINEERING • PLANNING • MAPPING • SURVEYING
 3301 C STREET, BLDG. 100-B, SACRAMENTO, CA 95816
 PHONE: (916) 241-7780 FAX: (916) 241-7787

DATE:	DRAWN:	CHECKED:	PROJECT NO.:
JUNE 03	BKV		1045.056

S:\Jobs\Northpointe Phase 2\ Village 30A\Dwgs\Civil\Plotplans\38.dwg 6/25/03 2:56pm bvwandevire

RESIDENTIAL BUILDING PERMIT APPLICATION

 New Construction

 Addition

 Remodel

 Other

Project Address: lot 38, 5676 bridgecross Dr. Assessor Parcel # 201-079-019

OWNER INFORMATION: Northpointe Park Village 30 A

Legal Property Owner: Beazer Homes Holdings Corp. Phone # 916-773-3888
 Owner Address: 3009 Douglas Blvd. 150 City Roseville State CA Zip 95661

CONTRACTOR INFORMATION:

0309739

Contractor: Same as above Lic. # B724191 Phone # 773-3888 Fax # 773-0425

PROJECT INFORMATION:

Land Use Zone _____ Occupancy Group _____ Construction Type _____ Fed Code _____

No. of stories: 1 No. of rooms: _____ Street width: _____

1st Floor Area 1910 2nd Floor Area 576 Basement 0 Roof Material _____

AREA IN SQUARE FOOT OF:

EXISTING

NEW

Dwelling/Living	_____	<u>1910</u>
Garage/Storage	_____	<u>576</u>
Decks/Balconies	_____	_____
Carports	_____	_____

SCOPE OF WORK: Single Family Homes

FOR OFFICE USE ONLY

- | | | |
|---|---|--|
| <input type="checkbox"/> Information above complete | <input type="checkbox"/> AR Flood Waiver required | <input type="checkbox"/> Planning Approval |
| <input type="checkbox"/> Violation files checked | <input type="checkbox"/> Flood Elevation Certificate Required | <input type="checkbox"/> Design Review Approval |
| <input type="checkbox"/> Standard setbacks | <input type="checkbox"/> Water Development Infill Area | <input type="checkbox"/> Special Fee Districts Apply : _____ |
| <input type="checkbox"/> County Sewer | | |

NEW STRUCTURES & ADDITIONS

*THE FOLLOWING MUST BE PROVIDED IN ORDER TO SUBMIT FOR PLAN REVIEW

- | | |
|---|--|
| <input type="checkbox"/> 2 COMPLETE PLANS, LEGIBLE & DRAWN TO SCALE
<input type="checkbox"/> 3 SETS IF PROJECT IS IN A DESIGN REVIEW AREA

<input type="checkbox"/> Title 24 Energy Compliance documentation
<input type="checkbox"/> Grading and Erosion Control Questionnaire | <input type="checkbox"/> 11" x 17" copy of floor plan for County Assessor
<input type="checkbox"/> Plan Review Fees

<i>* Plans to include: site plan, floor plan, elevations, roof/ceiling plan, foundation and structural framing details, and structural calculations for non-conforming structures.</i> |
|---|--|

Date: _____

Received by: (staff) _____

ACTIVITY/PERMIT # _____

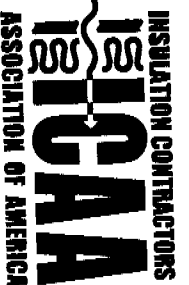

INSULATION CONTRACTORS ASSOCIATION OF AMERICA

INSULATION CERTIFICATE 52367

1321 DUKE STREET, SUITE 303 • ALEXANDRIA, VA 22314 • (703) 739-0356

THIS IS TO CERTIFY THAT INSULATION HAS BEEN INSTALLED IN CONFORMANCE WITH CURRENT ENERGY REGULATIONS, CALIFORNIA ADMINISTRATIVE CODE, TITLE 24, STATE OF CALIFORNIA, IN THE BUILDING LOCATED AT:

LOT # _____ TRACT # _____

STREET 5676 Bridgeway CITY _____

EXTERIOR WALLS:

MANUFACTURER _____ THICKNESS/TYPE _____ R-VALUE 13

CELLINGS:

BATTS: MANUFACTURER _____ THICKNESS/TYPE _____ R-VALUE 30

BLOWN IN: MINIMUM R-VALUE 30

MANUFACTURER _____ THICKNESS _____ R-VALUE _____

SQUARE FOOTAGE COVERED _____ NUMBER OF BAGS USED _____ R-VALUE _____

FLOORS: MANUFACTURER _____ THICKNESS/TYPE _____ R-VALUE _____

SLAB ON GRADE: MANUFACTURER _____ THICKNESS/TYPE _____ R-VALUE _____

MANUFACTURER _____ THICKNESS/TYPE _____ R-VALUE _____

WIDTH OF INSULATION _____ INCHES R-VALUE _____

FOUNDATION WALLS: MANUFACTURER _____ THICKNESS/TYPE _____ R-VALUE _____

MANUFACTURER _____ THICKNESS/TYPE _____ R-VALUE _____

GENERAL CONTRACTOR _____ DATE _____

CALIFORNIA CONTRACTORS LICENSE # _____

SIGNATURE _____ TITLE _____

INSULATION CONTRACTOR ARCADE INSULATION DATE 11-11-03

CALIFORNIA CONTRACTORS LICENSE #0152986
NEVADA CONTRACTORS LICENSE #0055201
SIGNATURE _____ TITLE _____

Beazer Sheffield Lot #38
OMEGA PRODUCTS INTERNATIONAL, INC.

DIAMOND WALL INSULATING STUCCO SYSTEM

JOB ADDRESS:

ICBO Report #4004

5676 Bridgecross Dr.
Stucco

Date of Job Completion 9-15-03

PLASTERING CONTRACTOR:

Name: STUCCO WORKS, INC.

Address: 5900 WAREHOUSE WAY SACRAMENTO, CA. 95826

Telephone No: (916)383-6699

Contractor Number of Diamond Wall System 2175

This is to certify that the exterior coating system on the building exterior at the above address has been installed in accordance with the evaluation report specified above and the manufacturer's instructions.

10/3/03
Date

[Signature]
Signature of authorized representative of
Plastering Contractor

This installation card must be presented to the building inspector after completion of work and before final inspection.