

CITY OF SACRAMENTO
1231 I Street, Sacramento, CA 95814

Permit No: 0409334
Insp Area: 4
Thos Bros:
Sub-Type: NSFR
Housing (Y/N):

Site Address: 170 CHANGO CR SAC

Parcel No: 201-1010-013
N

NATOMAS CREEK VIL. 1 LOT #191

CONTRACTOR
D. R. HORTON INC.
4401 HAZEL AVE STE 225
FAIR OAKS, CA 95628

OWNER

ARCHITECT

PAID
CITY OF SACRAMENTO
JUN 25 2004
NORTH PERMIT

Nature of Work: MP2222 1 STORY 9RM SFR

CONSTRUCTION LENDING AGENCY: I hereby affirm under penalty of perjury that there is a construction lending agency for the performance of the work for which this permit is issued (Sec. 3097, Civ. C).

Lender's Name _____ Lender's Address _____

LICENSED CONTRACTORS DECLARATION: I hereby affirm under penalty of perjury that I am licensed under provisions of Chapter 9 (commencing with section 7000) of Division 3 of the Business and Professions Code and my license is in full force and effect.

License Class _____ License Number 750190 Date 6/25/04 Contractor Signature *[Signature]*

OWNER-BUILDER DECLARATION: I hereby affirm under penalty of perjury that I am exempt from the contractors License Law for the following reason (Sec. 7031.5, Business and Professions Code; any city or county which requires a permit to construct, alter, improve, demolish, or repair any structure, prior to its issuance, also requires the applicant for such permit to file a signed statement that he or she is licensed pursuant to the provisions of the Contractors License Law (Chapter 9 (commencing with Section 7000) of Division 8 of the Business and Professions Code) or that he or she is exempt therefrom and the basis for the alleged exemption. Any violation of Section 7031.5 by any applicant for a permit subjects the applicant to a civil penalty of not more than five hundred dollars (\$500.00);

____ I, as a owner of the property, or my employees with wages as their sole compensation, will do the work, and the structure is not intended or offered for sale (Sec. 7044, Business and Professional Code: The Contractors License Law does not apply to an owner of property who builds or improves thereon, and who does such work himself or herself or through his/her own employees, provided that such improvements are not intended or offered for sale. If, however, the building or improvement is sold within one year of completion, the owner-builder will have the burden of proving that he/she did not build or improve for the purpose of sale.)

____ I, as owner of the property, am exclusively contracting with licensed contractors to construct the project (Sec. 7044, Business and Professions Code: The Contractors License Law does not apply to an owner of property who builds or improves thereon, and who contracts for such projects with a contractor(s) licensed pursuant to the Contractors License Law).

____ I am exempt under Sec. _____ B & PC for this reason: _____

Date _____ Owner Signature _____

IN ISSUING THIS BUILDING PERMIT, the applicant represents, and the city relies on the representation of the applicant, that the applicant verified all measurements and locations shown on the application or accompanying drawings and that the improvement to be constructed does not violate any law or private agreement relating to permissible or prohibited locations for such improvements. This building permit does not authorize any illegal location of any improvement or the violation of any private agreement relating to location of improvements.

I certify that I have read this application and state that all information is correct. I agree to comply with all city and county ordinances and state laws relating to building construction and hereby authorize representative(s) of this city to enter upon the abovementioned property for inspection purposes.

Date 6/25/04 Applicant/Agent Signature *[Signature]*

WORKER'S COMPENSATION DECLARATION: I hereby affirm under penalty of perjury one of the following declarations:

____ I have and will maintain a certificate of consent to self-insure for workers' compensation as provided for by Section 3700 of the Labor Code, for the performance of work for which the permit is issued.

____ I have and will maintain workers' compensation insurance, as required by Section 3700 of the Labor Code, for the performance of the work for which this permit is issued. My workers' compensation insurance carrier and policy number are:

Carrier AMERICAN CASULTY CO Policy Number WC247856876 Exp Date 07/01/2004

____ (This section need not be completed if the permit is for \$100 or less) I certify that in the performance of the work for which this permit is issued, I shall not employ any person in any manner so as to become subject to the workers' compensation laws of California and agree that if I should become subject to the workers' compensation provisions of Section 3700 of the Labor Code, I shall forthwith comply with those provisions.

Date 6/25/04 Applicant Signature *[Signature]*

WARNING: FAILURE TO SECURE WORKER'S COMPENSATION COVERAGE IS UNLAWFUL AND SHALL SUBJECT AN EMPLOYER TO CRIMINAL PENALTIES AND CIVIL FINES UP TO ONE HUNDRED THOUSAND DOLLARS (\$100,000) IN ADDITION TO THE COST OF COMPENSATION, DAMAGES AS PROVIDED FOR IN SECTION 3706 OF THE LABOR CODE, INTEREST AND ATTORNEY'S FEE.

THIS PERMIT SHALL EXPIRE BY LIMITATION IF WORK IS NOT COMMENCED WITHIN 180 DAYS.

THIS PLOT PLAN IS NOT FOR SALES PURPOSES. THIS PLOT PLAN IS FOR THE PURPOSE OF INDICATING COMPLIANCE WITH ZONING SET BACKS, GENERAL DRAINAGE AND APPROXIMATE UTILITY CONNECTION, ALL OTHER DATA SHOWN HEREON IS CONCEPTUAL. THIS PLOT PLAN DOES NOT REFLECT AS-BUILT CONDITION, RETAINING WALLS ARE OPTIONAL, AND MAY OR MAY NOT BE CONSTRUCTED.

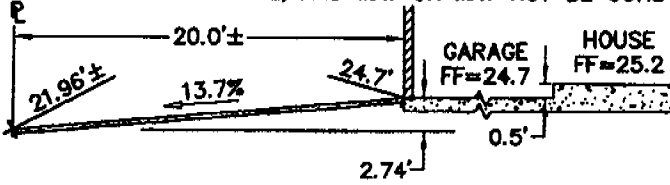

DRIVEWAY CENTERLINE PROFILE (NOT TO SCALE)

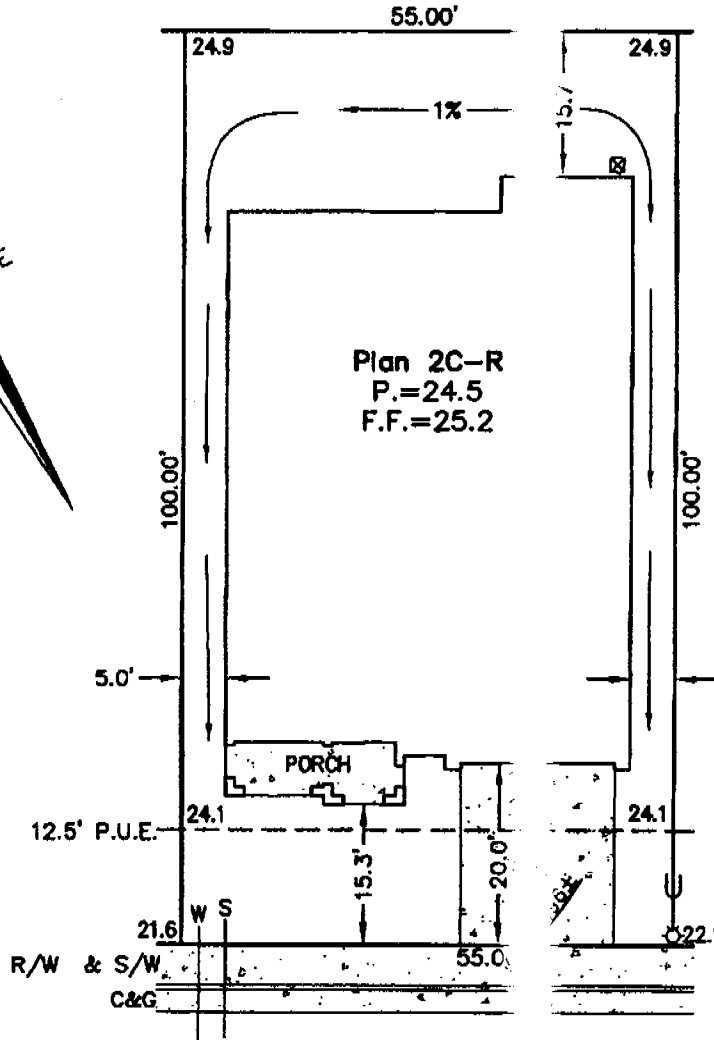
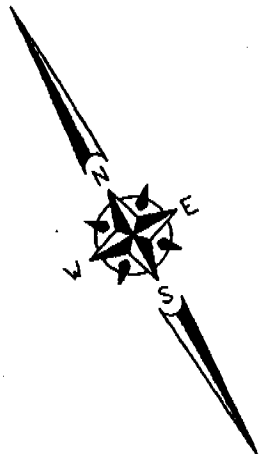

Chango Circle

This set of plans and specifications shall be kept on the job of the project until the project is completed. No changes shall be made without the written consent of the Surveyor. The Surveyor shall be responsible for the accuracy of the information provided.

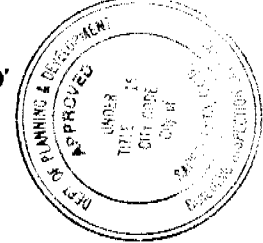

9

SCALE: 1" = 20'

LEGEND

- U - - - - UTILITY LOCATION
- ⊗ - - - - AIR CONDITIONER
- S - - - - SEWER
- W - - - - WATER
- ⊙ - - - - STREET LIGHT

NET LOT AREA = 5,500 SQ. FEET
FOOTPRINT AREA = 2,700 SQ. FEET
LOT COVERAGE = 49%

PLOT PLAN
LOT 1191
Natomas Creek Village 1
Palisades - Phase 1
City of Sacramento, State of California

WECKER SURVEYS
1111 KENNEDY PLACE
SUITE 4
DAVIS, CA 95616
530-792-7252
FAX 530-758-2775

CERTIFICATION OF INSULATION

| | | | | | | | | | | | | | | | | | | | | | |
|--|--|----|-------------------|-------------------------------------|---------|--------------|--|--|--|----|----|----|------|--|--|--|--|--|----|----|----|
| PART I GENERAL | ADDRESS | | | SACRAMENTO BUILDING PROJECT | | | | | | | | | | | | | | | | | |
| | <p style="font-size: 2em; font-family: cursive;">D.R. Horton</p> <p style="font-size: 2em; font-family: cursive;">Palisades</p> | | | LOT # 1191 | | | <input type="checkbox"/> P.O. BOX 854, WEST SACRAMENTO, CA 95691 LIC. #202026 <input type="checkbox"/> 1309 MELODY ROAD, MARYSVILLE, CA 95901 LIC. #202026 <input type="checkbox"/> P.O. BOX 9651, FRESNO, CA 93793-9651 LIC. #202026 <input checked="" type="checkbox"/> P.O. BOX 1631, RENO, NV 89505 LIC. #10675 <input type="checkbox"/> 3326 A PONDEROSA WAY, LAS VEGAS, NV 89118 LIC. #10675 | | | | | | | | | | | | | | |
| DATE INSULATION COMPLETED | | | | | | | | | | | | | | | | | | | | | |
| PART II AREAS INSULATED | WALLS | | | CEILING | | | FLOORS | | | | | | | | | | | | | | |
| | (SQUARE FEET) | | | (SQUARE FEET) | | | (SQUARE FEET) | | | | | | | | | | | | | | |
| | MATERIAL FIBERGLASS | | | MATERIAL FIBERGLASS | | | MATERIAL FIBERGLASS | | | | | | | | | | | | | | |
| | FORM BATTS | | | FORM BATTS & BLOW | | | FORM BATTS | | | | | | | | | | | | | | |
| | MANUFACTURER'S PRODUCT I.D. | | | MANUFACTURER'S PRODUCT I.D. | | | MANUFACTURER'S PRODUCT I.D. | | | | | | | | | | | | | | |
| | <table border="1" style="width: 100%; border-collapse: collapse;"> <tr> <td style="width: 33%;">CT</td> <td style="width: 33%;">OC</td> <td style="width: 33%;">JM</td> </tr> </table> | | | CT | OC | JM | <table border="1" style="width: 100%; border-collapse: collapse;"> <tr> <td style="width: 33%;">CT</td> <td style="width: 33%;">OC</td> <td style="width: 33%;">JM</td> </tr> <tr> <td colspan="3" style="text-align: center; font-size: small;">BAGS</td> </tr> </table> | | | CT | OC | JM | BAGS | | | <table border="1" style="width: 100%; border-collapse: collapse;"> <tr> <td style="width: 33%;">CT</td> <td style="width: 33%;">OC</td> <td style="width: 33%;">JM</td> </tr> </table> | | | CT | OC | JM |
| | CT | OC | JM | | | | | | | | | | | | | | | | | | |
| | CT | OC | JM | | | | | | | | | | | | | | | | | | |
| | BAGS | | | | | | | | | | | | | | | | | | | | |
| | CT | OC | JM | | | | | | | | | | | | | | | | | | |
| R VALUE | | | R VALUE | | | R VALUE | | | | | | | | | | | | | | | |
| APPLIED | | | APPLIED | | | APPLIED | | | | | | | | | | | | | | | |
| 13 19 3 1/2 | | | 5 1/2 30 | | | 9" 12" | | | | | | | | | | | | | | | |
| MATERIAL FIBERGLASS | | | FORM BATTS | | | R VALUE | | | | | | | | | | | | | | | |
| CT | | | OC | | | JM | | | | | | | | | | | | | | | |
| AIR INFILTRATION SEALANT | | | | | | | | | | | | | | | | | | | | | |
| MATERIAL <i>foam</i> | | | | | | MANUFACTURER | | | | | | | | | | | | | | | |
| HILTI | | | | | | HANDY FOAM | | | | | | | | | | | | | | | |
| THIS IS TO CERTIFY THAT INSULATION AND/OR SEALANT HAS BEEN INSTALLED IN CONFORMANCE WITH APPLICABLE CODES, MATERIAL STANDARDS AND REGULATIONS. | | | | | | | | | | | | | | | | | | | | | |
| SIGNATURE — INSULATION CONTRACTOR | | | | | TITLE | | DATE | | | | | | | | | | | | | | |
| <i>[Signature]</i> | | | | | MANAGER | | 10/14/04 | | | | | | | | | | | | | | |
| SIGNATURE — GENERAL CONTRACTOR | | | | | TITLE | | DATE | | | | | | | | | | | | | | |
| <i>[Signature]</i> | | | | | | | | | | | | | | | | | | | | | |
| REMARKS | | | | | | | | | | | | | | | | | | | | | |

BUILDER COPY

**WESTERN ONE STUCCO SYSTEM
SACRAMENTO STUCCO PRODUCTS CO., INC.**

Job Address:

ICBO Evaluation Services, Inc.

DRH-PALISADES

Report No. 3899

Lot 1191 120 Chango Cir

Date of Job Completion: 09-17-04

Plaster Contractor

Name: TOLIVER PLASTERING, INC.

Address: 3346 Luyung Dr., Rancho Cordova, CA 95742

Telephone Number: (916) 631-9844

Approved Applicator's License Number as
Issued by Western Stucco Products 507

This is to certify that the plastering system on the building exterior at the above address has been installed in accordance with the evaluation report specified above and the manufacturer's instructions.

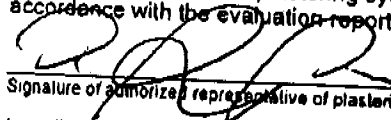
Signature of authorized representative of plastering contractor

Date 10-29-04

Installation card must be presented to the building inspector
After completion of work and before final inspection.

No. DRH-1191



WALLACE • KUHL & ASSOCIATES INC.
 GEOTECHNICAL ENGINEERING • CONSTRUCTION TESTING

3050 Industrial Blvd
 PO Box 113
 West Sacramento
 California 95699
 916-372-1433

| | | | | | | | | |
|--|----------|--|-----------|--|--------|--|-------|----------|
| DATE 3-13-76 | | JOB NO. 5406 W | | WEATHER Hot | | TEMP. ° at ° at | | AM PM |
| PROJECT Nacoma Concrete DP Hazard | | | | Technician I <input checked="" type="checkbox"/> | | Staff E/G <input type="checkbox"/> | | |
| LOCATION Lot # 1191 Palisades @ Univ Circle | | | | Technician II <input type="checkbox"/> | | Project E/G <input type="checkbox"/> | | |
| TYPE OF WORK Pull Test | | | | Technician III <input type="checkbox"/> | | Senior E/G <input type="checkbox"/> | | |
| Inside 50 mi. radius <input checked="" type="checkbox"/> | | Outside 50 mi. radius <input type="checkbox"/> | | Nuclear Densities <input type="checkbox"/> | | Principal E/G <input type="checkbox"/> | | |
| PERSONNEL | REG. HRS | OT HRS | TOTAL HRS | TRAVEL | ON JOB | VEHICLE | MILES | |
| Jose Matamoros | | | | | | 1551 | 24 | |

OBSERVATIONS:
 Tested 7/8" All thread anchor bolts for P106
 Hazardous to 5360' (24" P106) per
 per Simpson Bolt.

| # Bolts | Size | Location | Passed / Rejected |
|-------------|------|-----------------|-------------------|
| 2 7/8" P106 | 1191 | Major Hazardous | PASSED |

△ All Tested passed with BLUE

FIELD REPORT

Signed

CERTIFICATION OF INSULATION

FACT GENERAL

D.R. Horton LOT # 1191
Palisades

- P.O. BOX 854, WEST SACRAMENTO, CA 95691 LIC. #202026
- 1308 MELODY ROAD, MARYSVILLE, CA 95901 LIC. #202026
- P.O. BOX 9651, FRESNO, CA 93793-9651 LIC. #202026
- P.O. BOX 1631, RENO, NV 89505 LIC. #10675
- 3326 A PONDEROSA WAY, LAS VEGAS, NV 89118 LIC. #10675

DATE INSULATION COMPLETED

| SQUARE FEET) | SQUARE FEET) | SQUARE FEET) |
|----------------------------|------------------------------|----------------------------|
| MATERIAL FIBERGLASS | MATERIAL FIBERGLASS | MATERIAL FIBERGLASS |
| FORM BATTS | FORM BATTS & BLOW | FORM BATTS |
| MANUFACTURERS PRODUCT I.D. | MANUFACTURERS PRODUCT I.D. | MANUFACTURERS PRODUCT I.D. |

| CT | OC | JM | CT | OC | JM | CT | OC | JM |
|----|----|----|------|----|----|----|----|----|
| | | | BAGS | | | | | |

| | | | | | | | | |
|----|----|-------|----|----|----|--|--|--|
| 12 | 19 | 3 1/2 | 52 | 30 | 7" | | | |
|----|----|-------|----|----|----|--|--|--|

| MATERIAL | FORM | R VALUE | MANUFACTURER | | |
|-------------------|--------------|---------|--------------|----|----|
| FIBERGLASS | BATTS | | CT | OC | JM |

| MATERIAL | MANUFACTURER | |
|-------------|--------------|-------------------|
| <i>Foam</i> | HILTI | HANDY FOAM |

| | | |
|-----------------------------------|----------------|-----------------|
| SIGNATURE — INSULATION CONTRACTOR | TITLE | DATE |
| <i>[Signature]</i> | MANAGER | <i>10/14/04</i> |
| SIGNATURE — GENERAL CONTRACTOR | TITLE | DATE |
| | | |

REMARKS

ATTIC COPY



WALLACE • KUHL & ASSOCIATES INC.
 GEOTECHNICAL ENGINEERING • CONSTRUCTION TESTING

3050 Industrial Blvd.
 PO Box 1137
 West Sacramento
 California 95691
 916-372-1434

| | | | | | | | | |
|--|--|--|--------|--|--------|--|---------|----------|
| DATE 8-18-04 | | JOB NO. 3400.10 | | WEATHER Hot | | TEMP. ° F ° C | | AM PM |
| PROJECT Narciso - Crossroad D.R. Heron | | | | Technician I <input checked="" type="checkbox"/> | | Staff E/G <input type="checkbox"/> | | |
| LOCATION Lot #1191 Palisade @ Chang Circle | | | | Technician II <input type="checkbox"/> | | Project E/G <input type="checkbox"/> | | |
| TYPE OF WORK Pull Test | | | | Technician III <input type="checkbox"/> | | Senior E/G <input type="checkbox"/> | | |
| Inside 50 ml. radius <input checked="" type="checkbox"/> | | Outside 50 ml. radius <input type="checkbox"/> | | Nuclear Densities <input type="checkbox"/> | | Principal E/G <input type="checkbox"/> | | |
| PERSONNEL | | REG. HRS | OT HRS | TOTAL HRS | TRAVEL | ON JOB | VEHICLE | MILES |
| Jose Matamoros | | | | | | | # 51 | 20 |

OBSERVATIONS:
 Tested 7/8" All thread anchor bolts for PHD 6
 Holdown to 5860 Pounds of Tension (2400PSI sep IV)
 per Simpson Book.

| # Bolts | lot# | location | PASSED / FAILED |
|--------------|------|-----------------|-----------------|
| 2 7/8" PHD 6 | 1191 | Master Bathroom | PASSED. |

- All Tested painted WK BLUE

FIELD REPORT

Signed _____