

CITY OF SACRAMENTO

1231 I Street, Sacramento, CA 95814

Permit No: 0013669

Insp Area: 4

Site Address: 2036 FENMORE WY SAC

Parcel No: 225-1370-045

NORTHPT PK 7 LOT 45

Sub-Type: NSFR

Housing (Y/N): N

CONTRACTOR

JOHN LAING HOMES
2150 PROFESSIONAL DR. #120
ROSEVILLE CA 95661

OWNER

ARCHITECT

Nature of Work: MP 1630 1 STORY 8 ROOM SFR

CONSTRUCTION LENDING AGENCY : I hereby affirm under penalty of perjury that there is a construction lending agency for the performance of the work for which this permit is issued (Sec. 3097, Civ. C).

Lender's Name _____ Lender's Address _____

LICENSED CONTRACTORS DECLARATION: I hereby affirm under penalty of perjury that I am licensed under provisions of Chapter 9 (commencing with section 7000) of Division 3 of the Business and Professions Code and my license is in full force and effect.

License Class: B License Number: 687596 Date: 11/28/00 Contractor Signature: N. Collins

OWNER-BUILDER DECLARATION: I hereby affirm under penalty of perjury that I am exempt from the contractors License Law for the following reason (Sec. 7031.5, Business and Professions Code: any city or county which requires a permit to construct, alter, improve, demolish, or repair any structure, prior to its issuance, also requires the applicant for such permit to file a signed statement that he or she is licensed pursuant to the provisions of the Contractors License Law (Chapter 9 (commencing with Section 7000) of Division 8 of the Business and Professions Code) or that he or she is exempt therefrom and the basis for the alleged exemption. Any violation of Section 7031.5 by any applicant for a permit subjects the applicant to a civil penalty of not more than five hundred dollars (\$500.00).

_____, I, as a owner of the property, or my employees with wages as their sole compensation, will do the work, and the structure is not intended or offered for sale (Sec. 7044, Business and Professional Code: The Contractors License Law does not apply to an owner of property who builds or improves thereon, and who does such work himself or herself or through his/her own employees, provided that such improvements are not intended or offered for sale. If, however, the building or improvement is sold within one year of completion, the owner-builder will have the burden of proving that he/she did not build or improve for the purpose of sale.)

_____, I, as owner of the property, am exclusively contracting with licensed contractors to construct the project (Sec. 7044, Business and Professions Code: The Contractors License Law does not apply to an owner of property who builds or improves thereon, and who contracts for such projects with a contractor(s) licensed pursuant to the Contractors License Law)

_____, I am exempt under Sec. _____ B & PC for this reason: _____

Date _____ Owner Signature _____

IN ISSUING THIS BUILDING PERMIT, the applicant represents, and the city relies on the representation of the applicant, that the applicant verified all measurements and locations shown on the application or accompanying drawings and that the improvement to be constructed does not violate any law or private agreement relating to permissible or prohibited locations for such improvements. This building permit does not authorize any illegal location of any improvement or the violation of any private agreement relating to location of improvements.

I certify that I have read this application and state that all information is correct. I agree to comply with all city and county ordinances and state laws relating to building construction and hereby authorize representative(s) of this city to enter upon the abovementioned property for inspection purposes.

Date: 11/28/00 Applicant/Agent Signature: N. Collins

WORKER'S COMPENSATION DECLARATION: I hereby affirm under penalty of perjury one of the following declarations:

_____, I have and will maintain a certificate of consent to self-insure for workers' compensation as provided for by Section 3700 of the Labor Code, for the performance of work for which the permit is issued

I have and will maintain workers' compensation insurance, as required by Section 3700 of the Labor Code, for the performance of the work for which this permit is issued. My workers' compensation insurance carrier and policy number are:

Carrier: EAGLE PACIFIC INSURANCE COMPAN Policy Number: 1S0002200 Exp Date: 04/15/2001

_____, (This section need not be completed if the permit is for \$100 or less) I certify that in the performance of the work for which this permit is issued, I shall not employ any person in any manner so as to become subject to the workers' compensation laws of California and agree that if I should become subject to the workers' compensation provisions of Section 3700 of the Labor Code, I shall forthwith comply with those provisions.

Date: 11/28/00 Applicant Signature: N. Collins

WARNING: FAILURE TO SECURE WORKER'S COMPENSATION COVERAGE IS UNLAWFUL AND SHALL SUBJECT AN EMPLOYER TO CRIMINAL PENALTIES AND CIVIL FINES UP TO ONE HUNDRED THOUSAND DOLLARS (\$100,000) IN ADDITION TO THE COST OF COMPENSATION, DAMAGES AS PROVIDED FOR IN SECTION 3706 OF THE LABOR CODE, INTEREST AND ATTORNEY'S FEE.

THIS PERMIT SHALL EXPIRE BY LIMITATION IF WORK IS NOT COMMENCED WITHIN 180 DAYS.

RESIDENTIAL BUILDING PERMIT APPLICATION

New Construction Addition Remodels Other

Project Address: 2036 Fenmore Way Assessor Parcel # 225-1370-045

OWNER INFORMATION: Lot 45

Legal Property Owner: John Laing Homes Phone # 780-1222
Owner Address: 1536 Curika Rd. #100 City Roseville State Ca Zip 95661

CONTRACTOR INFORMATION: Northpointe Park Unit #7

Contractor: John Laing Homes Lic. # 687596 Phone # 780-1222 Fax# 780-1333

PROJECT INFORMATION:

Land Use Zone _____ Occupancy Group _____ Construction Type VN Fed Code A1

No. of stories: 1 No. of rooms: 8 Street width: _____

1st Floor Area 1630 2nd Floor Area _____ Basement _____ Roof Material _____

AREA IN SQUARE FOOT OF:	EXISTING	NEW
Dwelling/Living	_____	<u>1630</u>
Garage/Storage	_____	<u>416</u>
Decks/Balconies	_____	<u>48</u>
Carports	_____	_____

SCOPE OF WORK: _____

FOR OFFICE USE ONLY:

- Information above complete AR Flood Waiver required Planning Approval
- Violation files checked Flood Elevation Certificate Required Design Review Approval
- Standard setbacks Water Development Infill Area Special Fee Districts Apply : _____
- County Sewer

NEW STRUCTURES & ADDITIONS

❖ THE FOLLOWING MUST BE PROVIDED IN ORDER TO SUBMIT FOR PLAN REVIEW

- 2 COMPLETE PLANS, LEGIBLE & DRAWN TO SCALE ❖ Plans to include: site plan, floor plan, elevations, roof/ceiling plan, foundation and structural framing details, and structural calculations for non-conforming structures.
- 3 SETS IF PROJECT IS IN A DESIGN REVIEW AREA
- Title 24 Energy Compliance documentation 11" x 17" copy of floor plan for County Assessor
- Grading and Erosion Control Questionnaire Plan Review Fees

Date: _____ Received by: (staff) _____

ACTIVITY/PERMIT # _____

OMEGA PRODUCTS INTERNATIONAL, INC.

lot # 45

DIAMOND WALL INSULATING STUCCO SYSTEM

JOB ADDRESS:

ICBO Report #4004

JOHN KAINO INSPIRATION
2036 FENMORE WY, SACRAMENTO, CALIF.
95835

Date of Job Completion 8/22/00

PLASTERING CONTRACTOR:

Name: STUCCO WORKS INC
Address: 5900 WARE HOUSE WAY SACRAMENTO CA 9
Telephone No: (916) 383 66 99
Contractor Number of Diamond Wall System R175

This is to certify that the exterior coating system on the building exterior at the above address has been installed in accordance with the evaluation report specified above and the manufacturer's instructions.

8/25/00
Date

[Signature]
Signature of authorized representative of
Plastering Contractor

This installation card must be presented to the building inspector after completion of work and before final inspection.

INSULATION CERTIFICATE

THIS IS TO CERTIFY THAT INSULATION HAS BEEN INSTALLED IN CONFORMANCE WITH THE CURRENT ENERGY REGULATIONS, CALIFORNIA ADMINISTRATION CODE, TITLE 24, STATE OF CALIFORNIA, IN THE BUILDING LOCATED AT:

SITE ADDRESS: lot 45 inspiration @ Natomas Park Natomas, CA
NUMBER STREET CITY STATE
2036 PERMANENT WAY FACED CA 95855

CEILINGS:

BLOW: Manufacturer Greenstone Thickness 8.1" R/Value 30
Square Feet 1202 # Bags/Lbs. per bags 40

BATTS: Manufacturer Johns Manville Thickness 10.25" R/Value 30

EXTERIOR WALLS:

Manufacturer Johns Manville Thickness 3.5" R/Value 13

FLOOR INSULATION:

Manufacturer Johns Manville Thickness 3.5" R/Value 13

AIR INFILTRATION: (TITLE 24)

Yes ~~XXXX~~ No _____

OTHER:

GENERAL CONTRACTOR: John Lang Homes LIC. # _____

BY: Earl M... TITLE Superintendent DATE 6-18-01

INSULATION CONTRACTOR: Western Insulation, Inc. LIC. # 481278

BY: James Blair TITLE Auth. Agent DATE 4/10/00

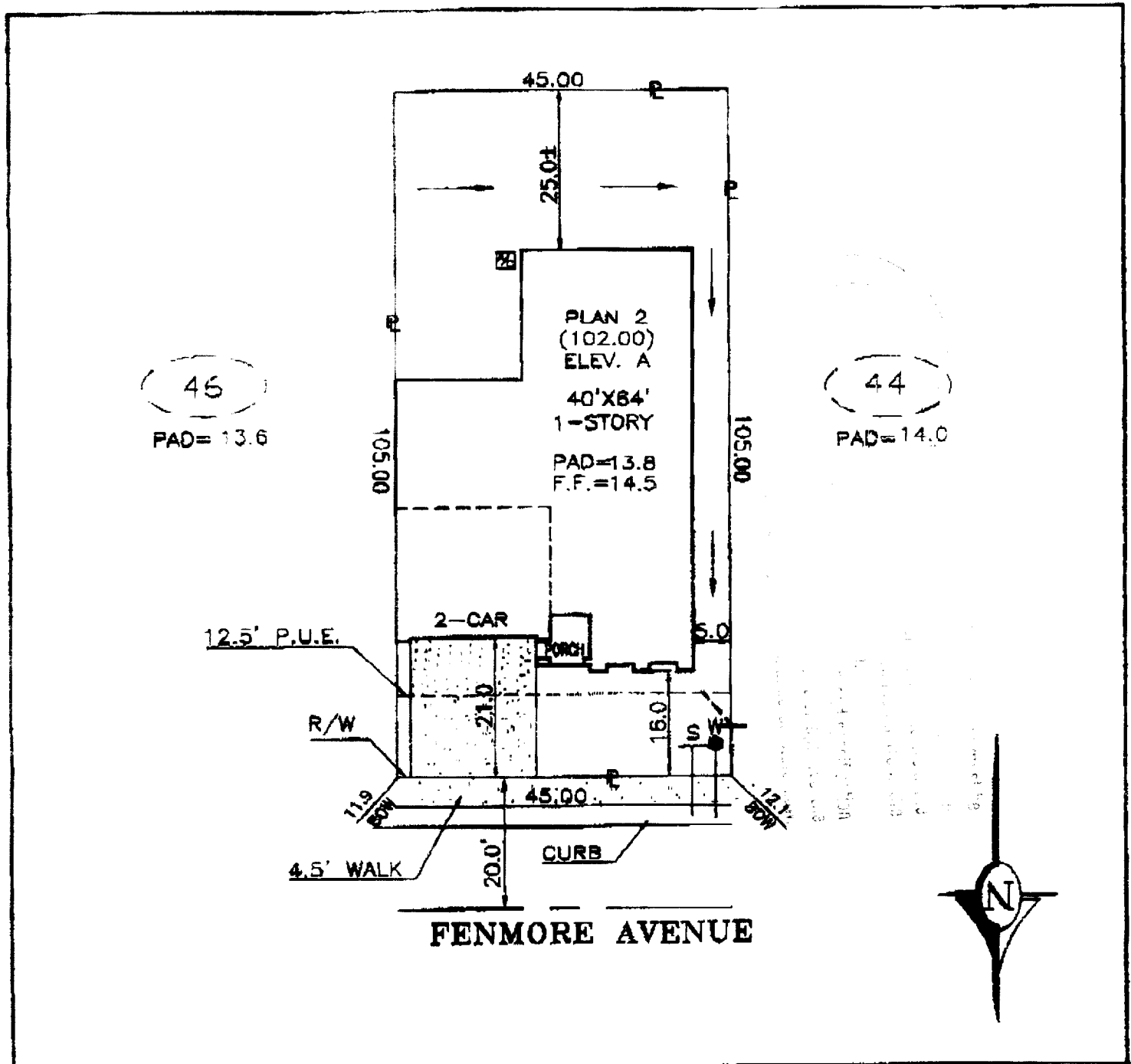

45
PAD=13.6

44
PAD=14.0

DIMENSIONS SHOWN ARE APPROXIMATE EXCEPT FOR MINIMUMS REQUIRED BY ORDINANCE.
THIS PLOT DOES NOT REFLECT AS BUILT CONDITIONS AND MAY VARY FROM THIS PLAN.

John Laing Homes 1536 HUNTER ROAD SUITE 100 ROSEVILLE, CALIFORNIA 95681 (TEL.) 916-780-1222 (FAX.) 916-780-1333		INSPIRATION		PLOT PLAN
		NORTHPOINTE PARK UNIT 7A		
ADDRESS: FENMORE AVENUE		LOT COV: 44.3 % APN:		LOT 45
PLAN NO.: 2-A	LOT SQ. FT.: 4,725.0	REAR YARD COVERAGE: %		
DRAWN BY: R.P.	APPROVED BY:	DATE: 10/13/00	SCALE: 1"=20'	