

City of Sacramento  
Building Division  
2101 Arena Blvd. Suite 200  
Sacramento, CA 95834  
808-2534

**Activity #0009658**

511 L ST  
MAKE CD  
Return to Sender

CONSTRUCTION LENDING AGENCY

I hereby affirm under penalty of perjury that there is a construction lending agency for the performance of the work for which this permit is issued (Sec. 3097, Civ. C).

Lenders Name \_\_\_\_\_  
Lenders Address \_\_\_\_\_

LICENSED CONTRACTORS DECLARATION

I hereby affirm under penalty of perjury that I am licensed under provisions of Chapter 9 (commencing with Section 7000) of Division 3 of the Business and Professions Code and my license is in full force and effect.

License Class E-10 Lic. Number 303019  
Date 8/18/00 Contractor Carl Cook  
(Signature)

OWNER - BUILDER DECLARATION

I hereby affirm under penalty of perjury that I am exempt from the Contractors License Law for the following reason (Sec. 7031.5, Business and Professions Code: Any city or county which requires a permit to construct, alter, improve, demolish, or repair any structure, prior to its issuance, also requires the applicant for such permit to file a signed statement that he or she is licensed pursuant to the provisions of the Contractors License Law (Chapter 9 (commencing with Section 7000) of Division 3 of the Business and Professions Code) or that he or she is exempt therefrom and the basis for the alleged exemption. Any violation of Section 7031.5 by any applicant for a permit subjects the applicant to a civil penalty of not more than five hundred dollars (\$500.00):

I, as owner of the property, or my employees with wages as their sole compensation, will do the work, and the structure is not intended or offered for sale (Sec. 7044, Business and Professions Code: The Contractors License Law does not apply to an owner of property who builds or improves thereon, and who does such work himself or herself or through his or her own employees, provided that such improvements are not intended or offered for sale. If, however, the building or improvement is sold within one year of completion, the owner-builder will have the burden of proving that he or she did not build or improve for the purpose of sale.)

I, as owner of the property, am exclusively contracting with licensed contractors to construct the project (Sec. 7044, Business and Professions Code: The Contractors License Law does not apply to an owner of property who builds or improves thereon, and who contracts for such projects with a contractor(s) licensed pursuant to the Contractors License Law).

I am exempt under Sec. \_\_\_\_\_ B & P C for this reason \_\_\_\_\_

Date \_\_\_\_\_ Owner \_\_\_\_\_ (Signature)

In issuing this building permit, the applicant represents, and the City relies on the representation of the applicant, that the applicant verified all measurements and locations shown on the application or accompanying drawings and that the improvement to be constructed does not violate any law or private agreement relating to permissible or prohibited locations for such improvements. This building permit does not authorize any illegal location of any improvement or the violation of any private agreement relating to location of improvements.

I certify that I have read this application and state that all information is correct. I agree to comply with all city and county ordinances and state laws relating to building construction and hereby authorize representative of this city to enter upon the aforementioned property for inspection purposes.

Date 8/18/00 Signature of Applicant or Agent Carl Cook

SITE ADDRESS

SUITE

INSP. AREA

511 & 8th St. 006-0087-031 /  
PARCEL NO. 286-022-DH PERMIT NO. 0069658

NAME OF APPLICANT

ADDRESS

ZIP CODE

PHONE NO.

LICENSED CONTRACTOR

P.O. Box 15100

95851

927 0527

BUSINESS OWNER  
Tacific Neon

Sac Ca

95851

927 0527

Greibitus & Sons

SIGN INFORMATION

- ATTACHED  INTERIOR / ELECT.  SINGLE FACED
- ILLUMINATED  NON-ILLUMINATED  BILLBOARD / SUBDIVISION
- INDIVIDUAL LETTERS  PAINTED ON BUILDING  LOGO
- METAL  POLE  DOUBLE FACED
- PLASTIC  MONUMENT  VENTILATOR FOAM
- WOODEN  PROJECTING  RE-FACE

SIGN COPY Greibitus & Sons  
Fine Jewelry & Gifthouse

521309

CITY OF SACRAMENTO PERMIT SERVICES  
BUILDING INSPECTION DIVISION 264-7619

WORKERS COMPENSATION DECLARATION

I hereby affirm under penalty of perjury one of the following declarations:

I have and will maintain a certificate of consent to self-insure for workers' compensation as provided for by Section 3700 of the Labor Code, for the performance of work for which the permit is issued.

I have and will maintain workers' compensation insurance as required by Section 3700 of the Labor Code, for the performance of the work for which this permit is issued. My workers' compensation insurance carrier and policy number are:

Carrier State Fund  
Policy Number 478-00

(This section need not be completed if the permit is for one hundred dollars (\$100) or less) I certify that in the performance of the work for which this permit is issued, I shall not employ any person in any manner so as to become subject to the workers' compensation laws of California and agree that if I should become subject to the workers' compensation provisions of Section 3700 of the Labor Code, I shall forthwith comply with those provisions.

Date: 8/18/00 Applicant: Carl Cook  
(Signature)

WARNING: FAILURE TO SECURE WORKERS' COMPENSATION COVERAGE IS UNLAWFUL AND SHALL SUBJECT AN EMPLOYER TO CRIMINAL PENALTIES AND CIVIL FINES UP TO ONE HUNDRED THOUSAND DOLLARS (\$100,000) IN ADDITION TO THE COST OF COMPENSATION, DAMAGES AS PROVIDED FOR IN SECTION 3706 OF THE LABOR CODE, INTEREST AND ATTORNEY'S FEES.

THIS PERMIT SHALL EXPIRE BY LIMITATION IF WORK AUTHORIZED IS NOT COMMENCED WITHIN 180 DAYS.

(A) HEIGHT <u>3'-11"</u>	(B) LENGTH <u>7'-11"</u>
(A X B) SIGN AREA <u>32</u>	
POLE SIZE _____	FOOTING SIZE _____
STREET FRONTAGE (FT) <u>60'</u>	
OCCUPANCY FRONTAGE (FT) _____	
ENGINEERING REQUIRED? YES NO APPROVED BY _____	
DESIGN REVIEW REQUIRED? YES NO APPROVED BY _____	
SPECIAL PERMIT REQUIRED? YES NO # _____	
VARIANCE REQUIRED? YES NO # _____	
LOCATED IN PUD? YES NO WHICH PUD? _____	
SIGN VALUATION	
A. TYPE OF SIGN <u>RE-FACE</u>	
B. \$ _____ PER SQ. FT. X _____ SQ. FT. = \$ _____	
APPROVED BY <u>MSL</u> DATE <u>8/18/00</u>	
DENIED BY _____ DATE _____	
FINAL INSPECTIONS	
BUILDING INSPECTOR _____ DATE _____	
ELECTRICAL INSPECTOR <u>J. MOORE</u> DATE <u>1-30-01</u>	
SIGN INSPECTOR _____ DATE _____	
FEES:	
CITY OF SACRAMENTO	RECEIVED
DATE	AMOUNT
SIGN APPLICATION FEE _____	
SIGN PERMIT FEE <u>AUGUST 2000</u>	
ELECTRICAL INSPECTION FEE <u>2000</u>	
CITY BUSINESS LICENSE FEE _____	
OTHER _____	
TOTAL \$ _____	



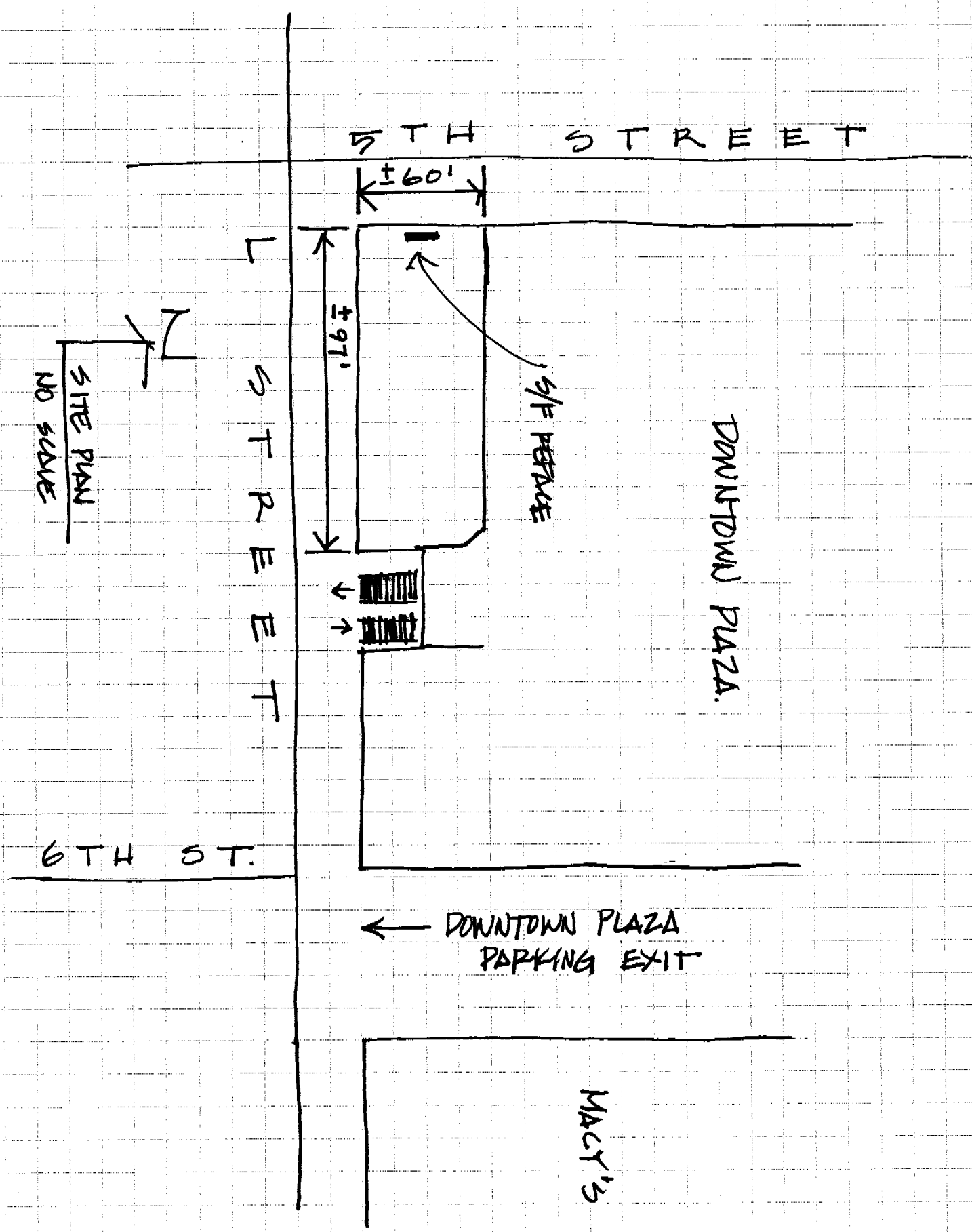

5TH STREET

$\pm 60'$

L STREET

$\pm 97'$

SITE OFFICE

DOWNTOWN PLAZA.

SITE PLAN  
NO SCALE

6TH ST.

← DOWNTOWN PLAZA  
PARKING EXIT

MACY'S