

NATOMAS UNIFIED SCHOOL DISTRICT

1515 Sports Drive, #1 • Sacramento, CA 95834

Phone 916/641-3300 • Fax 916/928-1629

CERTIFICATION OF COMPLIANCE

SCHOOL DISTRICT DEVELOPMENT FEES

PART I: TO BE COMPLETED BY APPLICANT			
PROPERTY OWNER'S NAME	Epic Homes #1 LLC		
OWNER'S ADDRESS	1263 The Esplanade Ste. C. Chico, Ca 95926		
PROJECT ADDRESS	10 Heathmore Ct. lot 59		
PARCEL NUMBER	274 - 0070 - 034		
SUBDIVISION NAME	Heritage Place / RiverGate		
NUMBER OF UNITS	173		
PRINT APPLICANT'S NAME	Bert Witzelberger	APPLICANT'S SIGNATURE:	
TITLE OF APPLICANT	Job Supt.		
DATE	4/6/99	TELEPHONE NUMBER	(530) 591-4757
PART II: TO BE COMPLETED BY BUILDING DEPARTMENT			
PLAN IDENTIFICATION NUMBER	M.P. 1314		
BUILDING TYPE (CHECK ONE)	<input checked="" type="checkbox"/> RESIDENTIAL <input type="checkbox"/> APARTMENT/CONDOMINIUM <input type="checkbox"/> COMMERCIAL/INDUSTRIAL		
SQUARE FEET OF CHARGEABLE BUILDING AREA	1314		
SIGNATURE			
TITLE	BI III	DATE	4-3-99
PART III: TO BE COMPLETED BY NATOMAS UNIFIED SCHOOL DISTRICT			
DISTRICT CERTIFICATION NUMBER	230		
FEES COLLECTED			
RESIDENTIAL	1314	Sq. Ft. X \$ 1.93	= \$ 2536.02
APARTMENT/CONDOMINIUM		Sq. Ft. X \$	= \$
COMMERCIAL/INDUSTRIAL		Sq. Ft. X \$	= \$

This certification covers only the amount of square footage indicated above. Any additions or corrections to the square footage for this project will require an amendment to the Certificate of Compliance.

As the authorized school district official, I hereby certify that the requirements of Government Code Section 65995 have been complied with by the above signed applicant.

AUTHORIZED SCHOOL DISTRICT OFFICIAL:

SIGNATURE:

TITLE: Facilities Planner

DATE: 4-7-99

COUNTY SANITATION DISTRICT NO. 1
 SACRAMENTO REGIONAL COUNTY SANITATION DISTRICT
SEWER IMPACT FEE
 PERMIT AND CALCULATION SHEET

APPLICATION NO: <u>CITY</u>		BLDG PERMIT NO:	
GENERAL INFORMATION <u>DU 4-7-99</u>		THIS PERMIT GOOD ONLY WHEN VALIDATED BY THE CASHIER <small>REPT 26 TRAM 254014 04/17/99 \$2,855.00</small> <small>RECEIPT 250857 4/17/99</small> THIS PERMIT TO CONNECT EXPIRES ONE YEAR FROM DATE OF ISSUANCE	
FEE CALCULATION		BUILDING USE	
INSPECTION		RESIDENTIAL SF <input checked="" type="checkbox"/> MF <input type="checkbox"/>	
CSD-1	<u>470 -</u>	COMMERCIAL USE	UNITS
SRCSD	<u>2385 -</u>		
CONSTRUCTION			
IN-LIEU			
TOTAL FEE	<u>2855-</u>		
APN: <u>274-0470-033</u>			
DESCRIPTION/ SUBDIVISION <u>Heritage Place / Diverslab</u> LOT: <u>58</u>			
PROPERTY ADDRESS <u>41 Heathmore Ct.</u>			
OWNER <u>Epick Homes #1 LLC</u>			
MAILING ADDRESS <u>1203 The Esplanade Ste. C</u>			
CITY-STATE-ZIP <u>Chico, Ca. 95926</u> PHONE <u>(530) 891-4757</u>			
ADDITIONAL FEES MAY BE DUE IF CHANGES IN USE INCREASE SEWER IMPACT.			
APPLICANT SIGNATURE <u>[Signature]</u>			
CONSOLIDATED UTILITY BILLING USE ONLY			
ACCT _____ INPUT _____ START _____			
BILLING COPY			



INSULATION CONTRACTORS ASSOCIATION OF AMERICA

INSULATION CERTIFICATE
53419

1321 DUKE STREET, SUITE 303 • ALEXANDRIA, VA 22314 • (703) 739-0356

TO CERTIFY THAT INSULATION HAS BEEN INSTALLED IN CONFORMANCE WITH CALIFORNIA REGULATIONS, CALIFORNIA ADMINISTRATIVE CODE, TITLE 24, STATE OF CALIFORNIA, THE BUILDING LOCATED AT:

Block Homes LOT # 59 TRACT #
STREET 10 Heathwood Ct. CITY Santa

EXTERIOR WALLS:

MANUFACTURER CH THICKNESS/TYPE 3/4" R-VALUE 13

CEILING:

BATTS: MANUFACTURER CH THICKNESS/TYPE 10" R-VALUE 30

BLOWN IN: MANUFACTURER CH THICKNESS 12" R-VALUE 30

SQUARE FOOTAGE COVERED 1005 NUMBER OF BAGS USED 18

FLOORS: MANUFACTURER THICKNESS/TYPE R-VALUE

SLAB ON GRADE: MANUFACTURER THICKNESS/TYPE R-VALUE

WIDTH OF INSULATION INCHES

FOUNDATION WALLS: MANUFACTURER THICKNESS/TYPE R-VALUE

GENERAL CONTRACTOR CALIFORNIA CONTRACTORS LICENSE #

DATE

SIGNATURE TITLE

INSULATION CONTRACTOR ARCADE INSULATION CALIFORNIA CONTRACTORS LICENSE #283784

DATE 10-1-99

SIGNATURE Blaw TITLE

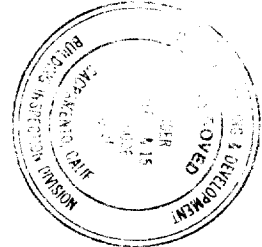
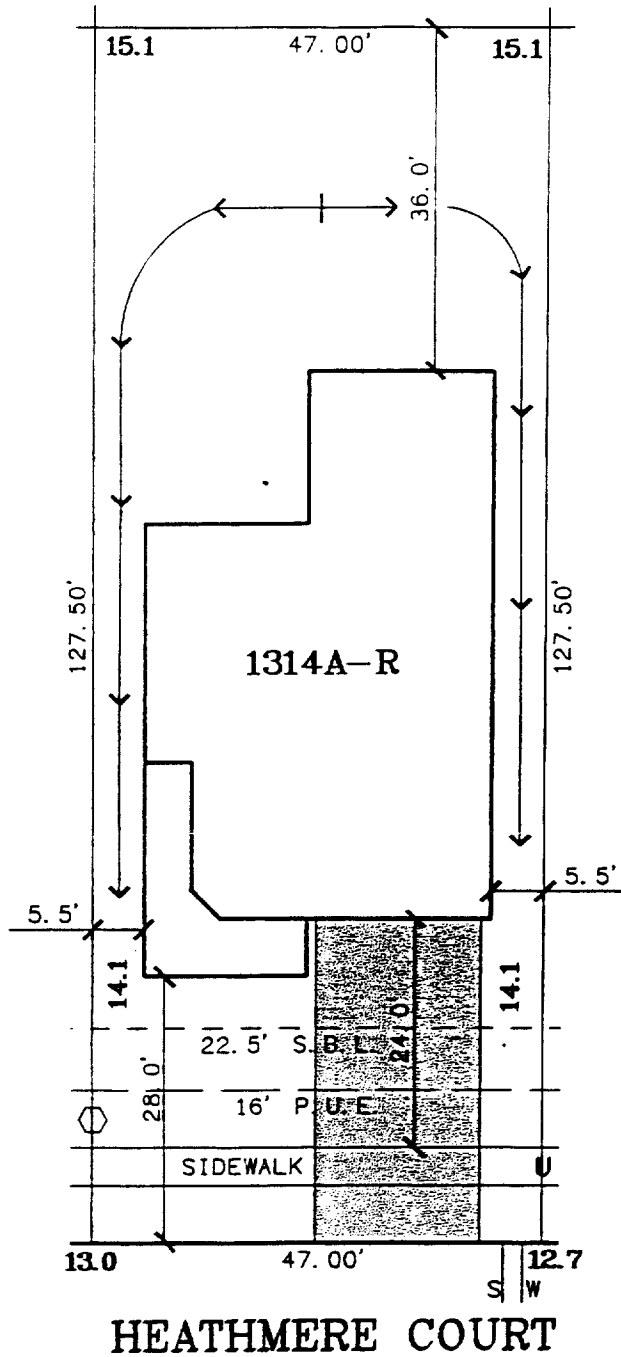

This set of plans and specifications must be kept on the job at all times and it is unlawful to make any changes or alterations from the same without written permission from the Building Inspection Division.

The approval of this plan and specification SHALL NOT be held to permit or approve the violation of any City Ordinance or State Law.

SCALE: 1" = 20'

LOT AREA: 5,992 SQ.FT.

DRAWN: 3-4-99 REV

A. P. N. :

ADDRESS : HEATHMERE COURT

APPROVED BY _____

The Spink Corporation
 2590 VENTURE OAKS WAY
 SACRAMENTO, CA 95833
 PH:(916)925-5550 FAX:(916)921-9274

HERITAGE PLACE
UNIT NO. 2
LOT 59
PLAN 1314A

RIVERSGATE

CITY OF SACRAMENTO, CA.
 CLIENT: EPICK HOMES #1, L.L.C.
 JOB NO.: 2808-004