

CITY OF SACRAMENTO
1231 I Street, Sacramento, CA 95814

Permit No: 0406172
Insp Area: 4
Thos Bros: 256H4

Site Address: 35 TAJO CT SAC
Parcel No: 201-0980-028
N

NATOMAS CREEK VIL. 1 LOT 28

Sub-Type: NSFR
Housing (Y/N):

CONTRACTOR
D. R. HORTON INC.
4401 HAZEL AVE STE 135
FAIR OAKS, CA 95628

OWNER

ARCHITECT

Nature of Work: MP2494 2 STORY 9 ROOM SFR

CONSTRUCTION LENDING AGENCY : I hereby affirm under penalty of perjury that there is a construction lending agency for the performance of the work for which this permit is issued (Sec. 3097, Civ. C).

Lender's Name _____ Lender's Address _____

LICENSED CONTRACTORS DECLARATION: I hereby affirm under penalty of perjury that I am licensed under provisions of Chapter 9 (commencing with section 7000) of Division 3 of the Business and Professions Code and my license is in full force and effect.

License Class _____ License Number 750190 Date 4-30-04 Contractor Signature *del fardid*

OWNER-BUILDER DECLARATION: I hereby affirm under penalty of perjury that I am exempt from the contractors License Law for the following reason (Sec. 7031.5, Business and Professions Code; any city or county which requires a permit to construct, alter, improve, demolish, or repair any structure, prior to its issuance, also requires the applicant for such permit to file a signed statement that he or she is licensed pursuant to the provisions of the Contractors License Law (Chapter 9 (commencing with Section 7000) of Division 8 of the Business and Professions Code) or that he or she is exempt therefrom and the basis for the alleged exemption. Any violation of Section 7031.5 by any applicant for a permit subjects the applicant to a civil penalty of not more than five hundred dollars (\$500.00);

____ I, as a owner of the property, or my employees with wages as their sole compensation, will do the work, and the structure is not intended or offered for sale (Sec. 7044, Business and Professional Code: The Contractors License Law does not apply to an owner of property who builds or improves thereon, and who does such work himself or herself or through his/her own employees, provided that such improvements are not intended or offered for sale. If, however, the building or improvement is sold within one year of completion, the owner-builder will have the burden of proving that he/she did not build or improve for the purpose of sale.)

____ I, as owner of the property, am exclusively contracting with licensed contractors to construct the project (Sec. 7044, Business and Professions Code: The Contractors License Law does not apply to an owner of property who builds or improves thereon, and who contracts for such projects with a contractor(s) licensed pursuant to the Contractors License Law).

____ I am exempt under Sec. _____ B & PC for this reason: _____
Date _____ Owner Signature _____

PAID
CITY OF SACRAMENTO
APR 30 2004

IN ISSUING THIS BUILDING PERMIT, the applicant represents, and the city relies on the representation of the applicant, that the applicant verified all measurements and locations shown on the application or accompanying drawings and that the improvement to be constructed does not violate any law or private agreement relating to permissible or prohibited locations for such improvements. This building permit does not authorize any illegal location of any improvement or the violation of any private agreement relating to location of improvements.

I certify that I have read this application and state that all information is correct. I agree to comply with all city and county ordinances and state laws relating to building construction and herby authorize representative(s) of this city to enter upon the abovementioned property for inspection purposes.

Date 4-30-04 Applicant/Agent Signature *del fardid*

WORKER'S COMPENSATION DECLARATION: I hereby affirm under penalty of perjury one of the following declarations:

____ I have and will maintain a certificate of consent to self-insure for workers' compensation as provided for by Section 3700 of the Labor Code, for the performance of work for which the permit is issued.

____ I have and will maintain workers' compensation insurance, as required by Section 3700 of the Labor Code, for the performance of the work for which this permit is issued. My workers' compensation insurance carrier and policy number are:

Carrier AMERICAN CASULTY CO Policy Number WC247856876 Exp Date 07/01/2004

____ (This section need not be completed if the permit is for \$100 or less) I certify that in the performance of the work for which this permit is issued, I shall not employ any person in any manner so as to become subject to the workers' compensation laws of California and agree that if I should become subject to the workers' compensation provisions of Section 3700 of the Labor Code, I shall forthwith comply with those provisions.

Date 4-30-04 Applicant Signature *del fardid*

WARNING: FAILURE TO SECURE WORKER'S COMPENSATION COVERAGE IS UNLAWFUL AND SHALL SUBJECT AN EMPLOYER TO CRIMINAL PENALTIES AND CIVIL FINES UP TO ONE HUNDRED THOUSAND DOLLARS (\$100,000) IN ADDITION TO THE COST OF COMPENSATION, DAMAGES AS PROVIDED FOR IN SECTION 3706 OF THE LABOR CODE, INTEREST AND ATTORNEY'S FEE.

THIS PERMIT SHALL EXPIRE BY LIMITATION IF WORK IS NOT COMMENCED WITHIN 180 DAYS.

THIS PLOT PLAN IS NOT FOR SALES PURPOSES. THIS PLOT PLAN IS FOR THE PURPOSE OF INDICATING COMPLIANCE WITH ZONING SET BACKS, GENERAL DRAINAGE AND APPROXIMATE UTILITY CONNECTION, ALL OTHER DATA SHOWN HEREON IS CONCEPTUAL. THIS PLOT PLAN DOES NOT REFLECT AS-BUILT CONDITION, RETAINING WALLS ARE OPTIONAL, AND MAY OR MAY NOT BE CONSTRUCTED.

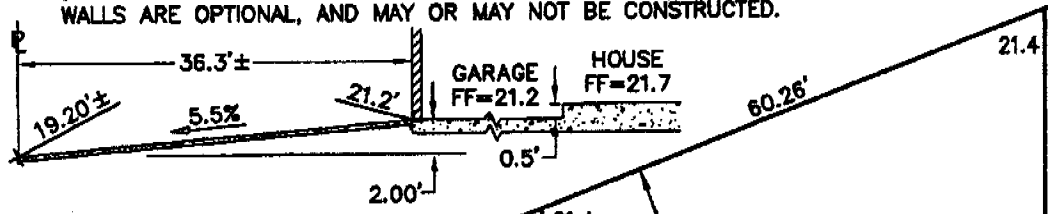

DRIVEWAY CENTERLINE PROFILE
(NOT TO SCALE)

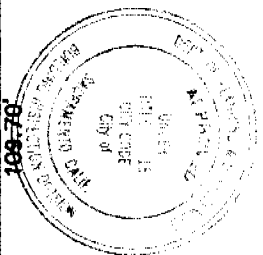
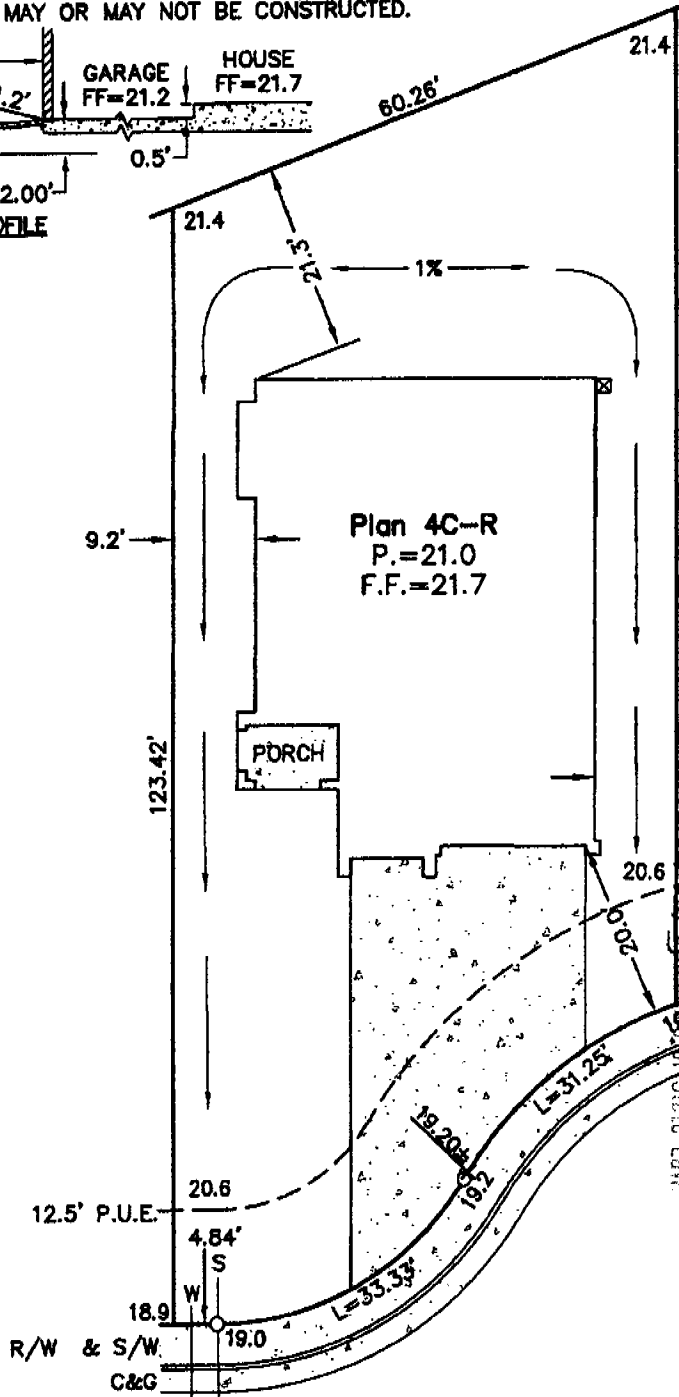
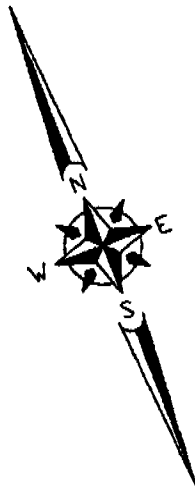

This plot plan and specifications are to be kept on the job at all times and the contractor to make any changes or alterations from the same without written permission from the Building Inspection Division.
 The approval of this plan and specifications SHALL NOT be held to permit or approve the violation of any City, State or Federal Law.

DK
OK

NY
S

LEGEND

- U - - - - UTILITY LOCATION
- ☒ - - - - AIR CONDITIONER
- S - - - - SEWER
- W - - - - WATER
- O - - - - DIMENSION POINT

Tajo Court

NET LOT AREA = 6,758 SQ. FEET
 FOOTPRINT AREA = 1,954 SQ. FEET
 LOT COVERAGE = 29%

SCALE: 1" = 20'

**PLOT PLAN
 LOT 1028**
 Natomas Creek Village 1
 Meadows - Phase 16
 City of Sacramento, State of California

**WECKER
 SURVEYS**

1111 KENNEDY PLACE
 SUITE 4
 DAVIS, CA 95616
 530-792-7252
 FAX 530-758-2775

CERTIFICATION OF INSULATION

| | | |
|---|--|--|
| ADDRESS OR TRACT <div style="font-size: 1.5em; font-family: cursive;">D.R. Horton Creekside</div> | LOT # <div style="font-size: 1.5em; font-family: cursive;">1028</div> | SACRAMENTO BUILDING PRODUCTS <input checked="" type="checkbox"/> P.O. BOX 854, WEST SACRAMENTO, CA 95691 LIC. #202026 <input type="checkbox"/> 1309 MELODY ROAD, MARYSVILLE, CA 95901 LIC. #202026 <input type="checkbox"/> P.O. BOX 9651, FRESNO, CA 93793-9651 LIC. #202026 <input type="checkbox"/> P.O. BOX 1631, RENO, NV 89505 LIC. #10675 <input type="checkbox"/> 3326 A PONDEROSA WAY, LAS VEGAS, NV 89118 LIC. #10675 DATE INSULATION COMPLETED <div style="font-size: 1.5em; font-family: cursive;">9-13-04</div> |
|---|--|--|

| WALLS | | | CEILINGS | | | FLOORS | | |
|--|-------------------|---------------------|------------------------------|---------------------------------------|---------------------|-----------------------------|---------------------|-------------------|
| (SQUARE FEET) | | | (SQUARE FEET) | | | (SQUARE FEET) | | |
| TYPE OF INSULATION | | | TYPE OF INSULATION | | | TYPE OF INSULATION | | |
| MATERIAL FIBERGLASS | | | MATERIAL FIBERGLASS | | | MATERIAL FIBERGLASS | | |
| FORM BATTS | | | FORM BATTS & BLOW | | | FORM BATTS | | |
| MANUFACTURER'S PRODUCT I.D. | | | MANUFACTURER'S PRODUCT I.D. | | | MANUFACTURER'S PRODUCT I.D. | | |
| MANUFACTURER | | | MANUFACTURER | | | MANUFACTURER | | |
| CT | OC | JM | CT | OC | JM | CT | OC | JM |
| BAGS | | | BAGS | | | BAGS | | |
| R - VALUE INSTALLED | APPLIED THICKNESS | R - VALUE INSTALLED | APPLIED THICKNESS | MIN. INSTALLED WEIGHT PER SQUARE FOOT | R - VALUE INSTALLED | APPLIED THICKNESS | R - VALUE INSTALLED | APPLIED THICKNESS |
| 13 19 | 3 1/2" 6 1/4" | 30 | 9" 12" | | | | | |
| KNEE WALLS IF R-VALUE IS OTHER THAN WALLS ABOVE | | | | | | | | |
| MATERIAL FIBERGLASS | | FORM BATTS | | R VALUE | | MANUFACTURER | | |
| | | | | | | CT | OC | JM |
| AIR INFILTRATION SEALANT | | | | | | | | |
| MATERIAL <i>Foam</i> | | | | MANUFACTURER | | | | |
| | | | | HILTI | | HANDY FOAM | | |

THIS IS TO CERTIFY THAT INSULATION AND/OR SEALANT HAS BEEN INSTALLED IN CONFORMANCE WITH APPLICABLE CODES, MATERIAL STANDARDS AND REGULATIONS.

| | | | | | |
|-----------------------------------|----|-------|---------|------|---------|
| SIGNATURE — INSULATION CONTRACTOR | JC | TITLE | MANAGER | DATE | 9-13-04 |
| SIGNATURE — GENERAL CONTRACTOR | | TITLE | | DATE | |
| REMARKS | | | | | |

KwikKote

No. 200-922029

Stucco System Installation Card

Job Name: MEADOWS @ CREEKSIDE

Address: 35 TAJO COURT

Lot #: 0001028

Stucco System Trade Name: KWIK KOTE

Stucco System Manufacturer: KWIK KOTE CORP.

ICBO Evaluation Service, Inc.

Report No. 3607

Date of Job Completion: 8/14/04

Home Builder: D.R. HORTON INC.

Address: 4401 HAZEL AVE. SUITE 225

FAIR OAKS, CA

Stucco Contractor: KENYON PLASTERING, INC.

Address: PO BOX 2077

North Highlands, CA

Telephone Number: 916/349-8191

Approved Contractor Number as
issued by the Stucco Manufacturer: 1001

Card Print Date: 09/01/2004

This is to certify that the stucco system on the building exterior at the above address had been installed in accordance with the evaluation report specified above and the manufacturer's instructions.

Walter Huse

Signature of authorized representative of stucco contractor

9/1/04

Date