

**CITY OF SACRAMENTO**  
1231 I Street, Sacramento, CA 95814

**Permit No: 0216942**  
**Insp Area: 4**  
Thos Bros:  
Sub-Type: NSFR  
Housing (Y/N): N

**Site Address: 5751 HERBAL WY SAC**  
Parcel No: NORTHPOINTE PARK VIL 29 LOT 113

CONTRACTOR  
BEAZER HOMES  
3009 DOUGLAS BL #150  
ROSEVILLE CA 95661

OWNER

ARCHITECT

**Nature of Work: MP1911 1 STORY 8 ROOM SFR**

**CONSTRUCTION LENDING AGENCY:** I hereby affirm under penalty of perjury that there is a construction lending agency for the performance of the work for which this permit is issued (Sec. 3097, Civ. C).

Lender's Name \_\_\_\_\_ Lender's Address \_\_\_\_\_

**LICENSED CONTRACTORS DECLARATION:** I hereby affirm under penalty of perjury that I am licensed under provisions of Chapter 9 (commencing with section 7000) of Division 3 of the Business and Professions Code and my license is in full force and effect.

License Class B License Number 724191 Date 11/27/02 Contractor Signature Sheylf Van Maeren

**OWNER-BUILDER DECLARATION:** I hereby affirm under penalty of perjury that I am exempt from the Contractors License Law for the following reason (Sec. 7031.5, Business and Professions Code; any city or county which requires a permit to construct, alter, improve, demolish, or repair any structure, prior to its issuance, also requires the applicant for such permit to file a signed statement that he or she is licensed pursuant to the provisions of the Contractors License Law (Chapter 9 (commencing with Section 7000) of Division 8 of the Business and Professions Code) or that he or she is exempt therefrom and the basis for the alleged exemption. Any violation of Section 7031.5 by any applicant for a permit subjects the applicant to a civil penalty of not more than five hundred dollars (\$500.00);

\_\_\_\_\_, I, as a owner of the property, or my employees with wages as their sole compensation, will do the work, and the structure is not intended or offered for sale (Sec. 7044, Business and Professions Code: The Contractors License Law does not apply to an owner of property who builds or improves thereon, and who does such work himself or herself or through his/her own employees, provided that such improvements are not intended or offered for sale. If, however, the building or improvement is sold within one year of completion, the owner-builder will have the burden of proving that he/she did not build or improve for the purpose of sale.)

\_\_\_\_\_, I, as owner of the property, am exclusively contracting with licensed contractors to construct the project (Sec. 7044, Business and Professions Code: The Contractors License Law does not apply to an owner of property who builds or improves thereon, and who contracts for such projects with a contractor(s) licensed pursuant to the Contractors License Law).

\_\_\_\_\_, I am exempt under Sec. \_\_\_\_\_ B & PC for this reason: 3097 3097 7007

Date \_\_\_\_\_ Owner Signature \_\_\_\_\_

**IN ISSUING THIS BUILDING PERMIT,** the applicant represents, and the city relies on the representation of the applicant, that the applicant verified all measurements and locations shown on the application or accompanying drawings and that the improvement to be constructed does not violate any law or private agreement relating to permissible or prohibited locations for such improvements. This building permit does not authorize any illegal location of any improvement or the violation of any private agreement relating to location of improvements.

I certify that I have read this application and state that all information is correct. I agree to comply with all city and county ordinances and state laws relating to building construction and hereby authorize representative(s) of this city to enter upon the above mentioned property for inspection purposes.

Date 11/22/02 Applicant/Agent Signature Sheylf Van Maeren

**WORKER'S COMPENSATION DECLARATION:** I hereby affirm under penalty of perjury one of the following declarations:

\_\_\_\_\_, I have and will maintain a certificate of consent to self-insure for workers' compensation as provided for by Section 3700 of the Labor Code, for the performance of work for which the permit is issued.

I have and will maintain workers' compensation insurance, as required by Section 3700 of the Labor Code, for the performance of the work for which this permit is issued. My workers' compensation insurance carrier and policy number are:

Carrier LIBERTY MUTUAL INS CO. Policy Number WA2-65D-004147-082 Exp Date 04/01/2003

\_\_\_\_\_, (This section need not be completed if the permit is for \$100 or less) I certify that in the performance of the work for which this permit is issued, I shall not employ any person in any manner so as to become subject to the workers' compensation laws of California and agree that if I should become subject to the workers' compensation provisions of Section 3700 of the Labor Code, I shall forthwith comply with those provisions.

Date 11/27/02 Applicant Signature Sheylf Van Maeren

**WARNING: FAILURE TO SECURE WORKER'S COMPENSATION COVERAGE IS UNLAWFUL AND SHALL SUBJECT AN EMPLOYER TO CRIMINAL PENALTIES AND CIVIL FINES UP TO ONE HUNDRED THOUSAND DOLLARS (\$100,000) IN ADDITION TO THE COST OF COMPENSATION, DAMAGES AS PROVIDED FOR IN SECTION 3706 OF THE LABOR CODE, INTEREST AND ATTORNEY'S FEE.**

**THIS PERMIT SHALL EXPIRE BY LIMITATION IF WORK IS NOT COMMENCED WITHIN 180 DAYS.**

RESIDENTIAL BUILDING PERMIT APPLICATION

New Construction     Addition     Remodels     Other

Project Address: Lot 113 - 5751 HERBAR WAY Assessor Parcel # 201-0320-022 & 023

OWNER INFORMATION: Northpointe Park Village 29

Legal Property Owner: Beazer Homes Holdings Corp. Phone # 916-773-3888  
Owner Address: 3009 Douglas Blvd. 150 City Roseville State CA Zip 95661

CONTRACTOR INFORMATION:

Contractor: Same as above Lic. # B724191 Phone # 773-3888 Fax # 773-0425

PROJECT INFORMATION:

Land Use Zone \_\_\_\_\_ Occupancy Group \_\_\_\_\_ Construction Type \_\_\_\_\_ Fed Code \_\_\_\_\_

No. of stories: 1 No. of rooms: \_\_\_\_\_ Street width: \_\_\_\_\_

1<sup>st</sup> Floor Area 1911 2<sup>nd</sup> Floor Area \_\_\_\_\_ Basement \_\_\_\_\_ Roof Material \_\_\_\_\_

AREA IN SQUARE FOOT OF:

	<u>EXISTING</u>	<u>NEW</u>
Dwelling/Living	_____	<u>1911</u>
Garage/Storage	_____	<u>619</u>
Decks/Balconies	_____	_____
Carports	_____	_____

SCOPE OF WORK: Single Family Homes

FOR OFFICE USE ONLY

- Information above complete     AR Flood Waiver required     Planning Approval
- Violation files checked     Flood Elevation Certificate Required     Design Review Approval
- Standard setbacks     Water Development Infill Area     Special Fee Districts Apply : \_\_\_\_\_
- County Sewer

NEW STRUCTURES & ADDITIONS

THE FOLLOWING MUST BE PROVIDED IN ORDER TO SUBMIT FOR PLAN REVIEW

- 2 COMPLETE PLANS, LEGIBLE & DRAWN TO SCALE     Plans to include: site plan, floor plan, elevations, roof/ceiling plan, foundation and structural framing details, and structural calculations for non-conforming structures.
- 3 SETS IF PROJECT IS IN A DESIGN REVIEW AREA
- Title 24 Energy Compliance documentation     11" x 17" copy of floor plan for County Assessor
- Grading and Erosion Control Questionnaire     Plan Review Fees

Date: \_\_\_\_\_ Received by: (staff) \_\_\_\_\_

ACTIVITY/PERMIT # \_\_\_\_\_



**F. RODGERS INSULATION  
RESIDENTIAL, INC.**  
THERMAL INSULATION CONTRACTORS  
Residential

6232

7775 LAS POSITAS ROAD • LIVERMORE, CA 94561  
(925) 294-9400 • FAX (925) 294-9475  
1300 S RIVER RD, #125 • W. SACRAMENTO, CA 95691  
(916) 386-9400 • FAX (916) 386-9446



BLAZER LOT# 113 TRACT # 11111111  
STREET 5751 Herkel CITY S.A.

EXTERIOR WALLS:  
MANUFACTURER 5/M THICKNESS/TYPE VALUE R- 13+19

CELLINGS:  
BATTIS:  
MANUFACTURER 5/M THICKNESS/TYPE VALUE R- 30  
BLOWN IN:  
MANUFACTURER 5/M THICKNESS/TYPE VALUE R- 30

SQUARE FOOTAGE COVERED 1601 NUMBER OF BAGS USED 28  
FLOORS & OVERHANGS:  
MANUFACTURER THICKNESS/TYPE VALUE R-  
OTHER:  
MANUFACTURER THICKNESS/TYPE VALUE R-

GENERAL CONTRACTOR \_\_\_\_\_  
CALIFORNIA CONTRACTORS LICENSE # \_\_\_\_\_  
DATE \_\_\_\_\_

SIGNATURE \_\_\_\_\_ TITLE \_\_\_\_\_

INSULATION CONTRACTOR F. RODGERS INSULATION RESIDENTIAL  
CALIFORNIA CONTRACTORS LICENSE #771285

DATE 5-8-03  
SIGNATURE [Signature] TITLE \_\_\_\_\_

# OMEGA PRODUCTS INTERNATIONAL, INC.

DIAMOND WALL INSULATING STUCCO SYSTEM

JOB ADDRESS:

ICBO Report #4004

5751 Herbal Way  
Lot 113

Date of Job Completion 4-5-03

PLASTERING CONTRACTOR:

Name: Stucco Works, INC.

Address: 5900 Warren <sup>Way</sup> Sacramento, CA. 95826

Telephone No: (916) 383-6699

Contractor Number of Diamond Wall System 2175

This is to certify that the exterior coating system on the building exterior at the above address has been installed in accordance with the evaluation report specified above and the manufacturer's instructions.

5-20-03  
Date

[Signature]  
Signature of authorized representative of  
Plastering Contractor

This installation card must be presented to the building inspector after completion of work and before final inspection.

THIS PLOT PLAN IS NOT FOR SALES PURPOSES. THIS PLOT PLAN IS FOR THE PURPOSES OF INDICATING COMPLIANCE WITH ZONING SET BACKS, GENERAL DRAINAGE DIRECTION, AND APPROXIMATE UTILITY CONNECTION. ALL OTHER DATA SHOWN HEREON IS CONCEPTUAL. THIS PLOT PLAN DOES NOT REFLECT AS-BUILT CONDITION, RETAINING WALL ARE OPTIONAL AND MAY OR MAY NOT BE CONSTRUCTED.

SCALE: 1" = 20'

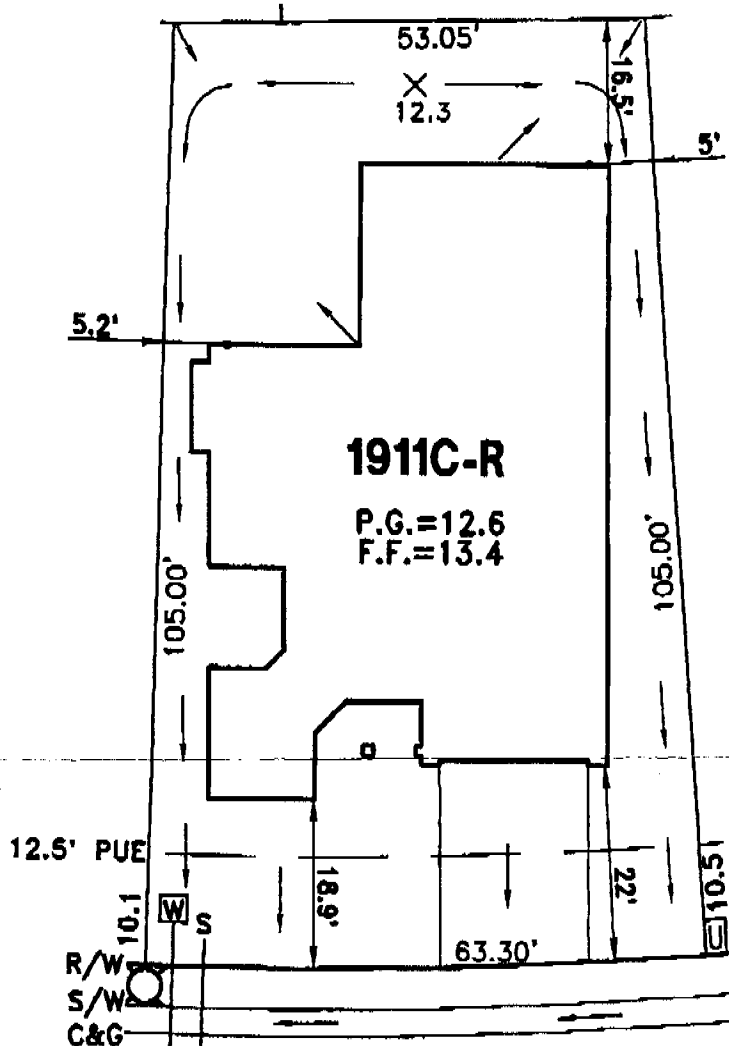





**HERBAL WAY**

ROUTING/APPROVAL		INITIALS
President		
Project Development		
Construction		
Marketing		
Admin.		
Accounting		

This plot plan and specifications must be reviewed and approved by the City of Sacramento. No alterations or modifications to the plan shall be made without the written permission from the City of Sacramento.

The approval of this plan and specification SHALL NOT be held to permit or approve the violation of any City Ordinance or State Law.

**LEGEND**

-  STREET LIGHT
-  TRANSFORMER
-  UTILITY BOX
-  FIRE HYDRANT

**PLOT PLAN  
LOT 113  
WINDHAM  
AT REGENCY PARK VILLAGE 29  
FOR  
BEAZER HOMES  
CITY OF SACRAMENTO CALIFORNIA**

**WOOD RODGERS**  
ENGINEERING • PLANNING • MAPPING • SURVEYING  
3301 E STREET, BLDG. 100-S, SACRAMENTO, CA 95818  
PHONE: (916) 341-7768 FAX: (916) 341-7767

DATE: OCT.2002	DRAWN: FJ	CHECKED: 	PROJECT NO: 1045.069
-------------------	--------------	---	-------------------------