

CITY OF SACRAMENTO

1231 I Street, Sacramento, CA 95814

Permit No: 0013276

Insp Area: 4

Site Address: 4230 RIVER SWAN LN SAC

Parcel No: 225-1240-080

GATEWAY N 2 LOT 115

Sub-Type: NSFR

Housing (Y/N): N

CONTRACTOR

CALIFORNIA HOMES
3031 W MARCH LN # 133- SO
STOCKTON CALIF. 95219

OWNER

ARCHITECT

Nature of Work: MP 2150 W/OPT. OVER DEN 2 STORY 9 ROOM SFR

CONSTRUCTION LENDING AGENCY : I hereby affirm under penalty of perjury that there is a construction lending agency for the performance of the work for which this permit is issued (Sec. 3097, Civ. C).

Lender's Name Lender's Address

LICENSED CONTRACTORS DECLARATION: I hereby affirm under penalty of perjury that I am licensed under provisions of Chapter 9 (commencing with section 7000) of Division 3 of the Business and Professions Code and my license is in full force and effect.

License Class License Number Date Contractor Signature

OWNER-BUILDER DECLARATION: I hereby affirm under penalty of perjury that I am exempt from the contractors License Law for the following reason (Sec. 7031.5, Business and Professions Code; any city or county which requires a permit to construct, alter, improve, demolish, or repair any structure, prior to its issuance, also requires the applicant for such permit to file a signed statement that he or she is licensed pursuant to the provisions of the Contractors License Law (Chapter 9 (commencing with Section 7000) of Division 8 of the Business and Professions Code) or that he or she is exempt therefrom and the basis for the alleged exemption Any violation of Section 7031.5 by any applicant for a permit subjects the applicant to a civil penalty of not more than five hundred dollars (\$500.00);

I, as a owner of the property, or my employees with wages as their sole compensation, will do the work, and the structure is not intended or offered for sale (Sec. 7044, Business and Professional Code: The Contractors License Law does not apply to an owner of property who builds or improves thereon, and who does such work himself or herself or through his/her own employees, provided that such improvements are not intended or offered for sale. If, however, the building or improvement is sold within one year of completion, the owner-builder will have the burden of proving that he/she did not build or improve for the purpose of sale.)

I, as owner of the property, am exclusively contracting with licensed contractors to construct the project (Sec. 7044, Business and Professions Code: The Contractors License Law does not apply to an owner of property who builds or improves thereon, and who contracts for such projects with a contractor(s) licensed pursuant to the Contractors License Law).

I am exempt under Sec. B & PC for this reason:

Date Owner Signature

IN ISSUING THIS BUILDING PERMIT, the applicant represents, and the city relies on the representation of the applicant, that the applicant verified all measurements and locations shown on the application or accompanying drawings and that the improvement to be constructed does not violate any law or private agreement relating to permissible or prohibited locations for such improvements. This building permit does not authorize any illegal location of any improvement or the violation of any private agreement relating to location of improvements.

I certify that I have read this application and state that all information is correct. I agree to comply with all city and county ordinances and state laws relating to building construction and hereby authorize representative(s) of this city to enter upon the abovementioned property for inspection purposes.

Date Applicant/Agent Signature

WORKER'S COMPENSATION DECLARATION: I hereby affirm under penalty of perjury one of the following declarations:

I have and will maintain a certificate of consent to self-insure for workers' compensation as provided for by Section 3700 of the Labor Code, for the performance of work for which the permit is issued

I have and will maintain workers' compensation insurance, as required by Section 3700 of the Labor Code, for the performance of the work for which this permit is issued. My workers' compensation insurance carrier and policy number are:

Carrier STATE FUND Policy Number 1586735-00 Exp Date 7/1/2001

(This section need not be completed if the permit is for \$100 or less) I certify that in the performance of the work for which this permit is issued, I shall not employ any person in any manner so as to become subject to the workers' compensation laws of California and agree that if I should become subject to the workers' compensation provisions of Section 3700 of the Labor Code, I shall forthwith comply with those provisions.

Date Applicant Signature

WARNING FAILURE TO SECURE WORKER'S COMPENSATION COVERAGE IS UNLAWFUL AND SHALL SUBJECT AN EMPLOYER TO CRIMINAL PENALTIES AND CIVIL FINES UP TO ONE HUNDRED THOUSAND DOLLARS (\$100,000) IN ADDITION TO THE COST OF COMPENSATION, DAMAGES AS PROVIDED FOR IN SECTION 3706 OF THE LABOR CODE, INTEREST AND ATTORNEY'S FEE.

THIS PERMIT SHALL EXPIRE BY LIMITATION IF WORK IS NOT COMMENCED WITHIN 180 DAYS.

RESIDENTIAL BUILDING PERMIT APPLICATION

- New Construction
 Addition
 Remodels
 Other

Project Address: 4230 River Swan Assessor Parcel # 225-124-080
 LOT # 115

OWNER INFORMATION:

Legal Property Owner: Matthews Homes Corp. dba Phone # (209)951-5444
California Homes
 Owner Address: 3031 W. March Ln. #133-So. City Stockton State CA Zip 95219

CONTRACTOR INFORMATION:

Contractor: Matthews Homes Lic. # 754984 Phone # 209-951-5444 Fax # 209-951-2619

PROJECT INFORMATION:

Land Use Zone RIA Occupancy Group R3 Construction Type VN Fed Code 1A
 No. of stories: 2 No. of rooms: 11 Street width: 40'
 1st Floor Area 1000s.s.f. 2nd Floor Area 1327s.s.f. Basement n/a Roof Material Tile

AREA IN SQUARE FOOT OF:	EXISTING	NEW
Dwelling/Living	<u>2327</u>	_____
Garage/Storage	<u>464</u>	_____
Decks/Balconies	_____	_____
Carports	<u>n/a</u>	_____

SCOPE OF WORK: Gateway Village #2

FOR OFFICE USE ONLY

- | | | |
|---|---|---|
| <input type="checkbox"/> Information above complete | <input type="checkbox"/> AR Flood Waiver required | <input type="checkbox"/> Planning Approval |
| <input type="checkbox"/> Violation files checked | <input type="checkbox"/> Flood Elevation Certificate Required | <input type="checkbox"/> Design Review Approval |
| <input type="checkbox"/> Standard setbacks | <input type="checkbox"/> Water Development Infill Area | <input type="checkbox"/> Special Fee Districts Apply: _____ |
| <input type="checkbox"/> County Sewer | | |

NEW STRUCTURES & ADDITIONS

THE FOLLOWING MUST BE PROVIDED IN ORDER TO SUBMIT FOR PLAN REVIEW

- | | |
|---|---|
| <input type="checkbox"/> 2 COMPLETE PLANS, LEGIBLE & DRAWN TO SCALE | ◆ Plans to include: site plan, floor plan, elevations, roof/ceiling plan, foundation and structural framing details, and structural calculations for non-conforming structures. |
| <input type="checkbox"/> 3 SETS IF PROJECT IS IN A DESIGN REVIEW AREA | |
| <input type="checkbox"/> Title 24 Energy Compliance documentation | <input type="checkbox"/> 11" x 17" copy of floor plan for County Assessor |
| <input type="checkbox"/> Grading and Erosion Control Questionnaire | <input type="checkbox"/> Plan Review Fees |

Date: _____ Received by: (staff) _____

ACTIVITY/PERMIT #

ENGEL INSULATION, INC.

CALIFORNIA CONTRACTOR'S LICENSE #745646

460 Roseville Road • Roseville, CA 95678

(916) 786-2088 / (916) 969-6191

THIS IS TO CERTIFY THAT INSULATION HAS BEEN INSTALLED IN CONFORMANCE WITH CURRENT ENERGY REGULATIONS, CALIFORNIA ADMINISTRATIVE CODE, TITLE 24, STATE OF CALIFORNIA, IN THE BUILDING LOCATED AT:

TRACT BELLA VISTA I LOT 115/2
STREET _____ CITY SACRAMENTO

EXTERIOR WALLS
MANUFACTURER CT THICKNESS 3 1/2 R-VALUE 13

CEILING AREA BATT
MANUFACTURER CT THICKNESS 10 R-VALUE 30

CEILINGS BLOWN IN
MANUFACTURER INSULSAFE THICKNESS 12 R-VALUE 30

SQUARE FOOTAGE 1090 NUMBER OF BAGS USED 20

~~FLOOR AREA~~ ^{ceiling}
MANUFACTURER CT THICKNESS 6 1/4 R-VALUE 19

EXTERIOR KNEEWALL
MANUFACTURER _____ THICKNESS _____ R-VALUE _____

INTERIOR KNEEWALL
MANUFACTURER CT THICKNESS 3 1/2 R-VALUE 13

APPLIED CAULK & SEALANT TO ALL EXTERIOR OPENINGS & PENETRATIONS

YES NO

GENERAL CONTRACTOR _____

CALIFORNIA CONTRACTORS LICENSE # _____ DATE _____

SIGNATURE _____ TITLE _____
Rose Schmitt-Hart Rec. Bookkeeper 4/17/01
INSULATION CONT. SIGNATURE _____ TITLE _____ DATE _____



BASALITE[®]

PACIFIC STUCCO SYSTEMS

4290 Roseville Road
North Highlands, CA 95660-5710
(916) 486-4094
Fax (916) 486-4187

Installation Card
Fiber Reinforced Stucco

Job Name and Address : CALIFORNIA HOME

ICBO# 5269

FULLA VISTA

4-17-01
Date of job completion

267-115

Plastering Contractor

Name: VISION PLASTERING

Address: 8974 GREEN BACH

Telephone No. (916) 3324

Approved contractor as issued by Basalite/Pacific Stucco

This is to certify the exterior coating system at the above address, has been installed in accordance with the evaluation report specified above and the manufacturers instructions.

[Signature]

Signature of authorized representative of
plastering contractor

4-18-01
Date

This installation card must be presented to the building inspector after completion of work and before final inspection

California Homes

303 I West March Lane
Stockton, California 95219

Suite 133-South
Corp. Office (209) 951-5444

BELLA VISTA II SACRAMENTO, CALIFORNIA GATEWAY NORTH VILLAGE 2 UNIT #2 SCALE: 1"=20' LOT #115

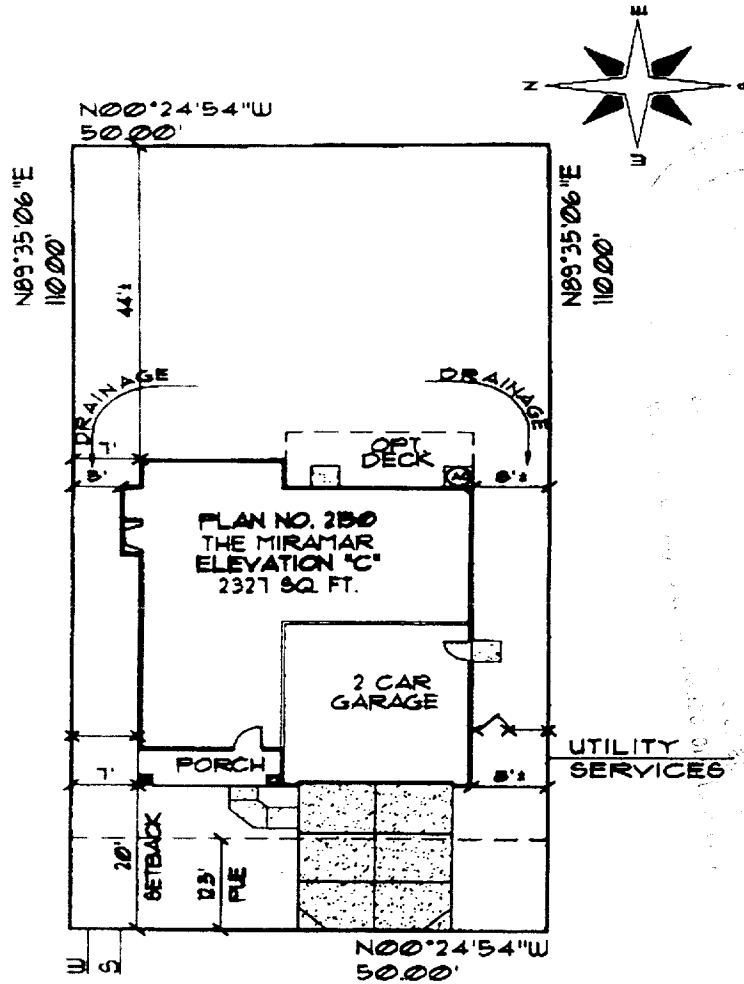

4230 RIVER SWAN LANE

PLOT PLAN NOTES

1. FINISHED FLOOR SHALL BE 1 1/2 INCHES MINIMUM ABOVE THE TOP OF CURB.
 2. MEASUREMENTS SHOWN ARE APPROXIMATE. CALIFORNIA HOMES RESERVES THE RIGHT TO ALTER THE DIMENSIONS WITHOUT PRIOR WRITTEN NOTICE OR OBLIGATION.
 3. THE GRADING AND DRAINAGE IS REQUIRED TO CONFORM WITH THE UNIFORM BUILDING CODE AND LOCAL AGENCY REQUIREMENTS. THE GRADING AND DRAINAGE IS INSPECTED BY THE LOCAL AGENCY AT FINAL BUILDING INSPECTION FOR COMPLIANCE WITH LOCAL REQUIREMENTS. CALIFORNIA HOMES IS NOT RESPONSIBLE FOR CHANGES MADE TO THE GRADING OR DRAINAGE SWALES. SHOULD YOU WISH TO CHANGE THE DRAINAGE PATTERN, BE SURE THAT A PROPER DRAINAGE METHOD IS MAINTAINED. BY SIGNING BELOW, I INDICATE THAT I UNDERSTAND THE IMPORTANCE OF MAINTAINING A PROPER GRADING AND DRAINAGE SYSTEM.
 4. MOST LOTS ARE ENCUMBERED BY PUBLIC UTILITY OR OTHER EASEMENTS. YOU ARE RESPONSIBLE FOR REVIEWING THE TITLE REPORT TO CONFIRM THE EXISTENCE AND LOCATIONS OF EASEMENTS.
 5. LOTS MAY CONTAIN FIRE HYDRANTS, STREET LIGHTS, HANDICAPPED RAMPS, UNDERGROUND AND/OR ABOVE GROUND UTILITY BOXES, POSTAL BOXES ETC. OR TOPOGRAPHICAL FEATURES. YOU ARE RESPONSIBLE FOR WALKING YOUR LOT TO DETERMINE THAT ANY ENCUMBRANCES WILL NOT UNDULY AFFECT YOUR USE OF THE LOT.
- BY SIGNING BELOW I AGREE THAT I UNDERSTAND THE ABOVE BUYER RESPONSIBILITIES.

*RVD
10/80/00*

BUYERS _____

DATE _____