

CITY OF SACRAMENTO
1231 I Street, Sacramento, CA 95814

Permit No: 0306709
Insp Area: 4
Thos Bros: 257-C4

Site Address: 1668 SALIZAR WY SAC
Parcel No: 201-0780-069 NORTHPOINTE PARK VIL 30A LOT 95
N Housing (Y/N):

CONTRACTOR
LENNAR RENAISSANCE INC
2240 DOUGLAS BL
ROSEVILLE, CA 95661

OWNER

ARCHITECT

Nature of Work: MP424(2090) 1 STORY 8 ROOM SFR

CONSTRUCTION LENDING AGENCY: I hereby affirm under penalty of perjury that there is a construction lending agency for the performance of the work for which this permit is issued (Sec. 3097, Civ. C).

Lender's Name _____ Lender's Address _____

LICENSED CONTRACTORS DECLARATION: I hereby affirm under penalty of perjury that I am licensed under provisions of Chapter 9 (commencing with section 7000) of Division 3 of the Business and Professions Code and my license is in full force and effect.

License Class B License Number 732348 Date 2/28/05 Contractor Signature [Signature]

OWNER-BUILDER DECLARATION: I hereby affirm under penalty of perjury that I am exempt from the contractors License Law for the following reason (Sec. 7031.5, Business and Professions Code; any city or county which requires a permit to construct, alter, improve, demolish, or repair any structure, prior to its issuance, also requires the applicant for such permit to file a signed statement that he or she is licensed pursuant to the provisions of the Contractors License Law (Chapter 9 (commencing with Section 7000) of Division 8 of the Business and Professions Code) or that he or she is exempt therefrom and the basis for the alleged exemption. Any violation of Section 7031.5 by any applicant for a permit subjects the applicant to a civil penalty of not more than five hundred dollars (\$500.00);

____ I, as a owner of the property, or my employees with wages as their sole compensation, will do the work, and the structure is not intended or offered for sale (Sec. 7044, Business and Professional Code: The Contractors License Law does not apply to an owner of property who builds or improves thereon, and who does such work himself or herself or through his/her own employees, provided that such improvements are not intended or offered for sale. If, however, the building or improvement is sold within one year of completion, the owner-builder will have the burden of proving that he/she did not build or improve for the purpose of sale.)

____ I, as owner of the property, am exclusively contracting with licensed contractors to construct the project (Sec. 7044, Business and Professions Code: The Contractors License Law does not apply to an owner of property who builds or improves thereon, and who contracts for such projects with a contractor(s) licensed pursuant to the Contractors License Law).

PAID
CITY OF SACRAMENTO
MAY 10 2003
NORTH PERMIT

____ I am exempt under Sec. _____ B & PC for this reason: _____
Date _____ Owner Signature _____

IN ISSUING THIS BUILDING PERMIT, the applicant represents, and the city relies on the representation of the applicant that the applicant verified all measurements and locations shown on the application or accompanying drawings and that the improvement to be constructed does not violate any law or private agreement relating to permissible or prohibited locations for such improvements. This building permit does not authorize any illegal location of any improvement or the violation of any private agreement relating to location of improvements.

I certify that I have read this application and state that all information is correct. I agree to comply with all city and county ordinances and state laws relating to building construction and hereby authorize representative(s) of this city to enter upon the abovementioned property for inspection purposes.

Date 5-30-07 Applicant/Agent Signature [Signature]

WORKER'S COMPENSATION DECLARATION: I hereby affirm under penalty of perjury one of the following declarations:
____ I have and will maintain a certificate of consent to self-insure for workers' compensation as provided for by Section 3700 of the Labor Code, for the performance of work for which the permit is issued.

I have and will maintain workers' compensation insurance, as required by Section 3700 of the Labor Code, for the performance of the work for which this permit is issued. My workers' compensation insurance carrier and policy number are:

Carrier OLD REPUBLIC INS. CO. Policy Number MWC10845400 Exp Date 11/01/2003

____ (This section need not be completed if the permit is for \$100 or less) I certify that in the performance of the work for which this permit is issued, I shall not employ any person in any manner so as to become subject to the workers' compensation laws of California and agree that if I should become subject to the workers' compensation provisions of Section 3700 of the Labor Code, I shall forthwith comply with those provisions.

Date 5-30-03 Applicant Signature [Signature]

WARNING: FAILURE TO SECURE WORKER'S COMPENSATION COVERAGE IS UNLAWFUL AND SHALL SUBJECT AN EMPLOYER TO CRIMINAL PENALTIES AND CIVIL FINES UP TO ONE HUNDRED THOUSAND DOLLARS (\$100,000) IN ADDITION TO THE COST OF COMPENSATION, DAMAGES AS PROVIDED FOR IN SECTION 3706 OF THE LABOR CODE, INTEREST AND ATTORNEY'S FEE.

THIS PERMIT SHALL EXPIRE BY LIMITATION IF WORK IS NOT COMMENCED WITHIN 180 DAYS.

4
RESIDENTIAL BUILDING PERMIT APPLICATION

New Construction Addition Remodels Other LOT# 95

Project Address: 1668 SALIZAR WAY Assessor Parcel # 201-0780-069

OWNER INFORMATION: NORTAPOINTE PARK VILLAGE 30A
Legal Property Owner: LENNAR RENAISSANCE Phone # (916)773-7471
Owner Address: 2240 DOUGLAS BLVD. City ROSEVILLE State CA Zip 95601

CONTRACTOR INFORMATION: 0306709
Contractor: LENNAR RENAISSANCE Lic. # 732348 Phone # (916)773-747 Fax# (916)773-4086

PROJECT INFORMATION:
Land Use Zone M/A Occupancy Group R3 Construction Type VM Fed Code 1A
No. of stories: ONE No. of rooms: _____ Street width: _____
1st Floor Area 2090 2nd Floor Area 0 Basement M/A Roof Material TILE
AREA IN SQUARE FOOT OF: EXISTING NEW
Dwelling/Living _____ 2090
Garage/Storage _____ 532
Decks/Balconies _____ _____
Carports _____ _____

SCOPE OF WORK: NEW SFD
PLAN # 424

FOR OFFICE USE ONLY:

- | | | |
|---|---|--|
| <input type="checkbox"/> Information above complete | <input type="checkbox"/> AR Flood Waiver required | <input type="checkbox"/> Planning Approval |
| <input type="checkbox"/> Violation files checked | <input type="checkbox"/> Flood Elevation Certificate Required | <input type="checkbox"/> Design Review Approval |
| <input type="checkbox"/> Standard setbacks | <input type="checkbox"/> Water Development Infill Area | <input type="checkbox"/> Special Fee Districts Apply |
| <input type="checkbox"/> County Sewer | | |

NEW STRUCTURES & ADDITIONS

*THE FOLLOWING MUST BE PROVIDED IN ORDER TO SUBMIT FOR PLAN REVIEW

- | | |
|---|---|
| <input type="checkbox"/> 2 COMPLETE PLANS, LEGIBLE & DRAWN TO SCALE | * Plans to include: site plan, floor plan, elevations, roof/ceiling plan, foundation and structural framing details, and structural calculations for non-conforming structures. |
| <input type="checkbox"/> 3 SETS IF PROJECT IS IN A DESIGN REVIEW AREA | |
| <input type="checkbox"/> Title 24 Energy Compliance documentation | <input type="checkbox"/> 11" x 17" copy of floor plan for County Assessor |
| <input type="checkbox"/> Grading and Erosion Control Questionnaire | <input type="checkbox"/> Plan Review Fees |

Date: _____ Received by: (staff) _____

ACTIVITY/PERMIT # _____

Scanned 12/1

ENGEL INSULATION, INC.

CALIFORNIA CONTRACTOR'S LICENSE #745646

460 Roseville Road • Roseville, CA 95678
(916) 786-2088 / (916) 786-2064

THIS IS TO CERTIFY THAT INSULATION HAS BEEN INSTALLED IN CONFORMANCE WITH CURRENT ENERGY REGULATIONS; CALIFORNIA ADMINISTRATIVE CODE, TITLE 24, STATE OF CALIFORNIA, IN THE BUILDING LOCATED AT:

TRACT Gossamer 599 465 @ LOT 095 2100 124
STREET 16680 Solimar CITY JACKSONVILLE

EXTERIOR WALLS: MANUFACTURER CT THICKNESS 3 1/2 R-VALUE 13

CEILING AREA: BATS MANUFACTURER CT THICKNESS 12 R-VALUE 38

CEILINGS: BLOWN IN MANUFACTURER SHOULD HAVE THICKNESS 1 1/2 R-VALUE 38

SQUARE FOOTAGE 1790 NUMBER OF BAGS USED 41

FLOOR AREA: MANUFACTURER VAULT THICKNESS _____ R-VALUE _____

EXTERIOR-KNEEWALL: MANUFACTURER CT THICKNESS 6 1/4 R-VALUE 19

INTERIOR KNEEWALL: MANUFACTURER CT THICKNESS 3 1/2 R-VALUE 13

APPLIED CAULK & SEALANT TO ALL EXTERIOR OPENINGS & PENETRATIONS

YES NO _____

GENERAL CONTRACTOR _____
CALIFORNIA CONTRACTORS LICENSE # _____ DATE _____

SIGNATURE Richard W. Newlin TITLE _____
INSULATION CONT. SIGNATURE _____ TITLE _____ DATE 12/24/03

INSTALLATION CERTIFICATE

(page 1 of 4)

CF-68

Site Address

Permit Number

An installation certificate is required to be posted at the building site or made available for all appropriate inspections. (The information provided on this form is required; however, use of this form to provide the information is optional.) After completion of final inspection, a copy must be provided to the building department (upon request), building owner or tenancy per Section 10-103(d).

HVAC SYSTEMS:

Heating Equipment

Type (See Part 6)	CEC Certified Mfr Name & Model Number	# of Heating Systems	Efficiency (AFUE, etc.) (a CEC label)	Heat Location (a/c, etc.)	Cost of Piping System	Heating Load (BTU/hr)	Heating Capacity (BTU/hr)

Cooling Equipment

Type (See Part 6)	CEC Certified Compressor Unit Mfr Name and Model Number	# of Condensed Systems	Efficiency (SEER, etc.) (a CEC label)	Heat Location (a/c, etc.)	Price Range	Cooling Load (BTU/hr)	Cooling Capacity (BTU/hr)

I, the undersigned, verify that equipment listed above my signature (1) is the actual equipment installed; (2) is equivalent to or more efficient than that specified in the certificate of compliance (Form CF-13) submitted for compliance with the Energy Efficiency Standards for residential buildings; and (3) the equipment meets or exceeds the appropriate requirements for manufactured devices (from the Appliance Efficiency Regulations or Part 6), where applicable.

Signature, Date

Installing Subcontractor (C.E. Name)
 OR General Contractor (C.E. Name) OR Owner

WATER HEATING SYSTEMS:

Model #	CEC Certified Mfr Name & Model Number	Manufacturer Type (See Part 6)	# Recycled Content (%)	# of Heating Systems	Rated Input (kW)	Tank Volume (gallons)	EF (See Part 6)	Capacity (See Part 6)	External Insulation (See Part 6)

For small gas storage water heaters rated input at 75,000 Btu/hr, electric resistance and heat pump water heaters, see Energy Factor.
 For large gas storage water heaters rated input > 75,000 Btu/hr, see Recovery Efficiency, Standby Loss and Rated Input.
 For instantaneous gas water heaters, see Recovery Efficiency and Rated Input.

Faucets & Shower Heads:

All faucets and showerheads installed are certified to the Commission, pursuant to Title 24, Part 6, Subchapter 2, Section 111.

I, the undersigned, verify that equipment listed above my signature (1) is the actual equipment installed; (2) is equivalent to or more efficient than that specified in the certificate of compliance (Form CF-13) submitted for compliance with the Energy Efficiency Standards for residential buildings; and (3) the equipment meets or exceeds the appropriate requirements for manufactured devices (from the Appliance Efficiency Regulations or Part 6), where applicable.

Rich Savard
 Signature, Date

Will-Mor Plant
 Installing Subcontractor (C.E. Name) OR
 General Contractor (C.E. Name) OR Owner

COPY TO: Building Department

INSTALLATION CERTIFICATE

Site Address _____

Permit Number _____

An installation certificate is required to be posted at the building site or made available for all appropriate inspections. (The information provided on this form is required; however, use of this form to provide the information is optional.) After completion of final inspection, a copy must be provided to the building department (upon request) and the building owner at occupancy, per Section 10-103(b).

HVAC SYSTEMS:

Heating Equipment

Equip. Type (pkg. heat pump)	CBC Certified Mfr Name and Model Number	# of Identical Systems	Efficiency (AFUE, etc.) ¹ [\geq CF-1R value]	Duct Location (attic, etc.)	Duct or Piping R-value	Heating Load (Btu/hr)	Heating Capacity (Btu/hr)
Furnace	Bryant 310JAV036070	1	80	Attic	4.2	22,660	51,000

Cooling Equipment

Equip. Type (pkg. heat pump)	CBC Certified Compressor Unit Mfr Name and Model Number	# of Identical Systems	Efficiency (SEER, etc.) ¹ [\geq CF-1R value]	Duct Location (attic, etc.)	Duct R-value	Cooling Load (Btu/hr)	Cooling Capacity (Btu/hr)
Split AC	Bryant 537A036	1	14.0	Attic	4.2	27,267	35,800

1. \geq reads greater than or equal to.

I, the undersigned, verify that equipment listed above is: 1) the actual equipment installed, 2) equivalent to or more efficient than that specified in the certificate of compliance (Form CF-1R) submitted for compliance with the Energy Efficiency Standards for residential buildings, and 3) equipment that meets or exceeds the appropriate requirements for manufactured devices (from the Appliance Efficiency Regulations or Part 6), where applicable.

Robert D. Q. 4-30-03
Signature, Date

Deal Sheet Metal Inc.
Installing Subcontractor (Co. Name)
OR General Contractor (Co. Name) OR Owner

WATER HEATING SYSTEMS:

Heater Type	CBC Certified Mfr Name & Model Number	Distribution Type (Std. Point-of-Use)	If Recirculation Control Type	# of Identical Systems	Rated ² Input (kW or Btu/hr)	Tank Volume (gallons)	Efficiency ² (EF, RE)	Standby ² Loss (%)	External Insulation R-value ³

- 2 For small gas storage (rated input of less than or equal to 75,000 Btu/hr), electric resistance and heat pump water heaters, list Energy Factor. For large gas storage water heaters (rated input of greater than 75,000 Btu/hr), list Recovery Efficiency, Standby Loss and Rated Input. For instantaneous gas water heaters, list Recovery Efficiency and Rated Input.
- 3 R-12 external insulation is mandatory for storage water heaters with an energy factor of less than 0.58.

Faucets & Shower Heads:

All faucets and showerheads installed are certified to the Commission, pursuant to Title 24, Part 6, Section 111.

I, the undersigned, verify that equipment listed above my signature is: 1) the actual equipment installed; 2) equivalent to or more efficient than that specified in the certificate of compliance (Form CF-1R) submitted for compliance with the Energy Efficiency Standards for residential buildings; and 3) equipment that meets or exceeds the appropriate requirements for manufactured devices (from the Appliance Efficiency Regulations or Part 6), where applicable.

Signature, Date

Installing Subcontractor (Co. Name) OR
General Contractor (Co. Name) OR Owner

COPY TO: Building Department
HERS Provider (if applicable)
Building Owner at Occupancy

plot plan

THIS PLOT PLAN IS FOR THE PURPOSE OF SHOWING THE HOUSE TO BE CONSTRUCTED ON THE LOT AND MAY NOT REPRESENT THE FINAL AS-BUILT CONFIGURATION OF THE PROPERTY OR IMPROVEMENTS THEREON. THE ACCURACY OF THIS PLOT PLAN IS NOT GUARANTEED, NOR IS IT A PART OF ANY POLICY, REPORT OR GUARANTEE TO WHICH IT MAY BE ATTACHED. ACTUAL DIMENSIONS, OTHER THAN MINIMUM ORDINANCE, MAY VARY OR CHANGE WITHOUT PRIOR NOTICE, DUE TO ACTUAL SITE CONDITIONS.

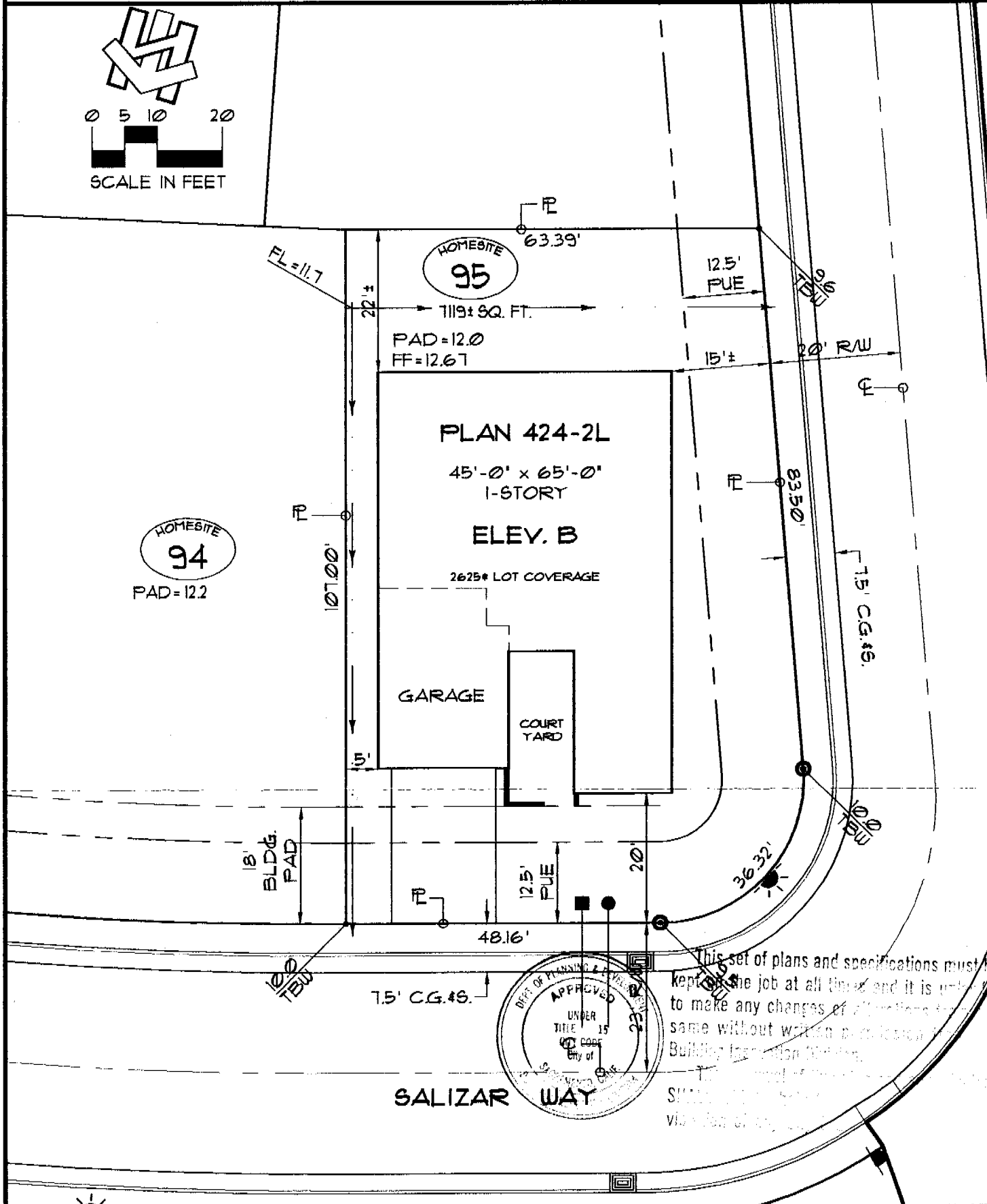
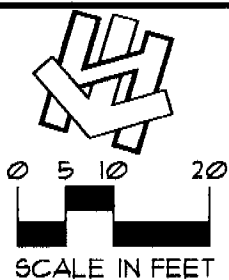

This set of plans and specifications must be kept on the job at all times and it is understood that no changes or alterations shall be made without written permission of the Building Inspector.

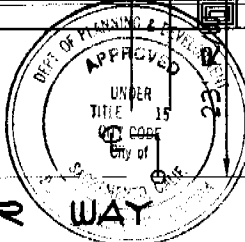

lot coverage	
LOT AREA:	1119± #
BUILDING:	2625 #
BLDG./ LOT AREA:	37 %

retaining wall	
HEIGHT:	_____
LENGTH:	_____
DISTANCE FROM P.L.:	_____

symbols legend	
DROP INLET:	
ELECTRIC SERVICE BOX:	
FIRE HYDRANT:	
FLOW LINE HIGH POINT:	FL=23.4
GAS SERVICE:	
PAD-MOUNT TRANSFORMER:	
SEWER SVC.:	
STREET LIGHT:	
TOP-BACK OF SIDEWALK ELEV.:	123.4 TBW
SWALE (FLOW DIRECTION):	
WATER SVC.:	
EXTENTS OF 2ND STORY LEVEL:	

Winncrest Homes

GOSSAMER SPRINGS

A REGENCY PARK COMMUNITY

home site #95

1668 Salizar Way

NORTHPOINTE PARK VILLAGE 30A
 CITY OF SACRAMENTO, CALIFORNIA
 a.p.n.: 201-0780-069

General notes

- 1) DIMENSIONS ALONG CURVED LINES ARE CHORD LENGTHS, U.O.N.
- 2) SETBACK DIMENSIONS ARE ROUNDED DOWN TO NEAREST HALF UNIT, U.O.N.
- 3) FOOTPRINT AREA CALCULATIONS (*) ARE BASED ON PLAN DIMENSIONS ONLY AND DO NOT INCLUDE COVERED ENTRIES, PORCHES OR ARCHITECTURAL PROJECTIONS.

3.1	BCB	5/3/03	20:1
phase	drawn by	issue	scale

ced 12/11