

CITY OF SACRAMENTO
1231 I Street, Sacramento, CA 95814

Permit No: 9909388
Insp Area: 4

Site Address: 11 EASTHAM CT SAC
Parcel No: 274-0540-023 HERITAGE PLACE LOT 23

Sub-Type: NSFR
Housing (Y/N): N

CONTRACTOR
EPICK INC
1253 THE ESPLANADE
CHICO, CA 95926

OWNER

ARCHITECT

Nature of Work: NEW HOME, MP1710 (W/DEN OPTION), 6 ROOMS

CONSTRUCTION LENDING AGENCY: I hereby affirm under penalty of perjury that there is a construction lending agency for the performance of the work for which this permit is issued (Sec. 3097, Civ. C).

Lender's Name 1st Bank Lender's Address 1527 Douglas Blvd. Roseville

LICENSED CONTRACTORS DECLARATION: I hereby affirm under penalty of perjury that I am licensed under provisions of Chapter 9 commencing with section 7000) of Division 3 of the Business and Professions Code and my license is in full force and effect.

License Class B License Number 46328 Date 8/27/99 Contractor Signature [Signature]

OWNER-BUILDER DECLARATION: I hereby affirm under penalty of perjury that I am exempt from the contractor's License Law for the following reason (Sec. 7031.5, Business and Professions Code, any city or county which requires a permit to construct, alter, improve, demolish, or repair any structure, prior to its issuance, also requires the applicant for such permit to file a signed statement that he or she is licensed pursuant to the provisions of the Contractors License Law (Chapter 9 (commencing with Section 7000) of Division 8 of the Business and Professions Code) or that he or she is exempt therefrom and the basis for the alleged exemption. Any violation of Section 7031.5 by any applicant for a permit subjects the applicant to a civil penalty of not more than five hundred dollars (\$500.00).

I, as a owner of the property, or my employees with wages as their sole compensation, will do the work, and the structure is not intended or offered for sale (Sec. 7044, Business and Professional Code: The Contractors License Law does not apply to an owner of property who builds or improves thereon, and who does such work himself or herself or through his/her own employees, provided that such improvements are not intended or offered for sale. If, however, the building or improvement is sold within one year of completion, the owner-builder will have the burden of proving that he/she did not build or improve for the purpose of sale.)

I, as owner of the property, am exclusively contracting with licensed contractors to construct the project (Sec. 7044, Business and Professions Code. The Contractors License Law does not apply to an owner of property who builds or improves thereon, and who contracts for such projects with a contractor(s) licensed pursuant to the Contractors License Law)

I am exempt under Sec. _____ B & PC for this reason: _____

Date _____ Owner Signature _____

IN ISSUING THIS BUILDING PERMIT, the applicant represents, and the city relies on the representation of the applicant, that the applicant verified all measurements and locations shown on the application or accompanying drawings and that the improvement to be constructed does not violate any law or private agreement relating to permissible or prohibited locations for such improvements. This building permit does not authorize any illegal location of any improvement or the violation of any private agreement relating to location of improvements.

I certify that I have read this application and state that all information is correct. I agree to comply with all city and county ordinances and state laws relating to building construction and hereby authorize representative(s) of this city to enter upon the abovementioned property for inspection purposes.

Date 8/27/99 Applicant/Agent Signature [Signature]

WORKER'S COMPENSATION DECLARATION: I hereby affirm under penalty of perjury one of the following declarations:
I have and will maintain a certificate of consent to self-insure for workers' compensation as provided for by Section 3700 of the Labor Code, for the performance of work for which the permit is issued.

I have and will maintain workers' compensation insurance, as required by Section 3700 of the Labor Code, for the performance of the work for which this permit is issued. My workers' compensation insurance carrier and policy number are:

Carrier: STATE FUND Policy Number: 1442812-98 Exp Date: 10/01/1999

This section need not be completed if the permit is for \$100 or less) I certify that in the performance of the work for which this permit is issued, I shall not employ any person in any manner so as to become subject to the workers' compensation laws of California and agree that if I should become subject to the workers' compensation provisions of Section 3700 of the Labor Code, I shall forthwith comply with those provisions.

Date 8/27/99 Applicant Signature [Signature]

WARNING: FAILURE TO SECURE WORKER'S COMPENSATION COVERAGE IS UNLAWFUL AND SHALL SUBJECT AN EMPLOYER TO CRIMINAL PENALTIES AND CIVIL FINES UP TO ONE HUNDRED THOUSAND DOLLARS (\$100,000) IN ADDITION TO THE COST OF COMPENSATION, DAMAGES AS PROVIDED FOR IN SECTION 3706 OF THE LABOR CODE, INTEREST AND ATTORNEY'S FEE.

THIS PERMIT SHALL EXPIRE BY LIMITATION IF WORK IS NOT COMMENCED WITHIN 180 DAYS.

Natomas Unified School District
 1515 Sports Drive, #1 • Sacramento, CA 95834-1905
 Phone 916/641-3300 • Fax 916/928-1629

C E R T I F I C A T I O N O F C O M P L I A N C E
SCHOOL DISTRICT DEVELOPMENT FEES

PART I: TO BE COMPLETED BY APPLICANT

Property Owner's Name	<i>Mark Thomas</i>
Owner's Address	
Project Address	
Parcel Number	
Subdivision Name	
Number of Units	
Print Applicant's Name	Applicant's Signature
Title of Applicant	
Date	Telephone Number

PART II: TO BE COMPLETED BY BUILDING DEPARTMENT

Plan Identification Number	
Building Type (Check One)	
<input checked="" type="checkbox"/> Residential	<input type="checkbox"/> Apartment/Condominium
	<input type="checkbox"/> Commercial/Industrial
Square Feet of Chargeable Building Area	
Signature	Date
Title	

PART III: TO BE COMPLETED BY NATOMAS UNIFIED SCHOOL DISTRICT

District Certification Number	
Fees Collected:	
Residential:	<i>1710</i> Sq. Ft. X \$ <i>1.93</i> = \$ <i>3300.30</i>
Apartment/Condominium:	Sq. Ft. X \$ = \$
Commercial/Industrial:	Sq. Ft. X \$ = \$
NOTICE TO APPLICANT: Pursuant to government code section 66020 (d), this will serve to notify you that the 90-day approval period in which you may protest the fees, or other payment identified above, will begin to run on the date in which the building or installation permit for this project is issued, or on which they are paid to the District, or to another public entity authorized to collect them on behalf of the District, whichever is earlier	
Applicant Signature:	Date:

This certification covers only the amount of square footage indicated above. Any additions or corrections to the square footage for this project will require an amendment to the Certificate of Compliance.

As the authorized Natomas Unified School District official, I hereby certify that the requirements of Government Code Section 95995 have been complied with by the above signed applicant.

SIGNATURE: _____ DATE: *8/11/99*

TITLE: _____

COUNTY SANITATION DISTRICT NO. 1
SACRAMENTO REGIONAL COUNTY SANITATION DISTRICT
SEWER IMPACT FEE
PERMIT AND CALCULATION SHEET

APPLICATION NO		BLDG PERMIT NO:	
GENERAL INFORMATION		THIS PERMIT GOOD ONLY WHEN VALIDATED BY THE CASHIER	
THIS PERMIT TO CONNECT EXPIRES ONE YEAR FROM DATE OF ISSUANCE			
FEE CALCULATION		BUILDING USE	
INSPECTION		RESIDENTIAL SF <input type="checkbox"/>	MF <input type="checkbox"/>
CSD-1		COMMERCIAL USE	UNITS
SRCSD			
CONSTRUCTION			
IN-LIEU			
TOTAL FEE	2855		
APN:			
DESCRIPTION/ SUBDIVISION		LOT: 23-3	
PROPERTY ADDRESS 11 Eastham Ct			
OWNER			
MAILING ADDRESS			
CITY-STATE-ZIP		PHONE	
ADDITIONAL FEES MAY BE DUE IF CHANGES IN USE INCREASE SEWER IMPACT.			
APPLICANT SIGNATURE			
CONSOLIDATED UTILITY BILLING USE ONLY			
ACCT _____ INPUT _____ START _____			

SCALE 1" = 20'
NORTH

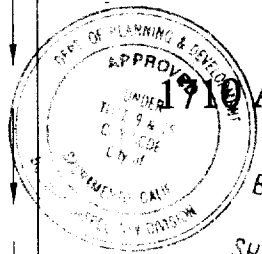
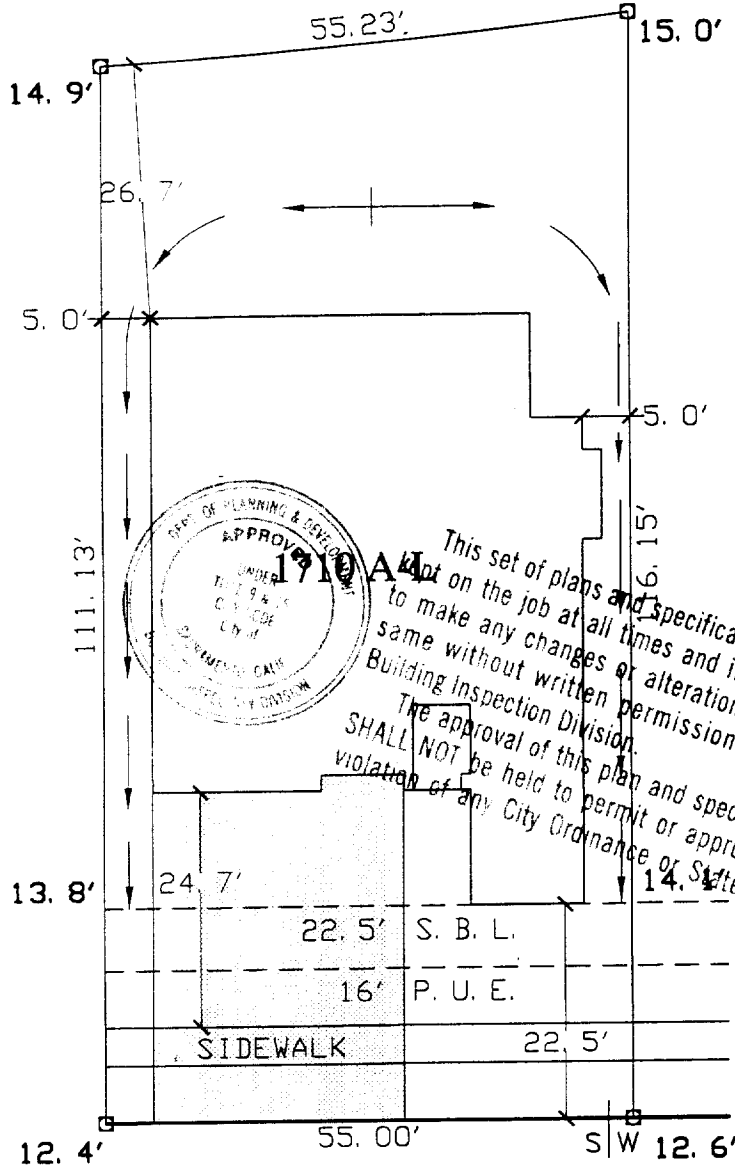

This set of plans and specifications must be used on the job at all times and it is unlawful to make any changes or alterations from the same without written permission from the Building Inspection Division. The approval of this plan and specification SHALL NOT be held to permit or approve the violation of any City Ordinance or State Law.

EASTHAM COURT

(PRIVATE)

A.P.N. :
ADDRESS : EASTHAM COURT
DATE : JUNE 21, 1999
LOT AREA : 6,232 SQ.FT

APPROVED BY _____

<p>The Spink Corporation 2590 VENTURE OAKS WAY SACRAMENTO, CA 95833 PHONE: (916) 925-5550 FAX: (916) 921-9274</p>	<p>HERITAGE PLACE UNIT NO. 3 LOT 23 PLAN 1710 A</p>	<p>RIVERSGATE CITY OF SACRAMENTO, CA. CLIENT: EPICK HOMES #1 L.L.C. JOB NO.: 2808-004</p>
--	---	---