

**CITY OF SACRAMENTO**  
1231 I Street, Sacramento, CA 95814

**Permit No: 0108029**  
**Insp Area: 4**

**Site Address: 2129 BLACKRIDGE AV SAC**  
Parcel No: 225-1400-015  
N

Sub-Type: NSFR  
NORTHPOINTE PARK UNIT 8 1A LOT 15  
Housing (Y/N):

**CONTRACTOR**  
MOURIER JOHN CONSTRUCTION INC  
1830 VERNON ST  
SUITE 9 95687

**OWNER**

**ARCHITECT**

**Nature of Work: MP 2624 2 STORY 11 ROOM SFR. REPLACES PERMIT 0013009. HOUSE DESTROYED BY FIRE DURING CONSTRUCTION.**

**CONSTRUCTION LENDING AGENCY:** I hereby affirm under penalty of perjury that there is a construction lending agency for the performance of the work for which this permit is issued (Sec. 3097, Civ. C.).

Lender's Name \_\_\_\_\_ Lender's Address \_\_\_\_\_

**LICENSED CONTRACTORS DECLARATION:** I hereby affirm under penalty of perjury that I am licensed under provisions of Chapter 9 (commencing with section 7000) of Division 8 of the Business and Professions Code and my license is in full force and effect.

License Class D License Number 613004 Date 6/27/01 Contractor Signature N. Collins

**OWNER-BUILDER DECLARATION:** I hereby affirm under penalty of perjury that I am exempt from the contractors License Law for the following reason (Sec. 7031.5, Business and Professions Code; any city or county which requires a permit to construct, alter, improve, demolish, or repair any structure, prior to its issuance, also requires the applicant for such permit to file a signed statement that he or she is licensed pursuant to the provisions of the Contractors License Law (Chapter 9 (commencing with Section 7000) of Division 8 of the Business and Professions Code) or that he or she is exempt therefrom and the basis for the alleged exemption. Any violation of Section 7031.5 by any applicant for a permit subjects the applicant to a civil penalty of not more than five hundred dollars (\$500.00).

\_\_\_\_\_, I, as a owner of the property, or my employees with wages as their sole compensation, will do the work, and the structure is not intended or offered for sale (Sec. 7044, Business and Professional Code. The Contractors License Law does not apply to an owner of property who builds or improves thereon, and who does such work himself or herself or through his/her own employees, provided that such improvements are not intended or offered for sale. If, however, the building or improvement is sold within one year of completion, the owner-builder will have the burden of proving that he/she did not build or improve for the purpose of sale.)

\_\_\_\_\_, I, as owner of the property, am exclusively contracting with licensed contractors to construct the project (Sec. 7044, Business and Professions Code). The Contractors License Law does not apply to an owner of property who builds or improves thereon, and who contracts for such projects with a contractor(s) licensed pursuant to the Contractors License Law.

\_\_\_\_\_, I am exempt under Sec. \_\_\_\_\_ B & PC for this reason: \_\_\_\_\_

Date \_\_\_\_\_ Owner Signature \_\_\_\_\_

**IN ISSUING THIS BUILDING PERMIT,** the applicant represents, and the city relies on the representation of the applicant, that the applicant verified all measurements and locations shown on the application or accompanying drawings and that the improvement to be constructed does not violate any law or private agreement relating to permissible or prohibited locations for such improvements. This building permit does not authorize any illegal location of any improvement or the violation of any private agreement relating to location of improvements.

I certify that I have read this application and state that all information is correct. I agree to comply with all city and county ordinances and state laws relating to building construction and hereby authorize representative(s) of this city to enter upon the abovementioned property for inspection purposes.

Date 6/27/01 Applicant/Agent Signature N. Collins

**WORKER'S COMPENSATION DECLARATION:** I hereby affirm under penalty of perjury one of the following declarations:

\_\_\_\_\_, I have and will maintain a certificate of consent to self-insure for workers' compensation as provided for by Section 3700 of the Labor Code, for the performance of work for which the permit is issued

I have and will maintain workers' compensation insurance, as required by Section 3700 of the Labor Code, for the performance of the work for which this permit is issued. My workers' compensation insurance carrier and policy number are:

Carrier STATE COMPENSATION INS FUND Policy Number 156326600 Exp Date 10/01/2001

\_\_\_\_\_, (This section need not be completed if the permit is for \$100 or less) I certify that in the performance of the work for which this permit is issued, I shall not employ any person in any manner so as to become subject to the workers' compensation laws of California and agree that if I should become subject to the workers' compensation provisions of Section 3700 of the Labor Code, I shall forthwith comply with those provisions.

Date 6/27/01 Applicant Signature N. Collins

**WARNING: FAILURE TO SECURE WORKER'S COMPENSATION COVERAGE IS UNLAWFUL AND SHALL SUBJECT AN EMPLOYER TO CRIMINAL PENALTIES AND CIVIL FINES UP TO ONE HUNDRED THOUSAND DOLLARS (\$100,000) IN ADDITION TO THE COST OF COMPENSATION, DAMAGES AS PROVIDED FOR IN SECTION 3706 OF THE LABOR CODE, INTEREST AND ATTORNEY'S FEE.**

**THIS PERMIT SHALL EXPIRE BY LIMITATION IF WORK IS NOT COMMENCED WITHIN 180 DAYS.**

**RESIDENTIAL BUILDING PERMIT APPLICATION**

- New Construction    
  Addition    
  Remodels    
  Other

Project Address: 2129 Blackridge Ave     Assessor Parcel # 225-1300-015

**OWNER INFORMATION:**

*Lot #15*

Legal Property Owner: John Maurier Construction     Phone # (916) 969-2842  
 Owner Address: 1830 VERNON STREET, #9     City Roseville     State Ca.     Zip 95678

**CONTRACTOR INFORMATION:** Northgate Park Unit #8 Village #1

Contractor: J.M.C.     Lic. # 613004     Phone # 969-2842     Fax# 782-8903

**PROJECT INFORMATION:**

Land Use Zone R14     Occupancy Group R3     Construction Type VN     Fed Code 14  
 No. of stories: 2     No. of rooms: 11     Street width: \_\_\_\_\_  
 1<sup>st</sup> Floor Area 1388     2<sup>nd</sup> Floor Area 1236     Basement \_\_\_\_\_     Roof Material \_\_\_\_\_

| AREA IN SQUARE FOOT OF: | EXISTING | NEW         |
|-------------------------|----------|-------------|
| Dwelling/Living         | _____    | <u>2624</u> |
| Garage/Storage          | _____    | <u>353</u>  |
| Decks/Balconies         | _____    | <u>64</u>   |
| Carports                | _____    | _____       |

SCOPE OF WORK: \_\_\_\_\_

**FOR OFFICE USE ONLY**

- |   |   |   |
|---|---|---|
| <input type="checkbox"/> Information above complete | <input type="checkbox"/> AR Flood Waiver required             | <input type="checkbox"/> Planning Approval                  |
| <input type="checkbox"/> Violation files checked    | <input type="checkbox"/> Flood Elevation Certificate Required | <input type="checkbox"/> Design Review Approval             |
| <input type="checkbox"/> Standard setbacks          | <input type="checkbox"/> Water Development Infill Area        | <input type="checkbox"/> Special Fee Districts Apply: _____ |
| <input type="checkbox"/> County Sewer               |   |   |

**NEW STRUCTURES & ADDITIONS**

❖ THE FOLLOWING MUST BE PROVIDED IN ORDER TO SUBMIT FOR PLAN REVIEW

- |   |   |
|---|---|
| <input type="checkbox"/> 2 COMPLETE PLANS, LEGIBLE & DRAWN TO SCALE   | ❖ Plans to include: site plan, floor plan, elevations, roof/ceiling plan, foundation and structural framing details, and structural calculations for non-conforming structures. |
| <input type="checkbox"/> 3 SETS IF PROJECT IS IN A DESIGN REVIEW AREA |   |
| <input type="checkbox"/> Title 24 Energy Compliance documentation     | <input type="checkbox"/> 11" x 17" copy of floor plan for County Assessor   |
| <input type="checkbox"/> Grading and Erosion Control Questionnaire    | <input type="checkbox"/> Plan Review Fees   |

Date: \_\_\_\_\_ Received by: (staff) \_\_\_\_\_

ACTIVITY/PERMIT # \_\_\_\_\_



**INSULATION CONTRACTORS  
ASSOCIATION  
OF AMERICA**

INSULATION  
CERTIFICATE

57744

1321 DUKE STREET, SUITE 303 • ALEXANDRIA, VA 22314 • (703) 739-0356

THIS IS TO CERTIFY THAT INSULATION HAS BEEN INSTALLED IN CONFORMANCE WITH CURRENT ENERGY REGULATIONS, CALIFORNIA ADMINISTRATIVE CODE, TITLE 24, STATE OF CALIFORNIA, IN THE BUILDING LOCATED AT:

John movich LOT # 15 TRACT # Netomas

STREET 2129 Black Ridge CITY Sacto

EXTERIOR WALLS:

MANUFACTURER F/E THICKNESS/TYPE 3 3/8" R. VALUE 13/19

CEILINGS:

BATTS: F/G THICKNESS/TYPE 10" R. VALUE 30

MANUFACTURER Insul-TV THICKNESS/TYPE 12" MINIMUM R. VALUE 50

MANUFACTURER Insul-TV THICKNESS/TYPE 12" R. VALUE 50

SQUARE FOOTAGE COVERED 1226 NUMBER OF BAGS USED 22

FLOORS: MANUFACTURER \_\_\_\_\_ THICKNESS/TYPE \_\_\_\_\_ R- VALUE \_\_\_\_\_

SLAB ON GRADE: MANUFACTURER \_\_\_\_\_ THICKNESS/TYPE \_\_\_\_\_ R- VALUE \_\_\_\_\_

MANUFACTURER \_\_\_\_\_ THICKNESS/TYPE \_\_\_\_\_ R- VALUE \_\_\_\_\_

WIDTH OF INSULATION \_\_\_\_\_ INCHES

FOUNDATION WALLS: MANUFACTURER \_\_\_\_\_ THICKNESS/TYPE \_\_\_\_\_ R- VALUE \_\_\_\_\_

GENERAL CONTRACTOR \_\_\_\_\_ DATE \_\_\_\_\_

CALIFORNIA CONTRACTORS LICENSE # \_\_\_\_\_

INSULATION CONTRACTOR **ARCADE INSULATION** DATE 1-8-2

CALIFORNIA CONTRACTORS LICENSE #263784 SIGNATURE [Signature] TITLE [Signature]

[REDACTED]

# 15 I

# OMEGA PRODUCTS CORP.

## DIAMOND WALL INSULATING STUCCO SYSTEM

JOB ADDRESS:

J.M.C. Court Yard

ICBO Report #4004

2129 BLACK RIDGE AV.

Date of Job Completion [REDACTED]

2507

PLASTERING CONTRACTOR:

Name: STUCCO WORKS INC.

Address: 5900 WAREHOUSE WAY, SACRAMENTO, CALIFORNIA 95826

Telephone No: (916) 383-6699

Contractor Number of Diamond Wall System 2175

This is to certify that the exterior coating system on the building exterior at the above address has been installed in accordance with the evaluation report specified above and the manufacturer's instructions.

[REDACTED]

Date 2507

*[Signature]*

Signature of authorized representative of  
Plastering Contractor

This installation card must be submitted to the building inspector after completion of work and before final inspection.



# NORTHPOINTE 8-1

## BLACKRIDGE AVE.

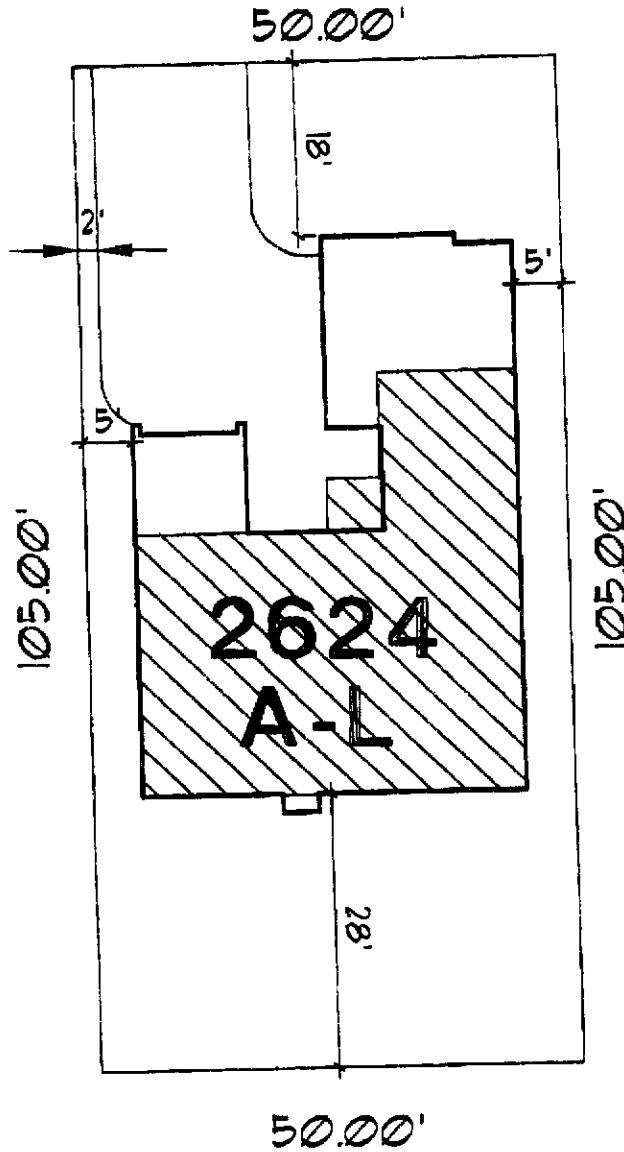

**LOT: 15 SITE ADDRESS: 2129 BLACKRIDGE AVE.**

WHEN USED FOR SALES OR CONTRACT PURPOSES THIS DOCUMENT DOES NOT GUARANTEE ANY DIMENSIONS, DISTANCES, BEARINGS OR SETBACKS. JMC RESERVES THE RIGHT TO MAKE CHANGES AT ANY TIME WITHOUT PRIOR NOTICE AND IS NOT RESPONSIBLE FOR IRREGULARITIES OR DIFFERENCES IN ACTUAL OR "AS-BUILT" LOT CHARACTERISTICS.

|                    |   |
|--------------------|---|
| SCALE: 1"=20'      | COVERAGE: 33%   |
| LOT SIZE: 5250 +/- | APN: 225-0140-015   |
| NP81-P15 DH 101600 | 1650 VERNON ST. No. 9<br>ROSEVILLE, CA 95678<br>916-782-8979<br>CA. LIC. 619004 |

