

**CITY OF SACRAMENTO**  
1231 I Street, Sacramento, CA 95814

**Permit No: 0007065**  
**Insp Area: 4**

**Site Address: 3 HORNBILL CT SAC**  
Parcel No: 225-1210-065 LOT 68 GATEWAY N 2

Sub-Type: NSFR  
Housing (Y/N): N

CONTRACTOR  
MARCHBROOK BUILDING CO  
PO BOX 7576  
STOCKTON CA 95267

OWNER

ARCHITECT

**Nature of Work: MP 3446 2 STORY 11 ROOM SFR**

**CONSTRUCTION LENDING AGENCY :** I hereby affirm under penalty of perjury that there is a construction lending agency for the performance of the work for which this permit is issued (Sec. 3097, Civ. C).

Lender's Name \_\_\_\_\_ Lender's Address \_\_\_\_\_

**LICENSED CONTRACTORS DECLARATION:** I hereby affirm under penalty of perjury that I am licensed under provisions of Chapter 9 (commencing with section 7000) of Division 3 of the Business and Professions Code and my license is in full force and effect.

License Class B License Number 790353 Date 7/12/00 Contractor Signature Paul B...

**OWNER-BUILDER DECLARATION:** I hereby affirm under penalty of perjury that I am exempt from the contractors License Law for the following reason (Sec. 7031.5, Business and Professions Code; any city or county which requires a permit to construct, alter, improve, demolish, or repair any structure, prior to its issuance, also requires the applicant for such permit to file a signed statement that he or she is licensed pursuant to the provisions of the Contractors License Law (Chapter 9 (commencing with Section 7000) of Division 8 of the Business and Professions Code) or that he or she is exempt therefrom and the basis for the alleged exemption. Any violation of Section 7031.5 by any applicant for a permit subjects the applicant to a civil penalty of not more than five hundred dollars (\$500.00):

I, as a owner of the property, or my employees with wages as their sole compensation, will do the work, and the structure is not intended or offered for sale (Sec. 7044, Business and Professional Code: The Contractors License Law does not apply to an owner of property who builds or improves thereon, and who does such work himself or herself or through his/her own employees, provided that such improvements are not intended or offered for sale. If, however, the building or improvement is sold within one year of completion, the owner-builder will have the burden of proving that he/she did not build or improve for the purpose of sale.)

I, as owner of the property, am exclusively contracting with licensed contractors to construct the project (Sec. 7044, Business and Professions Code: The Contractors License Law does not apply to an owner of property who builds or improves thereon, and who contracts for such projects with a contractor(s) licensed pursuant to the Contractors License Law).

I am exempt under Sec. \_\_\_\_\_ B & PC for this reason: \_\_\_\_\_

Date \_\_\_\_\_ Owner Signature \_\_\_\_\_

**IN ISSUING THIS BUILDING PERMIT,** the applicant represents, and the city relies on the representation of the applicant, that the applicant verified all measurements and locations shown on the application or accompanying drawings and that the improvement to be constructed does not violate any law or private agreement relating to permissible or prohibited locations for such improvements. This building permit does not authorize any illegal location of any improvement or the violation of any private agreement relating to location of improvements.

I certify that I have read this application and state that all information is correct. I agree to comply with all city and county ordinances and state laws relating to building construction and hereby authorize representative(s) of this city to enter upon the abovementioned property for inspection purposes.

Date 7/12/00 Applicant/Agent Signature Paul B...

**WORKER'S COMPENSATION DECLARATION:** I hereby affirm under penalty of perjury one of the following declarations:

I have and will maintain a certificate of consent to self-insure for workers' compensation as provided for by Section 3700 of the Labor Code, for the performance of work for which the permit is issued.

to I have and will maintain workers' compensation insurance, as required by Section 3700 of the Labor Code, for the performance of the work for which this permit is issued. My workers' compensation insurance carrier and policy number are:

Carrier SAFECO INSURANCE CO OF AMERICA Policy Number WC2342690B

Exp Date 7/1/2000

JUL 12 2000

(This section need not be completed if the permit is for \$100 or less) I certify that in the performance of the work for which this permit is issued, I shall not employ any person in any manner so as to become subject to the workers' compensation laws of California, and any person who shall be subject to the workers' compensation provisions of Section 3700 of the Labor Code, shall forthwith comply with those provisions.

Date 7/12/00 Applicant Signature Paul B...

**WARNING: FAILURE TO SECURE WORKER'S COMPENSATION COVERAGE IS UNLAWFUL AND SHALL SUBJECT AN EMPLOYER TO CRIMINAL PENALTIES AND CIVIL FINES UP TO ONE HUNDRED THOUSAND DOLLARS (\$100,000) IN ADDITION TO THE COST OF COMPENSATION, DAMAGES AS PROVIDED FOR IN SECTION 3706 OF THE LABOR CODE, INTEREST AND ATTORNEY'S FEE.**

**THIS PERMIT SHALL EXPIRE BY LIMITATION IF WORK IS NOT COMMENCED WITHIN 180 DAYS.**

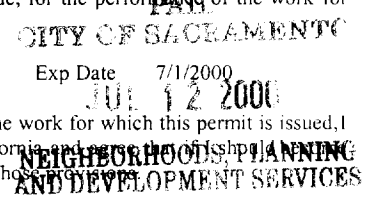

## RESIDENTIAL BUILDING PERMIT APPLICATION

New Construction    
  Addition    
  Remodels    
  Other

Project Address: 3 Humboldt Court                      Assessor Parcel # 225-1210-005

**OWNER INFORMATION:** 6768 - MP 3446

Legal Property Owner: <u>Sundance Lake LLC, A Delaware Limited Liability Co.</u>	Phone # <u>(209) 473-6000</u>
Owner Address: <u>P.O. Box 7576</u> City <u>Stockton</u> State <u>CA</u> Zip <u>95267</u>	

**CONTRACTOR INFORMATION:**

Contractor: <u>Marchbrook Building Co</u> Lic. # <u>740353</u> Phone # <u>(209) 473-6000</u> Fax # <u>(209) 473-6044</u>
--

**PROJECT INFORMATION:**

Land Use Zone _____	Occupancy Group _____	Construction Type _____	Fed Code _____
No. of stories: <u>2</u>	No. of rooms: <u>11</u>	Street width: _____	
1 <sup>st</sup> Floor Area <u>1513</u>	2 <sup>nd</sup> Floor Area <u>1823</u>	Basement _____	Roof Material _____

AREA IN SQUARE FOOT OF:	EXISTING	NEW
Dwelling/Living	<u>3446</u>	_____
Garage/Storage	<u>632</u>	_____
Decks/Balconies	<u>144</u>	_____
Carports	<u>DIA</u>	_____

SCOPE OF WORK: SFD

**FOR OFFICE USE ONLY**

<input type="checkbox"/> Information above complete	<input type="checkbox"/> AR Flood Waiver required	<input type="checkbox"/> Planning Approval
<input type="checkbox"/> Violation files checked	<input type="checkbox"/> Flood Elevation Certificate Required	<input type="checkbox"/> Design Review Approval
<input type="checkbox"/> Standard setbacks	<input type="checkbox"/> Water Development Infill Area	<input type="checkbox"/> Special Fee Districts Apply : _____
<input type="checkbox"/> County Sewer	_____	

**NEW STRUCTURES & ADDITIONS**

❖ THE FOLLOWING MUST BE PROVIDED IN ORDER TO SUBMIT FOR PLAN REVIEW

<input type="checkbox"/> <b>2 COMPLETE PLANS, LEGIBLE &amp; DRAWN TO SCALE</b> <input type="checkbox"/> <b>3 SETS IF PROJECT IS IN A DESIGN REVIEW AREA</b>	❖ <i>Plans to include: site plan, floor plan, elevations, roof/ceiling plan, foundation and structural framing details, and structural calculations for non-conforming structures.</i>
<input type="checkbox"/> Title 24 Energy Compliance documentation <input type="checkbox"/> Grading and Erosion Control Questionnaire	<input type="checkbox"/> 11" x 17" copy of floor plan for County Assessor <input type="checkbox"/> Plan Review Fees

Date: \_\_\_\_\_ Received by: (staff) \_\_\_\_\_

ACTIVITY/PERMIT #
-------------------

MARCH BROOK

INSULATION  
CERTIFICATE

# WES PAC INSULATION, INC.

THIS IS TO CERTIFY THAT INSULATION HAS BEEN INSTALLED IN CONFORMANCE WITH CURRENT ENERGY REGULATIONS, CALIFORNIA ADMINISTRATIVE CODE, TITLE 24, STATE OF CALIFORNIA, IN THE BUILDING LOCATED AT;

Sundance Lake LOT # 68 TRACT # 4

STREET \_\_\_\_\_ CITY \_\_\_\_\_

EXTERIOR WALLS:

MANUFACTURER Sm THICKNESS/TYPE 3 1/2 R-VALUE 13

CEILINGS:

BATTS: MANUFACTURER Sm THICKNESS/TYPE 12 R-VALUE 38

BLOWN IN: MANUFACTURER Green Fiber THICKNESS/TYPE 10.3 R-VALUE 38

SQUARE FOOTAGE COVERED 1863 NUMBER OF BAGS USED 69

FLOORS:

MANUFACTURER \_\_\_\_\_ THICKNESS/TYPE \_\_\_\_\_ R-VALUE \_\_\_\_\_

SLAB ON GRADE:

MANUFACTURER \_\_\_\_\_ THICKNESS/TYPE \_\_\_\_\_ R-VALUE \_\_\_\_\_

WIDTH OF INSULATION \_\_\_\_\_ INCHES

FOUNDATION WALLS:

MANUFACTURER \_\_\_\_\_ THICKNESS/TYPE \_\_\_\_\_ R-VALUE \_\_\_\_\_

GENERAL CONTRACTOR \_\_\_\_\_

CALIFORNIA CONTRACTORS LICENSE # \_\_\_\_\_

DATE \_\_\_\_\_

SIGNATURE

TITLE

INSULATION CONTRACTOR WES PAC INSULATION, INC.

CALIFORNIA CONTRACTORS LICENSE # \_\_\_\_\_

#487478 DATE \_\_\_\_\_

Debra Williams O/A

SIGNATURE

TITLE

WINDSONG STREET

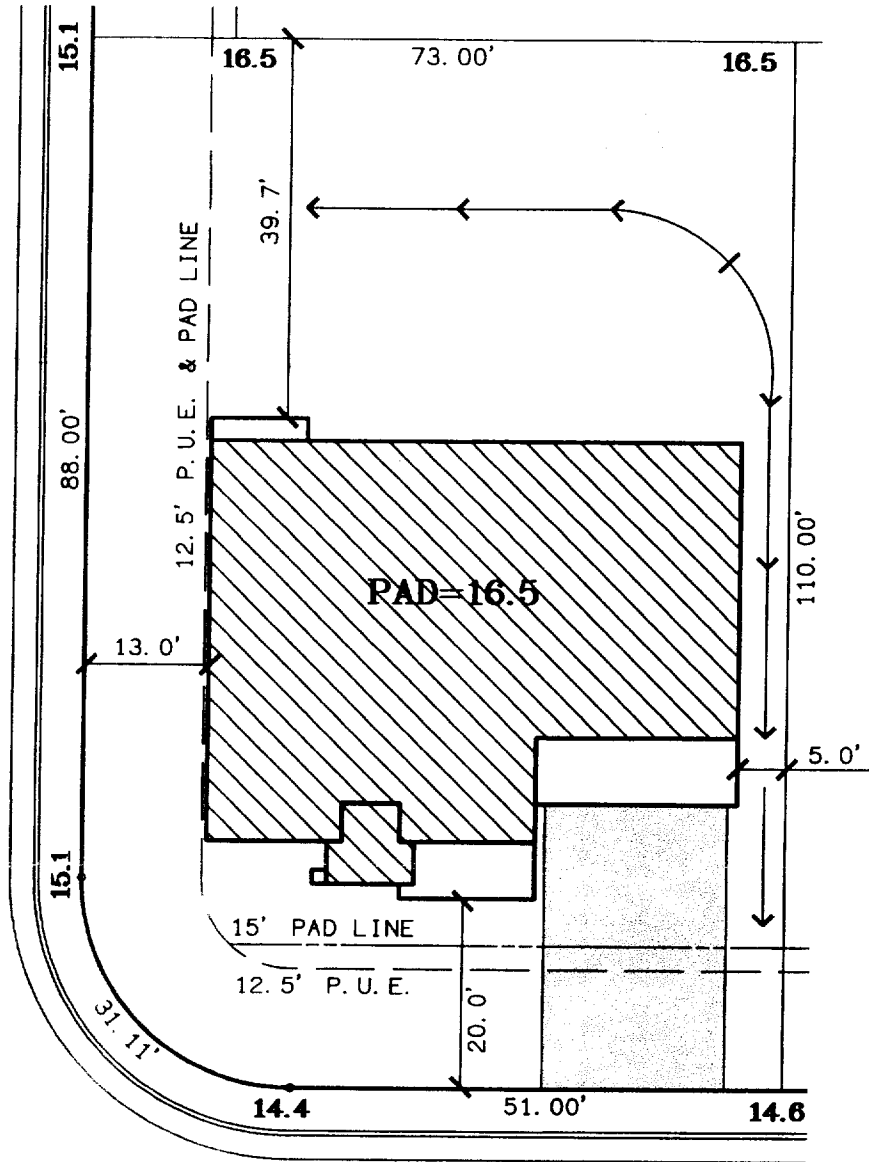

HORNBILL COURT

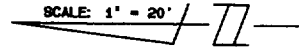

LOT 68  
 PLAN 4A RIGHT  
 A.P.N.:  
 ADDRESS: HORNBILL COURT  
 LOT AREA: 7,926 SF  
 LOT COVERAGE: 30%

**The Splink Corporation**

2590 VENTURE OAKS WAY  
 SACRAMENTO, CA 95833

PH:(916)925-5550 FAX:(916)921-9274

**MARCHBROOK BUILDING COMPANY**

P.O. Box 7576  
 Stockton, Ca 95267

office: (209) 473-8053  
 fax: (209) 951-0684

**GATEWAY NORTH  
 VILLAGE 2**

City of Sacramento, California

Scale: 1"=20'

June 14, 2000