

CITY OF SACRAMENTO

Permit No: 9810409

1231 I Street, Sacramento, CA 95814

Insp Area: 3

Site Address: 4300 82ND ST SAC
Parcel No: 0610061039

Sub-Type: NOTHR
Housing (Y/N): N

CONTRACTOR

JACKSON CONSTRUCTION
5665 POWER INN RD #140
SACRAMENTO CA 95824

OWNER

2ND/ALPINE PARTNERSHIP
5665 POWER INN RD #140
SACRAMENTO CA 95824

ARCHITECT

Nature of Work: INSTALLATION OF BACKFLOW PREVENTER ON POTABLE WATER SUPPLY

CONSTRUCTION LENDING AGENCY: I hereby affirm under penalty of perjury that there is a construction lending agency for the performance of the work for which this permit is issued (Sec. 3097, Civ. C).

Lender's Name Lender's Address

LICENSED CONTRACTORS DECLARATION: I hereby affirm under penalty of perjury that I am licensed under provisions of Chapter 9 (commencing with section 7000) of Division 3 of the Business and Professions Code and my license is in full force and effect.

License Class B License Number 365437 Date 19 OCT 98 Contractor Signature [Signature]

OWNER-BUILDER DECLARATION: I hereby affirm under penalty of perjury that I am exempt from the contractors License Law for the following reason (Sec. 7031.5, Business and Professions Code; any city or county which requires a permit to construct, alter, improve, demolish, or repair any structure, prior to its issuance, also requires the applicant for such permit to file a signed statement that he or she is licensed pursuant to the provisions of the Contractors License Law (Chapter 9 (commencing with Section 7000) of Division 8 of the Business and Professions Code) or that he or she is exempt therefrom and the basis for the alleged exemption. Any violation of Section 7031.5 by any applicant for a permit subjects the applicant to a civil penalty of not more than five hundred dollars (\$500.00);

I, as a owner of the property, or my employees with wages as their sole compensation, will do the work, and the structure is not intended or offered for sale (Sec. 7044, Business and Professional Code: The Contractors License Law does not apply to an owner of property who builds or improves thereon, and who does such work himself or herself or through his/her own employees, provided that such improvements are not intended or offered for sale. If, however, the building or improvement is sold within one year of completion, the owner-builder will have the burden of proving that he/she did not build or improve for the purpose of sale.)

I, as owner of the property, am exclusively contracting with licensed contractors to construct the project (Sec. 7044, Business and Professions Code: The Contractors License Law does not apply to an owner of property who builds or improves thereon, and who contracts for such projects with a contractor(s) licensed pursuant to the Contractors License Law).

I am exempt under Sec. B & PC for this reason:

Date Owner Signature

IN ISSUING THIS BUILDING PERMIT, the applicant represents, and the city relies on the representation of the applicant, that the applicant verified all measurements and locations shown on the application or accompanying drawings and that the improvement to be constructed does not violate any law or private agreement relating to permissible or prohibited locations for such improvements. This building permit does not authorize any illegal location of any improvement or the violation of any private agreement relating to location of improvements.

I certify that I have read this application and state that all information is correct. I agree to comply with all city and county ordinances and state laws relating to building construction and hereby authorize representative(s) of this city to enter upon the abovementioned property for inspection purposes.

Date 19 OCT 98 Applicant/Agent Signature [Signature]

WORKER'S COMPENSATION DECLARATION: I hereby affirm under penalty of perjury one of the following declarations:

I have and will maintain a certificate of consent to self-insure for workers' compensation as provided for by Section 3700 of the Labor Code, for the performance of work for which the permit is issued.

I have and will maintain workers' compensation insurance, as required by Section 3700 of the Labor Code, for the performance of the work for which this permit is issued. My workers' compensation insurance carrier and policy number are:

Carrier CALIFORNIA COMPENSATION Policy Number WP7C113055 12-20-98

(This section need not be completed if the permit is for \$100 or less) I certify that in the performance of the work for which this permit is issued, I shall not employ any person in any manner so as to become subject to the workers' compensation laws of California and agree that if I should become subject to the workers' compensation provisions of Section 3700 of the Labor Code, I shall forthwith comply with those provisions.

Date 19 OCT 98 Applicant Signature [Signature]

WARNING: FAILURE TO SECURE WORKER'S COMPENSATION COVERAGE IS UNLAWFUL AND SHALL SUBJECT AN EMPLOYER TO CRIMINAL PENALTIES AND CIVIL FINES UP TO ONE HUNDRED THOUSAND DOLLARS (\$100,000) IN ADDITION TO THE COST OF COMPENSATION, DAMAGES AS PROVIDED FOR IN SECTION 3706 OF THE LABOR CODE, INTEREST AND ATTORNEY'S FEE.

THIS PERMIT SHALL EXPIRE BY LIMITATION IF WORK IS NOT COMMENCED WITHIN 180 DAYS.



COUNTY OF SACRAMENTO
Environmental Management Department
 Mel Knight, Director

Bonnie Coleman, Manager
 Administrative Services
 Raymond E. Hackett, Manager
 Environmental Health
 Robert A. Knight, Manager
 Hazardous Materials

JOB 214
 CC 41700

RECEIVED

OCT 05 1998

October 2, 1998

82ND / ALPINE PARTNERSHIP
 5665 POWER INN RD STE 140
 SACRAMENTO, CA 95824
 Care of: JACKSON PROPERTIES, INC.

ISSUED

SURVEY DATE: 9/1/98

OCT 13 1998

Dear JACKSON PROPERTIES, INC.:

CITY OF SACRAMENTO
 DEVELOPMENT SERVICES DIV.

**SUBJECT: INSTALLATION OF BACKFLOW PREVENTION ASSEMBLY AT:
 4300 82ND ST IN SACRAMENTO, CALIFORNIA**

Introduction

State and local codes require public water purveyors to protect public water systems from contamination through appropriate backflow prevention measures at designated water service connections. A recent survey of the subject premises has identified it as presenting a real or potential hazard for backflow contamination into the public water system.

Action needed

Based on the survey information, Sacramento City Cross-Connection Control Policy requires that an approved reduced pressure principle backflow prevention assembly be installed at the water service connection within thirty (30) days from the date of this letter. Also, the assembly is to be tested by a Sacramento County certified backflow prevention assembly tester at the time of installation, and annually thereafter.

Attachments

- ✓ A copy of the Survey Report *and it is unclear if it is must be*
- ✓ General installation instructions and diagrams
- ✓ List of approved backflow prevention assemblies
- ✓ List of County certified backflow prevention assembly testers.

Water purveyor

For water services three (3) inches and larger, City of Sacramento, Department of Utilities, will provide a new water meter, meter strainer, and meter test spool. Your contractor will need to install them above grade on the backflow prevention assembly. Please contact Mr. Mike Dragash from City of Sacramento, Department of Utilities, Cross-Connection Control Program at (916) 433-6229 for specific installation instructions and specifications.

Plumbing Permit

Prior to installation of backflow prevention assembly, the premise water system should be evaluated for temperature and pressure relief devices for hot water systems. Adequate supply and pressure in the water system will need to be considered to ensure proper operation of plumbing fixtures and fire protection systems.

82ND / ALPINE PARTNERSHIP
5665 POWER INN RD STE 140
October 2, 1998
Page two

**Plumbing Permit,
con't**

A plumbing permit from the City of Sacramento, Planning and Development Services Department, Permit Services Division, located at 1231 I Street, Suite 200 may be required for this installation. Please present the Survey Report when applying for this permit.

Questions

If you or your contractor have any questions regarding this notification, I can be reached at (916) 875-8428, or by facsimile at (916) 875-8513.

Thank you for your cooperation.

Sincerely,

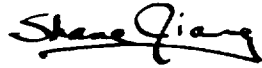

Shane Jiang, R.E.H.S.
Senior Environmental Health Specialist
Cross-Connection Control Program

SJ:ft

Enclosures

W:\XCONNECT\LETTERS\Install1.doc

ISSUED

OCT 13 1998

CITY OF SACRAMENTO
DEVELOPMENT SERVICES DIV.

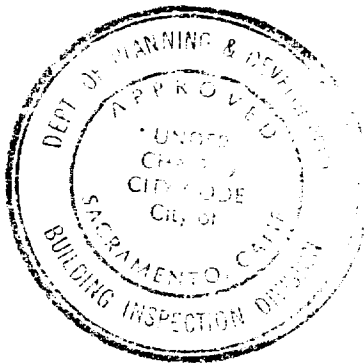

This set of plans and specifications must be kept on file at all times and it is unlawful to make any changes or alterations from the approved plans without permission from the Building Inspection Division.

The approval of this plan and specifications SHALL NOT be held to permit or approve the violation of any City Ordinance or State Law.



CROSS CONNECTION CONTROL SURVEY FORM

City- 320

* 7619
 Service Address: 4300 82ND ST.
 Water Customer: 82ND/ALPINE PARTNERSHIP
 Mailing Address: 5665 POWER INN Rd. #140
SACTO. CA. 95824
 Type of Business: STEAM CLEANER REPAIR
 Contact/Phone: _____
 Sacramento City/County Code: CITY #34

AGENCY APPROVALS

Water Purveyor: _____

Env. Health: _____

County: _____

City BID: _____

PERMIT NUMBER: 22 1998

ENTERED

Type of Facility Commercial Residential Industrial Other _____

	Service Connections	Existing Type of Protection	Required Protection
Domestic:	<u>1</u>	<input type="checkbox"/> RP <input type="checkbox"/> DC <input type="checkbox"/> AG <input checked="" type="checkbox"/> None	<input checked="" type="checkbox"/> RP <input type="checkbox"/> DC <input type="checkbox"/> AG <input type="checkbox"/> None <input type="checkbox"/> Other _____
Fire:	_____	<input type="checkbox"/> RP <input type="checkbox"/> DC <input type="checkbox"/> None	<input type="checkbox"/> RP <input type="checkbox"/> DC <input type="checkbox"/> None <input type="checkbox"/> Other _____
Irrigation:	_____	<input type="checkbox"/> RP <input type="checkbox"/> PVB <input type="checkbox"/> None	<input type="checkbox"/> RP <input type="checkbox"/> None <input type="checkbox"/> Other _____

Comments: METER #2793
OWNER TO INSTALL REDUCED PRESSURE BACKFLOW ASSEMBLY AT REAR OF WATER METER.

Water Purveyor: CITY OF SACTO. Representative: M. DRAGAN T. LAUREN
 Date of Survey: 9.1.98 Telephone: (916) 433-6229

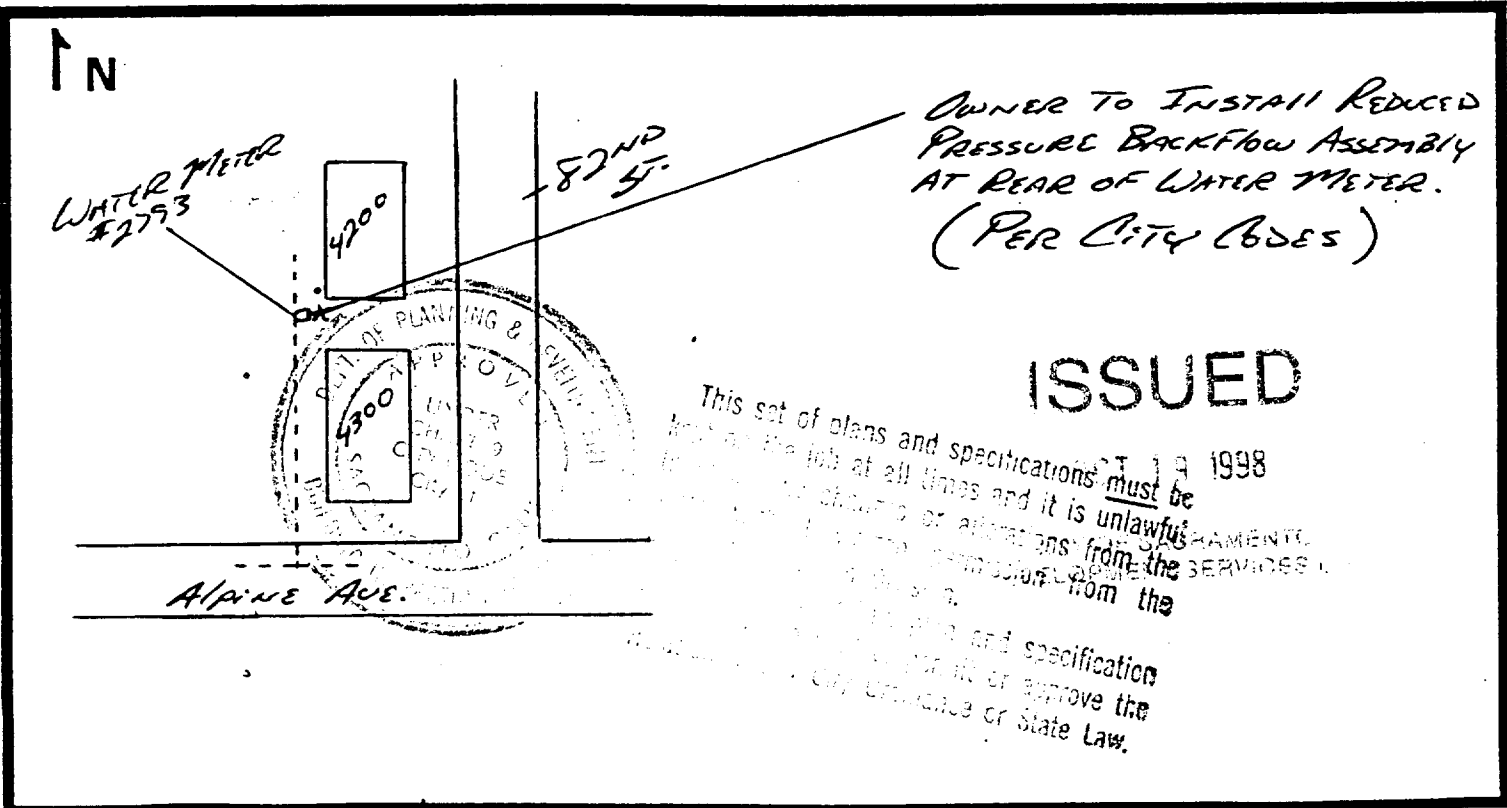

ISSUED

SEP 19 1998

This set of plans and specifications must be kept on the job at all times and it is unlawful to make any changes or alterations from the original specifications without the approval of the City Engineer and specification.

Department of Planning & Community Development

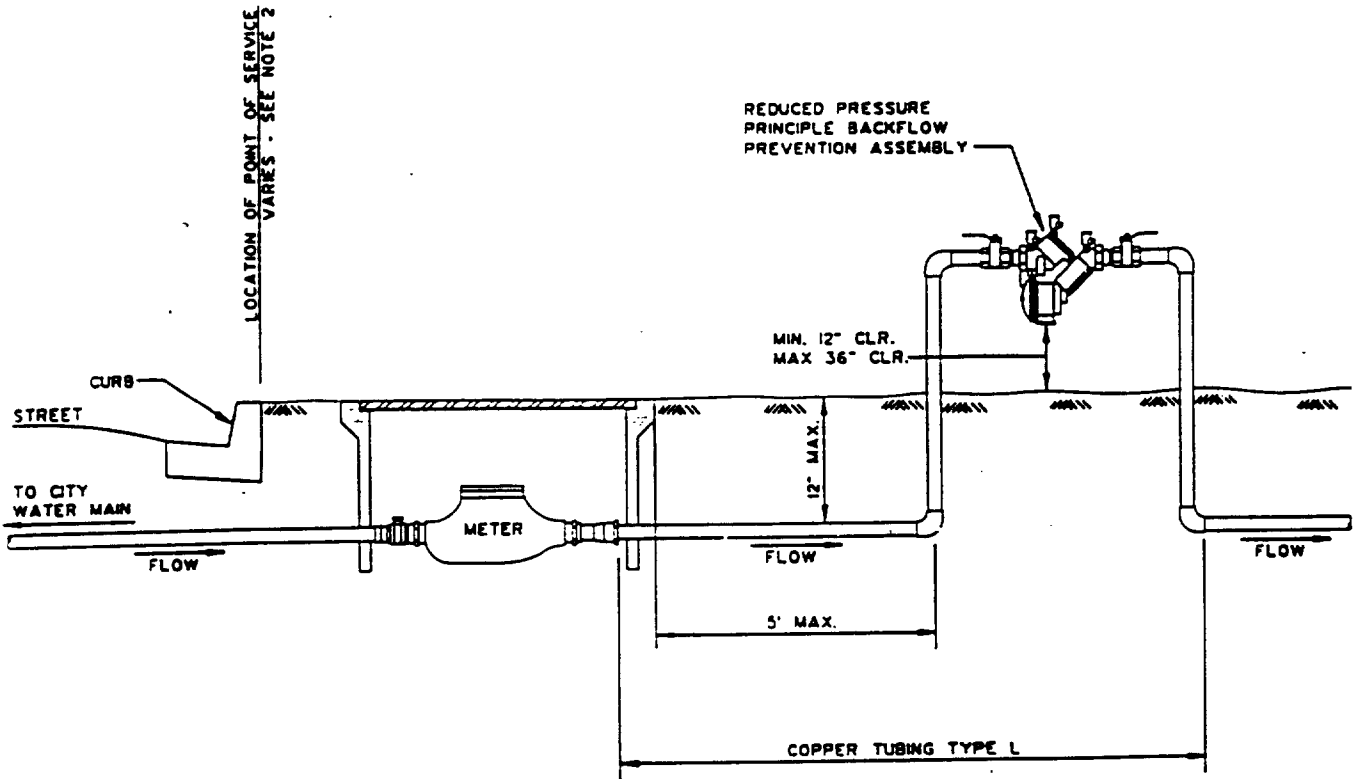

INSTALLATION OF 2-INCH AND SMALLER REDUCED PRESSURE PRINCIPLE BACKFLOW PREVENTION ASSEMBLY W/WATER METER

NO SCALE

ISSUED

OCT 19 1998

CITY OF SACRAMENTO
DEVELOPMENT SERVICES DIV

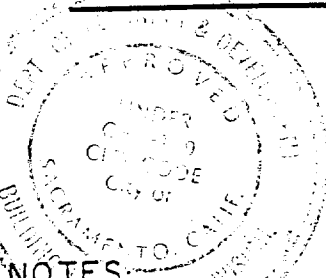

This set of plans and specifications must be kept on file at all times and it is unlawful to make any changes or alterations from the original without the permission from the Department of Utilities.

NOTES:

1. REDUCED PRESSURE BACKFLOW PREVENTION ASSEMBLIES MUST BE CONNECTED TO CITY WATER AND TESTED PRIOR TO BEING PLACED INTO SERVICE.
2. POINT OF SERVICE:
 - A. POINT OF SERVICE IS THE BACK OF CURB FOR ALL CITY STREETS WITH PLANTER STRIPS.
 - B. POINT OF SERVICE IS THE BACK OF SIDEWALK FOR STREETS WITH SIDEWALK CONTIGUOUS WITH CURB AND GUTTER.
 - C. POINT OF SERVICE IS THE RIGHT-OF-WAY LINE ON ALL ALLEYS AND UNIMPROVED STREETS.
 - D. WHERE THE POINT OF SERVICE IS UNCLEAR THE LOCATION SHALL BE DETERMINED BY THE CROSS CONNECTION CONTROL SPECIALIST OR HIS DESIGNEE.
3. LISTS OF APPROVED BACKFLOW PREVENTION ASSEMBLIES AND CERTIFIED BACKFLOW PREVENTION ASSEMBLY TESTORS ARE AVAILABLE AT THE DEPARTMENT OF UTILITIES CUSTOMER SERVICE COUNTER.
4. THE BACKFLOW PREVENTION ASSEMBLIES SHALL BE INSTALLED ABOVE GROUND, IN A HORIZONTAL AND LEVEL POSITION. THE ASSEMBLY SHALL BE LOCATED ON THE CUSTOMER'S SIDE AND NO FURTHER THAN FIVE (5) FEET FROM THE POINT OF SERVICE OR THE METER.
5. NO OUTLET, TAP, TEE, OR CONNECTION BETWEEN THE WATER MAIN AND BACKFLOW PREVENTER IS ALLOWED UNLESS APPROVED BY THE DEPARTMENT OF UTILITIES.
6. CONCRETE PAD IS RECOMMENDED IF ASSEMBLY IS PLACED WITHIN A PROTECTIVE ENCLOSURE.
7. FREEZE BAGS ARE RECOMMENDED FOR FREEZE PROTECTION.



INSTALLATION OF 2-INCH AND SMALLER REDUCED PRESSURE PRINCIPLE BACKFLOW PREVENTION ASSEMBLY W/WATER MTR

APPROVED: *[Signature]* SCALE: NONE
DATE: JANUARY 1997 DWG. NO. TDW-31A

C:\V0651\TDW\TDW 31A.Dwg



CROSS CONNECTION CONTROL PROGRAM

Approved Backflow Prevention Assemblies List

Supersedes all prior lists. Revised -- JULY 21, 1998

Unless otherwise noted in this document, all assemblies are approved for horizontal and level orientation only. Unless otherwise specified by the manufacturer, all assemblies are to be installed on cold water applications. (Below 110 degrees Fahrenheit)

All assembly manufacturers are listed in ascending alphabetical order; there is no implication of assembly preference.

REDUCED PRESSURE PRINCIPLE ASSEMBLIES (PAGES 9 THROUGH 12)

<u>MANUFACTURER</u>	<u>MODEL</u>	<u>SIZE</u>
AMES	4000B	1/2, 3/4, 1, 1 1/4, 1 1/2, 2"
	4000SS	2 1/2, 3, 4, 6"
	4000RP	4, 6, 8, 10"
BEECO	>SEE HERSEY/GRINNELL	
CLA-VAL	RP-2	3/4, 1, 1 1/4, 1 1/2"
	RP-4	2, 2 1/2, 3, 4, 6, 8, 10"
	RP4V	4"
CONBRACO	RP6LW	3/4, 1, 1 1/4, 1 1/2, 2"
	RP6VW	3/4, 1, 1 1/2, 2"
	RP7LW	2 1/2, 3, 4, 6, 8, 10"
	RP7LY	2 1/2, 3, 4, 6, 8, 10"
	RP8LW	2 1/2, 3, 4, 6, 8"
	RP8LY	2 1/2, 3, 4, 6, 8"
	RP8NW	2 1/2, 3, 4, 6, 8, 10"
	RP8NY	2 1/2, 3, 4, 6, 8, 10"
	RP8VW	2 1/2, 3, 4, 6, 8, 10" (N & Z configurations)
	RP8VY	2 1/2, 3, 4, 6, 8, 10" (N & Z configurations)
	40-200-02	3"
	40-200-03	3"
40-201-02	1/4"	
40-201-A2	1/4"	
40-201-A2S	1/4"	
40-202-02	3/8"	
40-202-A2	3/8"	
40-202-A2S	3/8"	
40-203-02	1/2"	
40-203-A2	1/2"	
40-203-A2S	1/2"	
40-204-02	3/4"	
40-204-A2	3/4"	
40-204-A2S	3/4"	
40-204-A2U	3/4"	
40-204-A2Z	3/4"	

NOTE: Model RP4V is approved for vertical installation (only) with the flow of water vertically upward.

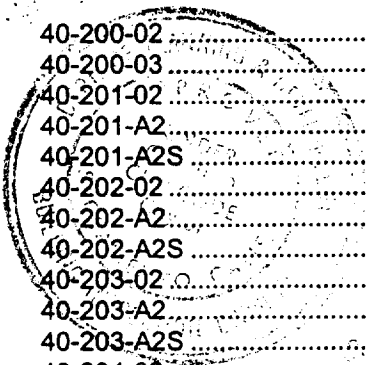

ISSUED

OCT 19 1998

DEPARTMENT OF WATER RESOURCES
 DIVISION OF PERMITS AND SERVICES
 This set of plans and specifications must be used for all times and it is unlawful to make any changes or alterations from the original without permission from the Department Director.
 No fee to permit or approve the any City Ordinance or State Law



CROSS CONNECTION CONTROL PROGRAM

Approved Backflow Prevention Assemblies List

Supersedes all prior lists. Revised -- JULY 21, 1998

REDUCED PRESSURE PRINCIPLE ASSEMBLIES (Cont'd)

NEPTUNE..... >SEE WILKINS

ORION

80-0069	1½"
9-2929	2"
BRP	¾, 1, 3, 4"

NOTE: All Orion assemblies utilize inlet piping running vertically upward and outlet piping running vertically downward.

RICHWELL..... >SEE WILKINS

TORO..... >SEE ORION

WATTS

009.....	2½, 3, 4, 6"
009M1QT.....	1¼, 1½, 2"
009M1PCQT.....	1¼, 1½, 2"
009M2QT.....	¾, 1, 1¼, 1½, 2"
009M2PCQT.....	1¼, 1½, 2"
009PCQT.....	½, ¾, 1, 1¼, 1½, 2"
009QT.....	¼, ¾, 1, 1¼, 1½, 2"
009SSM1QT.....	2"
009SSM1PCQT.....	2"
009SSPCQT.....	¾, 1, 1¼, 1½, 2"
009SSQT.....	¾, 1, 1¼, 1½, 2"
909.....	2½, 3, 4, 6"
909BB.....	2½, 3"
909HWQT.....	¾, 1"
909HWM1QT.....	1¼, 1½, 2"
909M1.....	8, 10"
909M1QT.....	1¼, 1½, 2"
909M1CTFDA.....	8, 10"
909PCHWM1QT.....	1¼, 1½, 2"
909PCHWQT.....	¾, 1"
909PCM1QT.....	1¼, 1½, 2"
909PCQT.....	¾, 1"
909QT.....	¾, 1"
909QT.....	¾, 1" (vertical up)
909QTFDA.....	2½, 3, 4, 6"
990.....	4, 8"
990QTFDA.....	4, 8"
992.....	4, 10"
994.....	2½, 3, 4, 6"
FAE909QT.....	1¼, 1½, 2"
FAE909HWQT.....	1¼, 1½, 2"
SS009QT.....	1"
U009APCQT.....	¾, 1"
U009AQT.....	¾, 1"

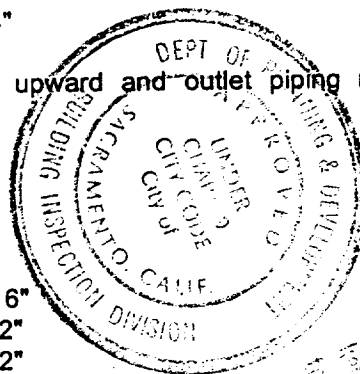

The requirements and specifications must be met in all cases and it is unlawful to make any alterations or additions from the same without written permission from the Building Inspection Division. The approval of this plan and specification shall not be held to permit or approve the violation of any City Ordinance or State Law.

ISSUED

OCT 19 1998

CITY OF SACRAMENTO
DEVELOPMENT SERVICES DIV.

FIXTURE TYPE	NO.	COLD WATER		HOT WATER		WASTE	
		FU	TOTAL	TOTAL @ 75%	FU	TOTAL	
WC (TANK)	x	5	=			6	=
WC (FV)	5 - x	10	= 50			6	=
UR	x	5	=			2	=
LAV	5 - x	2	= 10	8		1	=
KS	x	4	=			3	=
MSK	x	4	=			3	=
SSK	5 - x	4	= 20	15		3	=
EDF	x	1	=			1	=
HB	7 - x	3	= 21			0	=
FS	x	0	=			2	=
FD-3"	x	0	=			3	=
FD-2"	x	0	=			2	=
SHR	x	4	=			2	=
BT	x	4	=			2	=
DW	x	8	=			3	=
WASHER (FUTURE)	x	4	=			2	=

ISSUED

OCT 19 1998

CITY OF SACRAMENTO
DEVELOPMENT SERVICES DIV

TOTAL UNITS

101

23

PUMP TO
FIXTURE

METER
TO PUMP

CW FIXTURE UNITS =

IRRIGATION DEMAND,

COOLING TOWER DEMAND,

A. TOTAL SUPPLY DEMAND,

B. MIN DAILY SERVICE PRESSURE,

C. MIN FIXTURE PRESSURE,

D. ELEVATION LOSS, (5 ft x 0.43)

E. METER LOSS,

F. BACKFLOW PREVENTER LOSS,

G. PRESSURE AVAIL FOR FRICTION LOSS
(B - C - D - E - F = G)

H. DEVELOPED PIPE LENGTH

I. AVG ALLOWABLE FRICTION LOSS
(G x 100 / H)

J. PROPOSED SIZE MAIN (COPPER) (STEEL)

K. VELOCITY IN MAIN

L. PROPOSED FRICTION LOSS IN MAIN

M. HW DEMAND _____ GPM, _____ PIPE SIZE @ _____ FPS

N. SEWER _____ VERT _____ HORT. _____ % SLOPE

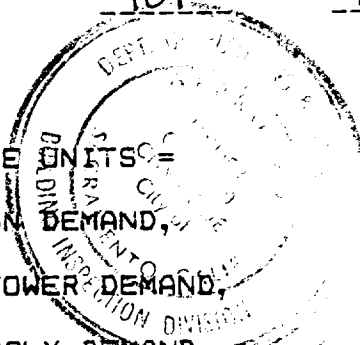

This set of plans and specifications shall not be taken as a violation of any City Ordinance or State Law. I, _____, Engineer, do hereby certify that I am a duly licensed Professional Engineer and it is unlawful for any person to violate any provision of this Plan and Specification without the approval of the City Engineer.

68 ~~80~~
 40
 15
 3
 10
 9
 100
 9
 2
 8
 7

GPM
 GPM
 GPM
 GPM
 PSI
 PSI
 PSI
 PSI
 PSI
 FT
 PSI / 100 FT
 INCH
 FPS
 PSI / 100 FT

10/19/98

SAT

COUNTY OF SACRAMENTO
ENVIRONMENTAL MANAGEMENT DEPARTMENT
ENVIRONMENTAL HEALTH DIVISION

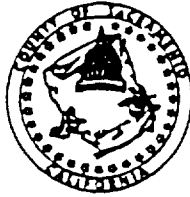

8475 JACKSON RD SUITE 240
SACRAMENTO, CA 95826
Office (916)386-7682
FAX (916)386-7011

City - 320

CROSS CONNECTION CONTROL SURVEY FORM

* 7619

Service Address: 4300 82ND ST.
 Water Customer: 82ND/ALPINE PARTNERSHIP
 Mailing Address: 5665 POWER INN Rd. #140
SACTO. CA. 95824
 Type of Business: STEAM CLEANER REPAIR
 Contact/Phone: _____
 Sacramento City/County Code: CITY # 34

AGENCY APPROVALS	
Water Purveyor:	<u>MD</u>
Env. Health:	ENTERED
City Bldg:	ENTERED
PERMIT NUMBER:	<u>22 1998</u>

Type of Facility Commercial Residential Industrial Other _____

	Service Connections	Existing Type of Protection	Required Protection
Domestic:	<u>1</u>	<input type="checkbox"/> RP <input type="checkbox"/> DC <input type="checkbox"/> AG <input checked="" type="checkbox"/> None	<input checked="" type="checkbox"/> RP <input type="checkbox"/> DC <input type="checkbox"/> AG <input type="checkbox"/> None <input type="checkbox"/> Other
Fire:		<input type="checkbox"/> RP <input type="checkbox"/> DC <input type="checkbox"/> None	<input type="checkbox"/> RP <input type="checkbox"/> DC <input type="checkbox"/> None <input type="checkbox"/> Other
Irrigation:		<input type="checkbox"/> RP <input type="checkbox"/> PVB <input type="checkbox"/> None	<input type="checkbox"/> RP <input type="checkbox"/> None <input type="checkbox"/> Other

Comments: METER # 2793
OWNER TO INSTALL REDUCED PRESSURE BACKFLOW ASSEMBLY AT REAR OF WATER METER

Water Purveyor: CITY OF SACTO. Representative: M. DEANON J. LAURENZI
 Date of Survey: 9.1.98 Telephone: (916) 433-8229

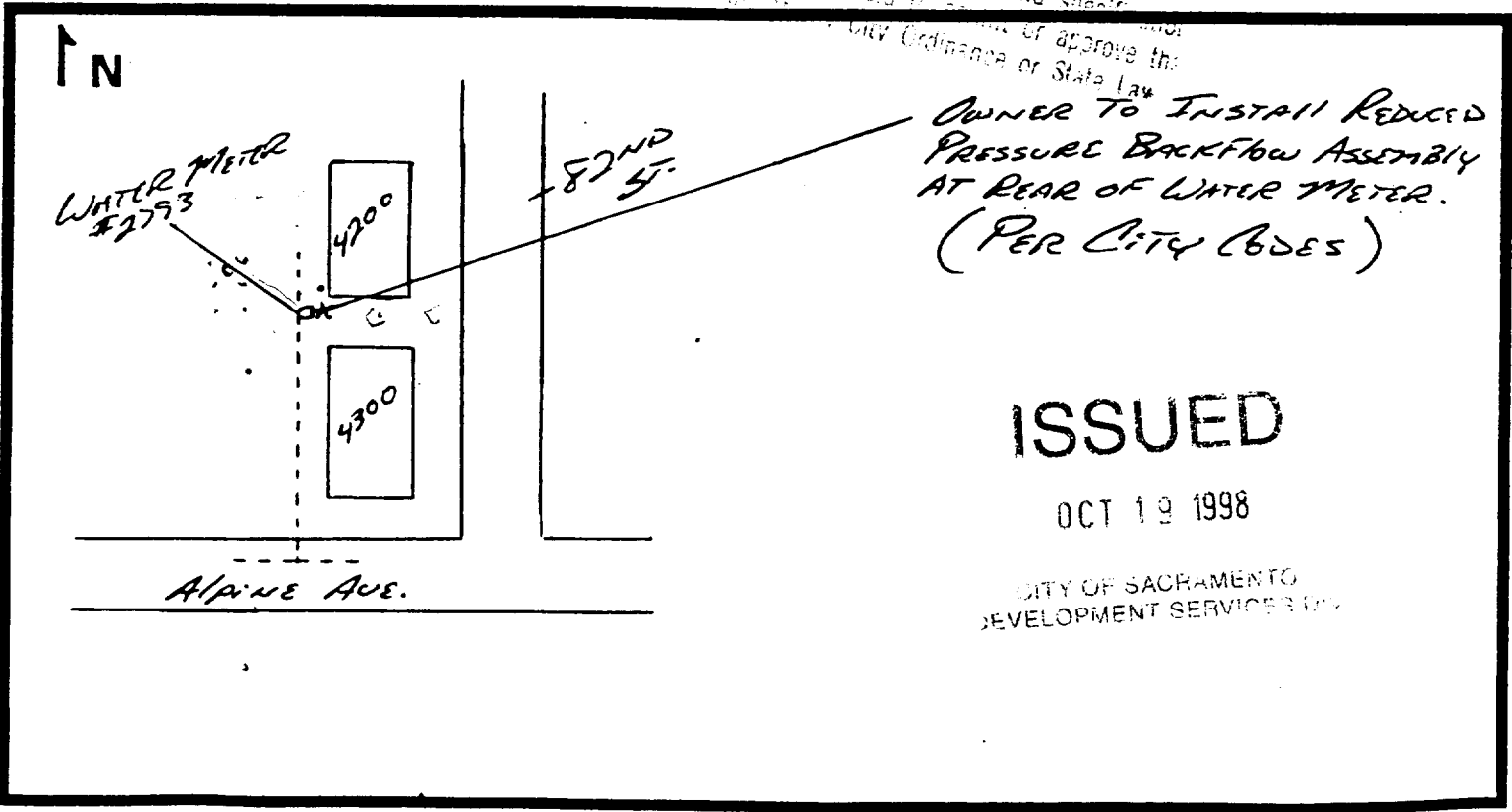

ISSUED

OCT 19 1998

CITY OF SACRAMENTO
DEVELOPMENT SERVICES DIV.