

CITY OF SACRAMENTO
1231 I Street, Sacramento, CA 95814

Permit No: 0006683
Insp Area: 4

Site Address: 18 COPPER CREST CT SAC
Parcel No: LOT 17 NATOMAS CROSSING UNIT 23
N

Sub-Type: NSFR
Housing (Y/N):

CONTRACTOR
RYLAND HOMES
1380 LEAD HILL BLVD. STE 108
ROSEVILLE CA 95661

OWNER

ARCHITECT

Nature of Work: MP 2383 2 STORY 10 ROOM SFR

CONSTRUCTION LENDING AGENCY: I hereby affirm under penalty of perjury that there is a construction lending agency for the performance of the work for which this permit is issued (Sec. 3097, Civ. C).

Lender's Name _____ Lender's Address _____

LICENSED CONTRACTORS DECLARATION: I hereby affirm under penalty of perjury that I am licensed under provisions of Chapter 9 (commencing with section 7000) of Division 3 of the Business and Professions Code and my license is in full force and effect.

License Class B License Number 54648 Date 6-16-00 Contractor Signature [Signature]

OWNER-BUILDER DECLARATION: I hereby affirm under penalty of perjury that I am exempt from the contractor's License Law for the following reason (Sec. 7031.5, Business and Professions Code; any city or county which requires a permit to construct, alter, improve, demolish, or repair any structure, prior to its issuance, also requires the applicant for such permit to file a signed statement that he or she is licensed pursuant to the provisions of the Contractors License Law (Chapter 9 (commencing with Section 7000) of Division 8 of the Business and Professions Code) or that he or she is exempt therefrom and the basis for the alleged exemption. Any violation of Section 7031.5 by any applicant for a permit subjects the applicant to a civil penalty of not more than five hundred dollars (\$500.00).

____ I, as a owner of the property, or my employees with wages as their sole compensation, will do the work, and the structure is not intended or offered for sale (Sec. 7044, Business and Professional Code: The Contractors License Law does not apply to an owner of property who builds or improves thereon, and who does such work himself or herself or through his/her own employees, provided that such improvements are not intended or offered for sale. If, however, the building or improvement is sold within one year of completion, the owner-builder will have the burden of proving that he/she did not build or improve for the purpose of sale.)

____ I, as owner of the property, am exclusively contracting with licensed contractors to construct the project (Sec. 7044, Business and Professions Code: The Contractors License Law does not apply to an owner of property who builds or improves thereon, and who contracts for such projects with a contractor(s) licensed pursuant to the Contractors License Law).

____ I am exempt under Sec. _____ B & PC for this reason: _____

Date _____ Owner Signature _____

IN ISSUING THIS BUILDING PERMIT, the applicant represents, and the city relies on the representation of the applicant, that the applicant verified all measurements and locations shown on the application or accompanying drawings and that the improvement to be constructed does not violate any law or private agreement relating to permissible or prohibited locations for such improvements. This building permit does not authorize any illegal location of any improvement or the violation of any private agreement relating to location of improvements.

I certify that I have read this application and state that all information is correct. I agree to comply with all city and county ordinances and state laws relating to building construction and hereby authorize representative(s) of this city to enter upon the abovementioned property for inspection purposes.

Date 6-16-00 Applicant/Agent Signature [Signature]

WORKER'S COMPENSATION DECLARATION: I hereby affirm under penalty of perjury one of the following declarations:

____ I have and will maintain a certificate of consent to self-insure for workers' compensation as provided for by Section 3700 of the Labor Code, for the performance of work for which the permit is issued.

____ I have and will maintain workers' compensation insurance, as required by Section 3700 of the Labor Code, for the performance of the work for which this permit is issued. My workers' compensation insurance carrier and policy number are:

Carrier _____ Policy Number _____ Exp Date _____

____ (This section need not be completed if the permit is for \$100 or less) I certify that in the performance of the work for which this permit is issued, I shall not employ any person in any manner so as to become subject to the workers' compensation laws of California and agree that if I should become subject to the workers' compensation provisions of Section 3700 of the Labor Code, I shall forthwith comply with those provisions.

Date 6-16-00 Applicant Signature [Signature]

WARNING: FAILURE TO SECURE WORKER'S COMPENSATION COVERAGE IS UNLAWFUL AND SHALL SUBJECT AN EMPLOYER TO CRIMINAL PENALTIES AND CIVIL FINES UP TO ONE HUNDRED THOUSAND DOLLARS (\$100,000) IN ADDITION TO THE COST OF COMPENSATION, DAMAGES AS PROVIDED FOR IN SECTION 3706 OF THE LABOR CODE, INTEREST AND ATTORNEY'S FEE.

THIS PERMIT SHALL EXPIRE BY LIMITATION IF WORK IS NOT COMMENCED WITHIN 180 DAYS.

RESIDENTIAL SUBDIVISION BUILDING PERMIT APPLICATION

Project Address: 18 COPPER CREST Ct. Assessor Parcel # _____
 Lot Number: 17 Subdivision Natomas Crossing Unit# 23

OWNER INFORMATION:

Legal Property Owner: <u>Ryland Homes</u>	Phone# <u>784-1330#14</u>
Owner Address: <u>1380 Lead Hill Rd.</u>	City <u>Roseville</u> State <u>CA</u> Zip <u>95661</u>

CONTRACTOR INFORMATION:

Contractor: <u>Ryland Homes</u>	Lic. # <u>54648</u>	Phone # <u>784-1330#14</u> Fax <u>784-9805</u>
---------------------------------	---------------------	--

PROJECT INFORMATION: Plan Four MP 2383

Land Use Zone <u>RIA</u>	Occupancy Group <u>R3</u>	Construction Type <u>VN</u>	Fed Code <u>1A</u>
No. of Stories: <u>2</u>	No. of Rooms: <u>10</u>	Street Width: <u>41'</u>	
1 st Floor Area <u>1238</u>	2 nd Floor Area <u>1145</u>	Basement _____	Roof Material <u>Tile</u>

AREA IN SQUARE FOOT OF:

Dwelling/Living	<u>2383</u>
Garage/Storage	<u>625</u>
Decks/Balconies	_____
Carports	_____

SCOPE OF WORK: SFD.

FOR OFFICE USE ONLY

<input type="checkbox"/> Information Above Complete <input type="checkbox"/> Violation Files Checked <input type="checkbox"/> Standard Setbacks <input type="checkbox"/> County Sewer	<input type="checkbox"/> AR Flood Waiver Required <input type="checkbox"/> Flood Elevation Certificate Required <input type="checkbox"/> Water Development Infill Area	<input type="checkbox"/> Planning Approval <input type="checkbox"/> Design Review Approval <input type="checkbox"/> Special Fee Districts Apply: _____
--	--	--

~THE FOLLOWING MUST BE PROVIDED IN ORDER TO SUBMIT FOR PERMIT~

<input type="checkbox"/> 2 COMPLETE PLOT PLANS, LEGIBLE & DRAWN TO SCALE
<input type="checkbox"/> 11 X 17 COPY OF FLOOR PLAN WITH FOLLOWING INFORMATION
a) Assessors Parcel Number c) Owners Name b) New Floor Area d) Project Address

Date: _____ Received by: (staff) _____ Permit # _____
 Jun 6 '00 15:59 P.12 Fax: 916 784 9805 916 849805

INSULATION
CERTIFICATE

WES PAC INSULATION, INC.

THIS IS TO CERTIFY THAT INSULATION HAS BEEN INSTALLED IN CONFORMANCE WITH CURRENT ENERGY REGULATIONS, CALIFORNIA ADMINISTRATIVE CODE, TITLE 24, STATE OF CALIFORNIA, IN THE BUILDING LOCATED AT:

LOT # 17 TRACT # _____
STREET 18 Copper Crest CITY _____

EXTERIOR WALLS:

MANUFACTURER _____ THICKNESS/TYPE _____ R-VALUE 13

CEILINGS:

BATTS:
MANUFACTURER _____ THICKNESS/TYPE _____ R-VALUE 38/19

BLOWN IN:

MANUFACTURER _____ THICKNESS/TYPE _____ R-VALUE 38

SQUARE FOOTAGE COVERED _____ NUMBER OF BAGS USED _____

FLOORS:

MANUFACTURER _____ THICKNESS/TYPE _____ R-VALUE _____

SLAB ON GRADE:

MANUFACTURER _____ THICKNESS/TYPE _____ R-VALUE _____

WIDTH OF INSULATION _____ INCHES

FOUNDATION WALLS:

MANUFACTURER _____ THICKNESS/TYPE _____ R-VALUE _____

GENERAL CONTRACTOR _____
CALIFORNIA CONTRACTORS LICENSE # _____ DATE _____

SIGNATURE TITLE

INSULATION CONTRACTOR WES PAC INSULATION, INC.
CALIFORNIA CONTRACTORS LICENSE # #487478 DATE 12/14/00

SIGNATURE TITLE

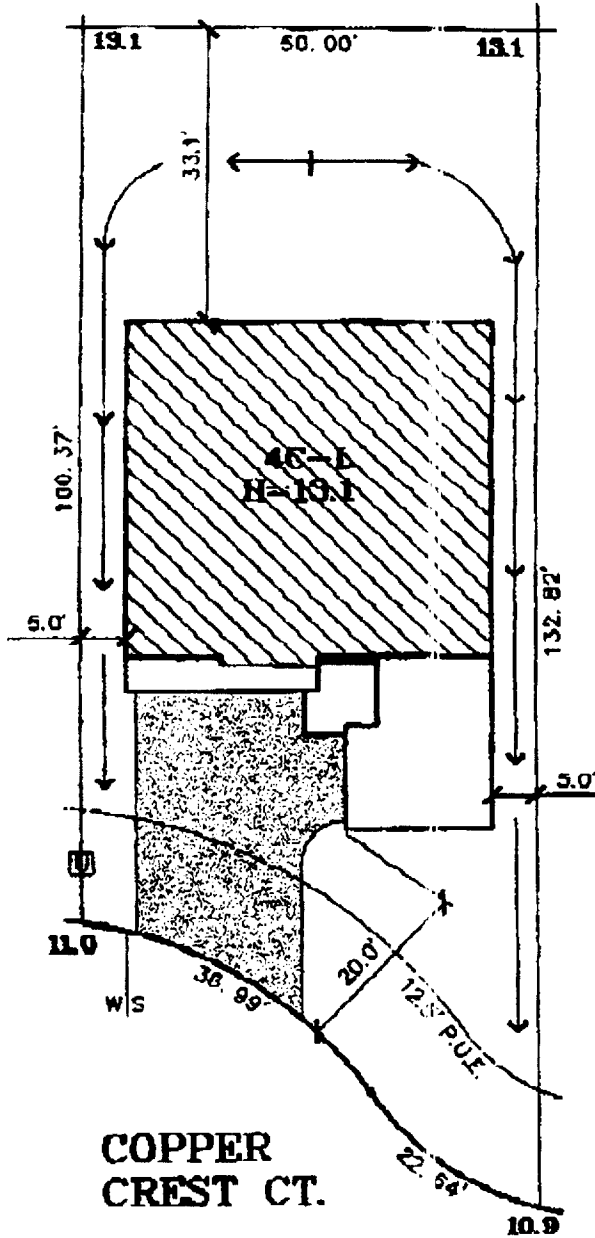

This set of plans and specifications shall remain the property of the City of Sacramento and shall be kept on file for public use. No part of this set of plans shall be reproduced or transmitted in any form or by any means, electronic, mechanical, photocopying, recording, or by any information storage and retrieval system, without the prior written permission of the City of Sacramento. The approval of this plan and specifications does not constitute a warranty of any kind. SIGNED AND NOTED TO BE IN ACCORDANCE WITH THE VIOLATION OF ANY CITY ORDINANCE OR STATE LAW.

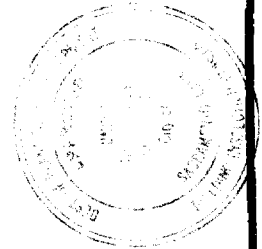

DATE: 4-5-00
 LOT AREA: 5,736 SF
 LOT COVERAGE: 00%

THIS PLAN IS PREPARED TO SHOW THE DIMENSIONAL RELATIONSHIP FROM BUILDING FOUNDATION TO PROPERTY LINE, DESIGN DRAINAGE CONTROL ELEVATIONS, AND DIRECTION OF DRAINAGE FLOW TO CONFORM WITH LOCAL ORDINANCES FOR THE PURPOSE OF BUILDING PERMIT ISSUANCE. INFORMATION SHOWN IS APPROXIMATE EXCEPT FOR THOSE SETBACKS WHICH ARE MINIMUMS REQUIRED BY ORDINANCE. THIS PLOT PLAN DOES NOT REFLECT AS BUILT CONDITIONS WHICH WILL LIKELY VARY FROM THIS PLAN.

<p>The Splink Corporation 2590 VENTURE OAKS WAY SACRAMENTO, CA 95833 PH: (916)925-5550 FAX: (916)921-9274</p>	<p>NATOMAS CROSSING VILLAGE 23 18 COPPER CREST CT. A.P.N.: LOT 17 PLAN 4C</p>	<p>RYLAND HERITAGE CITY OF SACRAMENTO, CA. CLIENT: RYLAND HOMES CONTACT: LINDA STEINFELDT PHONE: 916-784-1990 JOB NO.: 7884-009</p>
---	---	---