

CITY OF SACRAMENTO
1231 I Street, Sacramento, CA 95814

Permit No: 0101255
Insp Area: 4

Site Address: 5205 ALDERBERRY WY SAC
Parcel No: 201-0410-055 NORTHBR 2-1 LOT 58

Sub-Type: NSFR
Housing (Y/N): N

CONTRACTOR
MORRISON HOMES
1130 IRON POINT RD STE 120
FOLSOM CA. 95630

OWNER

ARCHITECT

Nature of Work: NSFR MP2265 9 RMS 2 STORY

CONSTRUCTION LENDING AGENCY: I hereby affirm under penalty of perjury that there is a construction lending agency for the performance of the work for which this permit is issued (Sec. 3097, Civ. C.)

Lender's Name _____ Lender's Address _____

LICENSED CONTRACTORS DECLARATION: I hereby affirm under penalty of perjury that I am licensed under provisions of Chapter 9 (commencing with section 7000) of Division 3 of the Business and Professions Code and my license is in full force and effect.

License Class B License Number 51046 Date 2-21-01 Contractor Signature [Signature]

OWNER-BUILDER DECLARATION: I hereby affirm under penalty of perjury that I am exempt from the contractors License Law for the following reason (Sec. 7031.5, Business and Professions Code: any city or county which requires a permit to construct, alter, improve, demolish, or repair any structure, prior to its issuance, also requires the applicant for such permit to file a signed statement that he or she is licensed pursuant to the provisions of the Contractors License Law (Chapter 9 (commencing with Section 7000) of Division 8 of the Business and Professions Code) or that he or she is exempt therefrom and the basis for the alleged exemption. Any violation of Section 7031.5 by any applicant for a permit subjects the applicant to a civil penalty of not more than five hundred dollars (\$500.00).

I, as a owner of the property, or my employees with wages as their sole compensation, will do the work, and the structure is not intended or offered for sale (Sec. 7044, Business and Professions Code: The Contractors License Law does not apply to an owner of property who builds or improves thereon, and who does such work himself or herself or through his/her own employees, provided that such improvements are not intended or offered for sale. If, however, the building or improvement is sold within one year of completion, the owner-builder will have the burden of proving that he/she did not build or improve for the purpose of sale.)

I, as owner of the property, am exclusively contracting with licensed contractors to construct the project (Sec. 7044, Business and Professions Code: The Contractors License Law does not apply to an owner of property who builds or improves thereon, and who contracts for such projects with a contractor(s) licensed pursuant to the Contractors License Law)

I am exempt under Sec. _____ B & PC for this reason: _____

Date _____ Owner Signature _____

IN ISSUING THIS BUILDING PERMIT, the applicant represents, and the city relies on the representation of the applicant, that the applicant verified all measurements and locations shown on the application or accompanying drawings and that the improvement to be constructed does not violate any law or private agreement relating to permissible or prohibited locations for such improvements. This building permit does not authorize any illegal location of any improvement or the violation of any private agreement relating to location of improvements.

I certify that I have read this application and state that all information is correct. I agree to comply with all city and county ordinances and state laws relating to building construction and hereby authorize representative(s) of this city to enter upon the above-mentioned property for inspection purposes.

Date 2-21-01 Applicant-Agent Signature [Signature]

WORKER'S COMPENSATION DECLARATION: I hereby affirm under penalty of perjury one of the following declarations:
I have and will maintain a certificate of consent to self-insure for workers' compensation as provided for by Section 3700 of the Labor Code, for the performance of work for which the permit is issued.

I have and will maintain workers' compensation insurance, as required by Section 3700 of the Labor Code, for the performance of the work for which this permit is issued. My workers' compensation insurance carrier and policy number are:

Carrier ZURICH-AMERICAN INS CO Policy Number WC2090701-03 Exp Date 11/01/2001

(This section need not be completed if the permit is for \$100 or less) I certify that in the performance of the work for which this permit is issued, I shall not employ any person in any manner so as to become subject to the workers' compensation laws of California and agree that if I should become subject to the workers' compensation provisions of Section 3700 of the Labor Code, I shall forthwith comply with those provisions.

Date 2-21-01 Applicant Signature [Signature]

WARNING: FAILURE TO SECURE WORKER'S COMPENSATION COVERAGE IS UNLAWFUL AND SHALL SUBJECT AN EMPLOYER TO CRIMINAL PENALTIES AND CIVIL FINES UP TO ONE HUNDRED THOUSAND DOLLARS (\$100,000) IN ADDITION TO THE COST OF COMPENSATION, DAMAGES AS PROVIDED FOR IN SECTION 3706 OF THE LABOR CODE, INTEREST AND ATTORNEY'S FEE.

THIS PERMIT SHALL EXPIRE BY LIMITATION IF WORK IS NOT COMMENCED WITHIN 180 DAYS.

RESIDENTIAL SUBDIVISION BUILDING PERMIT APPLICATION

Project Address: 2205 ALBERTA WAY Assessor Parcel # 201-041-055
Lot Number: 55 Subdivision Northborough Village 2

OWNER INFORMATION:

Legal Property Owner: Morrison Homes Phone# (916) 355-8900
Owner Address: 1130 Iron Point Rd #120 City Folsom State CA Zip 95630

CONTRACTOR INFORMATION:

Contractor: Morrison Homes Lic. # 519465 Phone # 355-8900 Fax 355-0100

PROJECT INFORMATION:

Land Use Zone R1A Occupancy Group R3 Construction Type VN Fed Code 1A
No. of Stories: 2 No. of Rooms: 9 Street Width: _____
1st Floor Area 1066 2nd Floor Area 1199 Basement _____ Roof Material _____
AREA IN SQUARE FOOT OF:
Dwelling/Living 3245
Garage/Storage 474
Decks/Balconies 108
Carports _____
SCOPE OF WORK: New Single Family Dwelling

RECEIVED

FOR OFFICE USE ONLY

- Information Above Complete
- Violation Files Checked
- Standard Setbacks
- County Sewer
- AR Flood Waiver Required
- Flood Elevation Certificate Required
- Water Development Infill Area
- Planning Approval
- Design Review Approval
- Special Fee Districts Apply:

THE FOLLOWING MUST BE PROVIDED IN ORDER TO SUBMIT FOR PERMIT

- 2 COMPLETE PLOT PLANS, LEGIBLE & DRAWN TO SCALE
- 11 X 17 COPY OF FLOOR PLAN WITH FOLLOWING INFORMATION
 - a) Assessors Parcel Number
 - b) New Floor Area
 - c) Owners Name
 - d) Project Address

Received by (staff)

Permit #



WesPac

insulation

a MASCO Company



809 North Market Blvd Ste 11 • Sacramento, CA 95834
(916) 927-7149 • Fax (916) 927-4257
Lic. #487478

Installed Insulation Certificate

We certify that the building insulation listed herein is installed in conformance with current energy conservation regulations, California Administrative Code, Title 24, State of California

R FACTOR

AREA

TYPE

INCHES/BAGS (BLOWN)

Certified by

Jamouy Tominey

Address or Lot Number

Title

Senior Sales

Date Installed

KwikKote

No. 200-002382

Stucco System Installation Card

Job Name: VILLA COLLECTION
Address: 5205 ALDERBERRY WAY
CA
Lot #: 00058-2

Stucco System Trade Name: KWIK KOTE
Stucco System Manufacturer: KWIK KOTE CORP.

ICBO Evaluation Service, Inc.
Report No. 3607
Date of Job Completion:

Home Builder: MORRISON HOMES
Address: 1130 IRON POINTE RD #120
FOLSOM, CA

Stucco Contractor: KENYON PLASTERING, INC.
Address: PO BOX 2077
North Highlands, CA

Telephone Number: 916/349-8191

Approved Contractor Number as
issued by the Stucco Manufacturer: 1001

Card Print Date: 06/27/2001

This is to certify that the stucco system on the building exterior at the above address had been installed in accordance with the evaluation report specified above and the manufacturer's instructions.

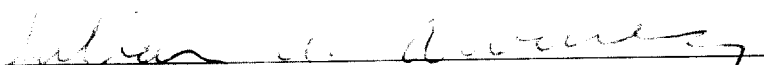

Signature of authorized representative of stucco contractor

6-27-01

Date

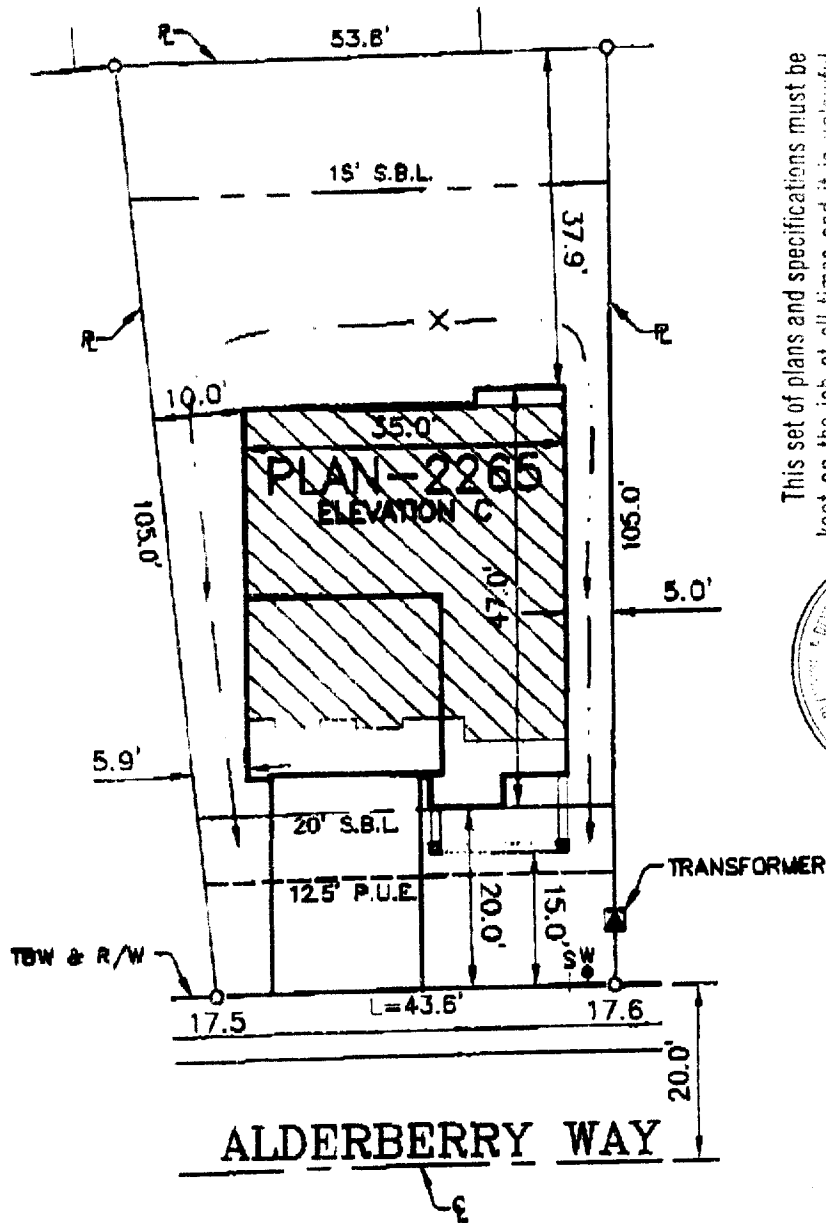

This set of plans and specifications must be kept on the job at all times and it is unlawful to make any changes or alterations from the same without written permission from the Building Inspection Division.
 The approval of this plan and specification SHALL NOT be held to permit or approve any violation of any City ordinance or state law.

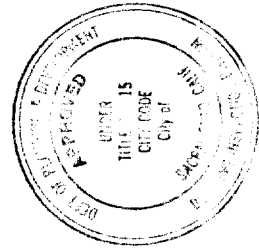

NOTE:
 It is understood that the drainage areas, slopes and grades shall not be altered, changed, blocked, modified or in any way be reconstructed by Owner contrary to what is depicted on this Plat Plan. THESE CONDITIONS RUN WITH THE LAND AND ARE BINDING ON ALL SUBSEQUENT OWNERS.

Julia Osterman 1/12/01
 Signature
 Date

Owner _____ Date _____

NOTE:
 All setback dimensions and elevations as shown may be adjusted to fit field conditions.

ELECTRICAL SERVICE ON
 L SIDE OF LOT.

A.P.N. = 201-041-055
 PAD ELEV = 19.2
 FOOTPRINT = 1,450 SF
 LOT AREA = 5,100 SF
 ALLOWED LOT COVERAGE = 40% = 2,040 SF
 ACTUAL LOT COVERAGE = 28% = 1,450 SF

LOT 58
5206 ALDERBERRY WAY

NORTHBOROUGH VILLAGE 2
COUNTY OF SACRAMENTO

APPROVAL:

MORRISON HOMES Res. _____ Date _____

REGISTERED CIVIL ENGINEER AND LAND SURVEYOR
 REG. NO. 4200 Exp. 01/01/03
REY. ENGINEERS, Inc.
 Civil Engineers / Land Surveyors



JOB NO.	40808
DRWN.	AL
CHECKED	BT
DATE	0-12-0
SCALE	1"=0'