

CITY OF SACRAMENTO
1231 I Street, Sacramento, CA 95814

Permit No: 0011639

Insp Area: 4

Site Address: 3616 TREFETHEN WY SAC

Parcel No: 225-1300-038

GATEWAY W 3 LOT 61

Sub-Type: NSFR

Housing (Y/N): N

CONTRACTOR

MOURIER JOHN CONSTRUCTION INC.
1830 VERNON ST
SUITE 9 95687

OWNER

ARCHITECT

Nature of Work: MP 2128 1 STORY 8 ROOM SFR

CONSTRUCTION LENDING AGENCY : I hereby affirm under penalty of perjury that there is a construction lending agency for the performance of the work for which this permit is issued (Sec. 3097, Civ. C).

Lender's Name _____ Lender's Address _____

LICENSED CONTRACTORS DECLARATION: I hereby affirm under penalty of perjury that I am licensed under provisions of Chapter 9 (commencing with section 7000) of Division 3 of the Business and Professions Code and my license is in full force and effect.

License Class B License Number 1213884 Date 10/3/00 Contractor Signature [Signature]

OWNER-BUILDER DECLARATION: I hereby affirm under penalty of perjury that I am exempt from the contractors License Law for the following reason (Sec. 7031.5, Business and Professions Code: any city or county which requires a permit to construct, alter, improve, demolish, or repair any structure, prior to its issuance, also requires the applicant for such permit to file a signed statement that he or she is licensed pursuant to the provisions of the Contractors License Law (Chapter 9 (commencing with Section 7000) of Division 8 of the Business and Professions Code) or that he or she is exempt therefrom and the basis for the alleged exemption. Any violation of Section 7031.5 by any applicant for a permit subjects the applicant to a civil penalty of not more than five hundred dollars (\$500.00);

I, as a owner of the property, or my employees with wages as their sole compensation, will do the work, and the structure is not intended or offered for sale (Sec. 7044, Business and Professional Code: The Contractors License Law does not apply to an owner of property who builds or improves thereon, and who does such work himself or herself or through his/her own employees, provided that such improvements are not intended or offered for sale. If, however, the building or improvement is sold within one year of completion, the owner-builder will have the burden of proving that he/she did not build or improve for the purpose of sale.)

I, as owner of the property, am exclusively contracting with licensed contractors to construct the project (Sec. 7044, Business and Professions Code: The Contractors License Law does not apply to an owner of property who builds or improves thereon, and who contracts for such projects with a contractor(s) licensed pursuant to the Contractors License Law).

I am exempt under Sec. _____ B & PC for this reason: _____

Date _____ Owner Signature _____

IN ISSUING THIS BUILDING PERMIT, the applicant represents, and the city relies on the representation of the applicant, that the applicant verified all measurements and locations shown on the application or accompanying drawings and that the improvement to be constructed does not violate any law or private agreement relating to permissible or prohibited locations for such improvements. This building permit does not authorize any illegal location of any improvement or the violation of any private agreement relating to location of improvements.

I certify that I have read this application and state that all information is correct. I agree to comply with all city and county ordinances and state laws relating to building construction and hereby authorize representative(s) of this city to enter upon the abovementioned property for inspection purposes.

Date [Signature] Applicant/Agent Signature [Signature]

WORKER'S COMPENSATION DECLARATION: I hereby affirm under penalty of perjury one of the following declarations:

I have and will maintain a certificate of consent to self-insure for workers' compensation as provided for by Section 3700 of the Labor Code, for the performance of work for which the permit is issued.

I have and will maintain workers' compensation insurance, as required by Section 3700 of the Labor Code, for the performance of the work for which this permit is issued. My workers' compensation insurance carrier and policy number are:

Carrier FINANCIAL PACIFIC INS. CO. Policy Number 920137C Exp Date 10/1/2000

(This section need not be completed by the permittee for \$100,000 or less) I certify that in the performance of the work for which this permit is issued, I shall not employ any person in any manner so as to become subject to the workers' compensation laws of California and agree that if I should become subject to the workers' compensation provisions of Section 3700 of the Labor Code, I shall forthwith comply with those provisions.

Date [Signature] Applicant Signature [Signature]

WARNING: FAILURE TO SECURE WORKER'S COMPENSATION COVERAGE IS UNLAWFUL AND SHALL SUBJECT AN EMPLOYER TO CRIMINAL PENALTIES AND CIVIL FINES UP TO ONE HUNDRED THOUSAND DOLLARS (\$100,000) IN ADDITION TO THE COST OF COMPENSATION, DAMAGES AS PROVIDED FOR IN SECTION 3706 OF THE LABOR CODE, INTEREST AND ATTORNEY'S FEE.

THIS PERMIT SHALL EXPIRE BY LIMITATION IF WORK IS NOT COMMENCED WITHIN 180 DAYS.

RESIDENTIAL BUILDING PERMIT APPLICATION

New Construction

Additions

Remodels

Other

Project Address: 3616 Trefethen Way

Assessor Parcel # 225-1300-038

lot #61

OWNER INFORMATION:

Legal Property Owner: John MAUBIER Construction Phone # (916) 969-2842
Owner Address: 1830 VERNON STREET, #9 City Roseville State Ca. Zip 95678

CONTRACTOR INFORMATION:

Contractor: J.M.C. Lic. # 613009 Phone # 969-2842 Fax # 782-8903
Gateway West Village

PROJECT INFORMATION:

Land Use Zone R14 Occupancy Group R3 Construction Type VN Fed Code 14

No. of stories: 1 No. of rooms: 8 Street width: _____

1st Floor Area _____ 2nd Floor Area _____ Basement _____ Roof Material _____

AREA IN SQUARE FOOT OF:	EXISTING	NEW
Dwelling/Living	_____	<u>2128</u>
Garage/Storage	_____	<u>375</u>
Decks/Balconies	_____	<u>44</u>
Carports	_____	_____

SCOPE OF WORK:

FOR OFFICE USE ONLY

- Information above complete
- Violation files checked
- Standard setbacks
- County Sewer
- AR Flood Waiver required
- Flood Elevation Certificate Required
- Water Development Infill Area
- Planning Approval
- Design Review Approval
- Special Fee Districts Apply

NEW STRUCTURES & ADDITIONS

◆ THE FOLLOWING MUST BE PROVIDED IN ORDER TO SUBMIT FOR PLAN REVIEW

- 2 COMPLETE PLANS, LEGIBLE & DRAWN TO SCALE
 - 3 SETS IF PROJECT IS IN A DESIGN REVIEW AREA
 - Title 24 Energy Compliance documentation
 - Grading and Erosion Control Questionnaire
 - 11" x 17" copy of floor plan for County Assessor
 - Plan Review Fees
- ◆ Plans to include: site plan, floor plan, elevations, roof/ceiling plan, foundation and structural framing details, and structural calculations for non-conforming structures.

Date: _____

Received by: (staff) _____

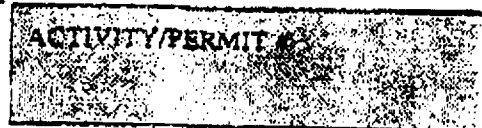

Natomas Unified School District
 1515 Sports Drive, #1 • Sacramento, CA 95834-1905
 Phone 916/641-3300 • Fax 916/928-1629

CERTIFICATION OF COMPLIANCE

SCHOOL DISTRICT DEVELOPMENT FEES

PART I: TO BE COMPLETED BY APPLICANT

Property Owner's Name	(916) 969-2242
Owner's Address	95078
Project Address	
Parcel Number	51
Subdivision Name	
Number of Units	
Print Applicant's Name	Applicant's Signature
Title of Applicant	
Date	Telephone Number 916-9700

PART II: TO BE COMPLETED BY BUILDING DEPARTMENT

Plan Identification Number	
Building Type (Check One)	
<input type="checkbox"/> Residential	<input type="checkbox"/> Apartment/Condominium
<input type="checkbox"/> Commercial/Industrial	
Square Feet of Chargeable Building Area	
Signature	
Title	Date

PART III: TO BE COMPLETED BY NATOMAS UNIFIED SCHOOL DISTRICT

District Certification Number	
Fees Collected:	
Residential: 2128	Sq. Ft. X \$ 3.25 = \$ 6916.00
Apartment/Condominium:	Sq. Ft. X \$ = \$
Commercial/Industrial:	Sq. Ft. X \$ = \$

NOTICE TO APPLICANT: Pursuant to government code section 66020 (d), this will serve to notify you that the 90-day approval period in which you may protest the fees, or other payment identified above, will begin to run on the date in which the building or installation permit for this project is issued, or on which they are paid to the District, or to another public entity authorized to collect them on behalf of the District, whichever is earlier.

Applicant Signature: _____ **Date:** 9/29/00

This certification covers only the amount of square footage indicated above. Any additions or corrections to the square footage for this project will require an amendment to the Certificate of Compliance.

As the authorize Natomas Unified School District official, I hereby certify that the requirements of Government Code Section 95995 have been complied with by the above signed applicant.

SIGNATURE: _____ **DATE:** 10/2/00

TITLE: _____

61

OMEGA PRODUCTS INTERNATIONAL, INC.

DIAMOND WALL INSULATING STUCCO SYSTEM

JOB ADDRESS:

J. N. C. [unclear] [unclear] [unclear]

ICBO Report #4004

PLASTERING CONTRACTOR:

Name: Stucco Works, Inc.

Address: 5900 Warehouse way

Telephone No: (916) 383-6699

Contractor Number of Diamond Wall System 2175-

Date of Job Completion

3/30/01

This is to certify that the exterior coating system on the building exterior at the above address has been installed in accordance with the evaluation report specified above and the manufacturer's instructions.

Date 4/2/01

Signature of authorized representative of
Plastering Contractor

This installation card must be presented to the building inspector after completion of work and before final inspection.



WesPac

insulation
a MASCO Company



809 North Market Blvd., Ste. 11 • Sacramento, CA 95834
(916) 927-7149 • Fax (916) 927-4257
Lic. #487478

Installed Insulation Certificate

We certify that the building insulation listed herein is installed in conformance with current energy conservation regulations, California Administrative Code, Title 24, State of California

R FACTOR	AREA	TYPE	INCHES/BAGS (BLOWN)
R30	CEILING	FIBERGLASS BLOWN	12"
R30	CEILING	FIBERGLASS BATTS	10.25"
R13	EXTERIOR WALLS	FIBERGLASS BATTS	3.5"

Certified by *Carol Stricker*
Title Secretary

GATEWAY #151
JMC GATEWAY #E51/G1
Address or Lot Number 04/03/01
Date Installed _____
Phase # _____

GATEWAY WEST VILLAGE 3



TREFETHEN WAY

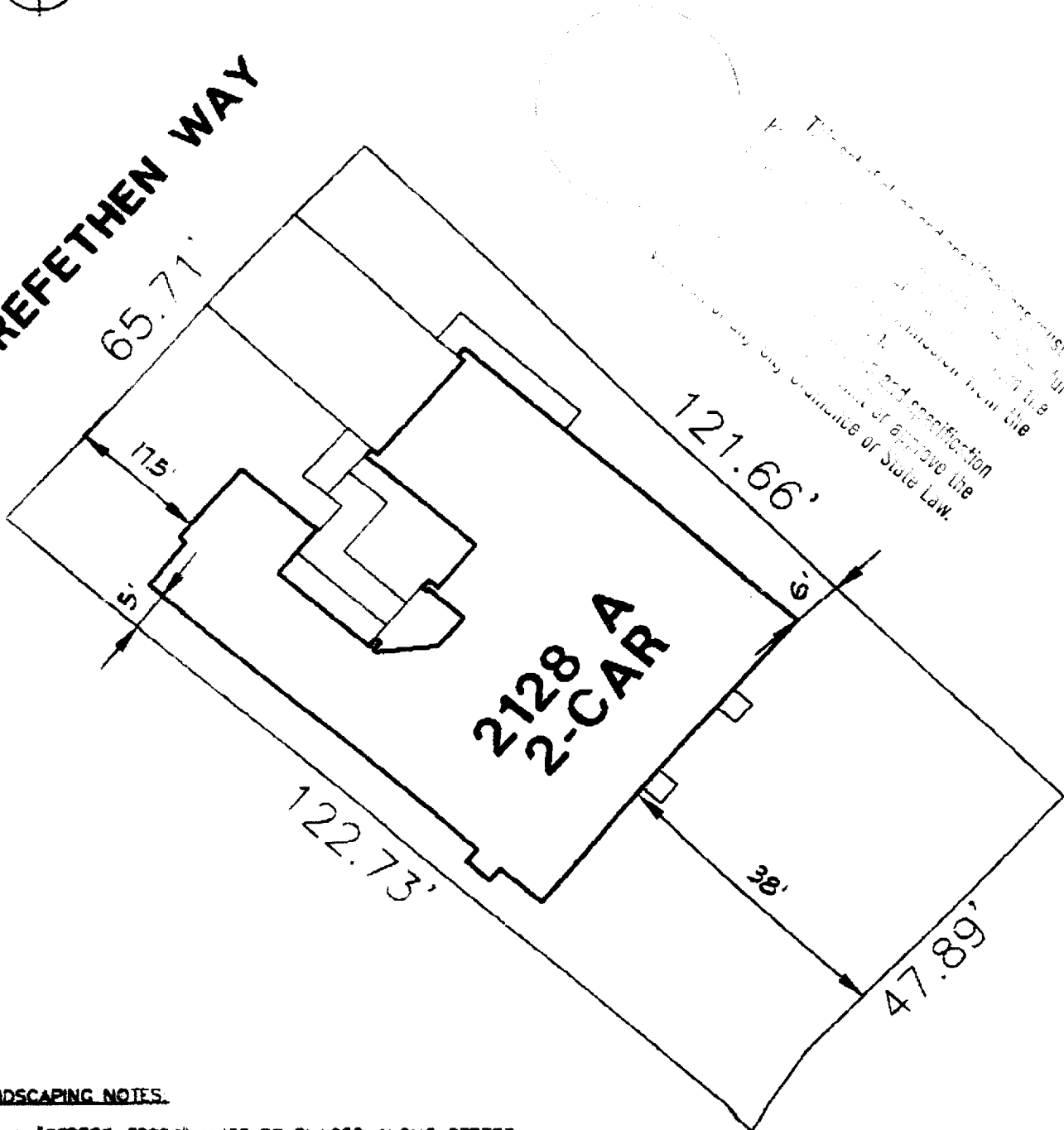

2128 A
2-CAR

The intended use and construction must be in accordance with the applicable zoning ordinance and specifications of the City of Roseville. The applicant must obtain the necessary permits from the City of Roseville and comply with all applicable laws, codes, and specifications of the City of Roseville or approve the same by ordinance of State Law.

LANDSCAPING NOTES.

- 1 ALL "STREET-TREES" MUST BE PLACED ALONG STREET FRONTAGE AT AN AVERAGE OF 10'-0" TO 30'-0" O.C.
- 2 ALL "STREET-TREES" SPECIES MUST BE PER GATEWAY WEST "STREET-TREE" MATRIX TABLE FOR STREET(S) BORDERING LOT - NO EXCEPTIONS

LOT: 61 SITE ADDRESS: 3616 TREFETHEN WAY

WHEN USED FOR SALES OR CONTRACT PURPOSES THIS DOCUMENT DOES NOT GUARANTEE ANY DIMENSIONS, DISTANCES, BEARINGS OR SETBACKS. JMC RESERVES THE RIGHT TO MAKE CHANGES AT ANY TIME WITHOUT PRIOR NOTICE AND IS NOT RESPONSIBLE FOR IRREGULARITIES OR DIFFERENCES

SCALE: 1"=20'	APN:
LOT SIZE: 7,437 sq.-	
GW-P61 JM 091200	1250 VERNON ST. No.2 ROSEVILLE, CA 95678 916-782-8979 CA. LIC. 60604

