

CITY OF SACRAMENTO

1231 I Street, Sacramento, CA 95814

Permit No: 0008810

Insp Area: 4

Site Address: 5136 GORHAM WY SAC

Parcel No: 201-0350-005
N

NORTHBOROUGH VIL 5-1 LOT 5

Sub-Type: NSFR

Housing (Y/N):

CONTRACTOR

CENTEX HOMES
3300 DOUGLAS BLVD
STE. 210 95661

OWNER

ARCHITECT

Nature of Work: NSFR MP2512B/OPT 10 RMS 2 STORY

CONSTRUCTION LENDING AGENCY : I hereby affirm under penalty of perjury that there is a construction lending agency for the performance of the work for which this permit is issued (Sec. 3097, Civ. C).

Lender's Name N/A Lender's Address _____

LICENSED CONTRACTORS DECLARATION: I hereby affirm under penalty of perjury that I am licensed under provisions of Chapter 9 (commencing with section 7000) of Division 3 of the Business and Professions Code and my license is in full force and effect.

License Class B License Number 734094 Date 8-3-00 Contractor Signature Debbie Stowers

OWNER-BUILDER DECLARATION: I hereby affirm under penalty of perjury that I am exempt from the contractors License Law for the following reason (Sec. 7031.5, Business and Professions Code; any city or county which requires a permit to construct, alter, improve, demolish, or repair any structure, prior to its issuance, also requires the applicant for such permit to file a signed statement that he or she is licensed pursuant to the provisions of the Contractors License Law (Chapter 9 (commencing with Section 7000) of Division 8 of the Business and Professions Code) or that he or she is exempt therefrom and the basis for the alleged exemption. Any violation of Section 7031.5 by any applicant for a permit subjects the applicant to a civil penalty of not more than five hundred dollars (\$500.00);

_____, I, as a owner of the property, or my employees with wages as their sole compensation, will do the work, and the structure is not intended or offered for sale (Sec. 7044, Business and Professional Code: The Contractors License Law does not apply to an owner of property who builds or improves thereon, and who does such work himself or herself or through his/her own employees, provided that such improvements are not intended or offered for sale. If, however, the building or improvement is sold within one year of completion, the owner-builder will have the burden of proving that he/she did not build or improve for the purpose of sale.)

_____, I, as owner of the property, am exclusively contracting with licensed contractors to construct the project (Sec. 7044, Business and Professions Code: The Contractors License Law does not apply to an owner of property who builds or improves thereon, and who contracts for such projects with a contractor(s) licensed pursuant to the Contractors License Law).

_____ I am exempt under Sec. _____ B & PC for this reason: _____

Date _____ Owner Signature _____

IN ISSUING THIS BUILDING PERMIT, the applicant represents, and the city relies on the representation of the applicant, that the applicant verified all measurements and locations shown on the application or accompanying drawings and that the improvement to be constructed does not violate any law or private agreement relating to permissible or prohibited locations for such improvements. This building permit does not authorize any illegal location of any improvement or the violation of any private agreement relating to location of improvements.

I certify that I have read this application and state that all information is correct. I agree to comply with all city and county ordinances and state laws relating to building construction and hereby authorize representative(s) of this city to enter upon the abovementioned property for inspection purposes.

Date 8-3-00 Applicant/Agent Signature Debbie Stowers

WORKER'S COMPENSATION DECLARATION: I hereby affirm under penalty of perjury one of the following declarations:

_____, I have and will maintain a certificate of consent to self-insure for workers' compensation as provided for by Section 3700 of the Labor Code, for the performance of work for which the permit is issued.

I have and will maintain workers' compensation insurance, as required by Section 3700 of the Labor Code, for the performance of the work for which this permit is issued. My workers' compensation insurance carrier and policy number are:

Carrier: AMER GUAR. & LIAB. INS Policy Number WC8322096-02 Exp Date 10/01/2000

_____, (This section need not be completed if the permit is for \$100 or less) I certify that in the performance of the work for which this permit is issued, I shall not employ any person in any manner so as to become subject to the workers' compensation laws of California and agree that if I should become subject to the workers' compensation provisions of Section 3700 of the Labor Code, I shall forthwith comply with those provisions.

Date 8-3-00 Applicant Signature Debbie Stowers

WARNING - FAILURE TO SECURE WORKER'S COMPENSATION COVERAGE IS UNLAWFUL AND SHALL SUBJECT AN EMPLOYER TO CRIMINAL PENALTIES AND CIVIL FINES UP TO ONE HUNDRED THOUSAND DOLLARS (\$100,000) IN ADDITION TO THE COST OF COMPENSATION, DAMAGES AS PROVIDED FOR IN SECTION 3706 OF THE LABOR CODE, INTEREST AND ATTORNEY'S FEE.

THIS PERMIT SHALL EXPIRE BY LIMITATION IF WORK IS NOT COMMENCED WITHIN 180 DAYS.

RESIDENTIAL BUILDING PERMIT APPLICATION

New Construction Addition Remodels Other

Project Address: 5136 Larkham Way

Assessor Parcel # 201-0350-005

OWNER INFORMATION:

LT 5

Legal Property Owner: <u>Center Homes</u>	Phone # <u>786-8693</u>
Owner Address: <u>3700 Douglas Blvd # 150</u>	City <u>Roseville</u> State <u>CA</u> Zip <u>95661</u>

CONTRACTOR INFORMATION:

Contractor: <u>Center Homes</u>	Lic. # <u>734094</u>	Phone # <u>786-8693</u>	Fax# <u>786-6802</u>
---------------------------------	----------------------	-------------------------	----------------------

PROJECT INFORMATION:

Land Use Zone <u>RIA</u>	Occupancy Group <u>R3</u>	Construction Type <u>VN</u>	Fed Code <u>IA</u>
No. of stories: <u>2</u>	No. of rooms: _____	Street width: _____	
1 st Floor Area <u>1309</u>	2 nd Floor Area <u>1363</u>	Basement _____	Roof Material _____

AREA IN SQUARE FOOT OF:	EXISTING	NEW	
	Dwelling/Living	_____	<u>2672</u>
	Garage/Storage	_____	<u>614</u>
	Decks/Balconies	_____	_____
	Carports	_____	_____

SCOPE OF WORK: MP 2512 New Home Construction

FOR OFFICE USE ONLY

<input type="checkbox"/> Information above complete	<input type="checkbox"/> AR Flood Waiver required	<input type="checkbox"/> Planning Approval
<input type="checkbox"/> Violation files checked	<input type="checkbox"/> Flood Elevation Certificate Required	<input type="checkbox"/> Design Review Approval
<input type="checkbox"/> Standard setbacks	<input type="checkbox"/> Water Development Infill Area	<input type="checkbox"/> Special Fee Districts Apply : _____
<input type="checkbox"/> County Sewer	_____	

NEW STRUCTURES & ADDITIONS

❖ THE FOLLOWING MUST BE PROVIDED IN ORDER TO SUBMIT FOR PLAN REVIEW

- | | |
|---|---|
| <input type="checkbox"/> 2 COMPLETE PLANS, LEGIBLE & DRAWN TO SCALE | ❖ Plans to include: site plan, floor plan, elevations, roof/ceiling plan, foundation and structural framing details, and structural calculations for non-conforming structures. |
| <input type="checkbox"/> 3 SETS IF PROJECT IS IN A DESIGN REVIEW AREA | |
| <input type="checkbox"/> Title 24 Energy Compliance documentation | <input type="checkbox"/> 11" x 17" copy of floor plan for County Assessor |
| <input type="checkbox"/> Grading and Erosion Control Questionnaire | <input type="checkbox"/> Plan Review Fees |

Date: _____

Received by: (staff) _____

ACTIVITY/PERMIT #

Natomas Unified School District
 1515 Sports Drive, #1 • Sacramento, CA 95834-1905
 Phone 916/641-3300 • Fax 916/928-1629

CERTIFICATE OF COMPLIANCE
SCHOOL DISTRICT DEVELOPMENT FEES

PART I: TO BE COMPLETED BY APPLICANT			
Property Owner's Name	Center Homes		
Owner's Address	3700 Douglas Blvd #150, Roseville 95661		
Project Address	5136 Gordon Way		
Parcel Number	201-0350-005	Lot 5	
Subdivision Name	Northborough 5		
Number of Units	1		
Print Applicant's Name	Debbie Stowers	Applicant's Signature	Debbie Stowers
Title of Applicant	Permit Coordinator		Telephone Number
Date	7-24-00	786-8693	
PART II: TO BE COMPLETED BY BUILDING DEPARTMENT			
Plan Identification Number	MP 2512		
Building Type (Check One)	<input checked="" type="checkbox"/> Residential <input type="checkbox"/> Apartment/Condominium <input type="checkbox"/> Commercial/Industrial		
Square Feet of Chargeable Building Area	2672 sq ft		
Signature			
Title	BI	Date	7-25-00
PART III: TO BE COMPLETED BY NATOMAS UNIFIED SCHOOL DISTRICT			
District Certification Number	01-219		
Fees Collected:			
Residential:	2672 Sq. Ft. X \$ 3.25	= \$	8684
Apartment/Condominium:	Sq. Ft. X \$	= \$	
Commercial/Industrial:	Sq. Ft. X \$	= \$	
NOTICE TO APPLICANT: Pursuant to government code section 66020 (d), this will serve to notify you that the 90-day approval period in which you may protest the fees, or other payment identified above, will begin to run on the date in which the building or installation permit for this project is issued, or on which they are paid to the District, or to another public entity authorized to collect them on behalf of the District, whichever is earlier.			
Applicant Signature:			Date: 8-3-00

This certification covers only the amount of square footage indicated above. Any additions or corrections to the square footage for this project will require an amendment to the Certificate of Compliance.

As the authorize Natomas Unified School District official, I hereby certify that the requirements of Government Code Section 95995 have been complied with by the above signed applicant.

SIGNATURE: DATE: 8/3/00
 TITLE: Robert Taylor II

COUNTY SANITATION DISTRICT NO. 1
 SACRAMENTO REGIONAL COUNTY SANITATION DISTRICT
SEWER IMPACT FEE ^{9mf}
 PERMIT AND CALCULATION SHEET ^{7/28/00}

APPLICATION NO GENERAL INFORMATION		BLDG PERMIT NO: <u>City</u>	
		THIS PERMIT GOOD ONLY WHEN VALIDATED BY THE CASHIER	
FEE CALCULATION		BUILDING USE	
INSPECTION		RESIDENTIAL SF <input type="checkbox"/>	MF <input type="checkbox"/>
CSD-1	473.-	COMMERCIAL USE	UNITS
SRCSD	2404.-		
CONSTRUCTION			
IN-LIEU			
TOTAL FEE	2877.00		
APN: <u>201 - 0350 - 005</u>			
DESCRIPTION/ SUBDIVISION		LOT: <u>5</u>	
<u>Northborough 5</u>			
PROPERTY ADDRESS <u>5136 Gorham Way</u>			
OWNER <u>Center Homes</u>			
MAILING ADDRESS <u>3700 Douglas Blvd # 150</u>			
CITY-STATE-ZIP <u>Roseville CA 95661</u> PHONE <u>786-3673</u>			
ADDITIONAL FEES MAY BE DUE IF CHANGES IN USE INCREASE SEWER IMPACT.			
APPLICANT SIGNATURE <u>Debbie Stowers</u>			
CONSOLIDATED UTILITY BILLING USE ONLY			
ACCT _____	INPUT _____	START _____	

INSPECTOR'S COPY

Lot Area = 6,595 sf
 Building Footprint = 2,097 sf
 Gross Coverage = 31.8%
 Porch Allowance = 174 sf
 Net Coverage = 29.2%

Scale: 1"=20'

NORTHBOROUGH DRIVE

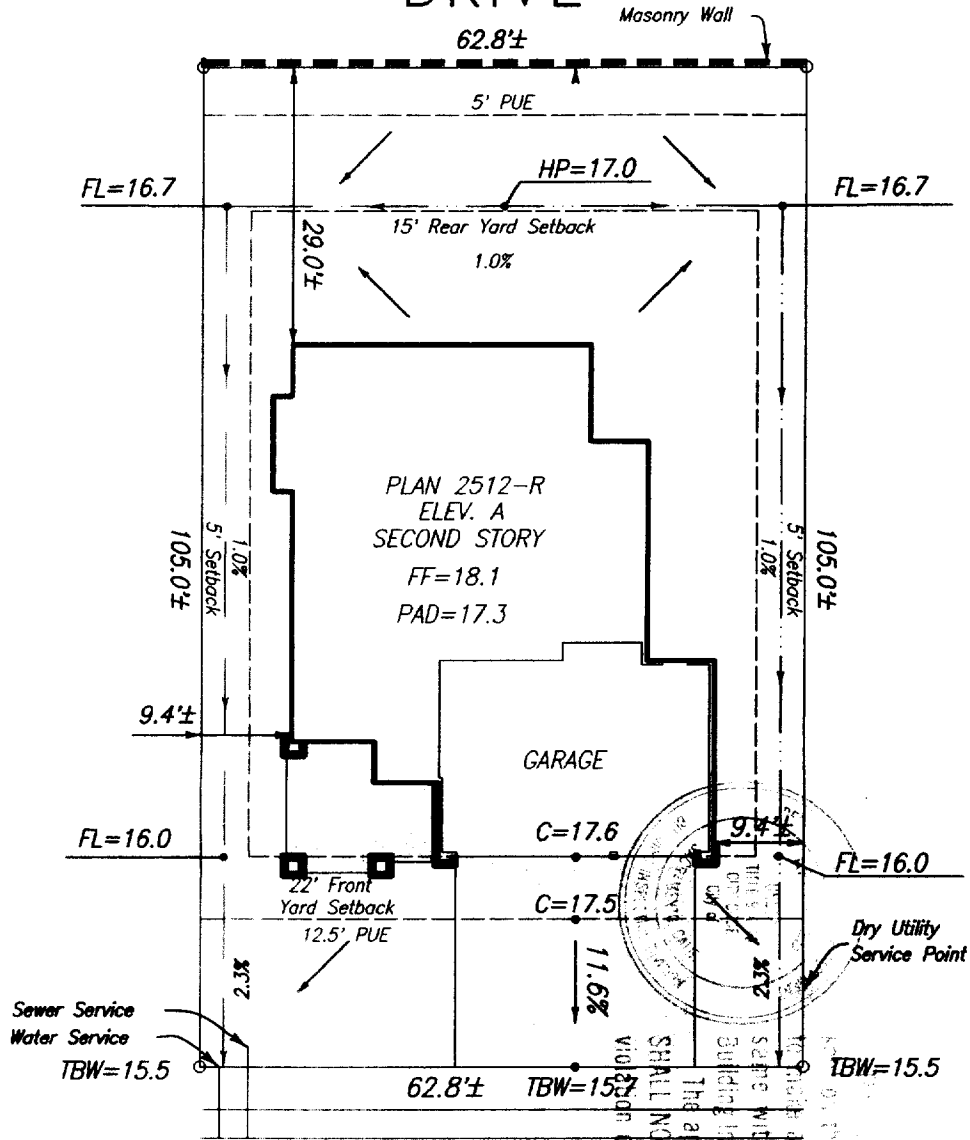

5136 GORHAM WAY
 GORHAM COURT
 CANTARA WAY

Plot Plan for Lot 5
 Northborough Village 5-1
 City of Sacramento

Centex Homes

3300 Douglas Blvd., Suite 210
 Roseville, CA 95661
 Ph.: (916) 786-8693

Plan 2512 Elev. A
 Centex Review & Approval:
 By: SA Date: 7/21

Note:
 This plot plan has been prepared for the purpose of showing the building foundation relationship to the property line, proposed drainage elevations and direction of flow to conform to local ordinances and for the purpose of building permit issuance. Information shown is approximate except for those setbacks which are minimums required by ordinance. This plot does not reflect as-built conditions which will likely vary from this plan.

Murray Smith & Associates
 Engineering, Inc.
 3110 Gold Canal Drive
 Rancho Cordova, CA 95670
 Ph.: (916) 635-1511

July 20, 2000

PN: 99008