

CITY OF SACRAMENTO
1231 I Street, Sacramento, CA 95814

Permit No: 0516544
Insp Area: 4
Thos Bros:
Sub-Type: NSFR
Housing (Y/N): N

Site Address: 295 DELTA LEAF WY SAC
Parcel No: PARUNKN000 SYCAMORE PARK LOT #7

CONTRACTOR
MAHAL CO.
PO BOX 1082
SAC. CA. 95812

OWNER
SURJIT MAHAL
P.O. BOX 1082
SACRAMENTO, CA 95812

ARCHITECT

Nature of Work: MP 2787 2 STORY 12 RM SFR

CONSTRUCTION LENDING AGENCY : I hereby affirm under penalty of perjury that there is a construction lending agency for the performance of the work for which this permit is issued (Sec. 3097, Civ. C).

Lender's Name _____ Lender's Address _____

LICENSED CONTRACTORS DECLARATION: I hereby affirm under penalty of perjury that I am licensed under provisions of Chapter 9 (commencing with section 7000) of Division 3 of the Business and Professions Code and my license is in full force and effect.

License Class B License Number 763251 Date 10-31-05 Contractor Signature [Signature]

OWNER-BUILDER DECLARATION: I hereby affirm under penalty of perjury that I am exempt from the contractors License Law for the following reason (Sec. 7031.5, Business and Professions Code; any city or county which requires a permit to construct, alter, improve, demolish, or repair any structure, prior to its issuance, also requires the applicant for such permit to file a signed statement that he or she is licensed pursuant to the provisions of the Contractors License Law (Chapter 9 (commencing with Section 7000) of Division 8 of the Business and Professions Code) or that he or she is exempt therefrom and the basis for the alleged exemption. Any violation of Section 7031.5 by any applicant for a permit subjects the applicant to a civil penalty of not more than five hundred dollars (\$500.00);

I, as a owner of the property, or my employees with wages as their sole compensation, will do the work, and the structure is not intended or offered for sale (Sec. 7044, Business and Professional Code: The Contractors License Law does not apply to an owner of property who builds or improves thereon, and who does such work himself or herself or through his/her own employees, provided that such improvements are not intended or offered for sale. If, however, the building or improvement is sold within one year of completion, the owner-builder will have the burden of proving that he/she did not build or improve for the purpose of sale.)

I, as owner of the property, am exclusively contracting with licensed contractors to construct the project (Sec. 7044, Business and Professions Code: The Contractors License Law does not apply to an owner of property who builds or improves thereon, and who contracts for such projects with a contractor(s) licensed pursuant to the Contractors License Law).

PAID
OCT 31 2005
NEIGHBORHOODS PLANNING
AND DEVELOPMENT SERVICES

I am exempt under Sec. _____ B & PC for this reason: _____

Date _____ Owner Signature _____

IN ISSUING THIS BUILDING PERMIT, the applicant represents, and the city relies on the representation of the applicant, that the applicant verified all measurements and locations shown on the application or accompanying drawings and that the improvement to be constructed does not violate any law or private agreement relating to permissible or prohibited locations for such improvements. This building permit does not authorize any illegal location of any improvement or the violation of any private agreement relating to location of improvements.

I certify that I have read this application and state that all information is correct. I agree to comply with all city and county ordinances and state laws relating to building construction and hereby authorize representative(s) of this city to enter upon the abovementioned property for inspection purposes.

Date 10-31-05 Applicant/Agent Signature [Signature]

WORKER'S COMPENSATION DECLARATION: I hereby affirm under penalty of perjury one of the following declarations:

I have and will maintain a certificate of consent to self-insure for workers' compensation as provided for by Section 3700 of the Labor Code, for the performance of work for which the permit is issued.

I have and will maintain workers' compensation insurance, as required by Section 3700 of the Labor Code, for the performance of the work for which this permit is issued. My workers' compensation insurance carrier and policy number are:

Carrier EXEMPT Policy Number NO EMPLOYEES Exp Date

(This section need not be completed if the permit is for \$100 or less) I certify that in the performance of the work for which this permit is issued, I shall not employ any person in any manner so as to become subject to the workers' compensation laws of California and agree that if I should become subject to the workers' compensation provisions of Section 3700 of the Labor Code, I shall forthwith comply with those provisions.

Date 10-31-05 Applicant Signature [Signature]

WARNING: FAILURE TO SECURE WORKER'S COMPENSATION COVERAGE IS UNLAWFUL AND SHALL SUBJECT AN EMPLOYER TO CRIMINAL PENALTIES AND CIVIL FINES UP TO ONE HUNDRED THOUSAND DOLLARS (\$100,000) IN ADDITION TO THE COST OF COMPENSATION, DAMAGES AS PROVIDED FOR IN SECTION 3706 OF THE LABOR CODE, INTEREST AND ATTORNEY'S FEE.

THIS PERMIT SHALL EXPIRE BY LIMITATION IF WORK IS NOT COMMENCED WITHIN 180 DAYS.

Lot # 7

Mahal Company
Surjit Mahal
Cel: (916) 240-1785
Fax: (916) 419-3690

Letter of Intent

April 13, 2006

To: City of Sacramento Building Department

This letter is in regards to the Sully Subdivision (aka: Sycamore – Sully) located on Sully Street north of Main Ave and Norwood Ave. The subdivision consists of 20 single family lots.

I Surjit Mahal, owner of the above referenced property agree to complete the final grade and front yard landscaping on the homes as soon as the weather clears up. I am requesting the final sign off on the building permits prior to completing the final grade and landscaping. I assure you that all other items shall be completed prior to requesting the final permits to be signed off.

I greatly appreciate your cooperation in working with me during this unpleasant weather situation.

Thank you,



Surj Mahal
Cel: (916) 240 – 1785

Lot #7



ALTERNATE MATERIALS OR METHODS

Permission has been granted for the installation of :

PEX PIPE AND FITTINGS

Job name/location Sycamore Park (Sully Subdivision)
4837 Sully Street, Sacramento, CA 95838

Total no. of buildings 20 Homes

REQUIREMENTS

1. Permission is granted to above named address only.
2. Installers must be certified by manufacturers and city of Sacramento.
3. Manufactures installation instructions must be on jobsite and available to inspectors.
4. This notice must be posted on jobsite with permits.
5. Permission to use alternate materials or methods can be revoked if found to have been unlawfully issued.
6. This permission has been granted per the following code sections:
CPC 301.2—CMC 105.0—CBC 104.2.8—CEC 90-2

Keith A. Winkle
Administrative Authority
Keith A. Winkle
CHIEF PLUMBING INSPECTOR

11-9-05
Date

I request permission to use the product or method shown above. I am the legal owner/or authorized agent of owner.

Name: Sujit Patel (owner) Date: Nov 3 2005

CERTIFICATION OF INSULATION

PART I GENERAL	SURJ MATHAL LOT # 7 291 DELTA LOOP WAY		SACRAMENTO PRODUCTS						
			<input checked="" type="checkbox"/> P.O. BOX 854, WEST SACRAMENTO, CA 95691 LIC. #202026 <input type="checkbox"/> 1309 MELODY ROAD, MARYSVILLE, CA 95901 LIC. #202026 <input type="checkbox"/> P.O. BOX 9651, FRESNO, CA 93793-9651 LIC. #202026 <input type="checkbox"/> P.O. BOX 1631, RENO, NV 89505 LIC. #10675 <input type="checkbox"/> 3326 A PONDEROSA WAY, LAS VEGAS, NV 89118 LIC. #10675 DATE INSULATION COMPLETED						
PART II AREAS INSULATED	WALLS		CEILING			FLOORS			
	(SQUARE FEET)		(SQUARE FEET)			(SQUARE FEET)			
	TYPE OF INSULATION		TYPE OF INSULATION			TYPE OF INSULATION			
	MATERIAL FIBERGLASS		MATERIAL FIBERGLASS			MATERIAL FIBERGLASS			
	FORM BATTS		FORM BATTS & BLOW			FORM BATTS			
	MANUFACTURER'S PRODUCT I.D.		MANUFACTURER'S PRODUCT I.D.			MANUFACTURER'S PRODUCT I.D.			
	MANUFACTURER		MANUFACTURER			MANUFACTURER			
	CT	OC	JM	CT	OC	JM	CT	OC	JM
			BAGS						
	R - VALUE INSTALLED	APPLIED THICKNESS	R - VALUE INSTALLED	APPLIED THICKNESS	MIN. INSTALLED WEIGHT PER SQUARE FOOT	R - VALUE INSTALLED	APPLIED THICKNESS		
	13 19	3.5 5.5	38	12 1/4 75	—	—	—		
	NOTE: WALLS IF R-VALUE IS OTHER THAN WALLS ABOVE								
MATERIAL FIBERGLASS		FORM BATTS		R VALUE		MANUFACTURER			
						CT	OC	JM	
AIR INFILTRATION SEALANT									
MATERIAL				MANUFACTURER					
FOAM				HILTI		HANDY FOAM			
THIS IS TO CERTIFY THAT INSULATION AND/OR SEALANT HAS BEEN INSTALLED IN CONFORMANCE WITH APPLICABLE CODES, MATERIAL STANDARDS AND REGULATIONS.									
SIGNATURE — INSULATION CONTRACTOR		B.G.		TITLE MANAGER		DATE 1/23/06			
SIGNATURE — GENERAL CONTRACTOR				TITLE		DATE			
REMARKS									

INSTALLATION CARD
Diamond Wall One Coat System
Omega Products International, Inc.

Project Address

PALACE DEVELOPMENT Lot# 7
295 DELTA LEAF WAY
SACRAMENTO, CA. 95838

ICBO Evaluation Service, Inc.

Report ER-4004

Date Completed 2/1/06

Plastering Contractor:

Name: Vision Plastering, Inc.
Address: 8974 Greenback Lane, Orangevale, CA 95662
Tele No: (916) 987-3324

Approved contractor number as issued by Omega Products Int'l., Inc. 2390

This is to certify that the exterior coating system on the building exterior at the above address has been installed in accordance with the evaluation report and the manufacturer's instructions.

Signature of authorized representative of
plastering contractor

4/12/06
Date

This installation card must be presented to the building inspector after the completion of work and before final inspection.

INSTALLATION CERTIFICATE**CF-6R**

Site Address: 291 DELTA LEAF WAY, SACRAMENTO, CA

Permit Number

An installation certificate is required to be posted at the building site or made available for all appropriate inspections. (The information provided on this form is required) After completion of final inspection, a copy must be provided to the building department (upon request) and the building owner at occupancy, per Section 10-103(b).

HVAC SYSTEMS:**Heating Equipment**

Equip. Type (pkg. heat pump)	CEC Certified Mfr. name and Model Number	# of Identical Systems	Efficiency (AFUE, etc.) ¹ (=CF-1R value)	Duct Location (attic, etc.)	Duct or Piping R-value	Heating Load (Btu/hr)	Heating Capacity (Btu/hr)
Furnace	Carrier #58STX080-16	1	0.80	Attic	R-4.2	40,728	70,000

Cooling Equipment

Equip. Type (pkg. Heat pump)	CEC Certified Mfr. Name and Model Number	# of Identical Systems	Efficiency (SEER or EER) (=CF-1R value)	Duct Location (attic, etc.)	Duct R-value	Cooling Load (Btu/hr)	Cooling Capacity (Btu/hr)
A/C	Carrier #38BRC048	1	12.0	Attic	R-4.2	32,317	43,200

1. ≥ reads greater than or equal to what is indicated on the CF-1R value.

Include both SEER and EER if compliance credit for high EER air conditioner is claimed.

I, the undersigned, verify that equipment listed above is: 1) is the actual equipment installed, 2) equivalent to or more efficient than that specified in the certificate of compliance (Form CF-1R) submitted for compliance with the *Energy Efficiency Standards* for residential buildings, and 3) equipment that meets or exceeds the appropriate requirements for manufactured devices (from the *Appliance Efficiency Regulations* or Part 6), where applicable.

Gregory A. [Signature] 4/12/06
Signature Date

Beutler Corporation

Installing Subcontractor (Co. Name)

OR General Contractor (Co. Name) OR Own

COPY TO: Building Department
HERS Rater (if applicable)
Building Owner at Occupancy

Residential Compliance Forms

March 2005

Site Address

Permit Number

An installation certificate is required to be posted at the building site or made available for all appropriate inspections. (The information provided on this form is required; however, use of this form to provide the information is optional.) After completion of final inspection, a copy must be provided to the building department (upon request) and the building owner at occupancy, per Section 10-103(b).

HVAC SYSTEMS:

Heating Equipment

Equip. Type (pkg. heat pump)	CEC Certified Mfr Name and Model Number	# of Identical Systems	Efficiency (AFUE, etc.) ¹ [\geq CF-1R value]	Duct Location (attic, etc.)	Duct or Piping R-value	Heating Load (Btu/hr)	Heating Capacity (Btu/hr)

Cooling Equipment

Equip. Type (pkg. heat pump)	CEC Certified Compressor Unit Mfr Name and Model Number	# of Identical Systems	Efficiency (SEER, etc.) ¹ [\geq CF-1R value]	Duct Location (attic, etc.)	Duct R-value	Cooling Load (Btu/hr)	Cooling Capacity (Btu/hr)

1. \geq reads greater than or equal to.

I, the undersigned, verify that equipment listed above is: 1) is the actual equipment installed, 2) equivalent to or more efficient than that specified in the certificate of compliance (Form CF-1R) submitted for compliance with the *Energy Efficiency Standards* for residential buildings, and 3) equipment that meets or exceeds the appropriate requirements for manufactured devices (from the *Appliance Efficiency Regulations* or Part 6), where applicable.

Signature, Date

Installing Subcontractor (Co. Name)

OR General Contractor (Co. Name) OR Owner

WATER HEATING SYSTEMS:

Heater Type	CEC Certified Mfr Name & Model Number	Distribution Type (Std. Point-of-Use)	If Recirculation, Control Type	# of Identical Systems	Rated ² Input (kW or Btu/hr)	Tank Volume (gallons)	Efficiency ² (EF, RE)	Standby ² Loss (%)	External Insulation R-value ³
Water	American Water Heaters EG-61-50540-3NOV	std	N/A	1	40000 input Btu's	5.5	BEF	58%	R-4

2. For small gas storage (rated input of less than or equal to 75,000 Btu/hr), electric resistance and heat pump water heaters, list Energy Factor.

For large gas storage water heaters (rated input of greater than 75,000 Btu/hr), list Recovery Efficiency, Standby Loss and Rated Input.

For instantaneous gas water heaters, list Recovery Efficiency and Rated Input.

3. R-12 external insulation is mandatory for storage water heaters with an energy factor of less than 0.58.

Faucets & Shower Heads:

All faucets and showerheads installed are certified to the Commission, pursuant to Title 24, Part 6, Section 111.

I, the undersigned, verify that equipment listed above my signature is: 1) the actual equipment installed; 2) equivalent to or more efficient than that specified in the certificate of compliance (Form CF-1R) submitted for compliance with the *Energy Efficiency Standards* for residential buildings; and 3) equipment that meets or exceeds the appropriate requirements for manufactured devices (from the *Appliance Efficiency Regulations* or Part 6), where applicable.

Arjit Mahal 7/14/06
Signature, Date

Mahal Company
Installing Subcontractor (Co. Name) OR
General Contractor (Co. Name) OR Owner

COPY TO: Building Department
HERS Provider (if applicable)
Building Owner at Occupancy

FRONT YARD TO PROVIDE FULL LANDSCAPE INCL.
IRRIGATION, GRASS AND SHRUBS.

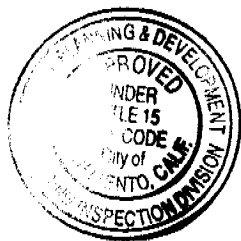
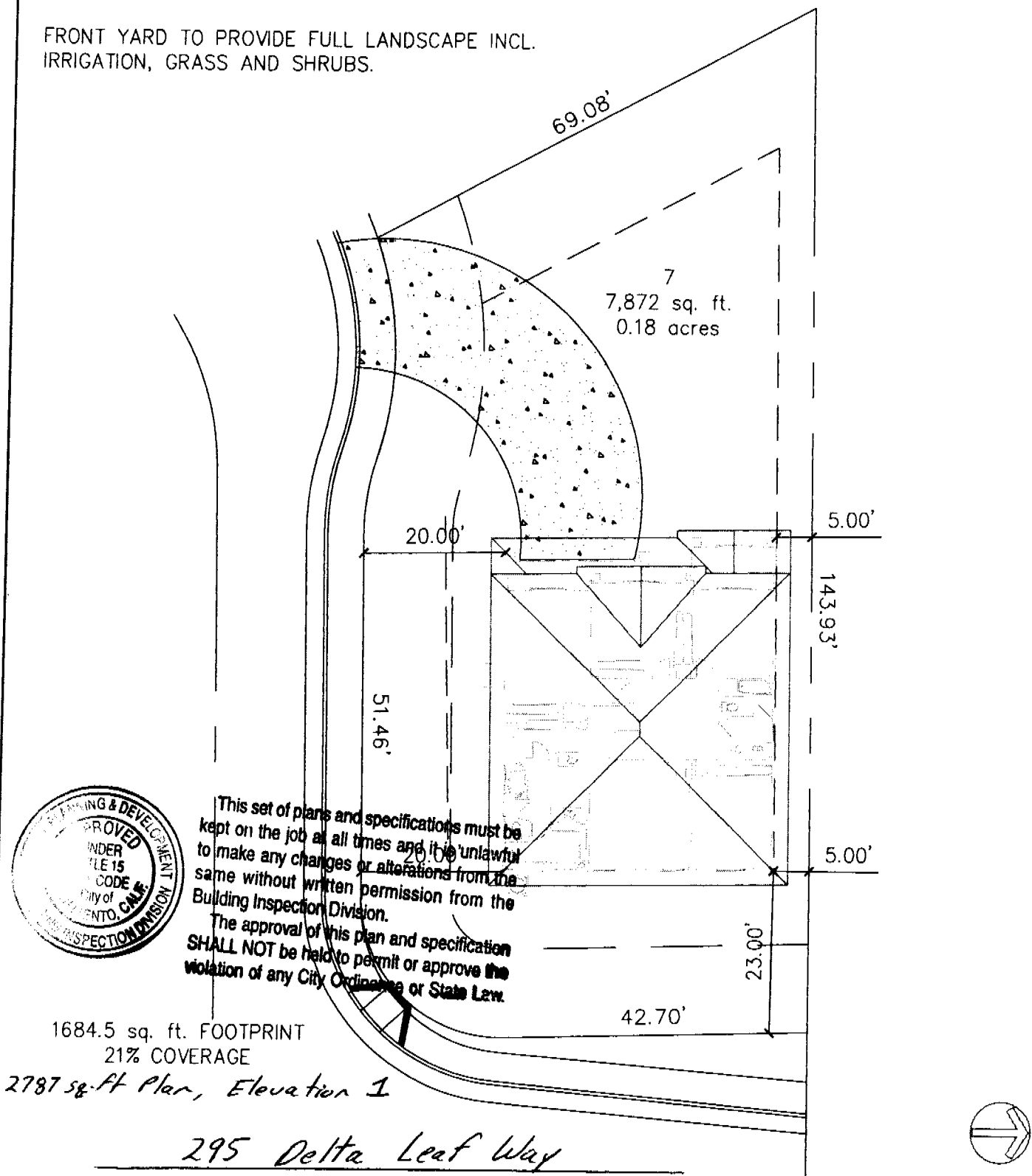

This set of plans and specifications must be kept on the job at all times and it is unlawful to make any changes or alterations from the same without written permission from the Building Inspection Division. The approval of this plan and specification SHALL NOT be held to permit or approve the violation of any City Ordinance or State Law.

1684.5 sq. ft. FOOTPRINT
21% COVERAGE

2787 sq. ft. Plan, Elevation 1

295 Delta Leaf Way

Sully Street LLC.

P.O. Box 1082
Sacramento CA. 95812
Contact Surj Mahal
Ph. 916.240.5459

Subdivision	SULLY HOMES
Lot Number	7
Lot Size	7,872 sq. ft.
Scale	1" = 20'-0"
Date	2-15-05