



CITY OF SACRAMENTO

March 25th, 1980

REAL ESTATE AND STREET ASSESSMENTS DIVISION

915 I STREET
CITY HALL ROOM 207

SACRAMENTO, CALIFORNIA 95811
TELEPHONE (916) 449-5625

CITY MANAGER'S OFFICE
RECEIVED
MAR 20 1980

IRVIN E. MORAES
REAL ESTATE SUPERVISOR

City Council
Sacramento, California

Honorable Members In Session:

SUBJECT: Authorizing Giving of Notice of Intent to Adopt
Condemnation Resolutions to Acquire Round Corner
at Southwest corner of Intersection of El Camino
Avenue and Grove Avenue

BACKGROUND INFORMATION

In order to improve the traffic flow at the above subject intersection, it is necessary to acquire additional property for a 43 foot radius round corner from the Southwest corner of the above stated intersection. The lot is fully improved with a dwelling and attached garage.

FINANCIAL DATA

The estimated acquisition cost of this parcel is approximately \$2,500.00 and will be financed by Gas Tax Fund.

RECOMMENDATION

It is recommended that the attached Resolution Authorizing Giving of Notice of Intent to adopt Condemnation Resolution be adopted.

Respectfully submitted,

R. H. Parker
City Engineer

Recommendation Approved

Walter J. Slupe
City Manager

RHP:IEM:bd
Attachments

March 25th, 1980
DISTRICT NO. 2

APPROVED
BY THE CITY COUNCIL

MAR 25 1980

OFFICE OF THE
CITY CLERK

ice 4'-6" P.C.C. Sidewalk
d Curb & Gutter #4
Match existing
Driveway

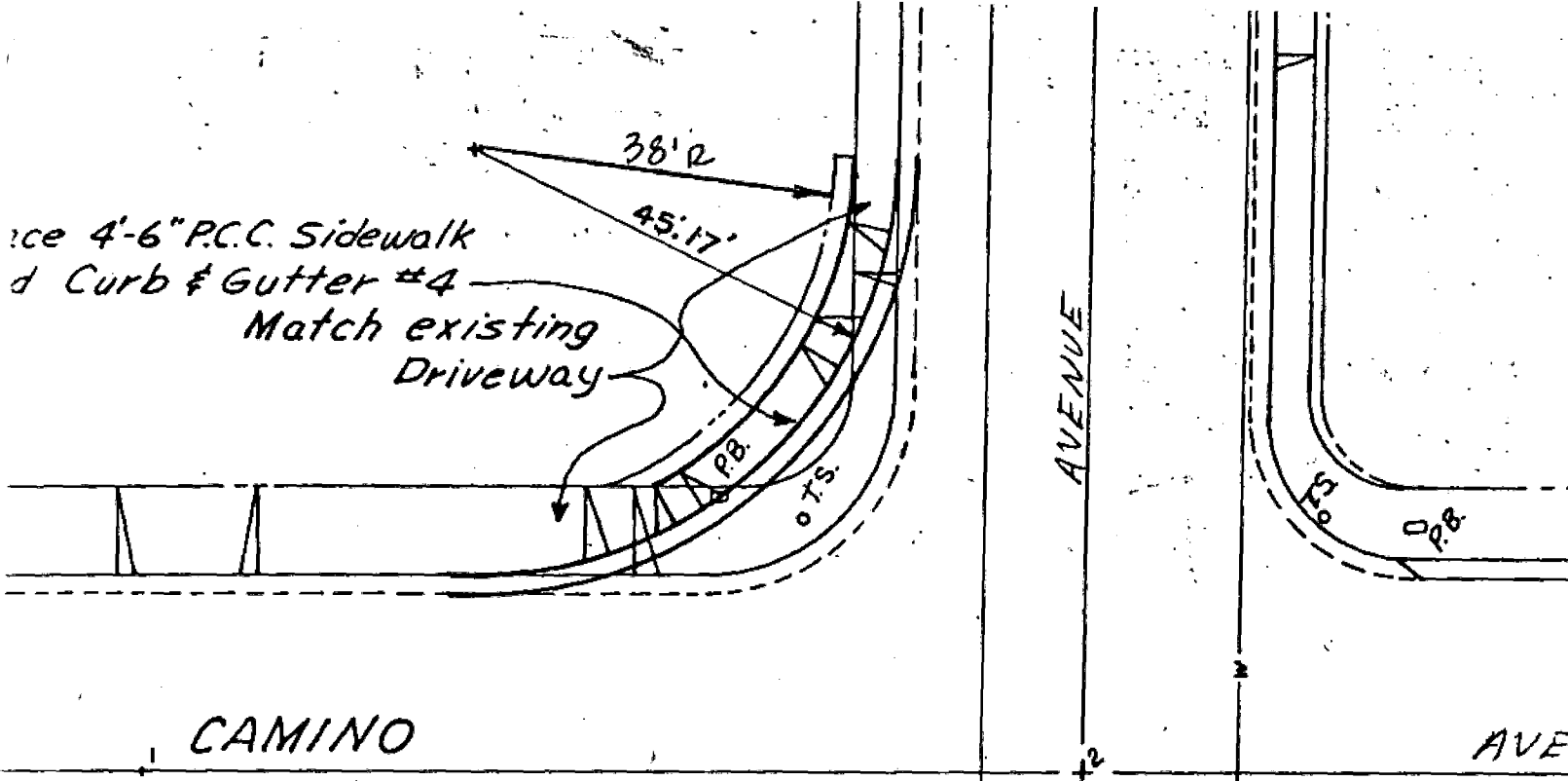

CAMINO

AVENUE

AVE

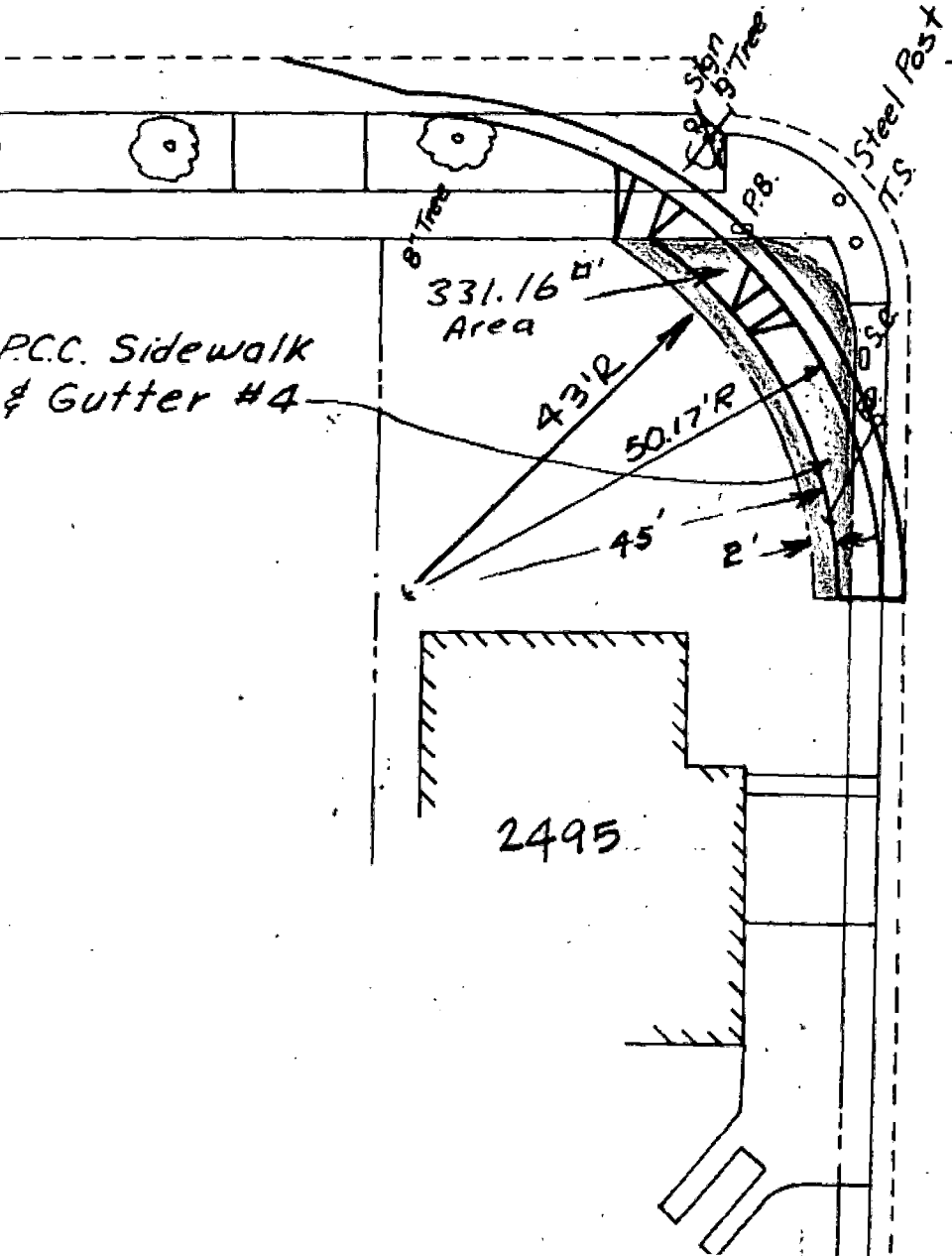

P.C.C. Sidewalk
& Gutter #4

331.16 Area

43' R

50.17' R

45'

2'

Steel Post

2495

E GROVE

1" = 20'

RESOLUTION NO. 80-169

Adopted by The Sacramento City Council on date of

MARCH 25, 1980

RESOLUTION AUTHORIZING GIVING OF NOTICE OF
INTENT TO ADOPT CONDEMNATION RESOLUTION:

ACQUISITION OF PARCEL 1877-1, ROUND CORNER
AT SOUTHWEST CORNER OF EL CAMINO AVENUE AND
GROVE AVENUE INTERSECTION

Recitals:

A. It has been recommended to the City Council that a certain parcel of property be acquired by the City for public use by this exercise of the power of eminent domain.

B. The City desires to afford the owner of such parcel the opportunity to appear and be heard at a public hearing concerning those matters specified in Section 1245.235 of the Code of Civil Procedure.

NOW, THEREFORE, BE IT RESOLVED BY THE COUNCIL OF THE CITY OF SACRAMENTO AS FOLLOWS:

1. That the City Council announces its intent to adopt the attached resolution, marked Exhibit A.

2. That the City Clerk is hereby authorized and directed to give the notice of said intention as required by Section 1245.235 of the Code of Civil Procedure.

3. That said notice shall provide that the City Council shall hold the hearing required by Section 1245.235 of the Code of Civil Procedure at the regular Council meeting to be held at 7:30 P. M. on April 29th, 1980 in the City Council Chambers and that the request to appear and be heard at said hearing shall be filed in writing in the office of the City Clerk not later than 5:00 P. M. on April 22nd, 1980.

MAYOR

ATTEST:

CITY CLERK

APPROVED
BY THE CITY COUNCIL

MAR 25 1980

OFFICE OF THE
CITY CLERK

RESOLUTION NO.

Adopted by The Sacramento City Council on date of

APRIL 29, 1980

RESOLUTION OF NECESSITY: ACQUISITION OF
PARCEL 1877-1, ROUND CORNER AT SOUTHWEST
CORNER OF EL CAMINO AND GROVE AVENUES
INTERSECTION

BE IT RESOLVED BY THE COUNCIL OF THE CITY OF SACRAMENTO, TWO-THIRDS OF ALL MEMBERS OF SAID COUNCIL VOTING IN FAVOR THEREOF:

1. That the City of Sacramento intends to acquire through the exercise of the power of eminent domain the real property or interests in real property hereinafter described as Parcel 1877-1, (herein referred to as the "Subject Parcel").

2. That the City of Sacramento intends to acquire the Subject Parcel in fee simple absolute unless a lesser estate is expressly specified in the description of said parcel.

3. That the Subject Parcel is to be taken for the following public use: road purposes.

4. That the statute or statutes authorizing the City of Sacramento to acquire the Subject Parcel for the above-mentioned public purposes are as follows: Government Code, Section 37350.5.

5. That the Subject Parcel is generally located at 2495 Grove Avenue, Sacramento, California.

6. That the City Council declares that it has found and determined each of the following:

a. The public interest and necessity require the site for the improvement of traffic flow at the intersection of El Camino Avenue and Grove Avenue.

b. The improvement of the intersection will be in the manner that will be most compatible with the greatest public good and the least private injury.

c. The Subject Parcel is necessary for the improvement of traffic flow at said intersection.

7. That the City of Sacramento, a municipal corporation, its appropriate officers, employees and agents, are hereby authorized and empowered:

a. To acquire in fee simple in the name of the City of Sacramento, a municipal corporation, the Subject Parcel by condemnation in accordance with the provisions of the Eminent Domain Law of the State of California.

EXHIBIT "A"

b. To prepare, file and prosecute in the appropriate court, such proceedings in eminent domain as are necessary for the acquisition of the Subject Parcel; and,

c. To deposit the probable amount of compensation, as fixed by the City Council in accordance with law, with the Clerk of the appropriate court and to make application to said court for an order permitting the City of Sacramento to take immediate possession and use of the Subject Parcel.

8. The Subject Parcel, being the real property or interests therein which the City is by this Resolution authorized to acquire is situated in the City of Sacramento, State of California, and described as follows:

Parcel 1877-1

All that portion of Lot 13, in Block 8 as shown on the Official Plat of North Sacramento Subdivision No. 10, filed in the office of the County Recorder of Sacramento County, California on April 4, 1916, in Book 15 of Maps, Map No. 31, described as follows:

Beginning at a point on the Eastern boundary line of said Lot 13 as described above, located North 0° 05' East 106.61 feet from the Southeast corner of said Lot 13; thence North 89° 55' West 3.5 feet; thence along the arc of a curve to the left with a radius of 43 feet, and a central angle of 59° 32' 59", said arc being subtended by a chord bearing North 29° 41' 30" West 42.71 feet to a point on the northern boundary line of said Lot 13; thence North 89° 03' East 12.29 feet; thence along the arc of a curve to the right with a radius of 12.2 feet, and a central angle of 91° 02', said arc being subtended by a chord bearing South 45° 25' 12" East 17.41 feet to a point on the eastern boundary line of said Lot 13; thence South 0° 05' West 25.09 feet to the point of beginning; containing 331.16 square feet, more or less.

MAYOR

ATTEST:

CITY CLERK