

**CITY OF SACRAMENTO  
DEPARTMENT OF PLANNING & DEVELOPMENT  
ZONING ADMINISTRATOR  
1231 I Street, Sacramento, CA 95814**

**ACTION OF THE ZONING ADMINISTRATOR**

On Tuesday August 10, 1993, the variance request to waive the required six foot decorative masonry wall along the east property line was withdrawn by the applicant (File Z93-022).

This variance had previously been approved by the Planning Commission (P86-229). See Page 2 for further information.

**Project Information**

**Request:** Zoning Administrator's Variance to waive the required six foot masonry wall for a church parking lot on 3± partially developed acres in the Agriculture (A) zone.

**Location:** 475 Florin Road

**Assessor's Parcel Number:** 030-0370-002

<b>Applicant:</b> Greenhaven Lutheran Church 475 Florin Road Sacramento, Ca 95831	<b>Property Owner:</b> Lutheran Church Missouri Synod-CA-NV District 465 Woolsey Street San Francisco, CA 94134
---	---

**General Plan Designation:** Public/Quasi-public- Miscellaneous  
Pocket Community

**Plan Designation:** Institutional

**Existing Land Use of Site:** Church

**Existing Zoning of Site:** Agriculture (A)

Surrounding Land Use and Zoning:	Setbacks	Required	Provided
North: R-2A; Vacant	Front:	25'	50'
South: A; High School	Side(Int):	5'	165'
East: R-1; Single Family	Side(St):	12.5'	50'
West: R-2A; Apartments	Rear:	15'	155'

Current Sanctuary Occupancy: 251  
 Parking Required: 42 spaces (1 space per 6 seats approved ratio, at 1:4 ratio the requirement would be 63 spaces)  
 Parking Provided: 58 spaces  
 Property Area: 3.0± acres  
 Square Footage of Building: 5,764 sq. ft.  
 Height of Building: One Story, 20 feet  
 Exterior Building Materials: T-1/11 Plywood, cement plaster  
 Roof Materials: Asphalt shingle  
 Topography: Flat  
 Street Improvements: Existing

Project Plans: See Exhibit A.

Project History and Additional Information:

On February 27, 1968, the Planning Commission approved a 4,111 square foot church with 108 seats and 28 parking spaces (P-3185). The original plans showed future buildings and parking on the remaining acreage. On May 8, 1986, the Planning Commission approved a Special Permit to expand a church facility and establish a master plan for the church (P86-133). One of the conditions stated "The applicant shall install a six-foot solid decorative masonry wall at the time of the Phase II parking lot expansion or obtain the necessary waiver." On July 10, 1986 the Planning Commission approved a variance to waive the required masonry wall along the east property line of the site (P86-229). On February 10, 1987, the Planning Director approved a Special Permit Modification to allow the parking lot to be expanded from 28 to 53 spaces as part of Phase I (P86-133). The Phase I Multi-Purpose Room/Fellowship Hall was constructed in 1986-87, activating the master plan development and related entitlements (special permit/variance). The church decided to defer the parking lot expansion. In November of 1992, a building permit was issued to the church to expand the sanctuary to 238 seats (building occupant load - 251) and the church parking lot to 58 spaces. The church again applied for a variance to waive the wall (Z93-022). The application, however, is not necessary as the waiver of the wall has been approved. The applicant, therefore, has withdrawn the current variance application.

Staff of both the Planning and Building Divisions have visited the project site. The sanctuary and parking lot improvements have been completed and the project is ready for a Final Certificate of Occupancy.



\_\_\_\_\_  
 Joy D. Patterson  
 Zoning Administrator

cc: File (original)                      ZA Log Book  
       Applicant                              Building Division

Z93-022

August 10, 1993

Item #3

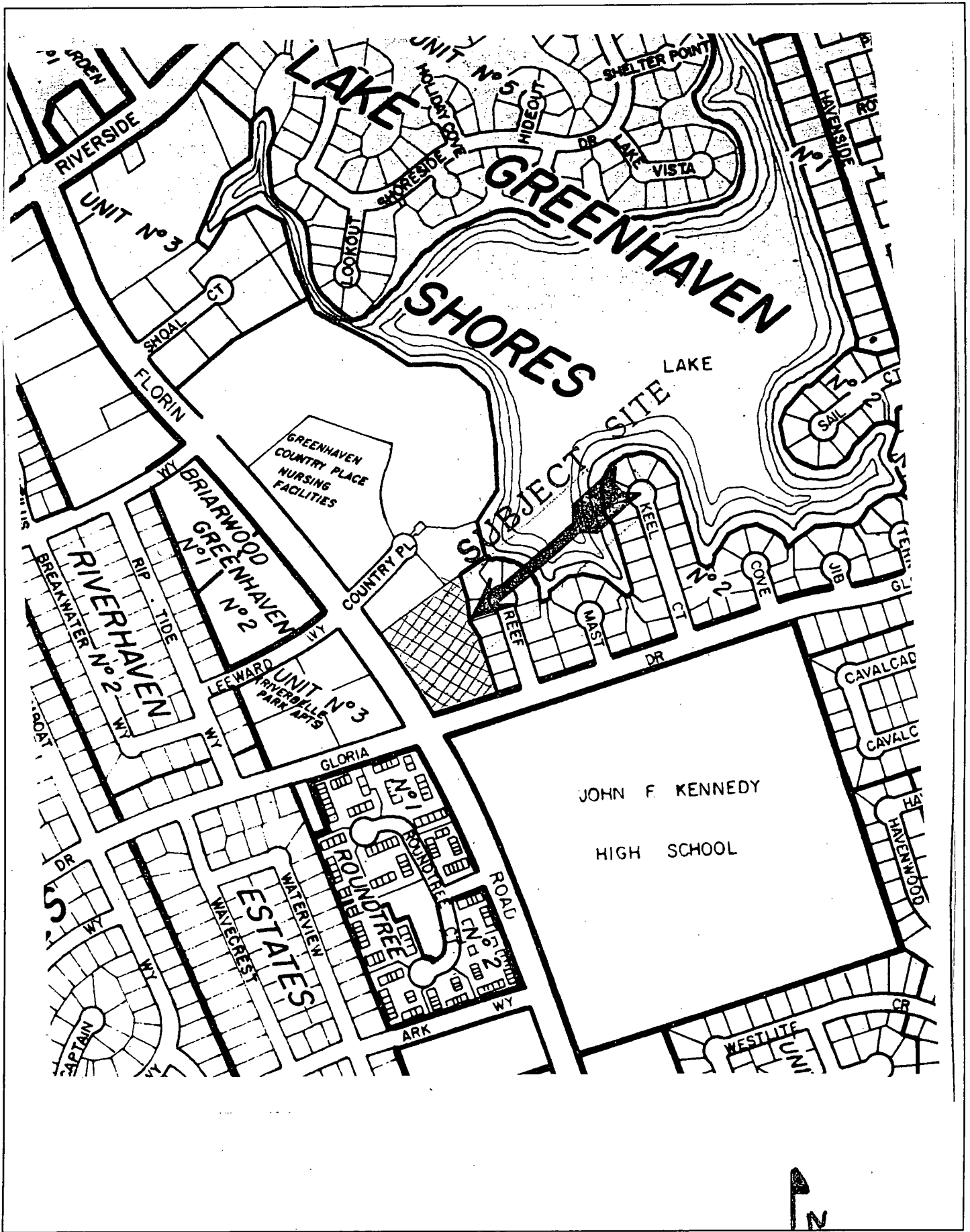

VICINITY MAP



EXHIBIT - A

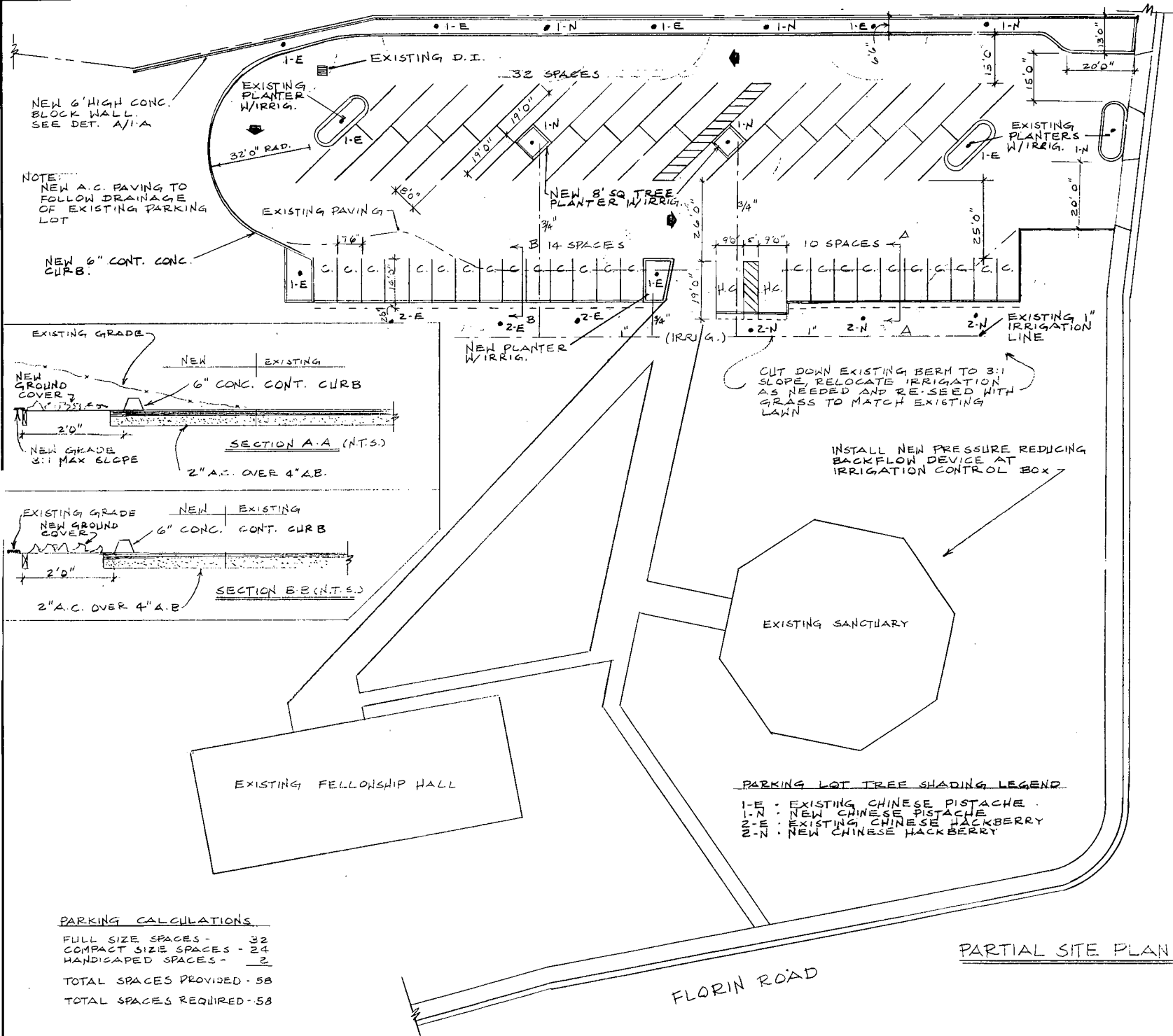

ITEM #3

AUGUST 10, 1993

293-022

REVISIONS	BY

GREENHAVEN LUTHERAN CHURCH

Date	9-25-92
Scale	1" = 20'0"
Drawn	
Job	
Sheet	4 - A
Of	4 Sheets