

CITY OF SACRAMENTO
1231 I Street, Sacramento, CA 95814

Permit No: 0113258
Insp Area: 4
Thos Bros:
Sub-Type: NSFR
N

Site Address: 339 ALCANTAR CR SAC
Parcel No: RIVERVIEW 2-3B LOT 18 Housing (Y/N):

CONTRACTOR
D. R. HORTON INC.
4401 HAZEL AVE STE 135
FAIR OAKS, CA 95628

OWNER

ARCHITECT

Nature of Work: NSFR MP2450/FLEX 2 STORY 9 RMS

CONSTRUCTION LENDING AGENCY : I hereby affirm under penalty of perjury that there is a construction lending agency for the performance of the work for which this permit is issued (Sec. 3097, Civ. C).

Lender's Name _____ Lender's Address _____

LICENSED CONTRACTORS DECLARATION: I hereby affirm under penalty of perjury that I am licensed under provisions of Chapter 9 (commencing with section 7000) of Division 3 of the Business and Professions Code and my license is in full force and effect.

License Class B License Number 750190 Date 10/15/01 Contractor Signature N. Collins

OWNER-BUILDER DECLARATION: I hereby affirm under penalty of perjury that I am exempt from the contractors License Law for the following reason (Sec. 7031.5, Business and Professions Code; any city or county which requires a permit to construct, alter, improve, demolish, or repair any structure, prior to its issuance, also requires the applicant for such permit to file a signed statement that he or she is licensed pursuant to the provisions of the Contractors License Law (Chapter 9 (commencing with Section 7000) of Division 8 of the Business and Professions Code) or that he or she is exempt therefrom and the basis for the alleged exemption. Any violation of Section 7031.5 by any applicant for a permit subjects the applicant to a civil penalty of not more than five hundred dollars (\$500.00);

____ I, as a owner of the property, or my employees with wages as their sole compensation, will do the work, and the structure is not intended or offered for sale (Sec. 7044, Business and Professional Code: The Contractors License Law does not apply to an owner of property who builds or improves thereon, and who does such work himself or herself or through his/her own employees, provided that such improvements are not intended or offered for sale. If, however, the building or improvement is sold within one year of completion, the owner-builder will have the burden of proving that he/she did not build or improve for the purpose of sale.)

____ I, as owner of the property, am exclusively contracting with licensed contractors to construct the project (Sec. 7044, Business and Professions Code: The Contractors License Law does not apply to an owner of property who builds or improves thereon, and who contracts for such projects with a contractor(s) licensed pursuant to the Contractors License Law).

____ I am exempt under Sec. _____ B & PC for this reason: _____

Date _____ Owner Signature _____

IN ISSUING THIS BUILDING PERMIT, the applicant represents, and the city relies on the representation of the applicant, that the applicant verified all measurements and locations shown on the application or accompanying drawings and that the improvement to be constructed does not violate any law or private agreement relating to permissible or prohibited locations for such improvements. This building permit does not authorize any illegal location of any improvement or the violation of any private agreement relating to location of improvements.

I certify that I have read this application and state that all information is correct. I agree to comply with all city and county ordinances and state laws relating to building construction and hereby authorize representative(s) of this city to enter upon the abovementioned property for inspection purposes.

Date 10/15/01 Applicant/Agent Signature N. Collins

WORKER'S COMPENSATION DECLARATION: I hereby affirm under penalty of perjury one of the following declarations:

____ I have and will maintain a certificate of consent to self-insure for workers' compensation as provided for by Section 3700 of the Labor Code, for the performance of work for which the permit is issued.

I have and will maintain workers' compensation insurance, as required by Section 3700 of the Labor Code, for the performance of the work for which this permit is issued. My workers' compensation insurance carrier and policy number are:

Carrier KEMPER INSURANCE CO Policy Number 5BR08354700 Exp Date 07/01/2002

____ (This section need not be completed if the permit is for \$100 or less) I certify that in the performance of the work for which this permit is issued, I shall not employ any person in any manner so as to become subject to the workers' compensation laws of California and agree that if I should become subject to the workers' compensation provisions of Section 3700 of the Labor Code, I shall forthwith comply with those provisions.

Date 10/15/01 Applicant Signature N. Collins

WARNING: FAILURE TO SECURE WORKERS COMPENSATION COVERAGE IS UNLAWFUL AND SHALL SUBJECT AN EMPLOYER TO CRIMINAL PENALTIES AND CIVIL FINES UP TO ONE HUNDRED THOUSAND DOLLARS (\$100,000) IN ADDITION TO THE COST OF COMPENSATION, DAMAGES AS PROVIDED FOR IN SECTION 3706 OF THE LABOR CODE, INTEREST AND ATTORNEY'S FEE.

THIS PERMIT SHALL EXPIRE BY LIMITATION IF WORK IS NOT COMMENCED WITHIN 180 DAYS.

RESIDENTIAL SUBDIVISION BUILDING PERMIT APPLICATION

Project Address: 339 Alcantara Circle Assessor Parcel # 225-0190-017
Lot Number: 18 Subdivision RIVERVIEW #2, Unit #3B

OWNER INFORMATION:

Legal Property Owner: D.R. HORTON Phone# 965-2200
Owner Address: City State Zip

CONTRACTOR INFORMATION:

Contractor: DA HORTON Lic. # 750190 Phone # 965-2200 Fax 956-22

PROJECT INFORMATION:

Land Use Zone R1A Occupancy Group R3 Construction Type VN Fed Code 1A
No. of Stories: 2 No. of Rooms: 10 Street Width:
1st Floor Area 2nd Floor Area Basement Roof Material
AREA IN SQUARE FOOT OF:
Dwelling/Living 21015
Garage/Storage 485
Decks/Balconies 36
Carports
SCOPE OF WORK:

- Information Above Complete AR Flood Waiver Required Planning Approval
Violation Files Checked Flood Elevation Certificate Required Design Review Approval
Standard Setbacks Water Development Infill Area Special Fee Districts Apply:
County Sewer

-THE FOLLOWING MUST BE PROVIDED IN ORDER TO SUBMIT FOR PERMIT-

- 2 COMPLETE PLOT PLANS, LEGIBLE & DRAWN TO SCALE
1 X 17 COPY OF FLOOR PLAN WITH FOLLOWING INFORMATION:
a) Assessor's Parcel Number c) Owners Name
b) New Floor Area d) Project Address

CERTIFICATION OF INSULATION

PART I GENERAL
PART II AREAS INSULATED
PART III CERTIFICATION

ADDRESS OR TRACT

SACRAMENTO INSULATION CONTRACTORS

D.N. WORTON

LOT # *18B*

- P.O. BOX 854, WEST SACRAMENTO, CA 95691 LIC. #202026
- 1309 MELODY ROAD, MARYSVILLE, CA 95901 LIC. #202026
- P.O. BOX 9651, FRESNO, CA 93793-9651 LIC. #202026
- P.O. BOX 1631, RENO, NV 89505 LIC. #10675
- 3326 A PONDEROSA WAY, LAS VEGAS, NV 89118 LIC. #10675

PARK WEST

DATE INSULATION COMPLETED

WALLS

CEILINGS

FLOORS

(SQUARE FEET)

(SQUARE FEET)

(SQUARE FEET)

TYPE OF INSULATION

TYPE OF INSULATION

TYPE OF INSULATION

MATERIAL

FIBERGLASS

MATERIAL

FIBERGLASS

MATERIAL

FIBERGLASS

FORM

BATTS

FORM

BATTS & BLOW

FORM

BATTS

MANUFACTURER'S PRODUCT I.D.

MANUFACTURER'S PRODUCT I.D.

MANUFACTURER'S PRODUCT I.D.

MANUFACTURER

OCF

MANUFACTURER

OCF

BAGS

MANUFACTURER

OCF

R-VALUE
INSTALLED

APPLIED
THICKNESS

R-VALUE
INSTALLED

APPLIED
THICKNESS

MIN. INSTALLED
WEIGHT PER
SQUARE FOOT

R-VALUE
INSTALLED

APPLIED
THICKNESS

*13
19*

*3 3/8"
5 1/2"*

*30
30*

*9"
12"*

KNEE WALLS IF R-VALUE IS OTHER THAN WALLS ABOVE

MATERIAL

FIBERGLASS

FORM

BATTS

R VALUE

MANUFACTURER

OCF

AIR INFILTRATION SEALANT

MATERIAL

FOAM

MANUFACTURER

W R GRACE

THIS IS TO CERTIFY THAT INSULATION AND/OR SEALANT HAS BEEN INSTALLED IN CONFORMANCE WITH APPLICABLE CODES, MATERIAL STANDARDS AND REGULATIONS.

SIGNATURE - INSULATION CONTRACTOR

Jeff Cable

TITLE

MANAGER

DATE

12-26-01

SIGNATURE - GENERAL CONTRACTOR

TITLE

DATE

REMARKS

PC-13

OMEGA PRODUCTS CORP.

DIAMOND WALL INSULATING STUCCO SYSTEM

JOB ADDRESS:

ICBO Report #4004

D.P. Honkan
PAK VIEW

Date of Job Completion, 1-20

PLASTERING CONTRACTOR:

Name: STUCCO WORKS INC.

Address: 5900 WAREHOUSE WAY, SACRAMENTO, CALIFORNIA 95826

Telephone No: (916) 383-6699

Contractor Number of Diamond Wall System 2175

This is to certify that the exterior coating system on the building exterior at the above address has been installed in accordance with the evaluation report specified above and the manufacturer's instructions.

Date 1/28/01

Signature of authorized representative of
Plastering Contractor

This installation card must be presented to the building inspector after completion of work and before final inspection.

Norman
Scheel
Structural
Engineer

Sacramento
5022 Sunrise Blvd.
Fair Oaks, CA 95628
(916) 536-9585
(916) 536-0260 (fax)

NORMAN SCHEEL
Structural Engineer
Email: norm@nsac.com

ROBERT COON
Project Manager
Email: rob@nsac.com

PAULO IBAÑEZ, P.E.
Project Manager
Email: paulo@nsac.com

TIM SLOAN, P.E.
Project Manager
Email: tim@nsac.com

STEVE COOKSEY
CAD Supervisor
Email: steve@nsac.com

STACY MARLIN
Office Manager
Email: stacy@nsac.com

Davis
213 E Street Suite B
Davis, CA 95616
(530) 753-5300
(530) 753-5380 (fax)

TRACY HARRIS, P.E.
Project Manager
Email: tracy@nsac-davis.com

DARRELL PEREIRA
Design Engineer
Email: darrell@nsac-davis.com

August 28, 2001

D.R. Horton
4401 Hazel Avenue #135
Fair Oaks, CA 95628

Re: Park West (Riverview) (Job #20424)
Inspection Clarification

To Whom It May Concern:

This letter is to clarify that in our opinion, the A25 or LPT4 clips are adequate enough to support the short pieces of sill plate. If possible, install a few shot pins to help stabilize the wall. In the future, move the plate breaks away from the door openings.

If you have any questions, please call Rob Coon

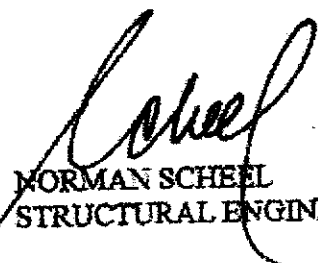
NORMAN SCHEEL
STRUCTURAL ENGINEER





WALLACE • KUHLE & ASSOCIATES INC.
 GEOTECHNICAL ENGINEERING • CONSTRUCTION TESTING

3050 Industrial Blvd.
 PO Box 1137
 West Sacramento
 California 95691
 916-372-1434

DATE 12-3-01		JOB NO. 42-0110		WEATHER Cloudy		TEMP. ° at _____ AM ° at _____ PM	
PROJECT Parkway				Technician I <input checked="" type="checkbox"/>		Staff E/G <input type="checkbox"/>	
LOCATION Lot 18				Technician II <input type="checkbox"/>		Project E/G <input type="checkbox"/>	
TYPE OF WORK Soil Test				Technician III <input type="checkbox"/>		Senior E/G <input type="checkbox"/>	
Inside 50 mi. radius <input checked="" type="checkbox"/>		Outside 50 mi. radius <input type="checkbox"/>		Nuclear Densities <input type="checkbox"/>		Principal E/G <input type="checkbox"/>	
PERSONNEL		REG. HRS	OT HRS	TOTAL HRS	TRAVEL	ON JOB	VEHICLE
Boyer Helms		1.5	0	1.5	1.5		37

OBSERVATIONS:

On site in an area adjacent to parking pull test on 3/4
 in. dia. to build a series of surface bolts. Devices with proper
 spacing for soil water table were maintained throughout to use
 Simpson load to determine values. All test pages requires S&S
 15-2825

In government base on three 1/2 bolts at lot 18 not all a
 possible there with no failures. Helms was in place and
 waited at the scene.

At 11:00 AM. Found no bearings exposed in place at lot 19

FIELD REPORT

Signed _____

399-10-1001

WOOD RODGERS INC.

NO. 8788 9.10.01

THIS PLAN IS PREPARED TO SHOW THE DIMENSIONAL RELATIONSHIP FROM BUILDING FOUNDATION TO PROPERTY LINE, DESIGN DRAINAGE CONTROL ELEVATIONS, AND DIRECTION OF DRAINAGE FLOW TO CONFORM WITH LOCAL ORDINANCES FOR THE PURPOSE OF BUILDING PERMIT ISSUANCE. INFORMATION SHOWN IS APPROXIMATE EXCEPT FOR THOSE SETBACKS WHICH ARE MINIMUMS REQUIRED BY ORDINANCE. THIS PLOT DOES NOT REFLECT AS BUILT CONDITIONS WHICH WILL LIKELY VARY FROM THIS PLAN.

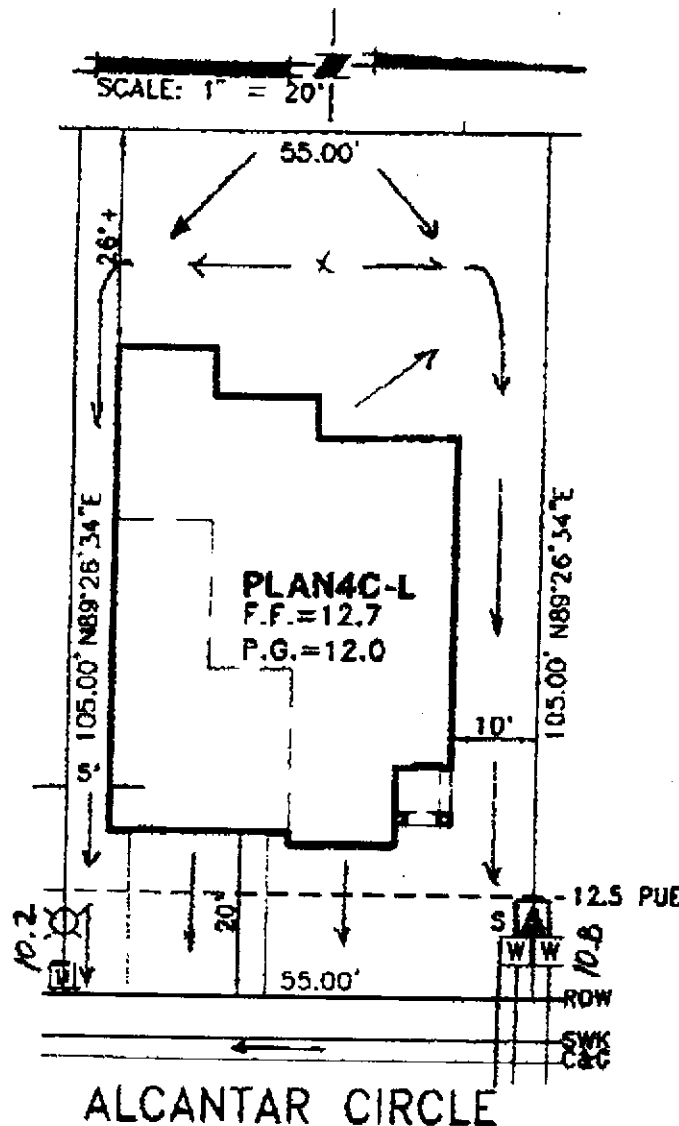

- ⊗ = STREET LIGHT
- ☐ = UTILITY BOX
- ▲ = TRANSFORMER

PLOT PLAN
LOT 18 B
RIVER VIEW #2, UNIT 3B
FOR
D.R. HORTON, INC.
SACRAMENTO CALIFORNIA

WOOD RODGERS INC.
ENGINEERING PLANNING MAPPING SURVEYING
8001 O STREET, BLDG. 1800 SACRAMENTO, CA 95811
PHONE: (916) 341-7760 FAX: (916) 341-0787

DATE: SEP 2001	DRAWN: HMB/ DAR	CHECKED: <i>[Signature]</i>	PROJECT NO: 1055.014
-------------------	-----------------------	--------------------------------	-------------------------

FILE: J:\085\VIEW\VIEW\DWG\CIVIL\LOT PLANS SAMPLER\Y3A38\LOTT18.DWG Last edited: 09/10/01 @ 17:04 by: Odaly

OK