

CITY OF SACRAMENTO

1231 I Street, Sacramento, CA 95814

Permit No: 0101612

Insp Area: 4

Site Address: 561 EASTBROOK WY SAC

Parcel No: 201-0370-065

NORTHBR 3-1 LOT 65

Sub-Type: NSFR

Housing (Y/N): N

CONTRACTOR

PS HOME
2366 GOLD MEADOW DR
SFE # 100 95670

OWNER

ARCHITECT

Nature of Work: MP 2566 2 STORY 9 ROOM SFR

CONSTRUCTION LENDING AGENCY: I hereby affirm under penalty of perjury that there is a construction lending agency for the performance of the work for which this permit is issued (Sec. 3097, Civ. C.)

Lender's Name _____ Lender's Address _____

LICENSED CONTRACTORS DECLARATION: I hereby affirm under penalty of perjury that I am licensed under provisions of Chapter 9 commencing with section 7000 of Division 3 of the Business and Professions Code and my license is in full force and effect.

License Class B License Number 457857 Date 2/22/01 Contractor Signature Don McCloskey

OWNER-BUILDER DECLARATION: I hereby affirm under penalty of perjury that I am exempt from the contractors License Law for the following reason (Sec. 7031.5, Business and Professions Code: any city or county which requires a permit to construct, alter, improve, demolish, or repair any structure, prior to its issuance, also requires the applicant for such permit to file a signed statement that he or she is licensed pursuant to the provisions of the Contractors License Law (Chapter 9 commencing with Section 7000) of Division 8 of the Business and Professions Code) or that he or she is exempt therefrom and the basis for the alleged exemption. Any violation of Section 7031.5 by any applicant for a permit subjects the applicant to a civil penalty of not more than five hundred dollars (\$500.00).

I, as a owner of the property, or my employees with wages as their sole compensation, will do the work, and the structure is not intended or offered for sale (Sec. 7044, Business and Professions Code). The Contractors License Law does not apply to an owner of property who builds or improves thereon, and who does such work himself or herself or through his/her own employees, provided that such improvements are not intended or offered for sale. If, however, the building or improvement is sold within one year of completion, the owner-builder will have the burden of proving that he/she did not build or improve for the purpose of sale.

I, as owner of the property, am exclusively contracting with licensed contractors to construct the project (Sec. 7044, Business and Professions Code). The Contractors License Law does not apply to an owner of property who builds or improves thereon, and who contracts for such projects with a contractor(s) licensed pursuant to the Contractors License Law.

I am exempt under Sec. _____ B & P for this reason: _____
Date _____ Owner Signature _____

IN ISSUING THIS BUILDING PERMIT, the applicant represents, and the city relies on the representation of the applicant, that the applicant verified all measurements and locations shown on the application or accompanying drawings and that the improvement to be constructed does not violate any law or private agreement relating to permissible or prohibited locations for such improvements. This building permit does not authorize any illegal location of any improvement or the violation of any private agreement relating to location of improvements.

I certify that I have read this application and state that all information is correct. I agree to comply with all city and county ordinances and state laws relating to building construction and hereby authorize representative(s) of this city to enter upon the abovementioned property for inspection purposes.

Date 2/22/01 Applicant/Agent Signature Don McCloskey

WORKER'S COMPENSATION DECLARATION: I hereby affirm under penalty of perjury one of the following declarations:
I have and will maintain a certificate of consent to self-insure for workers' compensation as provided for by Section 3700 of the Labor Code, for the performance of work for which the permit is issued.

I have and will maintain workers' compensation insurance, as required by Section 3700 of the Labor Code, for the performance of the work for which this permit is issued. My workers' compensation insurance carrier and policy number are:
Carrier OLD REPUBLIC INS. CO Policy Number MWC107468 00 Exp Date 11/01/2001

(This section need not be completed if the permit is for \$100 or less) I certify that in the performance of the work for which this permit is issued, I shall not employ any person in any manner so as to become subject to the workers' compensation laws of California and agree that if I should become subject to the workers' compensation provisions of Section 3700 of the Labor Code, I shall forthwith comply with those provisions.

Date 2/22/01 Applicant Signature Don McCloskey

WARNING: FAILURE TO SECURE WORKER'S COMPENSATION COVERAGE IS UNLAWFUL AND SHALL SUBJECT AN EMPLOYER TO CRIMINAL PENALTIES AND CIVIL FINES UP TO ONE HUNDRED THOUSAND DOLLARS (\$100,000) IN ADDITION TO THE COST OF COMPENSATION, DAMAGES AS PROVIDED FOR IN SECTION 3706 OF THE LABOR CODE, INTEREST AND ATTORNEY'S FEE.

THIS PERMIT SHALL EXPIRE BY LIMITATION IF WORK IS NOT COMMENCED WITHIN 180 DAYS.

RESIDENTIAL SUBDIVISION BUILDING PERMIT APPLICATION

Project Address: 501 Eastbrook ^{WY} Circle Assessor Parcel # 201-0870-0605
Lot Number: 65 Subdivision NORTHBOROUGH VILLAGE 3-1

OWNER INFORMATION:

Legal Property Owner: US HOME Phone# 858-3900
Owner Address: 366 GOLD MEADOW WAY City GOLD RIVER State CA Zip 95670

CONTRACTOR INFORMATION:

Contractor: US HOME Lic. # 451839 Phone # 858-3900 Fax 858-3925
DON McCLOSKEY 719-9050

PROJECT INFORMATION:

Land Use Zone RIA Occupancy Group R3 Construction Type VN Fed Code 1A
No. of Stories: 2 No. of Rooms: _____ Street Width: _____
1st Floor Area 1329 2nd Floor Area 1237 Basement _____ Roof Material _____

AREA IN SQUARE FOOT OF:

Dwelling/Living 2566
Garage/Storage 445
Decks/Balconies 33
Carports _____

CITY OF SACRAMENTO
PERMIT ASSISTANCE
FEB 02 2001
RECEIVED

SCOPE OF WORK: _____

- FOR OFFICE USE ONLY
- Information Above Complete
 - Violation Files Checked
 - Standard Setbacks
 - County Sewer
 - AR Flood Waiver Required
 - Flood Elevation Certificate Required
 - Water Development Infill Area
 - Planning Approval
 - Design Review Approval
 - Special Fee Districts Apply:
- THE FOLLOWING MUST BE PROVIDED IN ORDER TO SUBMIT FOR PERMIT**
- 2 COMPLETE PLOT PLANS, LEGIBLE & DRAWN TO SCALE
 - 11 X 17 COPY OF FLOOR PLAN WITH FOLLOWING INFORMATION
 - a) Assessor's Parcel Number
 - b) New Floor Area
 - c) Owners Name
 - d) Project Address

Date: _____ Received by: (staff) _____ Permit # _____



WesPac

insulation
a MASCO Company

809 North Market Blvd., Ste. 11 • Sacramento, CA 95834
(916) 927-7149 • Fax (916) 927-4257
Lic. #487478



Installed Insulation Certificate

We certify that the building insulation listed herein is installed in conformance with current energy conservation regulations, California Administrative Code, Title 24, State of California

R FACTOR	AREA	TYPE	INCHES/BAGS (BLOWN)
R38	CEILING	FIBERGLASS BLOW	14.75" / 25 BAGS
R38	CEILING	FIBERGLASS BATTIS	13"
R19	2X6 EXT. WALLS	FIBERGLASS BATTIS	6.5"
R13	2X4 EXT. WALLS	FIBERGLASS BATTIS	3.5"

US HOMES CORP.

Certified by

Title Secretary

NATOMAS TRADITIONS 65

USHC NATOMAS TRADITION/65
Address or Lot Number

Date Installed 07/20/01 Phase #

Jan 10 01 01:28p

Murray Smith & Associates

Lot Area = 5,748 sf
Building Footprint = 2,021 sf
Gross Coverage = 35.2%
Porch Allowance = 54 sf
Net Coverage = 34.2%

APN:

201-037-065

Address:

561 Eastbrook Circle

Owner:

Plan:

2546 R

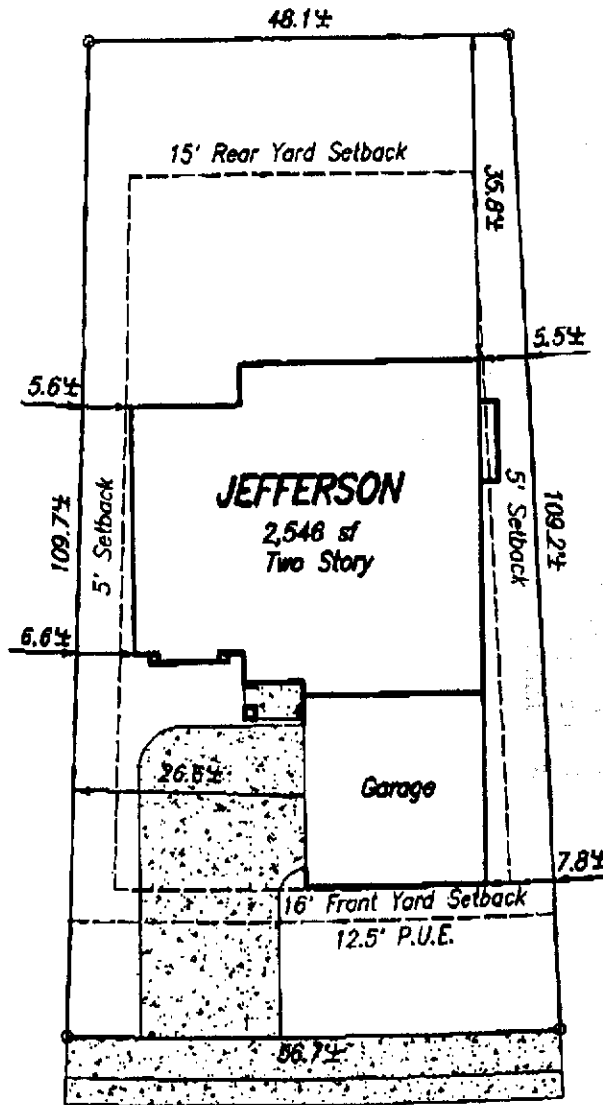

Eastbrook Circle

**Plot Plan for Lot 65 for Northborough Village 3-1
U.S.Home - Northborough - Traditions Series
City of Sacramento**

Notes:

This plot plan has been prepared for the purpose of showing the building foundation relationship to the property line, proposed drainage elevations and direction of flow to conform to local ordinances and for the purpose of building permit issuance. Information shown is approximate except for those setbacks which are minimums required by ordinance. This plot does not reflect as-built conditions which will likely vary from this plan.

**Murray Smith & Associates
Engineering, Inc.**
3110 Gold Canal Drive
Rancho Cordova, CA 95670
Ph.: (916) 635-1511

January 10, 2001

PN: 99003