

**CITY OF SACRAMENTO**  
1231 I Street, Sacramento, CA 95814

**Permit No: 0214889**  
**Insp Area: 4**  
**Thos Bros: 257C3**

**Site Address: 1597 ALICIA WY SAC**  
**Parcel No: NORTHPOINTE PARK 26 LOT 58**

**Sub-Type: NSFR**  
**Housing (Y/N): N**

CONTRACTOR  
BEAZER HOMES  
3009 DOUGLAS BL #150  
ROSEVILLE CA 95661

OWNER

ARCHITECT

**Nature of Work: MP1524 1 STORY 8 ROOM SFR**

**CONSTRUCTION LENDING AGENCY :** I hereby affirm under penalty of perjury that there is a construction lending agency for the performance of the work for which this permit is issued (Sec. 3097, Civ. C).

Lender's Name \_\_\_\_\_ Lender's Address \_\_\_\_\_

**LICENSED CONTRACTORS DECLARATION:** I hereby affirm under penalty of perjury that I am licensed under provisions of Chapter 9 (commencing with section 7000) of Division 3 of the Business and Professions Code and my license is in full force and effect.

License Class B License Number 724191 Date 10/23/02 Contractor Signature Sheuyf Van Maeren

**OWNER-BUILDER DECLARATION:** I hereby affirm under penalty of perjury that I am exempt from the contractors License Law for the following reason (Sec. 7031.5, Business and Professions Code; any city or county which requires a permit to construct, alter, improve, demolish, or repair any structure, prior to its issuance, also requires the applicant for such permit to file a signed statement that he or she is licensed pursuant to the provisions of the Contractors License Law (Chapter 9 (commencing with Section 7000) of Division 8 of the Business and Professions Code) or that he or she is exempt therefrom and the basis for the alleged exemption. Any violation of Section 7031.5 by any applicant for a permit subjects the applicant to a civil penalty of not more than five hundred dollars (\$500.00);

I, as a owner of the property, or my employees with wages as their sole compensation, will do the work, and the structure is not intended or offered for sale (Sec. 7044, Business and Professional Code: The Contractors License Law does not apply to an owner of property who builds or improves thereon, and who does such work himself or herself or through his/her own employees, provided that such improvements are not intended or offered for sale. If, however, the building or improvement is sold within one year of completion, the owner-builder will have the burden of proving that he/she did not build or improve for the purpose of sale.)

I, as owner of the property, am exclusively contracting with licensed contractors to construct the project (Sec. 7044, Business, and Professions Code: The Contractors License Law does not apply to an owner of property who builds or improves thereon, and who contracts for such projects with a contractor(s) licensed pursuant to the Contractors License Law).

I am exempt under Sec. \_\_\_\_\_ B & PC for this reason: \_\_\_\_\_  
Date \_\_\_\_\_ Owner Signature \_\_\_\_\_

**IN ISSUING THIS BUILDING PERMIT,** the applicant represents, and the city relies on the representation of the applicant, that the applicant verified all measurements and locations shown on the application or accompanying drawings and that the improvement to be constructed does not violate any law or private agreement relating to permissible or prohibited locations for such improvements. This building permit does not authorize any illegal location of any improvement or the violation of any private agreement relating to location of improvements.

I certify that I have read this application and state that all information is correct. I agree to comply with all city and county ordinances and state laws relating to building construction and herby authorize representative(s) of this city to enter upon the above mentioned property for inspection purposes.  
Date 10/23/02 Applicant/Agent Signature Sheuyf Van Maeren

**WORKER'S COMPENSATION DECLARATION:** I hereby affirm under penalty of perjury one of the following declarations:  
I have and will maintain a certificate of consent to self-insure for workers' compensation as provided for by Section 3700 of the Labor Code, for the performance of work for which the permit is issued.

I have and will maintain workers' compensation insurance, as required by Section 3700 of the Labor Code, for the performance of the work for which this permit is issued. My workers' compensation insurance carrier and policy number are:  
Carrier LIBERTY MUTUAL INS CO. Policy Number WA2-65D-004147-082 Exp Date 04/01/2003

(This section need not be completed if the permit is for \$100 or less) I certify that in the performance of the work for which this permit is issued, I shall not employ any person in any manner so as to become subject to the workers' compensation laws of California and agree that if I should become subject to the workers' compensation provisions of Section 3700 of the Labor Code, I shall forthwith comply with those provisions.  
Date 10/23/02 Applicant Signature Sheuyf Van Maeren

**WARNING: FAILURE TO SECURE WORKER'S COMPENSATION COVERAGE IS UNLAWFUL AND SHALL SUBJECT AN EMPLOYER TO CRIMINAL PENALTIES AND CIVIL FINES UP TO ONE HUNDRED THOUSAND DOLLARS (\$100,000) IN ADDITION TO THE COST OF COMPENSATION, DAMAGES AS PROVIDED FOR IN SECTION 3706 OF THE LABOR CODE, INTEREST AND ATTORNEY'S FEE.**

**THIS PERMIT SHALL EXPIRE BY LIMITATION IF WORK IS NOT COMMENCED WITHIN 180 DAYS.**

## RESIDENTIAL BUILDING PERMIT APPLICATION

New Construction     
  Addition     
  Remodels     
  Other

Project Address: Lot 58 1597 Azalia Way      Assessor Parcel # 201-0320-022 & 023

OWNER INFORMATION: Northpointe Park Village 26

Legal Property Owner: Beazer Homes Holdings Corp.      Phone # 916-773-3888  
 Owner Address: 3009 Douglas Blvd. 150      City Roseville      State CA      Zip 95661

**CONTRACTOR INFORMATION:**

Contractor: Same as above      Lic. # B724191      Phone # 773-3888      Fax # 773-0425

**PROJECT INFORMATION:**

Land Use Zone \_\_\_\_\_      Occupancy Group \_\_\_\_\_      Construction Type \_\_\_\_\_      Fed Code \_\_\_\_\_  
 No. of stories: 1      No. of rooms: \_\_\_\_\_      Street width: \_\_\_\_\_  
 1<sup>st</sup> Floor Area 1524      2<sup>nd</sup> Floor Area \_\_\_\_\_      Basement \_\_\_\_\_      Roof Material \_\_\_\_\_

AREA IN SQUARE FOOT OF:	EXISTING	NEW
Dwelling/Living	_____	1524
Garage/Storage	_____	413
Decks/Balconies	_____	_____
Carports	_____	_____

SCOPE OF WORK: Single Family Homes

**FOR OFFICE USE ONLY**

- |   |   |  |
|---|---|--|
| <input type="checkbox"/> Information above complete | <input type="checkbox"/> AR Flood Waiver required             | <input type="checkbox"/> Planning Approval                   |
| <input type="checkbox"/> Violation files checked    | <input type="checkbox"/> Flood Elevation Certificate Required | <input type="checkbox"/> Design Review Approval              |
| <input type="checkbox"/> Standard setbacks          | <input type="checkbox"/> Water Development Infill Area        | <input type="checkbox"/> Special Fee Districts Apply : _____ |
| <input type="checkbox"/> County Sewer               |   |  |

**NEW STRUCTURES & ADDITIONS**

❖ THE FOLLOWING MUST BE PROVIDED IN ORDER TO SUBMIT FOR PLAN REVIEW

- |  |  |
|--|--|
| <input type="checkbox"/> <b>2 COMPLETE PLANS, LEGIBLE &amp; DRAWN TO SCALE</b><br><input type="checkbox"/> <b>3 SETS IF PROJECT IS IN A DESIGN REVIEW AREA</b> | ❖ <i>Plans to include: site plan, floor plan, elevations, roof/ceiling plan, foundation and structural framing details, and structural calculations for non-conforming structures.</i> |
| <input type="checkbox"/> Title 24 Energy Compliance documentation<br><input type="checkbox"/> Grading and Erosion Control Questionnaire                        | <input type="checkbox"/> 11" x 17" copy of floor plan for County Assessor<br><input type="checkbox"/> Plan Review Fees   |

Date: \_\_\_\_\_ Received by: (staff) \_\_\_\_\_

ACTIVITY/PERMIT # \_\_\_\_\_

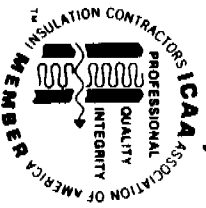

**INSULATION CONTRACTORS  
ASSOCIATION  
OF AMERICA**

INSULATION  
CERTIFICATE  
42169

1321 DUKE STREET, SUITE 303 • ALEXANDRIA, VA 22314 • (703) 739-0356

THIS IS TO CERTIFY THAT INSULATION HAS BEEN INSTALLED IN CONFORMANCE WITH CURRENT ENERGY REGULATIONS, CALIFORNIA ADMINISTRATIVE CODE TITLE 24, STATE OF CALIFORNIA, IN THE BUILDING LOCATED AT:

Dever Thomas LOT # 6058 TRACT # Paridene  
STREET 1597 Alicia Way CITY Napa

**EXTERIOR WALLS:**

MANUFACTURER F/Es THICKNESS/TYPE 3 5/8" R-VALUE 13

**CEILINGS:**

BATTS: MANUFACTURER F/Es THICKNESS/TYPE 10" R-VALUE 30

BLOWN IN: MANUFACTURER Wesday MINIMUM THICKNESS 12" R-VALUE 30

SQUARE FOOTAGE COVERED 1400 NUMBER OF BAGS USED 25

FLOORS: MANUFACTURER \_\_\_\_\_ THICKNESS/TYPE \_\_\_\_\_ R-VALUE \_\_\_\_\_

SLAB ON GRADE: MANUFACTURER \_\_\_\_\_ THICKNESS/TYPE \_\_\_\_\_ R-VALUE \_\_\_\_\_

WIDTH OF INSULATION \_\_\_\_\_ INCHES

FOUNDATION WALLS: MANUFACTURER \_\_\_\_\_ THICKNESS/TYPE \_\_\_\_\_ R-VALUE \_\_\_\_\_

GENERAL CONTRACTOR \_\_\_\_\_ DATE \_\_\_\_\_  
CALIFORNIA CONTRACTORS LICENSE # \_\_\_\_\_

SIGNATURE \_\_\_\_\_ TITLE \_\_\_\_\_

**INSULATION CONTRACTOR ARCADE INSULATION**

CALIFORNIA CONTRACTORS LICENSE #815286  
NEWBORN CONTRACTORS LICENSE #55201

[Signature] DATE \_\_\_\_\_  
SIGNATURE TITLE

6058

# OMEGA PRODUCTS INTERNATIONAL, INC.

DIAMOND WALL INSULATING STUCCO SYSTEM

JOB ADDRESS

ICBO Report #4004

BENTON PROLVENCE

Date of Job Completion

1/13/03

PLASTERING CONTRACTOR

Name: Stucco Works INC

Address: 500 WAREHOUSE SHERWOOD C.A. 95826

Telephone No: 925 383 6699

Contractor Number of Diamond Wall System 2175

This is to certify that the exterior coating system on the building exterior at the above address has been installed in accordance with the evaluation report specified above and the manufacturer's instructions.

Date 3/1/03

Signature of authorized representative of Plastering Contractor

This installation can't be presented to the building inspector after completion of work and before final inspection.

1597

Alicia

WAT

**THIS PLOT PLAN IS NOT FOR SALES PURPOSES. THIS PLOT PLAN IS FOR THE PURPOSES OF INDICATING COMPLIANCE WITH ZONING SET BACKS, GENERAL DRAINAGE DIRECTION, AND APPROXIMATE UTILITY CONNECTION. ALL OTHER DATA SHOWN HEREON IS CONCEPTUAL. THIS PLOT PLAN DOES NOT REFLECT AS-BUILT CONDITION, RETAINING WALL ARE OPTIONAL AND MAY OR MAY NOT BE CONSTRUCTED.**

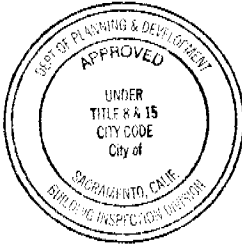

This set of plans and specifications must be kept on the job at all times and it is unlawful to make any changes or alterations from the same without written permission from the Building Inspection Division.

The approval of this plan and specification SHALL NOT be held to permit 45.50' have the violation of any City Ordinance or state law.

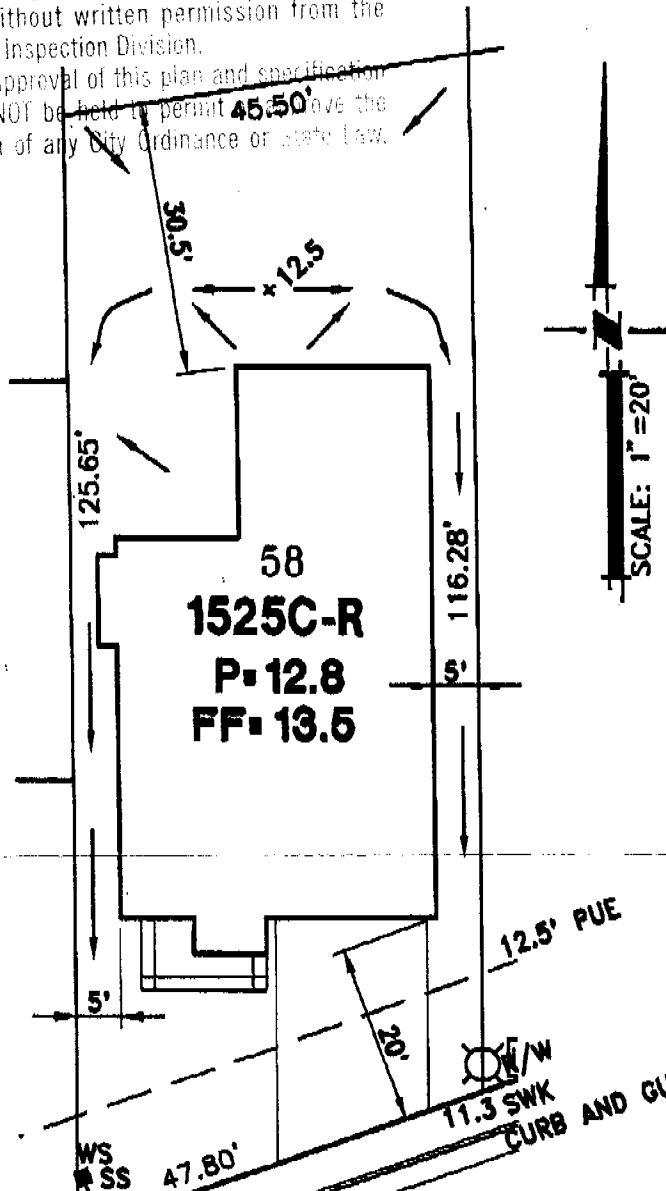

ROUTING/APPROVAL		INITIALS
President	✓	
Project Development		
Construction		
Marketing	✓	<i>al</i>
Admin.		
Accounting		

**ALICIA WAY**

- LEGEND**
- STREET LIGHT
  - TRANSFORMER
  - UTILITY BOX
  - FIRE HYDRANT

**PLOT PLAN**  
**LOT 58**  
**PROVIDENCE**  
**AT REGENCY PARK VILLAGE 26**  
**FOR**  
**BEAZER HOMES**  
CITY OF SACRAMENTO CALIFORNIA

**WOOD RODGERS**  
ENGINEERING • PLANNING • MAPPING • SURVEYING  
8881 P STREET, BLDG. 100-B, SACRAMENTO, CA 95816  
PHONE: (916) 341-7740 FAX: (916) 341-7747

DATE:	DRAWN:	CHECKED:	PROJECT NO:
OCT '02	DZR	<i>[Signature]</i>	1045.069

File: J:\JOBS\NORTHPOINTE PHASE 2\VILLAGE 26\DWGS\CIVIL\LOT PLANS\58.DWG Last edited: 10/07/02 @ 2:12 p.m. by: didier