

CITY OF SACRAMENTO  
1231 I Street, Sacramento, CA 95814

Permit No: 0012898

Insp Area: 4

Site Address: 1763 IVERSON WY SAC  
Parcel No: 225-1090-045 NORTHPT PK 4 LOT 45

Sub-Type: NSFR  
Housing (Y/N): N

CONTRACTOR  
JOHN LAING HOMES  
1536 EUREKA RD STE 100  
ROSEVILLE CA 95661

OWNER

ARCHITECT

Nature of Work: NSFR MP2401 2 STORY 10 RMS

**CONSTRUCTION LENDING AGENCY :** I hereby affirm under penalty of perjury that there is a construction lending agency for the performance of the work for which this permit is issued (Sec. 3097, Civ. C).

Lender's Name \_\_\_\_\_ Lender's Address \_\_\_\_\_

**LICENSED CONTRACTORS DECLARATION:** I hereby affirm under penalty of perjury that I am licensed under provisions of Chapter 9 (commencing with section 7000) of Division 3 of the Business and Professions Code and my license is in full force and effect.

License Class B License Number 687596 Date 11/3/00 Contractor Signature N. Collins

**OWNER-BUILDER DECLARATION:** I hereby affirm under penalty of perjury that I am exempt from the contractors License Law for the following reason (Sec. 7031.5, Business and Professions Code; any city or county which requires a permit to construct, alter, improve, demolish, or repair any structure, prior to its issuance, also requires the applicant for such permit to file a signed statement that he or she is licensed pursuant to the provisions of the Contractors License Law (Chapter 9 (commencing with Section 7000) of Division 8 of the Business and Professions Code) or that he or she is exempt therefrom and the basis for the alleged exemption. Any violation of Section 7031.5 by any applicant for a permit subjects the applicant to a civil penalty of not more than five hundred dollars (\$500.00):

I, as a owner of the property, or my employees with wages as their sole compensation, will do the work, and the structure is not intended or offered for sale (Sec. 7044, Business and Professional Code: The Contractors License Law does not apply to an owner of property who builds or improves thereon, and who does such work himself or herself or through his/her own employees, provided that such improvements are not intended or offered for sale. If, however, the building or improvement is sold within one year of completion, the owner-builder will have the burden of proving that he/she did not build or improve for the purpose of sale.)

I, as owner of the property, am exclusively contracting with licensed contractors to construct the project (Sec. 7044, Business and Professions Code: The Contractors License Law does not apply to an owner of property who builds or improves thereon, and who contracts for such projects with a contractor(s) licensed pursuant to the Contractors License Law).

I am exempt under Sec. \_\_\_\_\_ B & PC for this reason: \_\_\_\_\_  
Date \_\_\_\_\_ Owner Signature \_\_\_\_\_

**IN ISSUING THIS BUILDING PERMIT,** the applicant represents, and the city relies on the representation of the applicant verified all measurements and locations shown on the application or accompanying drawings and that the improvement to be constructed does not violate any law or private agreement relating to permissible or prohibited locations for such improvements. This building permit does not authorize any illegal location of any improvement or the violation of any private agreement relating to location of improvements.

I certify that I have read this application and state that all information is correct. I agree to comply with all city and county ordinances and state laws relating to building construction and hereby authorize representative(s) of this city to enter upon the above mentioned property for inspection purposes.

Date 11/3/00 Applicant/Agent Signature N. Collins

**WORKER'S COMPENSATION DECLARATION:** I hereby affirm under penalty of perjury one of the following declarations:  
I have and will maintain a certificate of consent to self-insure for workers' compensation as provided for by Section 3700 of the Labor Code, for the performance of work for which the permit is issued.

I have and will maintain workers' compensation insurance, as required by Section 3700 of the Labor Code, for the performance of the work for which this permit is issued. My workers' compensation insurance carrier and policy number are:

Carrier EAGLE PACIFIC INSURANCE COMPAN Policy Number 1S0002200 Exp Date 4/15/2001

(This section need not be completed if the permit is for \$100 or less) I certify that in the performance of the work for which this permit is issued, I shall not employ any person in any manner so as to become subject to the workers' compensation laws of California and agree that if I should become subject to the workers' compensation provisions of Section 3700 of the Labor Code, I shall forthwith comply with those provisions.

Date 11/3/00 Applicant Signature N. Collins

WARNING: FAILURE TO SECURE WORKER'S COMPENSATION COVERAGE IS UNLAWFUL AND SHALL SUBJECT AN EMPLOYER TO CRIMINAL PENALTIES AND CIVIL FINES UP TO ONE HUNDRED THOUSAND DOLLARS (\$100,000) IN ADDITION TO THE COST OF COMPENSATION, DAMAGES AS PROVIDED FOR IN SECTION 3706 OF THE LABOR CODE, INTEREST AND ATTORNEY'S FEE.

**THIS PERMIT SHALL EXPIRE BY LIMITATION IF WORK IS NOT COMMENCED WITHIN 180 DAYS.**

**RESIDENTIAL BUILDING PERMIT APPLICATION**

New Construction       Addition       Remodels       Other

Project Address: 1963 E. Jackson Way      Assessor Parcel # 225-1090-645

**OWNER INFORMATION:** Lot 45  
 Legal Property Owner: John Laing Homes      Phone # 780-1222  
 Owner Address: 1536 Eureka Rd. #100,      City Roseville,      State Ca.      Zip 95661

**CONTRACTOR INFORMATION:** Northpointe Park Unit #4  
 Contractor: John Laing Homes Lic. # 687596      Phone # 780-1222      Fax# 780-1333

**PROJECT INFORMATION:**  
 Land Use Zone \_\_\_\_\_      Occupancy Group \_\_\_\_\_      Construction Type VN      Fed Code A1  
 No. of stories: 2      No. of rooms: 16      Street width: \_\_\_\_\_  
 1<sup>st</sup> Floor Area \_\_\_\_\_      2<sup>nd</sup> Floor Area \_\_\_\_\_      Basement \_\_\_\_\_      Roof Material \_\_\_\_\_

<b>AREA IN SQUARE FOOT OF:</b>	<b>EXISTING</b>	<b>NEW</b>
Dwelling/Living	_____	<u>2401</u>
Garage/Storage	_____	<u>669</u>
Decks/Balconies	_____	<u>94</u>
Carports	_____	_____

**SCOPE OF WORK:** \_\_\_\_\_

**FOR OFFICE USE ONLY:**

- |   |   |  |
|---|---|--|
| <input type="checkbox"/> Information above complete | <input type="checkbox"/> AR Flood Waiver required             | <input type="checkbox"/> Planning Approval                   |
| <input type="checkbox"/> Violation files checked    | <input type="checkbox"/> Flood Elevation Certificate Required | <input type="checkbox"/> Design Review Approval              |
| <input type="checkbox"/> Standard setbacks          | <input type="checkbox"/> Water Development Infill Area        | <input type="checkbox"/> Special Fee Districts Apply : _____ |
| <input type="checkbox"/> County Sewer               |   |  |

**- NEW STRUCTURES & ADDITIONS**

❖ THE FOLLOWING MUST BE PROVIDED IN ORDER TO SUBMIT FOR PLAN REVIEW

- |   |   |
|---|---|
| <input type="checkbox"/> 2 COMPLETE PLANS, LEGIBLE & DRAWN TO SCALE   | ❖ Plans to include: site plan, floor plan, elevations, roof/ceiling plan, foundation and structural framing details, and structural calculations for non-conforming structures. |
| <input type="checkbox"/> 3 SETS IF PROJECT IS IN A DESIGN REVIEW AREA |   |
| <input type="checkbox"/> Title 24 Energy Compliance documentation     | <input type="checkbox"/> 11" x 17" copy of floor plan for County Assessor   |
| <input type="checkbox"/> Grading and Erosion Control Questionnaire    | <input type="checkbox"/> Plan Review Fees   |

Date \_\_\_\_\_ Received by: (staff) \_\_\_\_\_

**ACTIVITY/PERMIT #**

**INSULATION CERTIFICATE**

**THIS IS TO CERTIFY THAT INSULATION HAS BEEN INSTALLED IN CONFORMANCE WITH THE CURRENT ENERGY REGULATIONS, CALIFORNIA ADMINISTRATION CODE, TITLE 24, STATE OF CALIFORNIA, IN THE BUILDING LOCATED AT:**

**SITE ADDRESS:** LOT 45 PAGEANTRY SACRAMENTO, CA  
NUMBER STREET CITY STATE

**CEILING:**

<b>BLOW:</b>	<b>MANUFACTURER</b>	<u>GREENSTONE</u>	<b>THICKNESS</b>	<u>8.1"</u>	<b>R/VALUE</b>	<u>30</u>
	<b>SQUARE FEET</b>	<u>1117</u>	<b># BAGS/LBS</b>	<u>PER BAGS</u>		<u>33</u>
<b>BATTS:</b>	<b>MANUFACTURER</b>	<u>JOHNS MANVILLE</u>	<b>THICKNESS</b>	<u>10.25"</u>	<b>R/VALUE</b>	<u>30</u>
		<u>JOHNS MANVILLE</u>		<u>6.5"</u>		<u>19</u>

**EXTERIOR WALLS:**

<b>MANUFACTURER</b>	<u>JOHNS MANVILLE</u>	<b>THICKNESS</b>	<u>3.5"</u>	<b>R/VALUE</b>	<u>13</u>
	<u>JOHNS MANVILLE</u>				

**FLOOR INSULATION:**

<b>MANUFACTURER</b>	<u>JOHNS MANVILLE</u>	<b>THICKNESS</b>	<u>3.5"</u>	<b>R/VALUE</b>	<u>13</u>
---------------------	-----------------------	------------------	-------------	----------------	-----------

**AIR INFILTRATION:** (TITLE 24)

YES  NO

**OTHER:**

**GENERAL CONTRACTOR:** JOHN LAING HOMES **LICENSE#** \_\_\_\_\_

**BY:** \_\_\_\_\_ **TITLE:** \_\_\_\_\_ **DATE** \_\_\_\_\_

**INSULATION CONTRACTOR:** WESTERN INSULATION, INC. **LICENSE** 481278

**BY:** TAWNYA PEIRCE **TITLE:** AUTH. AGENT **DATE** 5/14/01

INSULATION CERTIFICATE

THIS IS TO CERTIFY THAT INSULATION HAS BEEN INSTALLED IN CONFORMANCE WITH THE CURRENT ENERGY REGULATIONS, CALIFORNIA ADMINISTRATION CODE, TITLE 24, STATE OF CALIFORNIA, IN THE BUILDING LOCATED AT:

SITE ADDRESS: LOT 45 PAGEENTRY SACRAMENTO, CA
NUMBER STREET CITY STATE

CEILINGS:

BLOW: MANUFACTURER GREENSTONE THICKNESS 8.1" R/VALUE 30
SQUARE FEET 1117 # BAGS/LBS PER BAGS 33
BATTS: MANUFACTURER JOHNS MANVILLE THICKNESS 10.25" R/VALUE 30
JOHNS MANVILLE 6.5" 19

EXYERIOR WALLS:

MANUFACTURER JOHNS MANVILLE THICKNESS 3.5" R/VALUE 13
JOHNS MANVILLE

FLOOR INSULATION:

MANUFACTURER JOHNS MANVILLE THICKNESS 3.5" R/VALUE 13

AIR INFILTRATION: (TITLE 24)

YES XX NO

OTHER:

GENERAL CONTRACTOR: JOHN LAING HOMES LICENSE#

BY: TITLE: DATE

INSULATION CONTRACTOR: WESTERN INSULATION, INC. LICENSE 481278

BY: TAWNYA PEIRCE TITLE: AUTH. AGENT DATE 5/14/01

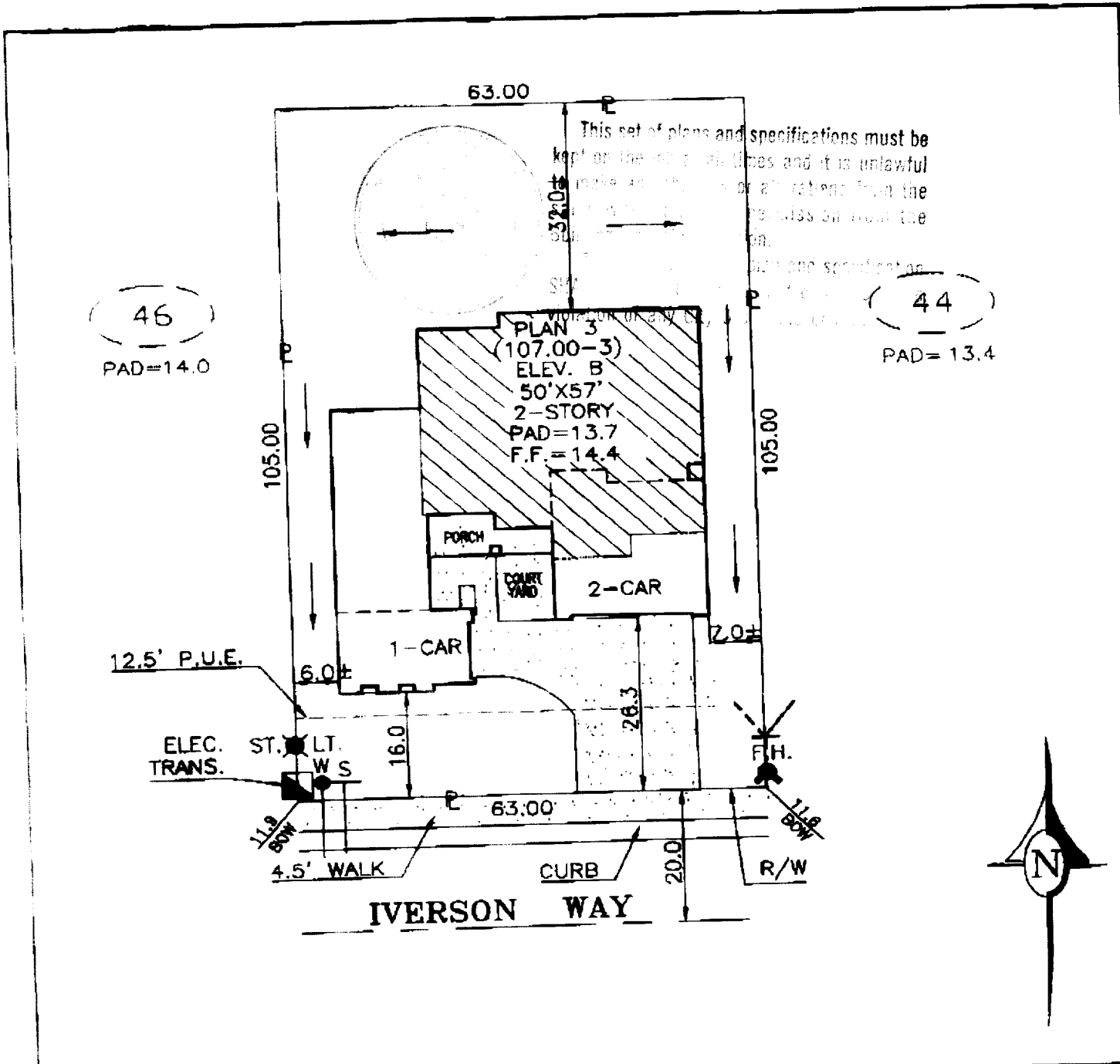

DIMENSIONS SHOWN ARE APPROXIMATE EXCEPT FOR MINIMUMS REQUIRED BY ORDINANCE. THIS PLOT DOES NOT REFLECT AS BUILT CONDITIONS AND MAY VARY FROM THIS PLAN.

<b>John Laing Homes</b> 1536 HUNTER ROAD SUITE 100 ROSEVILLE, CALIFORNIA 95661 (TEL.) 916-780-1222 (FAX.) 916-780-1333	<b>PAGEANTRY</b> NORTHPOINTE PARK UNIT 4 CITY OF SACRAMENTO CALIFORNIA		<b>PLOT PLAN</b> NOTES: CURVED LINES ARE CHORD MEASUREMENTS.
	ADDRESS: 1763 IVERSON WAY	LOT COV: 35.1 %	APN:225-109-045
PLAN NO.: 3-B	LOT SQ. FT.: 6,615	REAR YARD COVERAGE: %	
DRAWN BY: R.P.	APPROVED BY:	DATE: 10/31/00 SCALE: 1"=20'	