

CITY OF SACRAMENTO
1231 I Street, Sacramento, CA 95814

Permit No: 0105667
Insp Area: 4

Site Address: 1924 KANE AV SAC
Parcel No: 225-1490-087
N

NORTHPOINTE PARK VIL. 10 LOT 87

Sub-Type: NSFR
Housing (Y/N):

CONTRACTOR
WILLIAM LYON HOMES
9216 KIEFFER BL
SAC CA 95827

OWNER

ARCHITECT

Nature of Work: MP 2401 2 STORY 10 ROOM SFR

CONSTRUCTION LENDING AGENCY : I hereby affirm under penalty of perjury that there is a construction lending agency for the performance of the work for which this permit is issued (Sec. 3097, Civ. C)

Lender's Name _____ Lender's Address _____

LICENSED CONTRACTORS DECLARATION: I hereby affirm under penalty of perjury that I am licensed under provisions of Chapter 9 (commencing with section 7000) of Division 3 of the Business and Professions Code and my license is in full force and effect.

License Class B License Number 100155 Date 5/11/01 Contractor Signature Kellee Adams

OWNER-BUILDER DECLARATION: I hereby affirm under penalty of perjury that I am exempt from the contractors License Law for the following reason (Sec. 7031.5, Business and Professions Code: any city or county which requires a permit to construct, alter, improve, demolish, or repair any structure, prior to its issuance, also requires the applicant for such permit to file a signed statement that he or she is licensed pursuant to the provisions of the Contractors License Law (Chapter 9 (commencing with Section 7000) of Division 3 of the Business and Professions Code) or that he or she is exempt therefrom and the basis for the alleged exemption. Any violation of Section 7031.5 by any applicant for a permit subjects the applicant to a civil penalty of not more than five hundred dollars (\$500.00);

_____, I, as a owner of the property, or my employees with wages as their sole compensation, will do the work, and the structure is not intended or offered for sale (Sec. 7044, Business and Professional Code: The Contractors License Law does not apply to an owner of property who builds or improves thereon, and who does such work himself or herself or through his/her own employees, provided that such improvements are not intended or offered for sale. If, however, the building or improvement is sold within one year of completion, the owner-builder will have the burden of proving that he/she did not build or improve for the purpose of sale.)

_____, I, as owner of the property, am exclusively contracting with licensed contractors to construct the project (Sec. 7044, Business and Professions Code: The Contractors License Law does not apply to an owner of property who builds or improves thereon, and who contracts for such projects with a contractor(s) licensed pursuant to the Contractors License Law)

_____, I am exempt under Sec. _____ B & PC for this reason: _____

Date _____ Owner Signature _____

IN ISSUING THIS BUILDING PERMIT, the applicant represents, and the city relies on the representation of the applicant, that the applicant verified all measurements and locations shown on the application or accompanying drawings and that the improvement to be constructed does not violate any law or private agreement relating to permissible or prohibited locations for such improvements. This building permit does not authorize any illegal location of any improvement or the violation of any private agreement relating to location of improvements.

I certify that I have read this application and state that all information is correct. I agree to comply with all city and county ordinances and state laws relating to building construction and hereby authorize representative(s) of this city to enter upon the above mentioned property for inspection purposes.

Date 5/11/01 Applicant/Agent Signature Kellee Adams

WORKER'S COMPENSATION DECLARATION: I hereby affirm under penalty of perjury one of the following declarations:

_____, I have and will maintain a certificate of consent to self-insure for workers' compensation as provided for by Section 3700 of the Labor Code, for the performance of work for which the permit is issued

CA I have and will maintain workers' compensation insurance, as required by Section 3700 of the Labor Code, for the performance of the work for which this permit is issued. My workers' compensation insurance carrier and policy number are:

Carrier EAGLE PACIFIC Policy Number 4S0000285 Exp Date 07/01/2001

_____, (This section need not be completed if the permit is for \$100 or less) I certify that in the performance of the work for which this permit is issued, I shall not employ any person in any manner so as to become subject to the workers' compensation laws of California and agree that if I should become subject to the workers' compensation provisions of Section 3700 of the Labor Code, I shall thereupon comply with those provisions.

Date 5/11/01 Applicant Signature Kellee Adams

WARNING: FAILURE TO SECURE WORKER'S COMPENSATION COVERAGE IS UNLAWFUL AND SHALL SUBJECT AN EMPLOYER TO CRIMINAL PENALTIES AND CIVIL FINES UP TO ONE HUNDRED THOUSAND DOLLARS (\$100,000) IN ADDITION TO THE COST OF COMPENSATION, DAMAGES AS PROVIDED FOR IN SECTION 3706 OF THE LABOR CODE, INTEREST AND ATTORNEY'S FEE.

THIS PERMIT SHALL EXPIRE BY LIMITATION IF WORK IS NOT COMMENCED WITHIN 180 DAYS.

RESIDENTIAL SUBDIVISION BUILDING PERMIT APPLICATION

Project Address: 1924 Kane Avenue Assessor Parcel # 225-1490-087
Lot Number: 87 Plan 2C Subdivision Lyon Palazzo

OWNER INFORMATION:

Legal Property Owner: William Lyon Homes, Inc. Phone# (925) 543-5500
Owner Address: 2603 Camino Ramon #150 City San Ramon State CA Zip 94583

CONTRACTOR INFORMATION:

Contractor: William Lyon Homes Inc Lic. # 661158 Phone # (925) 543-5500 Fax 543-5501

PROJECT INFORMATION:

Land Use Zone R1A Occupancy Group R3 Construction Type VN Fed Code 1A

No. of Stories: 2 No. of Rooms: 12 Street Width: 40'

1st Floor Area 1,369 2nd Floor Area 1,032 Basement 0 Roof Material Conc. Tile

AREA IN SQUARE FOOT OF:

Dwelling/Living	<u>2,401</u>
Garage/Storage	<u>746</u>
Decks/Balconies	<u>0</u>
Carpports	<u>0</u>

SCOPE OF WORK: Construction of a Single Family Dwelling

- Information Above Complete AR Flood Waiver Required Planning Approval
 Violation Files Checked Flood Elevation Certificate Required Design Review Approval
 Standard Setbacks Water Development Infill Area Special Fee Districts Apply:
 County Sewer

~THE FOLLOWING MUST BE PROVIDED IN ORDER TO SUBMIT FOR PERMIT~

- 2 COMPLETE PLOT PLANS, LEGIBLE & DRAWN TO SCALE
 11 X 17 COPY OF FLOOR PLAN WITH FOLLOWING INFORMATION
a) Assessor's Parcel Number c) Owners Name
b) New Floor Area d) Project Address

CERTIFICATION OF INSULATION

PART I GENERAL

ADDRESS OR TRACT

SACRAMENTO INSULATION CONTRACTORS

WM. LYONS

LOT # 87

- P.O. BOX 854, WEST SACRAMENTO, CA 95691 LIC. #202028
- 1309 MELODY ROAD, MARYSVILLE, CA 95901 LIC. #202026
- P.O. BOX 9651, FRESNO, CA 93793-9651 LIC. #202026
- P.O. BOX 1631, RENO, NV 89505 LIC. #10675
- 3326 A PONDEROSA WAY, LAS VEGAS, NV 89118 LIC. #10675

PALAZZO

DATE INSULATION COMPLETED

PART II AREAS INSULATED

WALLS	CEILINGS	FLOORS				
(SQUARE FEET)	(SQUARE FEET)	(SQUARE FEET)				
TYPE OF INSULATION	TYPE OF INSULATION	TYPE OF INSULATION				
MATERIAL FIBERGLASS	MATERIAL FIBERGLASS	MATERIAL FIBERGLASS				
FORM BATTS	FORM BATTS & BLOW	FORM BATTS				
MANUFACTURER'S PRODUCT I.D.	MANUFACTURER'S PRODUCT I.D.	MANUFACTURER'S PRODUCT I.D.				
MANUFACTURER	MANUFACTURER	MANUFACTURER				
OCF	OCF	OCF				
	BAGS					
R-VALUE INSTALLED	APPLIED THICKNESS	R-VALUE INSTALLED	APPLIED THICKNESS	MIN. INSTALLED WEIGHT PER SQUARE FOOT	R-VALUE INSTALLED	APPLIED THICKNESS
13	3 5/8"	30 30	9" 12"			

KNEE WALLS IF R-VALUE IS OTHER THAN WALLS ABOVE

MATERIAL	FORM	R VALUE	MANUFACTURER
FIBERGLASS	BATTS		OCF

AIR INFILTRATION SEALANT

MATERIAL	MANUFACTURER
FOAM	W R GRACE

I HEREBY CERTIFY THAT INSULATION AND/OR SEALANT HAS BEEN INSTALLED IN CONFORMANCE WITH APPLICABLE STANDARDS AND REGULATIONS.

SIGNATURE - INSULATION CONTRACTOR 	TITLE MANAGER	DATE 11-28-01
SIGNATURE - GENERAL CONTRACTOR	TITLE	DATE

REMARKS:

"For informational purposes only. This plot is intended to show the approximate house orientation and proposed lot drainage pattern. All setbacks, other than minimum code requirements, are approximate. This plot plan may not reflect the final "as built" conditions. Refer to final map, grading plans, improvement plans and title records for additional information that may affect this lot."

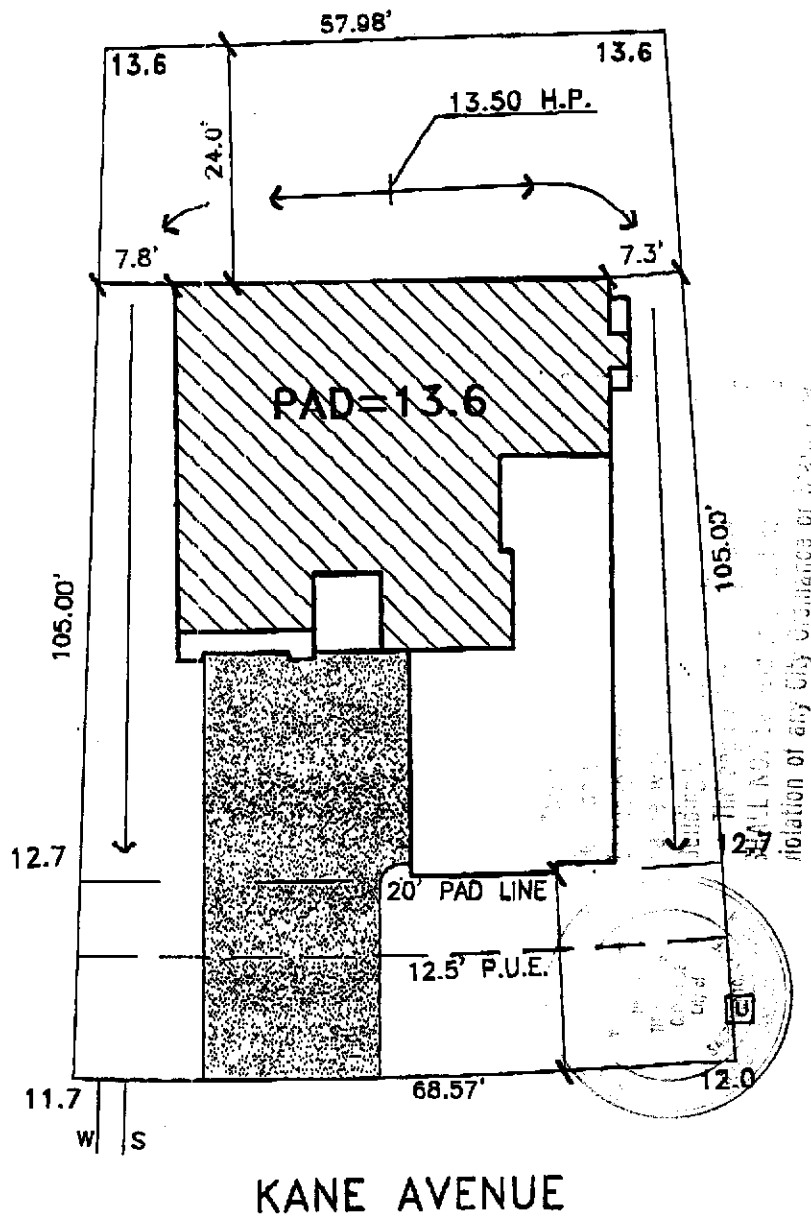

LOT 87
 PLAN 2C LEFT
 A.P.N.: 225-1490-087
 ADDRESS: 1924 KANE AVENUE
 LOT AREA: 6,675 SF
 LOT COVERAGE: 32%

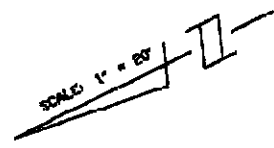

Stantec Consulting Inc.
 2390 Venture Oaks Way
 Sacramento, CA 95833-3288
 Tel. 916.925.5550
 Fax: 916.921.9274
 www.stantec.com

Stantec

WILLIAM LYON HOMES
 2603 Camino Ramon
 Suite 150
 San Ramon, Ca. 94583

office: (925) 543-5500
 fax: (925) 543-5501

NORTHPOINTE PARK
 UNIT NO. 10

City of Sacramento, California

Scale: 1"=20'

April 27, 2001