

CITY OF SACRAMENTO
1231 I Street, Sacramento, CA 95814

Permit No: 0008811
Insp Area: 4

Site Address: 5112 SEAGLENN WY SAC
Parcel No: 201-0350-022 NORTHBOROUGH VIL 5-1 LOT 22
N

Sub-Type: NSFR
Housing (Y/N):

CONTRACTOR
CENTEX HOMES
3900 DOUGLAS BLVD
SAC 95866

OWNER

ARCHITECT

Nature of Work: MP 2512B/OPT 2 STORY 10 ROOM SFR

CONSTRUCTION LENDING AGENCY : I hereby affirm under penalty of perjury that there is a construction lending agency for the performance of the work for which this permit is issued (Sec. 3097, Civ. C).

Lender's Name N/A Lender's Address _____

LICENSED CONTRACTORS DECLARATION: I hereby affirm under penalty of perjury that I am licensed under provisions of Chapter 9 (commencing with section 7000) of Division 3 of the Business and Professions Code and my license is in full force and effect.

License Class B License Number 734094 Date 8-23-00 Contractor Signature Debbie Stowers

OWNER-BUILDER DECLARATION: I hereby affirm under penalty of perjury that I am exempt from the contractors License Law for the following reason (Sec. 7031.5, Business and Professions Code; any city or county which requires a permit to construct, alter, improve, demolish, or repair any structure, prior to its issuance, also requires the applicant for such permit to file a signed statement that he or she is licensed pursuant to the provisions of the Contractors License Law (Chapter 9 (commencing with Section 7000) of Division 8 of the Business and Professions Code) or that he or she is exempt therefrom and the basis for the alleged exemption. Any violation of Section 7031.5 by any applicant for a permit subjects the applicant to a civil penalty of not more than five hundred dollars (\$500.00);

I, as a owner of the property, or my employees with wages as their sole compensation, will do the work, and the structure is not intended or offered for sale (Sec. 7044, Business and Professional Code: The Contractors License Law does not apply to an owner of property who builds or improves thereon, and who does such work himself or herself or through his/her own employees, provided that such improvements are not intended or offered for sale. If, however, the building or improvement is sold within one year of completion, the owner-builder will have the burden of proving that he/she did not build or improve for the purpose of sale.)

I, as owner of the property, am exclusively contracting with licensed contractors to construct the project (Sec. 7044, Business and Professions Code: The Contractors License Law does not apply to an owner of property who builds or improves thereon, and who contracts for such projects with a contractor(s) licensed pursuant to the Contractors License Law).

I am exempt under Sec. _____ B & PC for this reason: _____
Date _____ Owner Signature _____

PAID
CITY OF SACRAMENTO
AUG 23 2000
NEIGHBORHOODS, PLANNING
AND DEVELOPMENT SERVICES

IN ISSUING THIS BUILDING PERMIT, the applicant represents, and the city relies on the representation of the applicant, that the applicant verified all measurements and locations shown on the application or accompanying drawings and that the improvement to be constructed does not violate any law or private agreement relating to permissible or prohibited locations for such improvements. This building permit does not authorize any illegal location of any improvement or the violation of any private agreement relating to location of improvements.

I certify that I have read this application and state that all information is correct. I agree to comply with all city and county ordinances and state laws relating to building construction and hereby authorize representative(s) of this city to enter upon the abovementioned property for inspection purposes.

Date 8-23-00 Applicant/Agent Signature Debbie Stowers

WORKER'S COMPENSATION DECLARATION: I hereby affirm under penalty of perjury one of the following declarations:

I have and will maintain a certificate of consent to self-insure for workers' compensation as provided for by Section 3700 of the Labor Code, for the performance of work for which the permit is issued.

I have and will maintain workers' compensation insurance, as required by Section 3700 of the Labor Code, for the performance of the work for which this permit is issued. My workers' compensation insurance carrier and policy number are:

Carrier: AMER GUAR. & HAB INS Policy Number WC8322096-02 Exp Date 10/01/2000

(This section need not be completed if the permit is for \$100 or less) I certify that in the performance of the work for which this permit is issued, I shall not employ any person in any manner so as to become subject to the workers' compensation laws of California and agree that if I should become subject to the workers' compensation provisions of Section 3700 of the Labor Code, I shall forthwith comply with those provisions.

Date 8-23-00 Applicant Signature Debbie Stowers

WARNING: FAILURE TO SECURE WORKER'S COMPENSATION COVERAGE IS UNLAWFUL AND SHALL SUBJECT AN EMPLOYER TO CRIMINAL PENALTIES AND CIVIL FINES UP TO ONE HUNDRED THOUSAND DOLLARS (\$100,000) IN ADDITION TO THE COST OF COMPENSATION, DAMAGES AS PROVIDED FOR IN SECTION 3706 OF THE LABOR CODE, INTEREST AND ATTORNEY'S FEE.

THIS PERMIT SHALL EXPIRE BY LIMITATION IF WORK IS NOT COMMENCED WITHIN 180 DAYS.

RESIDENTIAL BUILDING PERMIT APPLICATION

New Construction

Addition

Remodels

Other

Project Address: 5112 Seaglen Way
LOT 22

Assessor Parcel # 201-0350-022

OWNER INFORMATION:

Legal Property Owner: Center Homes Phone # 786-8693
Owner Address: 3700 Douglas Blvd #150 City Rosville State CA Zip 95661

CONTRACTOR INFORMATION:

Contractor: Center Homes Lic. # 734094 Phone # 786-8693 Fax# 786-6802

PROJECT INFORMATION:

Land Use Zone RIA Occupancy Group R3 Construction Type VN Fed Code 1A
No. of stories: 2 No. of rooms: _____ Street width: _____
1st Floor Area 1309 2nd Floor Area 1363 Basement _____ Roof Material _____

AREA IN SQUARE FOOT OF:

	EXISTING	NEW
Dwelling/Living	_____	<u>2672</u>
Garage/Storage	_____	<u>614</u>
Decks/Balconies	_____	<u>58</u>
Carports	_____	_____

SCOPE OF WORK: MP 2512 New Home Construction

FOR OFFICE USE ONLY

- Information above complete
- Violation files checked
- Standard setbacks
- County Sewer
- AR Flood Waiver required
- Flood Elevation Certificate Required
- Water Development Infill Area
- Planning Approval
- Design Review Approval
- Special Fee Districts Apply : _____

NEW STRUCTURES & ADDITIONS

◆ THE FOLLOWING MUST BE PROVIDED IN ORDER TO SUBMIT FOR PLAN REVIEW

- 2 COMPLETE PLANS, LEGIBLE & DRAWN TO SCALE
 - 3 SETS IF PROJECT IS IN A DESIGN REVIEW AREA
 - Title 24 Energy Compliance documentation
 - Grading and Erosion Control Questionnaire
 - 11" x 17" copy of floor plan for County Assessor
 - Plan Review Fees
- ◆ Plans to include: site plan, floor plan, elevations, roof/ceiling plan, foundation and structural framing details, and structural calculations for non-conforming structures.

Date: _____

Received by: (staff) _____

ACTIVITY/PERMIT # _____

MP 2512B/OPT 2 STORY 10 ROOM
SFR

Natomas Unified School District
 1515 Sports Drive, #1 • Sacramento, CA 95834-1905
 Phone 916/641-3300 • Fax 916/928-1629

CERTIFICATION OF COMPLIANCE

SCHOOL DISTRICT DEVELOPMENT FEES

PART I: TO BE COMPLETED BY APPLICANT	
Property Owner's Name	Center Homez
Owner's Address	3700 Douglas Blvd. # 150, Roseville 95661
Project Address	5112 Sackler Way
Parcel Number	201-0350-022 Lot 22
Subdivision Name	Natomas 5
Number of Units	1
Print Applicant's Name	Debbie Stowers
Title of Applicant	Permit Coordinator
Date	7-24-00
Applicant's Signature	Debbie Stowers
Telephone Number	786-8693
PART II: TO BE COMPLETED BY BUILDING DEPARTMENT	
Plan Identification Number	MP 2406
Building Type (Check One)	<input checked="" type="checkbox"/> Residential <input type="checkbox"/> Apartment/Condominium <input type="checkbox"/> Commercial/Industrial
Square Feet of Chargeable Building Area	2406 sq ft
Signature	[Signature]
Title	IST
Date	7-25-00
PART III: TO BE COMPLETED BY NATOMAS UNIFIED SCHOOL DISTRICT	
District Certification Number	01-217
Fees Collected:	
Residential:	2406 Sq. Ft. X \$ 3.25 = \$ 7819.50
Apartment/Condominium:	Sq. Ft. X \$ = \$
Commercial/Industrial:	Sq. Ft. X \$ = \$
<p>NOTICE TO APPLICANT: Pursuant to government code section 66020 (d), this will serve to notify you that the 90-day approval period in which you may protest the fees, or other payment identified above, will begin to run on the date in which the building or installation permit for this project is issued, or on which they are paid to the District, or to another public entity authorized to collect them on behalf of the District, whichever is earlier.</p>	
Applicant Signature:	Debbie Stowers
Date:	8/3/00

This certification covers only the amount of square footage indicated above. Any additions or corrections to the square footage for this project will require an amendment to the Certificate of Compliance.

As the authorize Natomas Unified School District official, I hereby certify that the requirements of Government Code Section 95995 have been complied with by the above signed applicant.

SIGNATURE: [Signature] DATE: 8/3/00
 TITLE: Account Tech II

Natomas Unified School District
 1515 Sports Drive, #1 • Sacramento, CA 95834-1905
 Phone 916/641-3300 • Fax 916/928-1629

CERTIFICATE OF COMPLIANCE

SCHOOL DISTRICT DEVELOPMENT FEES

Property Owner's Name		Center Homes	
Owner's Address		3700 Douglas Blvd. #150, Roseville 95661	
Project Address		5112 Seaglean Way	
Parcel Number		201-352-022	Lot 22
Subdivision Name		Northborough 5	
Number of Units		1	
Print Applicant's Name		Debbie Stowers	Applicant's Signature <i>Debbie Stowers</i>
Title of Applicant		Permit Coordinator	Telephone Number 786-8673
Date		8-23-00	
FEES TO BE COMPLETED BY BUILDING DEPARTMENT			
Plan Identification Number		2512 B/017 REPLACES 2406	
Building Type (Check One)			
<input type="checkbox"/> Residential		<input type="checkbox"/> Apartment/Condominium	
<input type="checkbox"/> Commercial/Industrial			
Square Feet of Chargeable Building Area		2672 ^{sq} REPLACES 2406 ^{sq} (266 NEW)	
Signature		<i>Debbie Stowers</i>	
Title		Date 8-22-00	
FEES TO BE PAID TO NATOMAS UNIFIED SCHOOL DISTRICT			
District Certification Number		01-355	
Fees Collected:			
Residential:	266	Sq. Ft. X \$ 3.25	= \$ 864.50
Apartment/Condominium:		Sq. Ft. X \$	= \$
Commercial/Industrial:		Sq. Ft. X \$	= \$
<p>NOTICE TO APPLICANT: Pursuant to government code section 66020 (d), this will serve to notify you that the 90-day approval period in which you may protest the fees, or other payment identified above, will begin to run on the date in which the building or installation permit for this project is issued, or on which they are paid to the District, or to another public entity authorized to collect them on behalf of the District, whichever is earlier.</p>			
Applicant Signature:		<i>Debbie Stowers</i>	Date: 8-23-00

This certification covers only the amount of square footage indicated above. Any additions or corrections to the square footage for this project will require an amendment to the Certificate of Compliance.

As the authorize Natomas Unified School District official, I hereby certify that the requirements of Government Code Section 95995 have been complied with by the above signed applicant.

SIGNATURE: *[Signature]* DATE: 8/23/00
 TITLE: *Account Tech II*

COUNTY SANITATION DISTRICT NO. 1
 SACRAMENTO REGIONAL COUNTY SANITATION DISTRICT
SEWER IMPACT FEE *gmr*
 PERMIT AND CALCULATION SHEET *7/22/00*

APPLICATION NO:		BLDG PERMIT NO: <i>City</i>	
GENERAL INFORMATION		THIS PERMIT GOOD ONLY WHEN VALIDATED BY THE CASHIER	
		<i>201761 gmr 7/22/00</i>	
		THIS PERMIT TO CONNECT EXPIRES ONE YEAR FROM DATE OF ISSUANCE	
FEE CALCULATION		BUILDING USE	
INSPECTION	<i>0</i>	RESIDENTIAL SF <input type="checkbox"/>	MF <input type="checkbox"/>
CSD-1	<i>473.-</i>	COMMERCIAL USE	UNITS
SRCSO	<i>2404.-</i>		
CONSTRUCTION			
IN-LIEU			
TOTAL FEE	<i>2877.-</i>		
APN: <i>201 - 0350 - 022</i>			
DESCRIPTION/SUBDIVISION <i>Northborough 5</i> LOT: <i>22</i>			
PROPERTY ADDRESS <i>5112 Seaglem Way</i>			
OWNER <i>Center Homes</i>			
MAILING ADDRESS <i>3700 Douglas Blvd #150</i>			
CITY-STATE-ZIP <i>Roseville CA 95661</i> PHONE <i>786-8693</i>			
ADDITIONAL FEES MAY BE DUE IF CHANGES IN USE INCREASE SEWER IMPACT.			
APPLICANT SIGNATURE <i>Archie Stawek</i>			
CONSOLIDATED UTILITY BILLING USE ONLY			
ACCT _____ INPUT _____ START _____			

INSPECTOR'S COPY

Lot Area = 7,143 sf
 Building Footprint = 1,966 sf
 Gross Coverage = 27.5%
 Porch Allowance = 43 sf
 Net Coverage = 26.9%

SCALE: 1"=20'

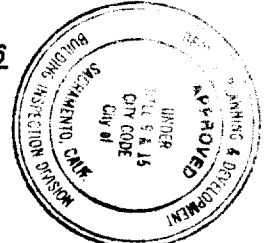
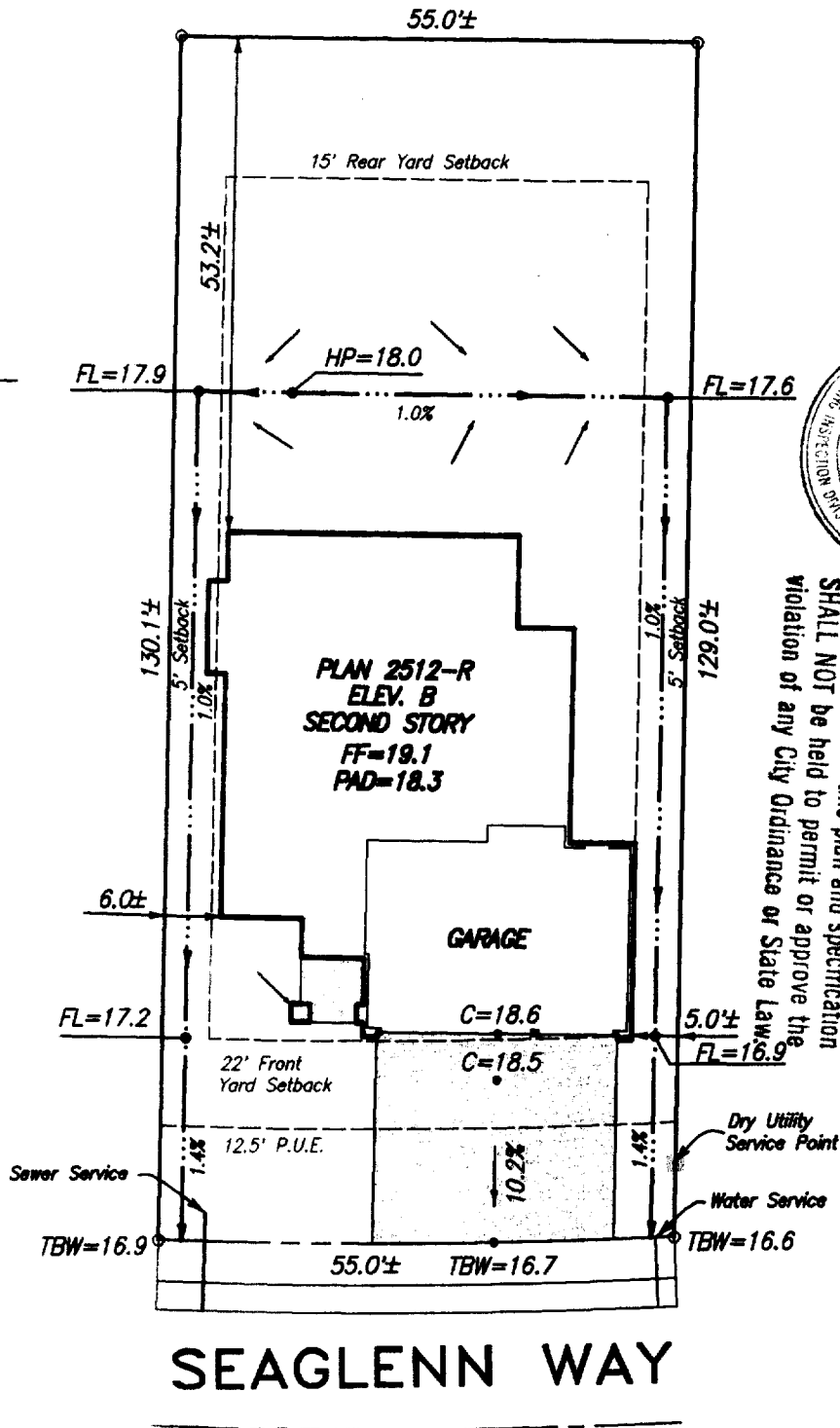

This set of plans and specifications must be kept on the job at all times and it is unlawful to make any changes or alterations from the same without written permission from the Building Inspection Division.
 The approval of this plan and specification SHALL NOT be held to permit or approve the violation of any City Ordinance or State Law.

Plot Plan for Lot 22
 Northborough Village 5-1
 City of Sacramento

Centex Homes
 3700 Douglas Blvd., Suite 150
 Roseville, CA 95661
 Ph.: (916) 786-8693

Plan 2512 Elev. B
 Centex Review & Approval:
 By: [Signature] Date: 8/21

Note:
 This plot plan has been prepared for the purpose of showing the building foundation relationship to the property line, proposed drainage elevations and direction of flow to conform to local ordinances and for the purpose of building permit issuance. Information shown is approximate except for those setbacks which are minimums required by ordinance. This plot does not reflect as-built conditions which will likely vary from this plan.

**Murray Smith & Associates
 Engineering, Inc.**
 3110 Gold Canal Drive
 Rancho Cordova, CA 95670
 Ph.: (916) 635-1511

August 18, 2000

PN: 99008