

OFFICE COPY THIS IS A 2 PART FORM WRITE ON A FIRM SURFACE

CONSTRUCTION LENDING AGENCY
 I hereby affirm under penalty of perjury that there is a construction lending agency for the performance of the work for which this permit is issued (Sec. 3097, Civ.C.).

Lenders Name _____
 Lenders Address _____

LICENSED CONTRACTORS DECLARATION
 I hereby affirm under penalty of perjury that I am licensed under provisions of Chapter 9 (commencing with Section 7000) of Division 3 of the Business and Professions Code and my license is in full force and effect.
 License Class B Lic. Number 724016
 Date 5/7/03 Contractor _____ (Signature)

OWNER - BUILDER DECLARATION
 I hereby affirm under penalty of perjury that I am exempt from the Contractors License Law for the following reason (Sec. 7031.5, Business and Professions Code: Any city or county which requires a permit to construct, alter, improve, demolish, or repair any structure, prior to its issuance, also requires the applicant for such permit to file a signed statement that he or she is licensed pursuant to the provisions of the Contractors License Law (Chapter 9 (commencing with Section 7000) of Division 3 of the Business and Professions Code) or that he or she is exempt therefrom and the basis for the alleged exemption. Any violation of Section 7031.5 by any applicant for a permit subjects the applicant to a civil penalty of not more than five hundred dollars (\$500.00):

I, as owner of the property, or my employees with wages as their sole compensation, will do the work, and the structure is not intended or offered for sale (Sec. 7044, Business and Professions Code: The Contractors License Law does not apply to an owner of property who builds or improves thereon, and who does such work himself or herself or through his or her own employees, provided that such improvements are not intended or offered for sale. If, however, the building or improvement is sold within one year of completion, the owner-builder will have the burden of proving that he or she did not build or improve for the purpose of sale.)

I, as owner of the property, am exclusively contracting with licensed contractors to construct the project (Sec. 7044, Business and Professions Code: The Contractors License Law does not apply to an owner of property who builds or improves thereon, and who contracts for such projects with a contractor(s) licensed pursuant to the Contractors License Law).

I am exempt under Sec. _____ B & P C for this reason _____
 Date _____ Owner _____ (Signature)

In issuing this building permit, the applicant represents, and the City relies on the representation of the applicant, that the applicant verified all measurements and locations shown on the application or accompanying drawings and that the improvement to be constructed does not violate any law or private agreement relating to permissible or prohibited locations for such improvements. This building permit does not authorize any illegal location of any improvement or the violation of any private agreement relating to location of improvements.

I certify that I have read this application and state that all information is correct. I agree to comply with all city and county ordinances and state laws relating to building construction and hereby authorize representative of this city to enter upon the abovementioned property for inspection purposes.
5/7/03 _____ Date
 Signature of Applicant or Agent

USE BLACK INK BALL POINT PEN - PRESS FIRMLY SIGN PERMIT APPLICATION

SITE ADDRESS 1725 28th St SUITE _____ INSP. AREA 1
 ASSESSOR PARCEL NO. 007-0344-003 PERMIT NO. 0306290
 NAME OF APPLICANT _____ PHONE NO. _____
 LICENSED CONTRACTOR WEST FORK CONST. INC. ADDRESS 4701 24th St, SACRAMENTO 95822 452-8197
 BUSINESS OWNER DEPT. HUMAN ASSISTANCE

SIGN INFORMATION
 ATTACHED INTERIOR/ELECT. SINGLE FACED
 ILLUMINATED NON-ILLUMINATED BILLBOARD / SUBDIVISION
 INDIVIDUAL LETTERS PAINTED ON BUILDING LOGO
 METAL POLE DOUBLE FACED
 PLASTIC MONUMENT VINYL/GATOR FOAM
 WOODEN PROJECTING RE-FACE
 SIGN COPY COUNTY OF SACRAMENTO
THE PAC WRLK BLDG
1725 28th St.

CITY OF SACRAMENTO PERMIT SERVICES 284-7619
BUILDING INSPECTION DIVISION
WORKER'S COMPENSATION DECLARATION
 I hereby affirm under penalty of perjury that I am making the following declarations:
 I have and will maintain a certificate of workers' compensation insurance for the performance of work for which this permit is issued.
 I have and will maintain workers' compensation insurance, as required by Section 3700 of the Labor Code, for the performance of the work for which this permit is issued. My workers' compensation insurance carrier and policy number are:
STATE COME INS. FUND
046-010307-02

WORKER'S COMPENSATION DECLARATION
 I hereby affirm under penalty of perjury that I am making the following declarations:
 I have and will maintain a certificate of workers' compensation insurance for the performance of work for which this permit is issued.
 I have and will maintain workers' compensation insurance, as required by Section 3700 of the Labor Code, for the performance of the work for which this permit is issued. My workers' compensation insurance carrier and policy number are:
STATE COME INS. FUND
046-010307-02

FINAL INSPECTIONS
 BUILDING INSPECTOR David 6-30-06 DATE
 ELECTRICAL INSPECTOR _____ DATE
 SIGN INSPECTOR _____ DATE
 RECEIVED _____ AMOUNT
 DATE

FEES:
 SIGN APPLICATION FEE _____
 SIGN PERMIT FEE _____
 ELECTRICAL SIGN FEE _____
 CITY BUSINESS LICENSE _____
 OTHER _____
TOTAL \$

WARNING: FAILURE TO SECURE WORKERS' COMPENSATION COVERAGE IS UNLAWFUL AND SHALL SUBJECT AN EMPLOYER TO CRIMINAL PENALTIES AND CIVIL FINES UP TO ONE HUNDRED THOUSAND DOLLARS (\$100,000) IN ADDITION TO THE COST OF COMPENSATION, DAMAGES AS PROVIDED FOR IN SECTION 3706 OF THE LABOR CODE, INTEREST AND ATTORNEY'S FEES.

THIS PERMIT SHALL EXPIRE BY LIMITATION IF WORK AUTHORIZED IS NOT COMMENCED WITHIN 180 DAYS.

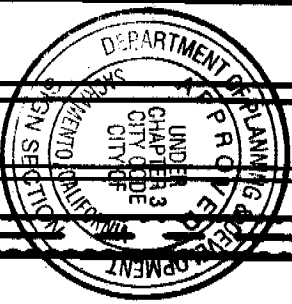

ALL ELECTRICAL WORK MUST BE U.L. LABELED OR BE OF EQUIVALENT STANDARDS, N.E.C. Sec. 90-6/land compliance with Chapter 14, Div. 2 of Sacramento City Code.

EQUIPMENT MUST BE USED AS DESIGNED AND MANUFACTURED.

ALL SIGN INSTALLATIONS ARE SUBJECT TO FIELD INSPECTIONS.

This set of plans and specifications must be kept on the job at all times and it is unlawful to make any changes or alterations from the same without written permission from the City of Sacramento Sign Section. The approval of these plans and specifications SHALL NOT be held to permit or approve the violation of any City Ordinance or State Law.

R STREET

80TH STREET

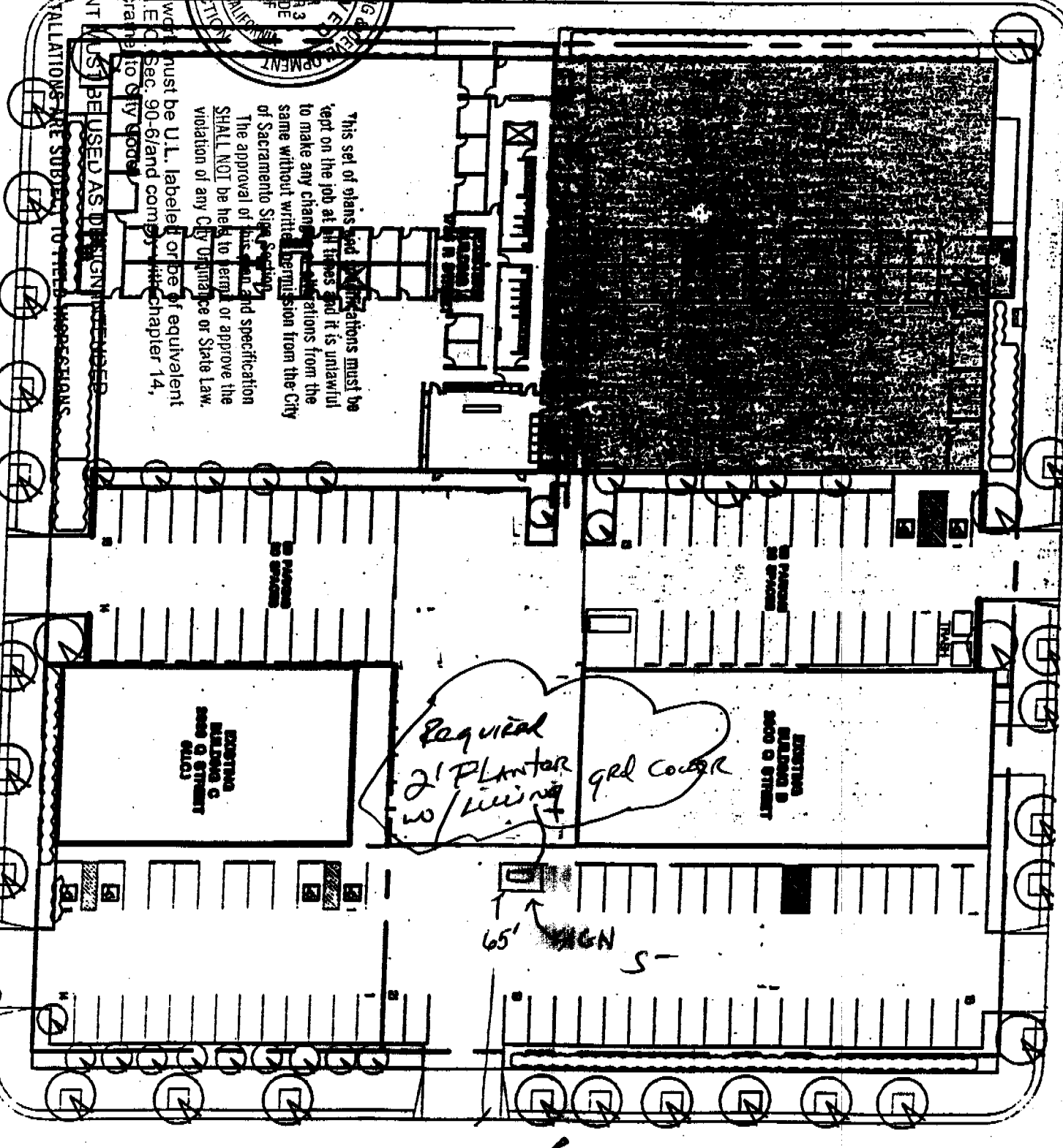

Required
2 PLANTER w/ wiring
grd cover

65' SIGN S-

CITY COPY

O STREET

8'-0" 24"

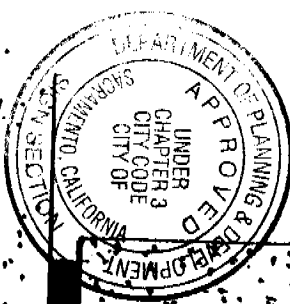
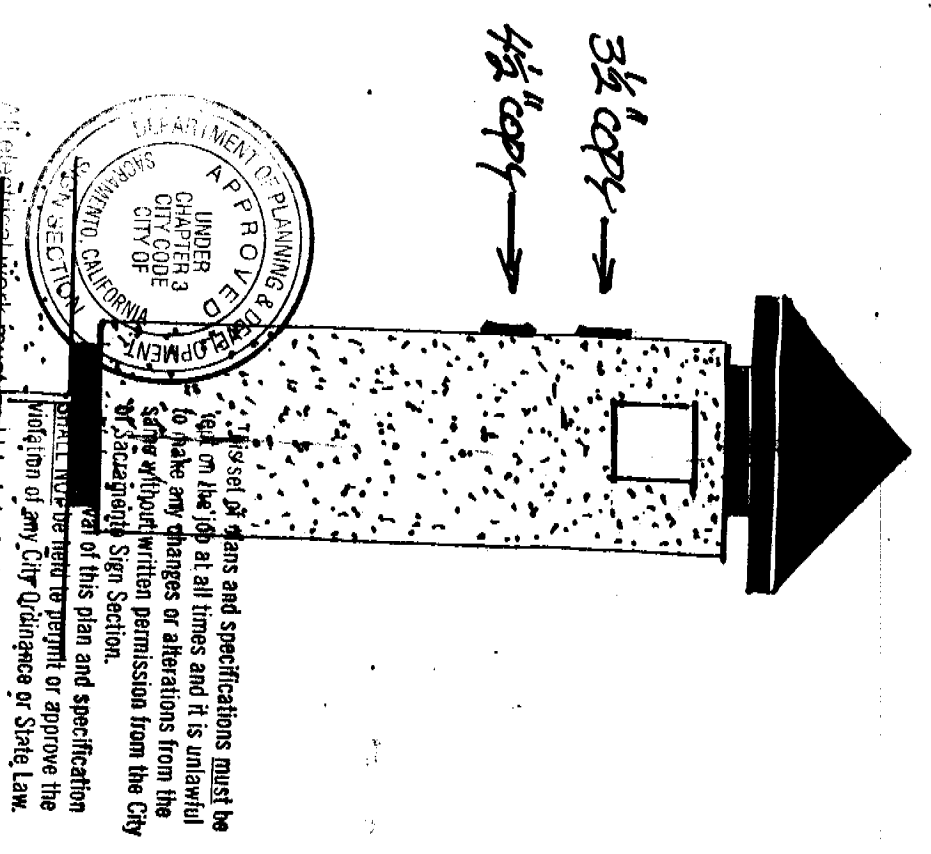
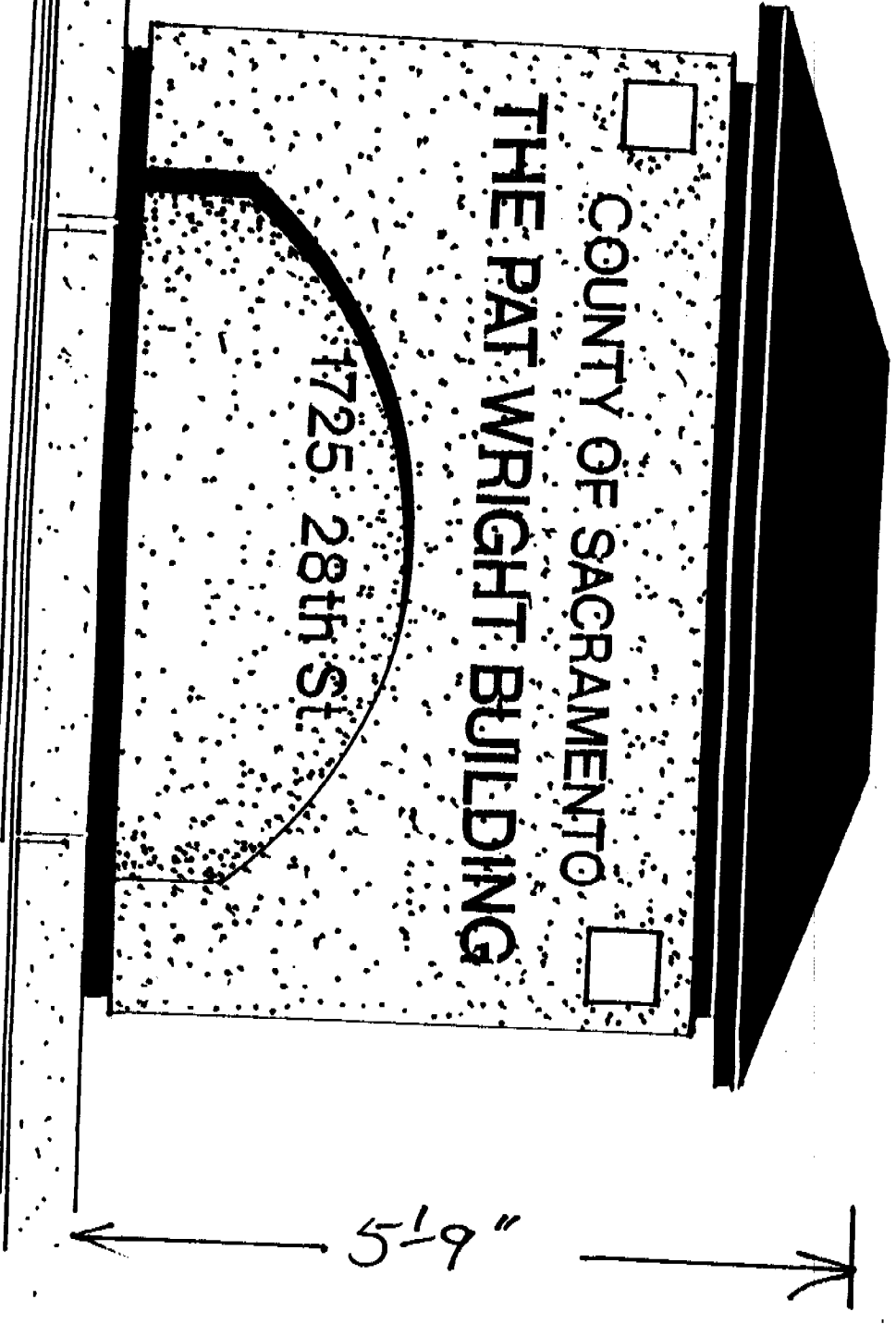

This set of plans and specifications must be kept on the job at all times and it is unlawful to make any changes or alterations from the same without written permission from the City of Sacramento Sign Section.

Approval of this plan and specification shall not be held to permit or approve the violation of any City Ordinance or State Law.

Golden Coast Signs
 1607 Juliette Avenue #B
 Sacramento, CA 95815
 (916) 929-3333

NO MINIMUM SIZE REQUIREMENT SIGN
SCALE 3/4" = 1'-0"
 ALL EQUIPMENT MUST BE USED AS DESIGN INTENDED
 ALL SIGN INSTALLATIONS ARE SUBJECT TO FIELD INSPECTIONS

7'1"

3' 4'-6"



All electrical work must be U.L. labeled or be of equivalent standards, N.E.C. Sec. 90-6/and comply with chapter 14, Div. 2 of Sacramento City Code.
EQUIPMENT MUST BE USED AS DESIGN INTENDED
ALL SIGN INSTALLATIONS ARE SUBJECT TO FIELD INSPECTIONS

This set of plans and specifications must be kept on the job at all times and it is unlawful to make any changes or alterations from the same without written permission from the City of Sacramento Sign Section.
The approval of this plan and specification SHALL NOT be held to permit or approve the violation of any City Ordinance or State Law.

2 4" O.D. GALV PIPE

2 1 1/2" AUSTE FROVE MARK SKIN
TEX COATED SHEET
EXISTING CURBETS
6" THICK

2 CONCRETE

CONCRETE

2 3" SAND

18"



8'-0" ← →

24" ← →

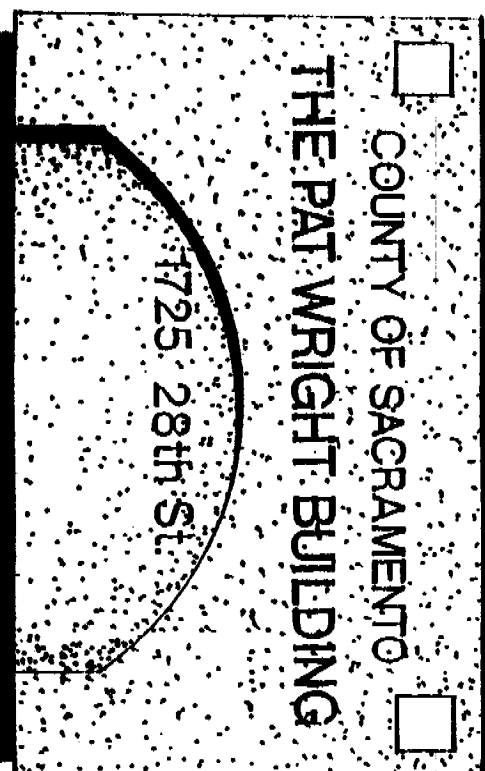

FRONT VIEW

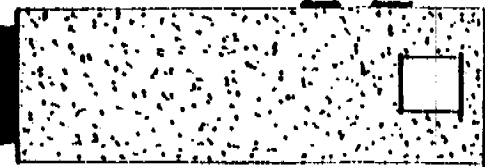

SIDE VIEW

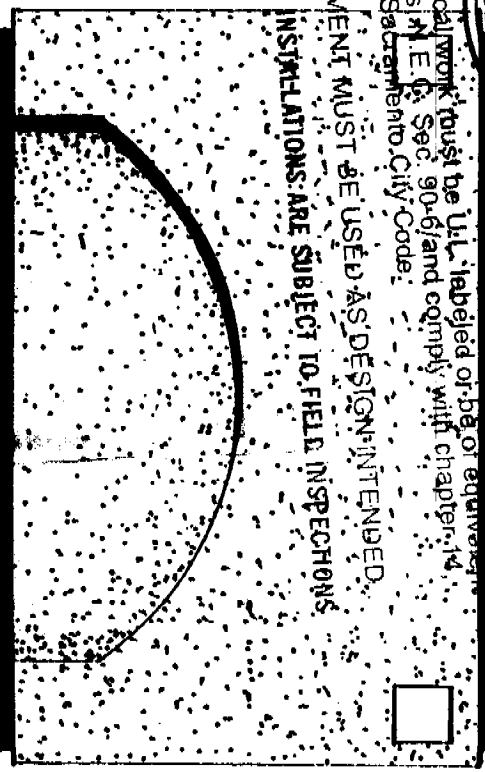

BACK VIEW

3 1/2" COPY
3 1/2" COPY
3" COPY

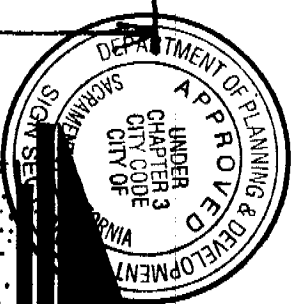

This set of plans and specifications must be kept on the job at all times and it is unlawful to make any changes or alterations from the same without written permission from the City.

All electrical work must be U.L. labeled or equivalent standards in E.C.A. Sec. 90-61 and comply with Chapter 14 Div. 2 of Sacramento City Code.

EQUIPMENT MUST BE USED AS DESIGN INTENDED. ALL SIGN INSTALLATIONS ARE SUBJECT TO FIELD INSPECTIONS.

5'-9"

- METAL ROOF 1/4" THICK METAL COPY / PAINTER GRAY MED GRADE
- 1 1/2" ANGLE IRON FRAME W/ TEX COATED SHEET METAL SKIN
- (G) 6"x6" FLUSHED TILE / EMBEDDED TO CURBLET
- (A) 4" OD STK POLES / COMPARE TO BEHND

Golden Coast Signs
1607 Julisse Avenue #B
Sacramento, CA 95815
(916) 929-3333