

CITY OF SACRAMENTO

1231 I Street, Sacramento, CA 95814

Permit No: **0506730**

Insp Area: 3

Thos Bros: 337F1

Site Address: 2733 YREKA AV SAC

Parcel No: 041-0063-005

Sub-Type: RES

Housing (Y/N): N

CONTRACTOR
OWNER BUILDER

OWNER
CHANDRA, NARESH
5985 79TH STREET
SACRAMENTO, CA 95824

ARCHITECT

Nature of Work: WRECK 960 SF SFD

CONSTRUCTION LENDING AGENCY : I hereby affirm under penalty of perjury that there is a construction lending agency for the performance of the work for which this permit is issued (Sec. 3097, Civ. C).

Lender's Name _____ Lender's Address _____

LICENSED CONTRACTORS DECLARATION: I hereby affirm under penalty of perjury that I am licensed under provisions of Chapter 9 (commencing with section 7000) of Division 3 of the Business and Professions Code and my license is in full force and effect.

License Class _____ License Number 0 _____ Date _____ Contractor Signature _____

OWNER-BUILDER DECLARATION: I hereby affirm under penalty of perjury that I am exempt from the contractors License Law for the following reason (Sec. 7031.5, Business and Professions Code; any city or county which requires a permit to construct, alter, improve, demolish, or repair any structure, prior to its issuance, also requires the applicant for such permit to file a signed statement that he or she is licensed pursuant to the provisions of the Contractors License Law (Chapter 9 (commencing with Section 7000) of Division 8 of the Business and Professions Code) or that he or she is exempt therefrom and the basis for the alleged exemption. Any violation of Section 7031.5 by any applicant for a permit subjects the applicant to a civil penalty of not more than five hundred dollars (\$500.00);

_____, I, as a owner of the property, or my employees with wages as their sole compensation, will do the work, and the structure is not intended or offered for sale (Sec. 7044, Business and Professional Code: The Contractors License Law does not apply to an owner of property who builds or improves thereon, and who does such work himself or herself or through his/her own employees, provided that such improvements are not intended or offered for sale. If, however, the building or improvement is sold within one year of completion, the owner-builder will have the burden of proving that he/she did not build or improve for the purpose of sale.)

I, as owner of the property, am exclusively contracting with licensed contractors to construct (Sec. 7044, Business and Professions Code: The Contractors License Law does not apply to an owner of property who builds or improves thereon, and who contracts for such projects with a contractor(s) licensed pursuant to the Contractors License Law).

PAID
CITY OF SACRAMENTO
MAY 17 2005

I am exempt under Sec. _____ B & PC for this reason: _____
Date 5-17-05 Owner Signature *[Signature]*

IN ISSUING THIS BUILDING PERMIT, the applicant represents, and the city relies on the representation of the applicant, that the applicant verified all measurements and locations shown on the application or accompanying drawings and that the improvement to be constructed does not violate any law or private agreement relating to permissible or prohibited locations for such improvements. This building permit does not authorize any illegal location of any improvement or the violation of any private agreement relating to location of improvements.

I certify that I have read this application and state that all information is correct. I agree to comply with all city and county ordinances and state laws relating to building construction and hereby authorize representative(s) of this city to enter upon the above-mentioned property for inspection purposes.

Date 5-17-05 Applicant/Agent Signature *[Signature]*

WORKER'S COMPENSATION DECLARATION: I hereby affirm under penalty of perjury one of the following declarations:

_____, I have and will maintain a certificate of consent to self-insure for workers' compensation as provided for by Section 3700 of the Labor Code, for the performance of work for which the permit is issued.

_____, I have and will maintain workers' compensation insurance, as required by Section 3700 of the Labor Code, for the performance of the work for which this permit is issued. My workers' compensation insurance carrier and policy number are:

Carrier _____ Policy Number _____ Exp Date _____

(This section need not be completed if the permit is for \$100 or less) I certify that in the performance of the work for which this permit is issued, I shall not employ any person in any manner so as to become subject to the workers' compensation laws of California and agree that if I should become subject to the workers' compensation provisions of Section 3700 of the Labor Code, I shall forthwith comply with those provisions.

Date 5-17-05 Applicant Signature *[Signature]*

WARNING: FAILURE TO SECURE WORKER'S COMPENSATION COVERAGE IS UNLAWFUL AND SHALL SUBJECT AN EMPLOYER TO CRIMINAL PENALTIES AND CIVIL FINES UP TO ONE HUNDRED THOUSAND DOLLARS (\$100,000) IN ADDITION TO THE COST OF COMPENSATION, DAMAGES AS PROVIDED FOR IN SECTION 3706 OF THE LABOR CODE, INTEREST AND ATTORNEY'S FEE.

THIS PERMIT SHALL EXPIRE BY LIMITATION IF WORK IS NOT COMMENCED WITHIN 180 DAYS.

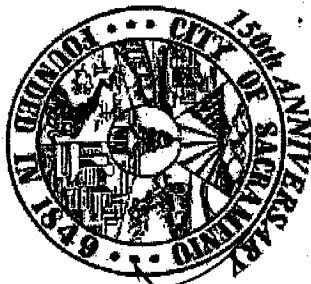

0506730

DATE: 5-12-05

CITY OF SACRAMENTO
DEVELOPMENT SERVICES DIVISION
FAXED PERMIT APPLICATION (certain restrictions apply)
Fax # 916-264-1901

Faxed request must be received in this office by 3:00 p.m. to be processed the following work day.
Note: Contractors must have a current certificate of Worker's Compensation Insurance.

Note: Work started before a Building Permit is issued will be subject to quad fee

RESIDENTIAL APARTMENTS (4+ units per building) COMMERCIAL (qualified)

IN ORDER TO PROCESS THIS REQUEST, ALL THE FOLLOWING INFORMATION MUST BE PROVIDED:

JOB ADDRESS: 2733 Yreka Ave. UNIT # _____ CONTRACT PRICE \$ 3,000.00

CONTACT PERSON: Naresh Chandra CONTACT PHONE: 916-203-0176

Property Owner: Naresh Chandra
Address: 5485 Park St.
City/State/Zip: Sac Ca 95824
Phone: 916-203-0176
Contractor: _____ License # _____
Address: _____
City/State/Zip: _____
Phone: _____ FAX: OTR

NATURE OF REQUEST: Indicate from the selections below & provide details under description of work

| | | | | | | |
|---|---|---|---|--|--|--|
| <input type="checkbox"/> ROOF (excluding tile) <input type="checkbox"/> TEAR-OFF <input type="checkbox"/> RESHET <input type="checkbox"/> HOUSE # SQUARES <input type="checkbox"/> GARAGE Material: <input type="checkbox"/> SIDING <input type="checkbox"/> wood <input type="checkbox"/> T-111 <input type="checkbox"/> Horiz <input type="checkbox"/> vinyl <input type="checkbox"/> stucco Note: Design Review approval may be required in certain areas. | <input type="checkbox"/> HVAC INSTALLATIONS (residential ONLY) <input type="checkbox"/> CHANGE-OUT <input type="checkbox"/> NEW <input type="checkbox"/> Heat Pump <input type="checkbox"/> Package <input type="checkbox"/> Split system <input type="checkbox"/> Roof mount <input type="checkbox"/> Cur-in <input type="checkbox"/> Heat pump or elect. unit to gas. <input type="checkbox"/> Wall furnace <input type="checkbox"/> Other (describe below) | <input type="checkbox"/> WATER HEATER (residential ONLY) <input type="checkbox"/> GAS <input type="checkbox"/> ELECTRIC <input type="checkbox"/> Change-out <input type="checkbox"/> Electric to Gas <input type="checkbox"/> Relocate <input type="checkbox"/> New | <input type="checkbox"/> MINOR ELECTRIC and/or MINOR PLUMBING (residential ONLY) <input type="checkbox"/> Electric Service Change # amps <input type="checkbox"/> New electric circuits <input type="checkbox"/> Re-wire <input type="checkbox"/> Water Service Replacement <input type="checkbox"/> Sewer Service Replacement <input type="checkbox"/> Gas Line Replacement <input type="checkbox"/> Re-plumb <input type="checkbox"/> Water <input type="checkbox"/> Waste | Value of duct work: \$ _____ Equipment: \$ _____ Cut-in: \$ _____ Note: Design Review approval may be required for rooftop units. | <input type="checkbox"/> DRY ROT OR TERMITE DAMAGE REPAIR (Describe locations below) Note: Design Review approval may be required in certain areas. | <input type="checkbox"/> PUBLIC UTILITIES SAFETY INSPECTION* (Residential and single apartment units ONLY) <input type="checkbox"/> SMUD <input type="checkbox"/> PGE *NOTE: Correction Notice items will require an additional building permit |
|---|---|---|---|--|--|--|

DESCRIPTION OF WORK:

900SF demolition of SFR

5371



Jose L. ...
5/17/05

Building Demolition & Movement

Form FP-9

Date of Application:

| Location | Type of Action |
|---|---|
| Address of Structure: <u>2733 Yreka Ave</u> | <input checked="" type="checkbox"/> Demolition |
| APN: <u>041-0063-005</u> Zip: <u>95822</u> | <input type="checkbox"/> Move - explain route on back |
| Contact Name: <u>Naresh Chandra</u> | Date: <u>5/18/05</u> |
| Contact Phone: <u>(916) 203-0176</u> | Time: <u>8:00 am.</u> |

Building Type

- Dwelling
- Commercial
- School
- Other - explain: _____

Hazard Analysis

Are there any access restrictions to the site?

- Yes - explain: _____
- No

Are there underground tanks on the property?

- Yes
- No

Are there any hazardous materials on the site? (i.e. asbestos, flammable or combustible liquids, etc.)

- Yes - explain: _____
- No

Responsible Party

Signature: *Naresh Chandra* Print Name: Naresh Chandra

Comments: _____

DATE: 5-17-05

DEPARTMENT OF
PLANNING AND DEVELOPMENT

CITY OF SACRAMENTO
CALIFORNIA

1231 I STREET
ROOM 200
SACRAMENTO, CA
95814-2998

BUILDING INSPECTIONS
916-264-5716
Permit Services
916-264-7619
FAX 916-264-7046

AGREEMENT TO HOLD CITY HARMLESS FROM LIABILITY
BY REASON OF DEMOLITION OF BUILDING

DATED: _____

5/13/2005

KNOW ALL MEN BY THESE PRESENT:

The undersigned owner of the premises at

2733 Yreka Avenue

pursuant to provisions of the City code, hereby agrees as follows:

1. That the building to be demolished consists of a single story building, garage, and other supplemental buildings to be demolished by owner with personnel employed by him.
2. That the structure to be demolished will be so torn down so as to complete all operations within the normal setback area from the property line.
3. That in accordance with provisions of sub-section (3) of Section 913 - 4408 of the City Building Code, the undersigned shall comply with the following:

"The permittees shall take all necessary precautions to adequately protect adjacent property and its occupants. Said permittee shall, at least ten (10) days before said demolition of a building or structure begins, notify, in writing, each property owner, tenant, or occupant on either or both sides of the time when said work will commence."

4. That in consideration of waiver of insurance as allowed in an opinion written by the City Attorney dated March 31, 1964 (City Code Section 913 - 4401) setting forth the conditions under which a waiver could be allowed, the undersigned owner hereby agrees to hold the City of Sacramento, a municipal corporation, its officers and employees, harmless from liability, suits, actions, claims and damages of every kind and description to which the City or its officers or employees may be subjected by reason of negligent

~~injury to persons or property arising out of the granting of permission by the City to the undersigned to demolish the building and salvage the materials from the premises above named.~~

IN WITNESS THEREOF, the undersigned has fully read this Agreement and executed this Agreement the day and year first above written.

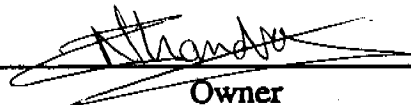
Owner

7462 SYLVIA WAY,
SACTO CA 95822 Address

Subscribed and sworn to before me this 13 day of May
2005

Notary Public in and for the County of
Sacramento, State of California

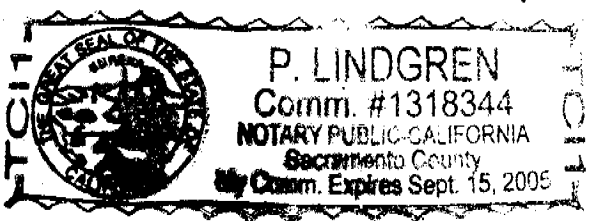

CITY OF SACRAMENTO
 PLANNING & BUILDING DEPARTMENT
 BUILDING DIVISION
www.cityofsacramento.org

2 INSPECTION PERMIT

Approval by the following City Departments **must be obtained prior to the issuance of** wrecking permit by the Building & Planning Department. Design Review approval required on all wrecking permits in Central City or Alhambra Blvd. Corridor **prior to sewer disconnect** permit being issued.

Address: 2733 YREKA AVENUE, SACRAMENTO CA 95822

Owner: NARESH CHANDRA

| | |
|--|--|
| Design Review/Planning 1231 I Street, Room 200 (916) 808-5656- Helpline Selection 3 X: | Housing & Dangerous Buildings 1231 I Street, Room 200 (916) 808-5404 X: |
| Dept of Utilities (All) 1395 35 th Ave (916) 808-5371 X: | Fire Department (All) 5770 Freeport Blvd, Suite 200 (919) 433-1692 X: |
| Traffic Engineer (Commercial) 1000 I Street, Suite 170 (916) 808-5307 X: | Arborist/Tree Service (Downtown & Commercial Bldgs.) Call for Appointment 5730 24 th Street (916) 433 6345 X: |

1. Route to Planning and Fire
2. Sewer Disconnect after calling 808-5371 Kill Tap Bring Permit (signed off by Plumbing Inspector) back to the Building Dept. to apply for a Wrecking Permit.
*Unless City Awarded Contract
3. Commercial buildings are required to have an Asbestos Form and are not to be issued before Air Quality Date is on the Asbestos Form (bottom right corner).

808-
5376

CITY OF SACRAMENTO
PLANNING & BUILDING DEPARTMENT
BUILDING DIVISION

95814-2998
Permit Service
916-264-7619
FAX 916-264-7046

APPLICATION FOR WRECKING PERMIT

LOCATION

Address: 2133 YREKA AVE, SACRAMENTO CA 95822

Lot: _____ Tract: _____

Lot Depth: _____ Lot Width: _____ Corner Lot: _____ Interior Lot: _____

Owner: NARESH CHANDRA

Address: 7462 SYLVIA WAY, SACRAMENTO, CA 95822

BUILDING DATA

Length: _____ Width: _____ First Floor Area: _____ (Sq. Ft.) No. Stories: 1

Use of Building: _____ Construction Type: _____ Height: _____

of Units: _____ Rear Yard: _____ Side Yard: _____ Set Back: _____

City Sewer: _____ Water: _____ Septic: _____ Well: _____

CONTRACTOR INFORMATION

Name: _____ State License No: _____

Address: _____

Phone: _____ Fax: _____

Liability Insurance P.L. _____ P.D. _____ Policy on File: _____

CODE REQUIREMENTS

Notification of Adjacent Property Owners: _____ Date: _____

Copy of Notification on File: _____ Use of Property Required: _____

Pedestrian Protection Required: _____ Requirements Attached: _____

Basement or Other Excavations on Lot: _____ To Be Filled: _____ Fenced: _____

PREPARE PLOT PLAN SHOWING LOCATION OF BUILDING ON LOT. ALSO TYPE AND LOCATION OF BUILDING BARRICADE.

SPECIAL CONDITIONS

I have read the above application and know the contents thereof; the same is true and correct. I further state that I am familiar with the laws governing the demolition of buildings within the City of Sacramento and the State of California and that the above structure will be razed in conformity therewith. I further state that I understand that this permit may be revoked for any violation of the provisions of the Code of the City of Sacramento pertaining to or affected by the demolition procedure to be used on the above building.

No. W _____

Date: _____

Fee: _____

Applicant: *N. Chandra*

Title: OWNER

(Applicant/Owner)

| | | |
|----------------|-------|------|
| PERMIT EXPIRES | | |
| Month / | Day / | Year |

Y THIS IS A REVOCABLE PERMIT



CITY OF SACRAMENTO
PLANNING & BUILDING DEPARTMENT
BUILDING DIVISION

DOWNTOWN PERMIT CENTER
1231 I Street, Suite 200, Sacramento, CA 95814

DEMOLITION PERMIT NOTIFICATION

BUILDING INSPECTOR

916-264-5716
PERMIT SERVICES
916-264-7619
FAX 916-264-7046

WRECKING PERMIT # _____

A Demolition Permit for a _____ **story building at:**

(Address)

Parcel No. _____ **has been issued on** _____
(Date)

The structure is scheduled for demolition within 30 days.

Please update your service and billing records accordingly.

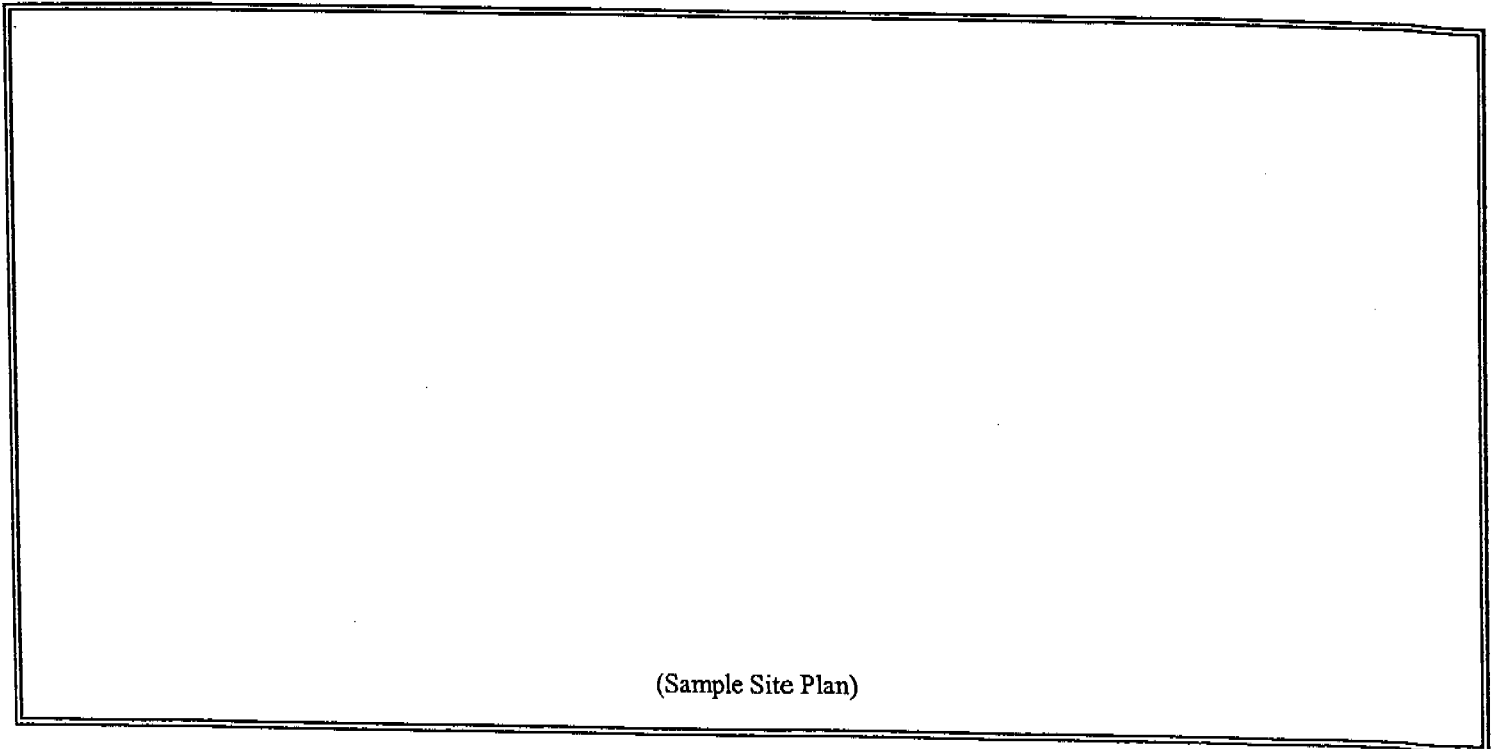

(Sample Site Plan)

- cc: **P.G. & E (Terry Clark)**
SMUD
SOLID WASTE (3141)
UTILITIES (3350)
UTILBILLING (1125)
FIRE DEPT. (2510)

DEPARTMENT OF
PLANNING AND DEVELOPMENT

CITY OF SACRAMENTO
CALIFORNIA

1231 I STREET
ROOM 200
SACRAMENTO, CA
95814-2998

BUILDING INSPECTIONS
916-264-5716
Permit Services
916-264-7619
FAX 916-264-7046

AGREEMENT TO HOLD CITY HARMLESS FROM LIABILITY
BY REASON OF DEMOLITION OF BUILDING

DATED: _____ 19 _____

KNOW ALL MEN BY THESE PRESENT:

The undersigned owner of the premises at _____

pursuant to provisions of the City code, hereby agrees as follows:

1. That the building to be demolished consists of a single story building, garage, and other supplemental buildings to be demolished by owner with personnel employed by him.
2. That the structure to be demolished will be so torn down so as to complete all operations within the normal setback area from the property line.
3. That in accordance with provisions of sub-section (3) of Section 913 - 4408 of the City Building Code, the undersigned shall comply with the following:

"The permittees shall take all necessary precautions to adequately protect adjacent property and its occupants. Said permittee shall, at least ten (10) days before said demolition of a building or structure begins, notify, in writing, each property owner, tenant, or occupant on either or both sides of the time when said work will commence."

4. That in consideration of waiver of insurance as allowed in an opinion written by the City Attorney dated March 31, 1964 (City Code Section 913 - 4401) setting forth the conditions under which a waiver could be allowed, the undersigned owner hereby agrees to hold the City of Sacramento, a municipal corporation, its officers and employees, harmless from liability, suits, actions, claims and damages of every kind and description to which the City or its officers or employees may be subjected by reason of negligent

injury to persons or property arising out of the granting of permission by the City to the undersigned to demolish the building and salvage the materials from the premises above named.

IN WITNESS THEREOF, the undersigned has fully read this Agreement and executed this Agreement the day and year first above written.

Owner

Address

Subscribed and sworn to before me this _____ day of _____

19 _____

Notary Public in and for the County of
Sacramento, State of California



DEPARTMENT OF
PLANNING AND DEVELOPMENT

CITY OF SACRAMENTO
CALIFORNIA

1231 I STREET
ROOM 200
SACRAMENTO, CA
95814-2998

WRECKING PERMIT # 0506730

BUILDING INSPECTIONS
916-264-5716
Permit Services
916-264-7619
FAX 916-264-7046

DEMOLITION PERMIT NOTIFICATION

A Demolition Permit for a 1 story building at:

2733 Yreka Avenue

Parcel number: 041-0063-005
(Address)

has been issued on _____
(date)

The structure is scheduled for demolition within 30 days.

Please update your service and billing records accordingly.

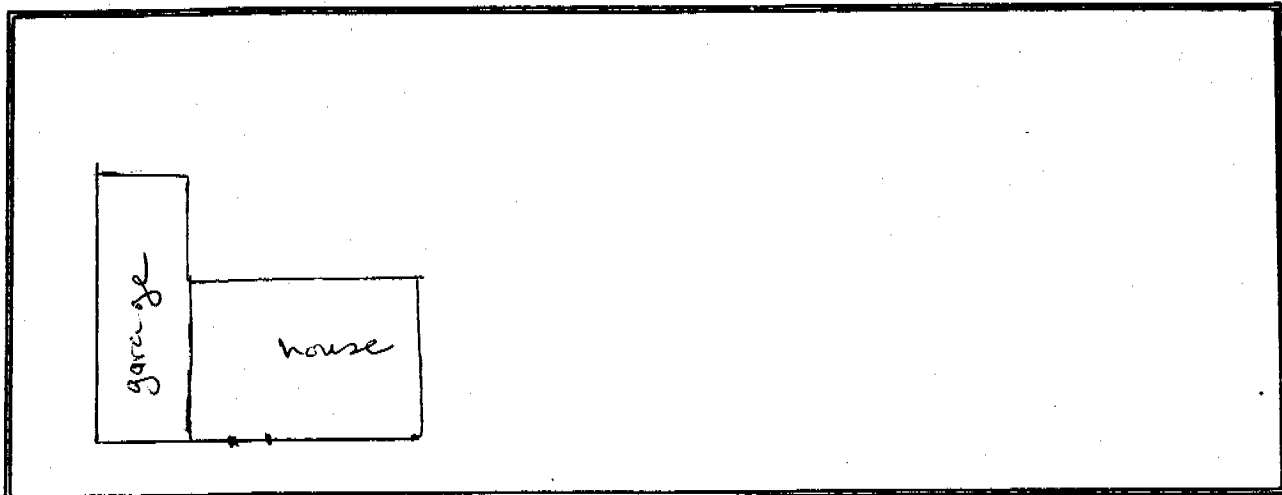

(SAMPLE SITE PLAN)

cc: P.G.& E (Terry Clark)
SMUD
SOLIDWASTE (3141)
UTILITIES (3350)
UTILBILLING (1125)

DEVELOPMENT SERVICES
DIVISION

916-264-7619
FAX 916-264-7046

APPLICATION FOR WRECKING PERMIT

LOCATION

ADDRESS: 2733 Yreka Avenue
LOT: _____ TRACT: _____
LOT DEPTH: _____ LOT WIDTH: _____ CORNER LOT: _____ INTERIOR LOT _____
OWNER: _____
ADDRESS: _____

BUILDING DATA

LENGTH: _____ WIDTH _____ FIRST FLOOR AREA _____ (SQ.FT.) NO. STORIES 1
USE OF BUILDING: Residential SFR CONSTRUCTION TYPE V-N HEIGHT _____
OF UNITS 1 REAR YARD _____ SIDE YARD _____ SET BACK _____
CITY SEWER _____ WATER _____ SEPTIC _____ WELL _____

CONTRACTOR

NAME: _____ STATE LICENSE NO. _____
ADDRESS: O/B _____
PHONE: _____ FAX: _____
LIABILITY INSURANCE P.L. _____ P.D. _____ POLICY ON FILE _____

CODE REQUIREMENTS

NOTIFICATION OF ADJACENT PROPERTY OWNERS _____ DATE: _____
COPY OF NOTIFICATION ON FILE: _____ USE OF PROPERTY REQUIRED: _____
PEDESTRIAN PROTECTION REQUIRED: _____ REQUIREMENTS ATTACHED _____
BASEMENTS OR OTHER EXCAVATIONS ON LOT: _____ TO BE FILLED _____ FENCED _____

PREPARE PLOT PLAN SHOWING LOCATION OF BUILDING ON LOT AND TYPE AND LOCATION OF BUILDING BARRICADE.

SPECIAL CONDITIONS:

I have read the above application and know the contents thereof; the same is true and correct. I further state that I am familiar with the laws governing the demolition of buildings within the City of Sacramento and the State of California and that the above structure will be razed in conformity therewith. I further state that I understand that this permit may be revoked for any violation of the provisions of the Code of the City of Sacramento pertaining to or affected by the demolition procedure to be used on the above building.

No. W _____
DATE: _____
FEE: _____

APPLICANT: NARESH CHANDRA
TITLE: OWNER
(APPLICANT/OWNER)

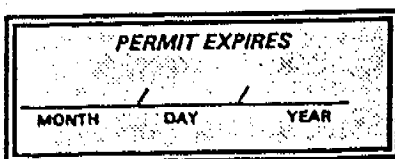

✓ THIS IS A REVOCABLE PERMIT