

CITY OF SACRAMENTO
1231 I Street, Sacramento, CA 95814

Permit No: 0103541
Insp Area: 4

Site Address: 4672 WESTLAKE PK SAC
Parcel No: 225-1550-032
N

WESTBOROUGH VIL. 1 PHASE 1 LOT 1

Sub-Type: NSFR
Housing (Y/N):

CONTRACTOR
WOODSIDE HOMES OF N. CALIF.
15 AUTO PLAZA DR #102
FOLSOM CA. 95630

OWNER

ARCHITECT

Nature of Work: MP 1800 1 STORY 6 ROOM SFR

CONSTRUCTION LENDING AGENCY: I hereby affirm under penalty of perjury that there is a construction lending agency for the performance of the work for which this permit is issued (Sec. 3097, C.R.C.)

Lender's Name _____ Lender's Address _____

LICENSED CONTRACTORS DECLARATION: I hereby affirm under penalty of perjury that I am licensed under provisions of Chapter 9 (commencing with section 7000) of Division 3 of the Business and Professions Code and my license is in full force and effect.

License Class B License Number 714377 Date 3/31/01 Contractor Signature Kiran Malhotra

OWNER-BUILDER DECLARATION: I hereby affirm under penalty of perjury that I am exempt from the contractors License Law for the following reason (Sec. 7031.5, Business and Professions Code: any city or county which requires a permit to construct, alter, improve, demolish, or repair any structure, prior to its issuance, also requires the applicant for such permit to file a signed statement that he or she is licensed pursuant to the provisions of the Contractors License Law (Chapter 9 (commencing with Section 7000) of Division 8 of the Business and Professions Code) or that he or she is exempt therefrom and the basis for the alleged exemption. Any violation of Section 7031.5 by any applicant for a permit subjects the applicant to a civil penalty of not more than five hundred dollars (\$500.00).

I, as a owner of the property, or my employees with wages as their sole compensation, will do the work, and the structure is not intended or offered for sale (Sec. 7044, Business and Professional Code: The Contractors License Law does not apply to an owner of property who builds or improves thereon, and who does such work himself or herself or through his/her own employees, provided that such improvements are not intended or offered for sale. If, however, the building or improvement is sold within one year of completion, the owner-builder will have the burden of proving that he/she did not build or improve for the purpose of sale.

I, as owner of the property, am exclusively contracting with licensed contractors to construct the project (Sec. 7044, Business and Professions Code: The Contractors License Law does not apply to an owner of property who builds or improves thereon, and who contracts for such projects with a contractor(s) licensed pursuant to the Contractors License Law).

I am exempt under Sec. _____ B & PC for this reason: _____

Date _____ Owner Signature _____

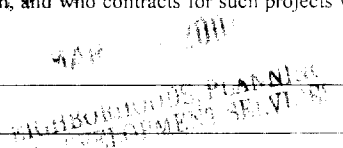

IN ISSUING THIS BUILDING PERMIT, the applicant represents, and the city relies on the representation of the applicant, that the applicant verified all measurements and locations shown on the application or accompanying drawings and that the improvement to be constructed does not violate any law or private agreement relating to permissible or prohibited locations for such improvements. This building permit does not authorize any illegal location of any improvement or the violation of any private agreement relating to location of improvements.

I certify that I have read this application and state that all information is correct. I agree to comply with all city and county ordinances and state laws relating to building construction and hereby authorize representative(s) of this city to enter upon the abovementioned property for inspection purposes.

Date 3/30/01 Applicant/Agent Signature Kiran Malhotra

WORKER'S COMPENSATION DECLARATION: I hereby affirm under penalty of perjury one of the following declarations:

I have and will maintain a certificate of consent to self-insure for workers' compensation as provided for by Section 3700 of the Labor Code, for the performance of work for which the permit is issued.

I have and will maintain workers' compensation insurance, as required by Section 3700 of the Labor Code, for the performance of the work for which this permit is issued. My workers' compensation insurance carrier and policy number are:

Carrier Ind. Energy Policy Number WBL170196100 Exp Date 12/31/01

(This section need not be completed if the permit is for \$100 or less.) I certify that in the performance of the work for which this permit is issued, I shall not employ any person in any manner so as to become subject to the workers' compensation laws of California and agree that if I should become subject to the workers' compensation provisions of Section 3700 of the Labor Code, I shall forthwith comply with those provisions.

Date 3/31/01 Applicant Signature Kiran Malhotra

WARNING: FAILURE TO SECURE WORKER'S COMPENSATION COVERAGE IS UNLAWFUL AND SHALL SUBJECT AN EMPLOYER TO CRIMINAL PENALTIES AND CIVIL FINES UP TO ONE HUNDRED THOUSAND DOLLARS (\$100,000) IN ADDITION TO THE COST OF COMPENSATION DAMAGES AS PROVIDED FOR IN SECTION 3706 OF THE LABOR CODE, INTEREST AND ATTORNEY'S FEE.

THIS PERMIT SHALL EXPIRE BY LIMITATION IF WORK IS NOT COMMENCED WITHIN 180 DAYS.

OMEGA PRODUCTS CORP.

DIAMOND WALL INSULATING STUCCO SYSTEM

JOB ADDRESS:

ICBO Report #4004

WESTLAKE - WOODSIDE HOMES
LOT #1

Date of Job Completion _____

PLASTERING CONTRACTOR:

Name: STELLAR ENTERPRISES, INC.

Address: 29054 GOETZ RD, STE. 14, CANYON LAKE CA. 92587

Telephone No: (909) 244-0525

Contractor Number of Diamond Wall System 1034

This is to certify that the exterior coating system on the building exterior at the above address has been installed in accordance with the evaluation report specified above and the manufacturer's instructions.

16 July 01
Date

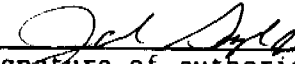
Signature of authorized representative of
Plastering Contractor

This installation card must be presented to the building inspector after completion of work and before final inspection.



WesPac

Insulation
a MASCO Company



809 North Market Blvd., Ste. 11 • Sacramento, CA 95834
(916) 927-7149 • Fax (916) 927-4257
Lic. #487478

Installed Insulation Certificate

We certify that the building insulation listed herein is installed in conformance with current energy conservation regulations, California Administrative Code, Title 24, State of California

R FACTOR	AREA	TYPE	INCHES/DAGS (BLOWN)
R30	CEILING AREA	FIBERGLASS BLOWN	12" / 34 DAGS
R30	CEILING AREA	FIBERGLASS BATT	10.25"
R13	EXT. WALL AREA	FIBERGLASS BATT	3.5"

Certified by *Jimmy Finney*
Title Secretary

WOOD SIDE HOMES WESTLAKE LOT
WOODSIDE HOMES/1
Address or Lot Number
06/08/01
Date Installed
Phase #

WesPac
Attn:

Lot 1- 4672 Westlake PK

Install all Interior doors and Hardware
unscrew all windows

Install all window screens

Hook up all Appliances

Remove trap fence on front

Install fence on sides

take toilet seat covers off

Remove stat cover

Disconnect music

flip over Hardware on fire door

turn all water on

Return all lites to operate Bx switch

RESIDENTIAL SUBDIVISION BUILDING PERMIT APPLICATION

Project Address: 4672 Westlake Parkway Assessor Parcel # 225-1550-032
Lot Number: 1 Subdivision Westborough-Village 1

OWNER INFORMATION: 0103541

Legal Property Owner: Woodside Westlake, Inc. Phone# (916) 608-9600
Owner Address: 15 Plaza Drive #102 City Folsom State CA Zip 95630

CONTRACTOR INFORMATION:

Contractor: Woodside Homes of CA, Inc. Lic. # 744379B Phone # 608-9600 Fax 608-9940

PROJECT INFORMATION:

Land Use Zone R1A Occupancy Group R3 Construction Type VN Fed Code 1A
No. of Stories: 1 No. of Rooms: _____ Street Width: _____
1st Floor Area 1800 2nd Floor Area _____ Basement N/A Roof Material Concrete Tile
AREA IN SQUARE FOOT OF:
Dwelling/Living 1800
Garage/Storage 435
Decks/Balconies N/A
Carpports N/A
SCOPE OF WORK: New Residential Construction

FOR OFFICE USE ONLY

- Information Above Complete
- Violation Files Checked
- Standard Setbacks
- County Sewer
- AR Flood Waiver Required
- Flood Elevation Certificate Required
- Water Development Infill Area
- Planning Approval
- Design Review Approval
- Special Fee Districts Apply:

THE FOLLOWING MUST BE PROVIDED IN ORDER TO SUBMIT FOR PERMIT

- 2 COMPLETE PLOT PLANS, LEGIBLE & DRAWN TO SCALE
- 11 X 17 COPY OF FLOOR PLAN WITH FOLLOWING INFORMATION
 - a) Assessor's Parcel Number
 - b) New Floor Area
 - c) Owners Name
 - d) Project Address

SCALE: 1"=20'

This set of plans and specifications is intended to be kept on the job at all times and the contractor shall be responsible for making any changes or corrections to the plans. No part of these plans shall be used for any other project without the written permission of the City of Sacramento. The contractor shall be responsible for obtaining all necessary permits and for compliance with all applicable laws, rules and regulations of any City, State or Federal agency.

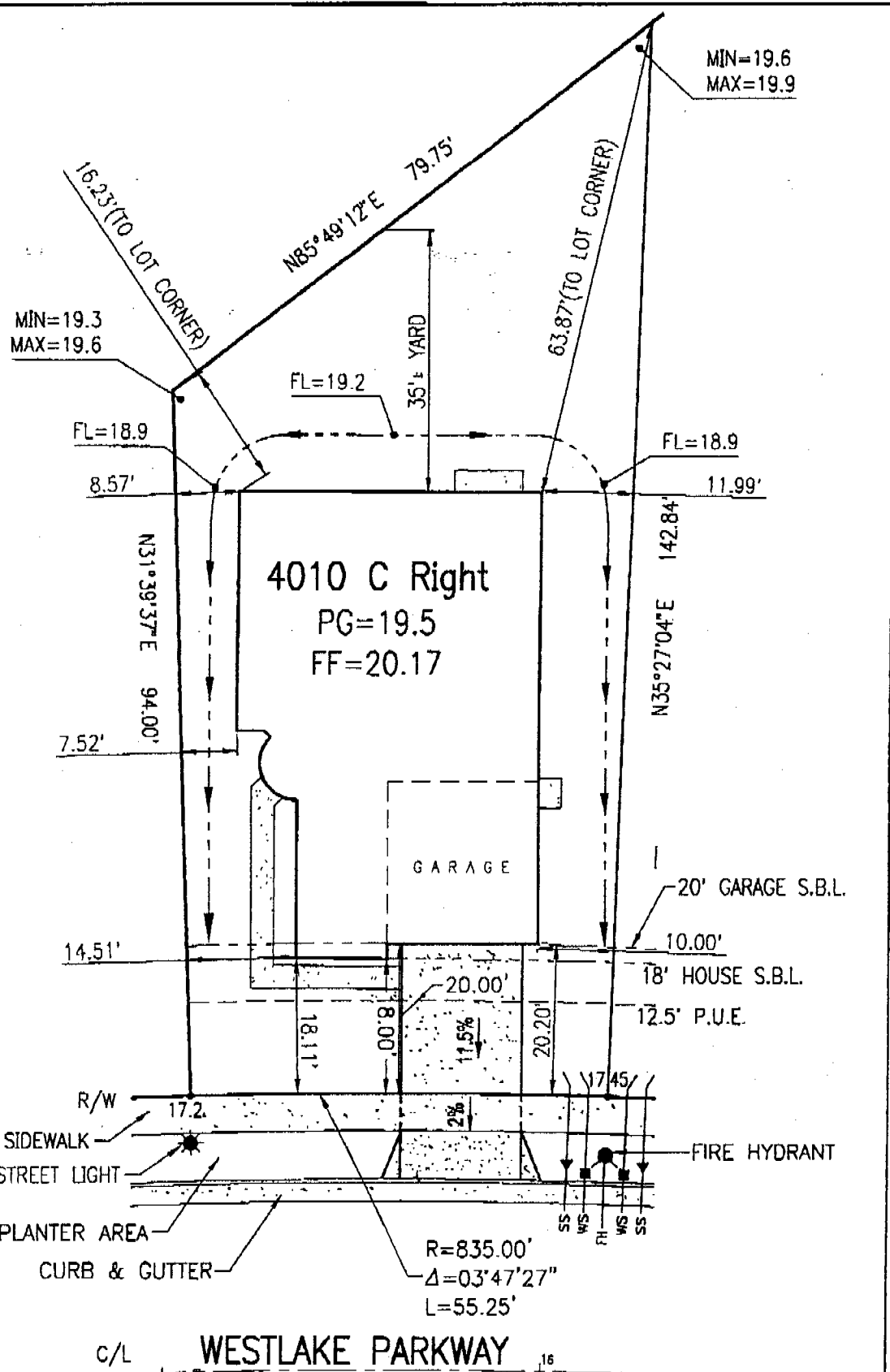
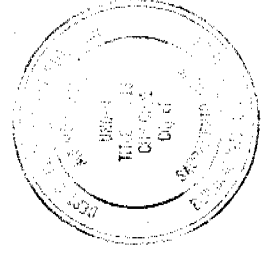

PLAN 4010
 1-STORY
 2-CAR GARAGE
 LIVABLE AREA=1800 s.f.
 GARAGE AREA= 435 s.f.
 FOOTPRINT = 2236 s.f.

C/L WESTLAKE PARKWAY

Plot Plan for Lot 1 of 81

WOODSIDE HOMES OF CA, INC.

Westborough ~ Village 1 , Phase 1

ADDRESS: 4672 WESTLAKE PARKWAY
 CITY OF SACRAMENTO , NATOMAS
 SACRAMENTO COUNTY , CALIFORNIA

A.P.N.: 225-1550-032
 Lot Area: 6964 s.f.
 Lot Coverage: 32.1%

SCALE : 1"=20'
 Date: Jan. 25, 2001
 Revised: 01-30-01
 Drawn By: T.D.B.
 Job No: 00-11-132