

CITY OF SACRAMENTO

1231 I Street, Sacramento, CA 95814

Permit No: 0004506

Insp Area: 2

Site Address: 8127 PAVIA WY SAC

Parcel No: 117-0420-027

LOT 27 VALLEY HI 18

Sub-Type: NSFR

Housing (Y/N): N

CONTRACTOR

FEITSER CONST
6060 SUNRISE VISTA #1300
CITRUS HEIGHTS CA 95610

OWNER

MORELLI DENNIS F/KARYN J
8127 PAVIA WY
SACRAMENTO CA 95823

ARCHITECT

Nature of Work: NSFR MP1144 1 STORY 6 RMS

CONSTRUCTION LENDING AGENCY: I hereby affirm under penalty of perjury that there is a construction lending agency for the performance of the work for which this permit is issued (Sec. 3097, Civ. C).

Lender's Name _____ Lender's Address _____

LICENSED CONTRACTORS DECLARATION: I hereby affirm under penalty of perjury that I am licensed under provisions of Chapter 9 (commencing with section 7000) of Division 3 of the Business and Professions Code and my license is in full force and effect.

License Class _____ License Number _____ Date _____ Contractor Signature _____

OWNER-BUILDER DECLARATION: I hereby affirm under penalty of perjury that I am exempt from the contractors License Law for the following reason (Sec. 7031.5, Business and Professions Code; any city or county which requires a permit to construct, alter, improve, demolish, or repair any structure, prior to its issuance, also requires the applicant for such permit to file a signed statement that he or she is licensed pursuant to the provisions of the Contractors License Law (Chapter 9 (commencing with Section 7000) of Division 8 of the Business and Professions Code) or that he or she is exempt therefrom and the basis for the alleged exemption. Any violation of Section 7031.5 by any applicant for a permit subjects the applicant to a civil penalty of not more than five hundred dollars (\$500.00):

____ I, as a owner of the property, or my employees with wages as their sole compensation, will do the work, and the structure is not intended or offered for sale (Sec. 7044, Business and Professional Code: The Contractors License Law does not apply to an owner of property who builds or improves thereon, and who does such work himself or herself or through his/her own employees, provided that such improvements are not intended or offered for sale. If, however, the building or improvement is sold within one year of completion, the owner-builder will have the burden of proving that he/she did not build or improve for the purpose of sale.)

I, as owner of the property, am exclusively contracting with licensed contractors to construct the project (Sec. 7044, Business and Professions Code: The Contractors License Law does not apply to an owner of property who builds or improves thereon, and who contracts for such projects with a contractor(s) licensed pursuant to the Contractors License Law).

I am exempt under Sec. _____ B & PC for this reason: _____

Date MAY 8, 2000 Owner Signature PAVIA Homes Inc Dennis Morelli

IN ISSUING THIS BUILDING PERMIT, the applicant represents, and the city relies on the representation of the applicant, that the applicant verified all measurements and locations shown on the application or accompanying drawings and that the improvement to be constructed does not violate any law or private agreement relating to permissible or prohibited locations for such improvements. This building permit does not authorize any illegal location of any improvement or the violation of any private agreement relating to location of improvements.

I certify that I have read this application and state that all information is correct. I agree to comply with all city and county ordinances and state laws relating to building construction and hereby authorize representative(s) of this city to enter upon the abovementioned property for inspection purposes.

Date MAY 8, 2000 Applicant/Agent Signature PAVIA Homes Inc Dennis Morelli

WORKER'S COMPENSATION DECLARATION: I hereby affirm under penalty of perjury one of the following declarations:

____ I have and will maintain a certificate of consent to self-insure for workers' compensation as provided for by Section 3700 of the Labor Code, for the performance of work for which the permit is issued.

____ I have and will maintain workers' compensation insurance, as required by Section 3700 of the Labor Code, for the performance of the work for which this permit is issued. My workers' compensation insurance carrier and policy number are:

Carrier FREEMONT COMPENSATION Policy Number SB50-0199-17689 Exp Date 01/01/2001

(This section need not be completed if the permit is for \$100 or less) I certify that in the performance of the work for which this permit is issued, I shall not employ any person in any manner so as to become subject to the workers' compensation laws of California and agree that if I should become subject to the workers' compensation provisions of Section 3700 of the Labor Code, I shall forthwith comply with those provisions.

Date MAY 8, 2000 Applicant Signature PAVIA Homes Inc Dennis Morelli

WARNING: FAILURE TO SECURE WORKER'S COMPENSATION COVERAGE IS UNLAWFUL AND SHALL SUBJECT AN EMPLOYER TO CRIMINAL PENALTIES AND CIVIL FINES UP TO ONE HUNDRED THOUSAND DOLLARS (\$100,000) IN ADDITION TO THE COST OF COMPENSATION, DAMAGES AS PROVIDED FOR IN SECTION 3706 OF THE LABOR CODE, INTEREST AND ATTORNEY'S FEE.

THIS PERMIT SHALL EXPIRE BY LIMITATION IF WORK IS NOT COMMENCED WITHIN 180 DAYS.

WES PAC

INSULATION, INC.

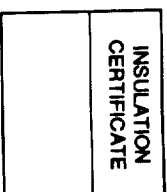

THIS IS TO CERTIFY THAT INSULATION HAS BEEN INSTALLED IN CONFORMANCE WITH CURRENT ENERGY REGULATIONS, CALIFORNIA ADMINISTRATIVE CODE, TITLE 24, STATE OF CALIFORNIA, IN THE BUILDING LOCATED AT:

LOT # _____ TRACT # _____

STREET 8127 Pavia Way CITY Sacramento

EXTERIOR WALLS:

MANUFACTURER JM THICKNESS/TYPE 3 1/2 R- VALUE 13

CEILINGS:

BATTS: MANUFACTURER JM THICKNESS/TYPE 6 R- VALUE 19

BLOWN IN: MANUFACTURER Everbloss THICKNESS/TYPE 8.1 R- VALUE 30

SQUARE FOOTAGE COVERED 1010 NUMBER OF BAGS USED 34

FLOORS:

MANUFACTURER _____ THICKNESS/TYPE _____ R- VALUE _____

SLAB ON GRADE:

MANUFACTURER _____ THICKNESS/TYPE _____ R- VALUE _____

WIDTH OF INSULATION _____ INCHES

FOUNDATION WALLS:

MANUFACTURER _____ THICKNESS/TYPE _____ R- VALUE _____

GENERAL CONTRACTOR _____

CALIFORNIA CONTRACTORS LICENSE # _____

DATE _____

SIGNATURE

TITLE

INSULATION CONTRACTOR **WES PAC INSULATION, INC.**

CALIFORNIA CONTRACTORS LICENSE #

#487478

DATE

9/25/10

Rita Bauer
SIGNATURE

Office Lead
TITLE

Certification of Compliance

School District Development Fees

(Print or Type) If Printing, press hard for four copies

PART I To be completed by the APPLICANT (MUST BE FILLED OUT COMPLETELY)

OWNER'S NAME DENNIS F. Monelli
 OWNER'S ADDRESS PO Box 245863 Sacramento, CA, 95824
 PROJECT ADDRESS 8124, 8127, 8132, 8133, 8138, 8139, 8144, 8145, 8150, 8151 (PAVIA WAY)
 PARCEL NUMBER 117-042-012 Thru 16 And 027-TRAY 031 LOT NO. 013, 13, 14, 15 + 16
 SUBDIVISION NAME VALLEY HI Unit 18 027 23, 29, 30, 31
 NUMBER OF UNITS 10

Upon payment of the fees listed below, a 90-day approval period commences upon which the applicant paying the fees may protest such fees. Any failure to file such protest within the 90-day period shall result in forfeiture of any rights to challenge such fees, through litigation or otherwise.

APPLICANT'S SIGNATURE Dennis F. Monelli
 TITLE OF APPLICANT OWNER
 DATE 4-29-2000 PHONE NUMBER 1-916-687-7526

PART II To be completed by BUILDING DEPARTMENT

PLAN IDENTIFICATION NUMBER _____
 BUILDING TYPE
 RESIDENTIAL () APARTMENT/CONDOMINIUM () COMMERCIAL/INDUSTRIAL ()
 SQUARE FEET OF CHARGEABLE BUILDING AREA _____
 SIGNATURE _____ DATE _____
 TITLE _____

PART III To be completed by SCHOOL DISTRICT

SCHOOL DISTRICT EGUSD
 DISTRICT CERTIFICATION NO. 24922
 EXEMPT _____ COMMENTS _____

RESIDENTIAL/APT/CONDO	SQ FT X \$	<u>0</u>	= \$	<u>0</u>
COMMERCIAL/INDUSTRIAL	SQ FT X \$		= \$	
OTHER FEE TYPE	SQ FT X \$		= \$	
TOTAL FEES COLLECTED		<u>0</u>	= \$	<u>0</u>

This Certification covers only the amount of square footage indicated above. Any additions or corrections to the square footage for this project will require an amendment to the Certificate of Compliance.

Previously paid on June 25, 1985 (See Attached)
 As the authorized school district official, I hereby certify that the requirements of Government Code Section 65995 and any other authorized requirements have been complied with by the above signed applicant.

AUTHORIZED SCHOOL DISTRICT OFFICIAL

SIGNATURE [Signature] **PAID**
 TITLE [Signature] **FEB 29 2000**
 DATE 2-29-00

Original: School District 1st copy: School District 2nd copy: Building Department 3rd copy: Applicant

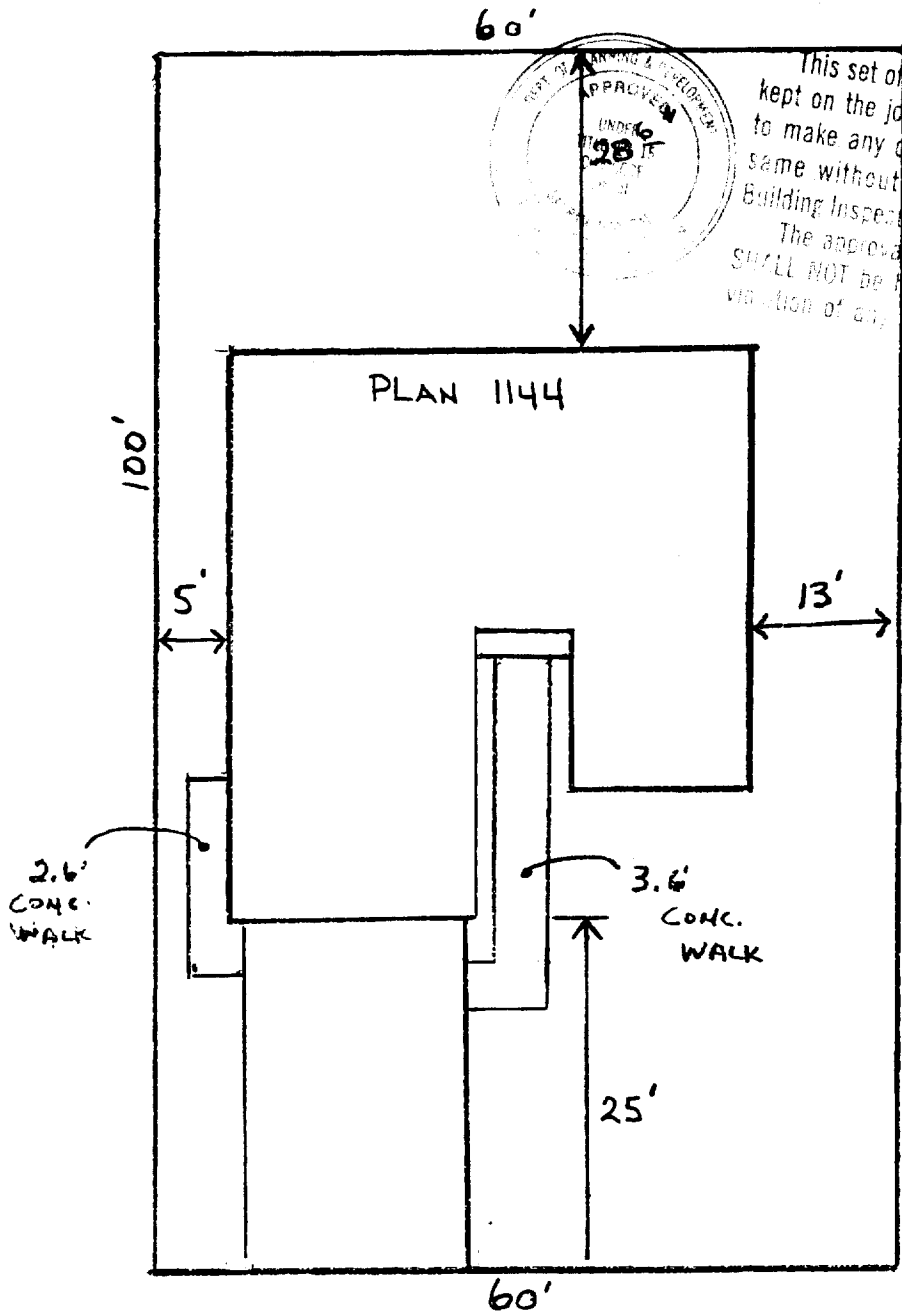

Site PLAN

APN: 117-0420-027

8127 PAVIA WAY
 Valley Hi Unit No. 18,
 Scale 1" = 16'

CENTER LINE (PAVIA WAY) street