

CITY OF SACRAMENTO
1231 I Street, Sacramento, CA 95814

Permit No: 0007208
Insp Area: 4

Site Address: 2420 WATERS EDGE WY SAC
Parcel No: 274-0510-009 LOT 9 RIVERWALK

Sub-Type: NSFR
Housing (Y/N): N

CONTRACTOR
MYERS HOMES INC.
3300 FITZGERALD RD.
RANCHO CORDOVA CA. 95742

OWNER

ARCHITECT

Nature of Work: NSFR MP2421 8 RMS 1 STORY

CONSTRUCTION LENDING AGENCY: I hereby affirm under penalty of perjury that there is a construction lending agency for the performance of the work for which this permit is issued (Sec. 3097, Civ. C).

Lender's Name _____ Lender's Address _____

LICENSED CONTRACTORS DECLARATION: I hereby affirm under penalty of perjury that I am licensed under provisions of Chapter 9 (commencing with section 7000) of Division 3 of the Business and Professions Code and my license is in full force and effect.

License Class B License Number 744473 Date 7-6-00 Contractor Signature [Signature]

OWNER-BUILDER DECLARATION: I hereby affirm under penalty of perjury that I am exempt from the contractors License Law for the following reason (Sec. 7031.5, Business and Professions Code; any city or county which requires a permit to construct, alter, improve, demolish, or repair any structure, prior to its issuance, also requires the applicant for such permit to file a signed statement that he or she is licensed pursuant to the provisions of the Contractors License Law (Chapter 9 (commencing with Section 7000) of Division 8 of the Business and Professions Code) or that he or she is exempt therefrom and the basis for the alleged exemption. Any violation of Section 7031.5 by any applicant for a permit subjects the applicant to a civil penalty of not more than five hundred dollars (\$500.00);

____ I, as a owner of the property, or my employees with wages as their sole compensation, will do the work, and the structure is not intended or offered for sale (Sec. 7044, Business and Professional Code: The Contractors License Law does not apply to an owner of property who builds or improves thereon, and who does such work himself or herself or through his/her own employees, provided that such improvements are not intended or offered for sale. If, however, the building or improvement is sold within one year of completion, the owner-builder will have the burden of proving that he/she did not build or improve for the purpose of sale.)

____ I, as owner of the property, am exclusively contracting with licensed contractors to construct the project (Sec. 7044, Business and Professions Code: The Contractors License Law does not apply to an owner of property who builds or improves thereon, and who contracts for such projects with a contractor(s) licensed pursuant to the Contractors License Law).

____ I am exempt under Sec. _____ B & PC for this reason: _____

Date _____ Owner Signature _____

IN ISSUING THIS BUILDING PERMIT, the applicant represents, and the city relies on the representation of the applicant, that the applicant verified all measurements and locations shown on the application or accompanying drawings and that the improvement to be constructed does not violate any law or private agreement relating to permissible or prohibited locations for such improvements. This building permit does not authorize any illegal location of any improvement or the violation of any private agreement relating to location of improvements.

I certify that I have read this application and state that all information is correct. I agree to comply with all city and county ordinances and state laws relating to building construction and hereby authorize representative(s) of this city to enter upon the abovementioned property for inspection purposes.

Date 7-6-00 Applicant/Agent Signature [Signature]

WORKER'S COMPENSATION DECLARATION: I hereby affirm under penalty of perjury one of the following declarations:

____ I have and will maintain a certificate of consent to self-insure for workers' compensation as provided for by Section 3700 of the Labor Code, for the performance of work for which the permit is issued.

____ I have and will maintain workers' compensation insurance, as required by Section 3700 of the Labor Code, for the performance of the work for which this permit is issued. My workers' compensation insurance carrier and policy number are:

Carrier RELIANCE NAT INS CO Policy Number NWAO154613-01 Exp Date 04/01/2001

____ (This section need not be completed if the permit is for \$100 or less) I certify that in the performance of the work for which this permit is issued, I shall not employ any person in any manner so as to become subject to the workers' compensation laws of California and agree that if I should become subject to the workers' compensation provisions of Section 3700 of the Labor Code, I shall forthwith comply with those provisions.

Date 7-6-00 Applicant/Agent Signature [Signature]

WARNING: FAILURE TO SECURE WORKERS' COMPENSATION COVERAGE IS UNLAWFUL AND SHALL SUBJECT AN EMPLOYER TO CRIMINAL PENALTIES AND CIVIL FINES UP TO ONE HUNDRED THOUSAND DOLLARS (\$100,000) IN ADDITION TO THE COST OF COMPENSATION, DAMAGES AS PROVIDED FOR IN SECTION 3706 OF THE LABOR CODE, INTEREST AND ATTORNEY'S FEE.

THIS PERMIT SHALL EXPIRE BY LIMITATION IF WORK IS NOT COMMENCED WITHIN 180 DAYS.

Natomas Unified School District

1515 Sports Drive, #1 • Sacramento, CA 95834-1905

Phone 916/641-3300 • Fax 916/928-1629

CERTIFICATION OF COMPLIANCE

SCHOOL DISTRICT DEVELOPMENT FEES

Property Owner's Name <u>Myers Homes of California, LLC</u>	
Owner's Address <u>3480 Sunrise Blvd. Suite 200, Rancho Cordova, CA 95742</u>	
Project Address <u>2420 Waters Edge Way, Sacramento, CA 95833</u>	
Parcel Number <u>274-0510-009</u>	
Subdivision Name <u>Riverwalk</u>	
Number of Units <u>1</u>	
Print Applicant's Name <u>Russ Sherman</u>	Applicant's Signature <u>R Sherman</u>
Title of Applicant <u>Project Coordinator</u>	Telephone Number <u>916-851-0530</u>
Date <u>6/29/00</u>	
PART II: TO BE COMPLETED BY BUILDING DEPARTMENT	
Plan Identification Number <u>5</u>	
Building Type (Check One) <input checked="" type="checkbox"/> Residential <input type="checkbox"/> Apartment/Condominium <input type="checkbox"/> Commercial/Industrial	
Square Feet of Chargeable Building Area <u>2421</u>	
Signature <u>[Signature]</u>	
Title <u>RI</u>	Date <u>7-5-00</u>
PART III: TO BE COMPLETED BY NATOMAS UNIFIED SCHOOL DISTRICT	
District Certification Number <u>01-50</u>	
Fees Collected:	
Residential: <u>2421</u> Sq. Ft. X \$ <u>3.25</u>	= \$ <u>7868.25</u>
Apartment/Condominium: _____ Sq. Ft. X \$ _____	= \$ _____
Commercial/Industrial: _____ Sq. Ft. X \$ _____	= \$ _____
<p>NOTICE TO APPLICANT: Pursuant to government code section 66020 (d), this will serve to notify you that the 90-day approval period in which you may protest the fees, or other payment identified above, will begin to run on the date in which the building or installation permit for this project is issued, or on which they are paid to the District, or to another public entity authorized to collect them on behalf of the District, whichever is earlier.</p>	
Applicant Signature: <u>[Signature]</u>	Date: <u>7/5/00</u>

This certification covers only the amount of square footage indicated above. Any additions or corrections to the square footage for this project will require an amendment to the Certificate of Compliance.

As the authorize Natomas Unified School District official, I hereby certify that the requirements of Government Code Section 95995 have been complied with by the above signed applicant.

SIGNATURE: [Signature] DATE: [Redacted]
 TITLE: Deputy Director

COUNTY SANITATION DISTRICT NO. 1
 SACRAMENTO REGIONAL COUNTY SANITATION DISTRICT
SEWER IMPACT FEE
 PERMIT AND CALCULATION SHEET

APPLICATION NO:	BLDG PERMIT NO: <i>City</i>
GENERAL INFORMATION	THIS PERMIT GOOD ONLY WHEN VALIDATED BY THE CASHIER <i>HW 261262 75.00</i>
	THIS PERMIT TO CONNECT EXPIRES ONE YEAR FROM DATE OF ISSUANCE

FEE CALCULATION		BUILDING USE	
INSPECTION		RESIDENTIAL SF <input checked="" type="checkbox"/>	MF <input type="checkbox"/>
CSD-1	<i>473.00</i>	COMMERCIAL USE	UNITS
SRCSD	<i>2,404.00</i>		
CONSTRUCTION			
IN-LIEU			
TOTAL FEE	<i>2,877.00</i>		

APN: *274-0510-009*

DESCRIPTION/
SUBDIVISION *Riverwalk* LOT: *9*

PROPERTY ADDRESS *2420 Waters Edge Way*

OWNER *Myers Homes of California, LLC*

MAILING ADDRESS *3480 Sunrise Blvd. Suite 200*

CITY-STATE-ZIP *Rancho Cordova CA 95742* PHONE *916-851-0520*

ADDITIONAL FEES MAY BE DUE IF CHANGES IN USE INCREASE SEWER IMPACT.

R. Swartz

APPLICANT SIGNATURE

CONSOLIDATED UTILITY BILLING USE ONLY

ACCT _____ INPUT _____ START _____

INSPECTOR'S COPY

CERTIFICATION OF INSULATION

ADDRESS OR TRACT

SACRAMENTO INSULATION CONTRACTORS

MEYER

101-9

- P.O. BOX 854, WEST SACRAMENTO, CA 95691 LIC. #202026
- 1309 MELODY ROAD, MARYSVILLE, CA 95901 LIC. #202026
- P.O. BOX 9651, FRESNO, CA 93793-9651 LIC. #202026
- P.O. BOX 1631, RENO, NV 89505 LIC. #10675
- 3326 A PONDEROSA WAY, LAS VEGAS, NV 89118 LIC. #10675

DATE INSULATION COMPLETED

RIVER WALK

PART I GENERAL

PART II AREAS INSULATED

WALLS		CEILINGS			FLOORS	
SQUARE FEET		SQUARE FEET			SQUARE FEET	
TYPE OF INSULATION		TYPE OF INSULATION			TYPE OF INSULATION	
MATERIAL: FIBERGLASS		MATERIAL: FIBERGLASS			MATERIAL: FIBERGLASS	
FORM: BATTS		FORM: BATTS & BLOW			FORM: BATTS	
MANUFACTURER'S PRODUCT ID		MANUFACTURER'S PRODUCT ID			MANUFACTURER'S PRODUCT ID	
MANUFACTURER		MANUFACTURER			MANUFACTURER	
OCF		OCF			OCF	
R-VALUE INSTALLED	APPLIED THICKNESS	R-VALUE INSTALLED	APPLIED THICKNESS	MIN. INSTALLED WEIGHT PER SQUARE FOOT	R-VALUE INSTALLED	APPLIED THICKNESS
13	3 5/8"	30 30	9" 12"			
KNEE WALLS IF R-VALUE IS OTHER THAN WALLS ABOVE						
MATERIAL: FIBERGLASS		FORM: BATTS		R-VALUE: 19	MANUFACTURER: OCF	
AIR INFILTRATION SEALANT						
MATERIAL: FOAM				MANUFACTURER: W R GRACE		

THIS IS TO CERTIFY THAT INSULATION AND/OR SEALANT HAS BEEN INSTALLED IN CONFORMANCE WITH APPLICABLE CODES, MATERIAL STANDARDS AND REGULATIONS.

SIGNATURE - INSULATION CONTRACTOR <i>Bill Hilg</i>	TITLE MANAGER	DATE 9-28-00
SIGNATURE - GENERAL CONTRACTOR	TITLE	DATE

REMARKS

OMEGA PRODUCTS CORP.

GLASS BLOCK INSULATING STUD SYSTEM

JOB ADDRESS:

ICED Report #4804

LOT 9

2420 WATERS EDGE WAY

Date of Job Completion 9-29-00

PLASTERING CONTRACTOR:

Name: Mescal Plastering

Address: Box 355 Lincoln Ca 95648

Telephone No: (916) 645-7337

Contractor Number of Stained Wall System 2130

This is to certify that the exterior coating system on the building exterior at the above address has been installed in accordance with the evaluation report specified above and the manufacturer's instructions.

9/29/00
Date

Jim Austin
Signature of authorized representative of
Plastering Contractor

This installation card must be presented to the building inspector after completion of work and before final inspection.

PLAN 5 Lot 4

RESIDENTIAL BUILDING PERMIT APPLICATION

- New Construction Addition Remodels Other

Project Address: 2420 Waters Edge Way Assessor Parcel # 274-0510-009

OWNER INFORMATION:

Legal Property Owner: MYERS HOMES OF CALIFORNIA, LLC Phone # 916-851-0530
 Owner Address: 3300 FITZGERALD RD City RANCHO CORONA State CA Zip 95742

CONTRACTOR INFORMATION:

Contractor: MYERS HOMES, INC. Lic. # 744473 Phone # 916-851-0530 Fax # 916-851-0535

PROJECT INFORMATION:

Land Use Zone R-1A PUD Occupancy Group R-3 Construction Type YN Fed Code LA
 No. of stories: 1 No. of rooms: 13 Street width: 50 FT
 1st Floor Area 2421 2nd Floor Area N/A Basement N/A Roof Material TILE

AREA IN SQUARE FOOT OF:

	EXISTING	NEW
Dwelling/Living		<u>2421</u>
Garage/Storage		<u>609</u>
Decks/Balconies		<u>192</u> COVERED FRONT PORCH
Carports		

SCOPE OF WORK: NEW CONSTRUCTION OF SINGLE FAMILY RESIDENCE, RIVERWALK SERIES II, PLAN 5/2421 # IN MASTER PLAN COMMUNITY 199-075

PT 7-005 AMENDED

FOR OFFICE USE ONLY:

- | | | |
|---|---|--|
| <input type="checkbox"/> Information above complete | <input type="checkbox"/> AR Flood Waiver required | <input type="checkbox"/> Planning Approval |
| <input type="checkbox"/> Violation files checked | <input type="checkbox"/> Flood Elevation Certificate Required | <input type="checkbox"/> Design Review Approval |
| <input type="checkbox"/> Standard setbacks | <input type="checkbox"/> Water Development Infill Area | <input type="checkbox"/> Special Fee Districts Apply : |
| <input type="checkbox"/> County Sewer | | |

NEW STRUCTURES & ADDITIONS

THE FOLLOWING MUST BE PROVIDED IN ORDER TO SUBMIT FOR PLAN REVIEW

- 2 COMPLETE PLOT 8.5" x 11" DRAINAGE INFO LEGIBLE & DRAWN TO SCALE
 3 SETS IF PROJECT IS IN A DESIGN REVIEW AREA
 Plans to include: site plan, floor plan, elevations, roof/ceiling plan, foundation and structural framing details, and structural calculations for non-conforming structures.

- Title 24 Energy Compliance documentation 11" x 17" copy of floor plan for County Assessor
 Grading and Erosion Control Questionnaire Plan Review Fees

Date: _____ Received by: (staff) _____

ACTIVITY/PERMIT #

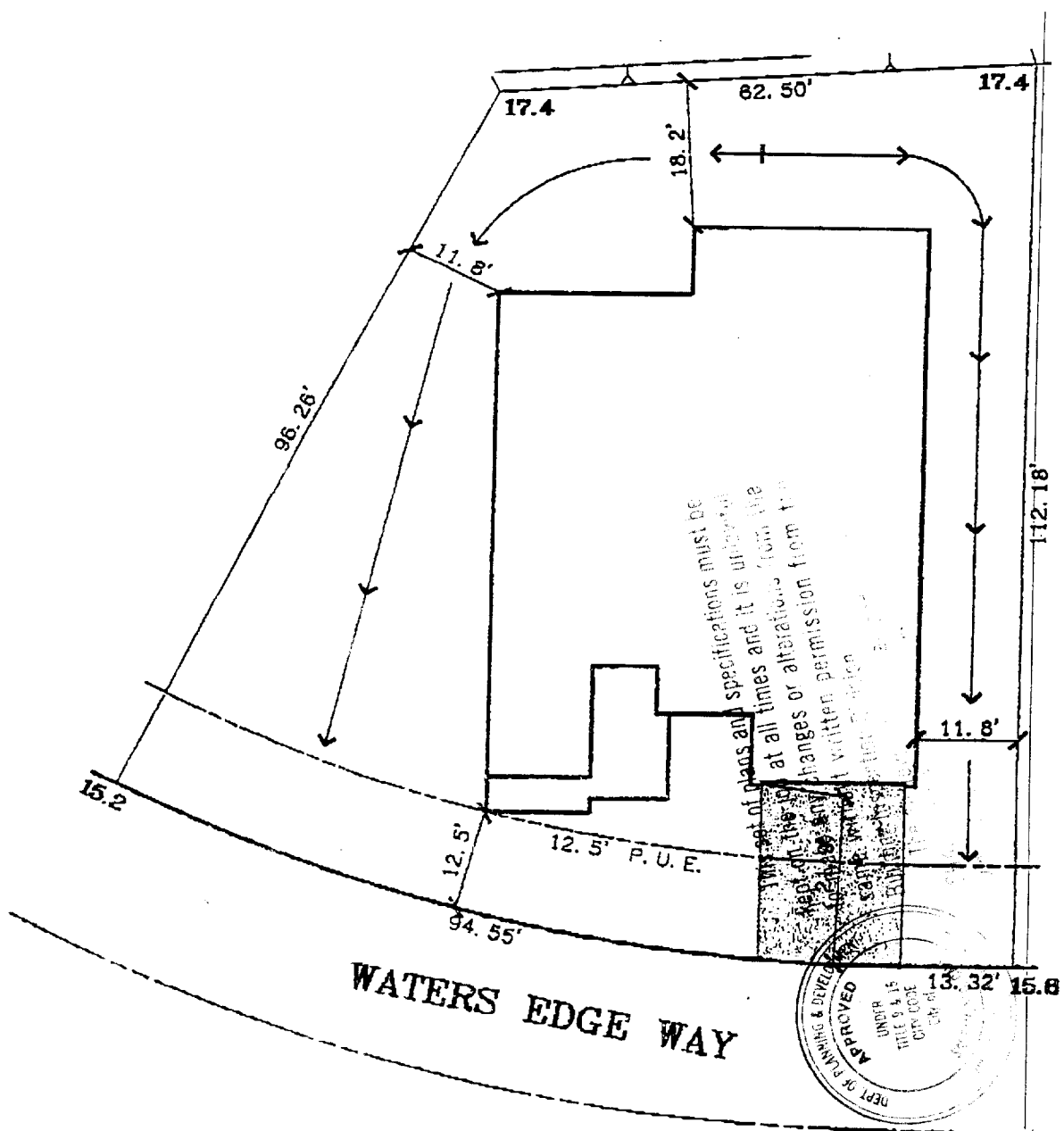

DATE: 6-12-00 REV
 A.P.N.:
 ADDRESS: 2420 WATERS EDGE WAY

LOT AREA: 8,992 SF
 LOT COVERAGE: 34%

The Spink Corporation
 2590 VENTURE OAKS WAY
 SACRAMENTO, CA 95833
 PH:(916)925-5550 FAX:(916)921-9274

RIVERWALK
 UNIT NO. 1
 LOT 9
 PLAN 2421B

RIVERWALK
 CITY OF SACRAMENTO, CA.
 CLIENT: MYERS HOMES
 JOB NO.: 1456-001