

CITY OF SACRAMENTO
1231 I Street, Sacramento, CA 95814

Permit No: 0103956

Insp Area: 4

Site Address: 480 EASTBROOK WY SAC
Parcel No: 201-0420-019 NORTHBR 3-2 LOT 19

Sub-Type: NSFR
Housing (Y/N): N

ARCHITECT

CONTRACTOR

1'S HOME
2366 GOLD MEADOW DR
SFE # 10095670

OWNER

Nature of Work: MP 1633 1 STORY 6 ROOM SFR

CONSTRUCTION LENDING AGENCY: I hereby affirm under penalty of perjury that there is a construction lending agency for the performance of the work for which this permit is issued (Sec. 3097, Civ. Code).

Lender's Name _____ Lender's Address _____

LICENSED CONTRACTORS DECLARATION: I hereby affirm under penalty of perjury that I am licensed under provisions of Chapter 9 commencing with section 7000 of Division 3 of the Business and Professions Code and my license is in full force and effect.

License Class B License Number 451239 Date 4/13/01 Contractor Signature Don McCloskey

OWNER-BUILDER DECLARATION: I hereby affirm under penalty of perjury that I am exempt from the contractors License Law for the following reason (Sec. 7031.5, Business and Professions Code; any city or county which requires a permit to construct, alter, improve, demolish, or repair any structure, prior to its issuance, also requires the applicant for such permit to file a signed statement that he or she is licensed pursuant to the provisions of the Contractors License Law (Chapter 9 commencing with Section 7000) of Division 8 of the Business and Professions Code) or that he or she is exempt therefrom and the basis for the alleged exemption. Any violation of Section 7031.5 by any applicant for a permit subjects the applicant to a civil penalty of not more than five hundred dollars (\$500.00).

I, as a owner of the property, or my employees with wages as their sole compensation, will do the work, and the structure is not intended or offered for sale (Sec. 7044, Business and Professional Code). The Contractors License Law does not apply to an owner of property who builds or improves thereon, and who does such work himself or herself or through his/her own employees, provided that such improvements are not intended or offered for sale. If, however, the building or improvement is sold within one year of completion, the owner-builder will have the burden of proving that he/she did not build or improve for the purpose of sale.

I, as owner of the property, am exclusively contracting with licensed contractors to construct the project (Sec. 7044, Business and Professions Code). The Contractors License Law does not apply to an owner of property who builds or improves thereon, and who contracts for such projects with a contractor(s) licensed pursuant to the Contractors License Law.

I am exempt under Sec. _____ B & PC for this reason: _____

Date _____ Owner Signature _____

IN ISSUING THIS BUILDING PERMIT, the applicant represents, and the city relies on the representation of the applicant, that the applicant verified all measurements and locations shown on the application or accompanying drawings and that the improvement to be constructed does not violate any law or private agreement relating to permissible or prohibited locations for such improvements. This building permit does not authorize any illegal location of any improvement or the violation of any private agreement relating to location of improvements.

I certify that I have read this application and state that all information is correct. I agree to comply with all city and county ordinances and state laws relating to building construction and hereby authorize representative(s) of this city to enter upon the abovementioned property for inspection purposes.

Date 4/13/01 Applicant/Agent Signature Don McCloskey

WORKER'S COMPENSATION DECLARATION: I hereby affirm under penalty of perjury one of the following declarations.

I have and will maintain a certificate of consent to self-insure for workers' compensation as provided for by Section 3700 of the Labor Code, for the performance of work for which the permit is issued.

I have and will maintain workers' compensation insurance, as required by Section 3700 of the Labor Code, for the performance of the work for which this permit is issued. My workers' compensation insurance carrier and policy number are:

Carrier OLD REPUBLIC INS CO Policy Number MWC107468 00 Exp Date 11/01/2001

(This section need not be completed if the permit is for \$100 or less) I certify that in the performance of the work for which this permit is issued, I shall not employ any person in any manner so as to become subject to the workers' compensation laws of California and agree that if I should become subject to the workers' compensation provisions of Section 3700 of the Labor Code, I shall forthwith comply with those provisions.

Date 4/13/01 Applicant Signature Don McCloskey

WARNING: FAILURE TO SECURE WORKER'S COMPENSATION COVERAGE IS UNLAWFUL AND SHALL SUBJECT AN EMPLOYER TO CRIMINAL PENALTIES AND CIVIL FINES UP TO ONE HUNDRED THOUSAND DOLLARS (\$100,000) IN ADDITION TO THE COST OF COMPENSATION, DAMAGES AS PROVIDED FOR IN SECTION 3706 OF THE LABOR CODE, INTEREST AND ATTORNEY'S FEE.

THIS PERMIT SHALL EXPIRE BY LIMITATION IF WORK IS NOT COMMENCED WITHIN 180 DAYS.

RESIDENTIAL SUBDIVISION BUILDING PERMIT APPLICATION

Project Address: 480 Eastbrook Way Assessor Parcel # 201-0420-019
 Lot Number: 19 Subdivision NORTHBOROUGH VILLAGE 3-2

OWNER INFORMATION:

Legal Property Owner: US HOME Phone# 858-3900
 Owner Address: 366 GOLD MEADOW WAY City GOLD RIVER State CA. Zip 95670

CONTRACTOR INFORMATION:

Contractor: US HOME Lic. # 451839 Phone # 858-3900 Fax 858-3925
DON McCLOSKEY 719-9050

PROJECT INFORMATION:

Land Use Zone R1A Occupancy Group R3 Construction Type VN Fed Code 1A
 No. of Stories: 1 No. of Rooms: _____ Street Width: _____
 1st Floor Area 1634 2nd Floor Area _____ Basement _____ Roof Material _____

AREA IN SQUARE FOOT OF:
 Dwelling/Living 1634
 Garage/Storage 427
 Decks/Balconies 25
 Carports _____

CITY OF SACRAMENTO
 PERMIT ASSISTANCE
 MAR 16 2001
RECEIVED

SCOPE OF WORK: _____

FOR OFFICE USE ONLY

- Information Above Complete
- Violation Files Checked
- Standard Setbacks
- County Sewer
- AR Flood Waiver Required
- Flood Elevation Certificate Required
- Water Development Infill Area
- Planning Approval
- Design Review Approval
- Special Fee Districts Apply:

THE FOLLOWING MUST BE PROVIDED IN ORDER TO SUBMIT FOR PERMIT

- 2 COMPLETE PLOT PLANS, LEGIBLE & DRAWN TO SCALE
- 11 X 17 COPY OF FLOOR PLAN WITH FOLLOWING INFORMATION
 - a) Assessor's Parcel Number
 - b) New Floor Area
 - c) Owners Name
 - d) Project Address

Date: _____ Received by: (staff) _____ Permit # _____



WesPac

insulation

a MASCO Company



809 North Market Blvd., Ste. 11 • Sacramento, CA 95834
(916) 927-7149 • Fax (916) 927-4257
Lic. #487478

Installed Insulation Certificate

We certify that the building insulation listed herein is installed in conformance with current energy conservation regulations, California Administrative Code, Title 24, State of California

R FACTOR	AREA	TYPE	INCHES/BAGS (BLOWN)
R38	CEILING AREA	FIBERGLASS BLOW	14.75" / 35 BAGS
R38	CEILING AREA	FIBERGLASS BATT	13"
R19	EXT.WALL AREA 2X6	FIBERGLASS BATT	6.5"
R13	EXT.WALL AREA 2X4	FIBERGLASS BATT	3.5"

Certified by

NATOMAS TRADITIONS

Address of Lot Number USBU, NATOMAS TRADITION/219

Title Secretary

Date Installed 09/26/01

Phase # _____

Lot Area = 5,434 sf
 Building Footprint = 2,060 sf
 Gross Coverage = 37.9%
 Porch Allowance = 0 sf
 Net Coverage = 37.9%

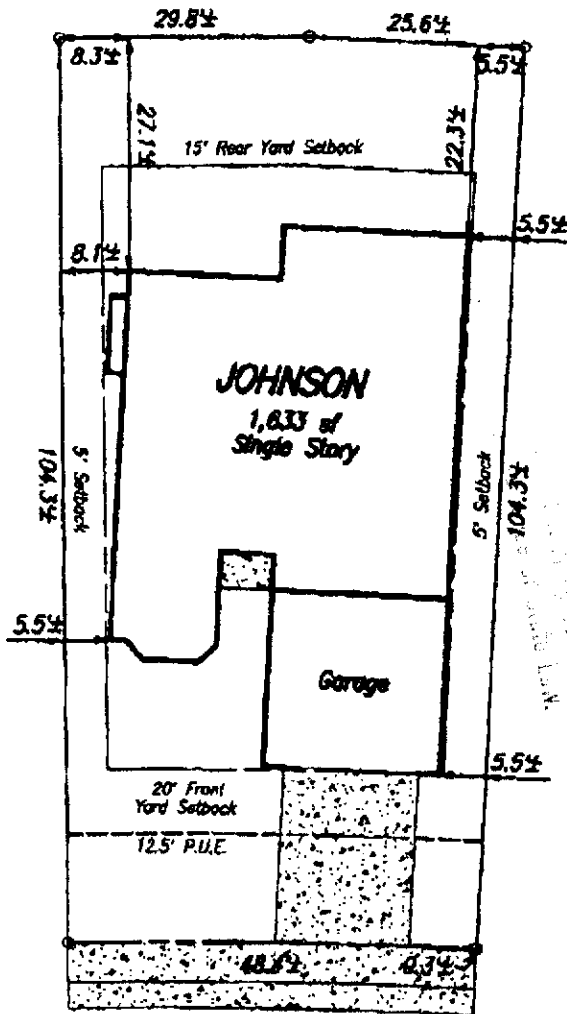
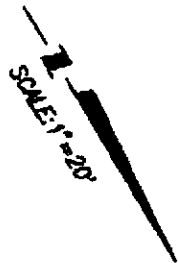

APN:

201-042-019

Address:

480 Eastbrook Way

Owner:

Plan:

1633 R

Plot Plan for Lot 19 for Northborough Village 3-2
 U.S.Home - Northborough - Traditions Series
 City of Sacramento

Note:
 This plot plan has been prepared for the purpose of showing the building foundation relationship to the property line, proposed drainage elevations and direction of flow to conform to local ordinances and for the purpose of building permit issuance. Information shown is approximate except for those setbacks which are minimums required by ordinance. This plot does not reflect as-built conditions which will likely vary from this plan.

**Murray Smith & Associates
 Engineering, Inc.**

3110 Gold Canal Drive
 Rancho Cordova, CA 95670
 Ph.: (916) 635-1511

March 8, 2001

PN: 99003