

CITY OF SACRAMENTO

Permit No: 0008427

1231 I Street, Sacramento, CA 95814

Insp Area: 4

Site Address: 40 OPUS CR SAC

Sub-Type: NSFR

Parcel No: 225-1360-038

LOT 38 GATEWAY WEST 5

Housing (Y/N): N

CONTRACTOR

OWNER

ARCHITECT

BEAZER HOMES
3009 DOUGLAS BL #150
ROSEVILLE CA 95661

Nature of Work: NSFR MP1973 8 RMS 1 STORY

CONSTRUCTION LENDING AGENCY: I hereby affirm under penalty of perjury that there is a construction lending agency for the performance of the work for which this permit is issued (Sec. 3097, Civ. C).

Lender's Name _____ Lender's Address _____

LICENSED CONTRACTORS DECLARATION: I hereby affirm under penalty of perjury that I am licensed under provisions of Chapter 9 commencing with section 7000) of Division 3 of the Business and Professions Code and my license is in full force and effect.

License Class B License Number 724191 Date 8/1/00 Contractor Signature Sheyf Van Maeren

OWNER-BUILDER DECLARATION: I hereby affirm under penalty of perjury that I am exempt from the contractors License Law for the following reason (Sec. 7031.5, Business and Professions Code; any city or county which requires a permit to construct, alter, improve, demolish, or repair any structure, prior to its issuance, also requires the applicant for such permit to file a signed statement that he or she is licensed pursuant to the provisions of the Contractors License Law (Chapter 9 (commencing with Section 7000) of Division 8 of the Business and Professions Code) or that he or she is exempt therefrom and the basis for the alleged exemption. Any violation of Section 7031.5 by any applicant for a permit subjects the applicant to a civil penalty of not more than five hundred dollars (\$500.00).

I, as a owner of the property, or my employees with wages as their sole compensation, will do the work, and the structure is not intended or offered for sale (Sec. 7044, Business and Professional Code: The Contractors License Law does not apply to an owner of property who builds or improves thereon, and who does such work himself or herself or through his/her own employees, provided that such improvements are not intended or offered for sale. If, however, the building or improvement is sold within one year of completion, the owner-builder will have the burden of proving that he/she did not build or improve for the purpose of sale.)

I, as owner of the property, am exclusively contracting with licensed contractors to construct the project (Sec. 7044, Business and Professions Code: The Contractors License Law does not apply to an owner of property who builds or improves thereon, and who contracts for such projects with a contractor(s) licensed pursuant to the Contractors License Law).

I am exempt under Sec. _____ B & PC for this reason: _____
Date _____ Owner Signature _____

IN ISSUING THIS BUILDING PERMIT, the applicant represents, and the city relies on the representation of the applicant, that the applicant verified all measurements and locations shown on the application or accompanying drawings and that the improvement to be constructed does not violate any law or private agreement relating to permissible or prohibited locations for such improvements. This building permit does not authorize any illegal location of any improvement or the violation of any private agreement relating to location of improvements.

I certify that I have read this application and state that all information is correct. I agree to comply with all city and county ordinances and state laws relating to building construction and hereby authorize representative(s) of this city to enter upon the above mentioned property for inspection purposes.

Date 8/1/00 Applicant/Agent Signature Sheyf Van Maeren

WORKER'S COMPENSATION DECLARATION: I hereby affirm under penalty of perjury one of the following declarations:

I have and will maintain a certificate of consent to self-insure for workers' compensation as provided for by Section 3700 of the Labor Code, for the performance of work for which the permit is issued.

I have and will maintain workers' compensation insurance, as required by Section 3700 of the Labor Code, for the performance of the work for which this permit is issued. My workers' compensation insurance carrier and policy number are:

Carrier LIBERTY MUTUAL INS CO. Policy Number WA2-651-004147-080 Exp Date 4/1/2001

(This section need not be completed if the permit is for \$100 or less) I certify that in the performance of the work for which this permit is issued, I shall not employ any person in any manner so as to become subject to the workers' compensation laws of California and agree that if I should become subject to the workers' compensation provisions of Section 3700 of the Labor Code, I shall forthwith comply with those provisions.

Date 8/1/00 Applicant Signature Sheyf Van Maeren

WARNING: FAILURE TO SECURE WORKER'S COMPENSATION COVERAGE IS UNLAWFUL AND SHALL SUBJECT AN EMPLOYER TO CRIMINAL PENALTIES AND CIVIL FINES UP TO ONE HUNDRED THOUSAND DOLLARS (\$100,000) IN ADDITION TO THE COST OF COMPENSATION, DAMAGES AS PROVIDED FOR IN SECTION 3706 OF THE LABOR CODE, INTEREST AND ATTORNEY'S FEE.

THIS PERMIT SHALL EXPIRE BY LIMITATION IF WORK IS NOT COMMENCED WITHIN 180 DAYS.

RESIDENTIAL BUILDING PERMIT APPLICATION

New Construction Addition Remodels Other

Project Address: 40 Opus Circle Assessor Parcel # 225-136-38

OWNER INFORMATION:

Legal Property Owner: Beazer Homes Phone # 773-3888
 Owner Address: 3009 Douglas Blvd #150 City Roseville State CA Zip 95661

CONTRACTOR INFORMATION:

Contractor: Beazer Homes Lic. # 724191 Phone # 773-3888 Fax # 773-0425

PROJECT INFORMATION:

Land Use Zone _____ Occupancy Group _____ Construction Type _____ Fed Code _____

No. of stories: 1 No. of rooms: _____ Street width: _____

1st Floor Area 1973 2nd Floor Area 0 Basement 0 Roof Material _____

AREA IN SQUARE FOOT OF:	EXISTING	NEW
Dwelling/Living	_____	<u>1973</u>
Garage/Storage	_____	<u>674</u>
Decks/Balconies	_____	<u>0</u>
Carports	_____	<u>0</u>

SCOPE OF WORK: New SFD Lot 38

FOR OFFICE USE ONLY

- | | | |
|---|---|--|
| <input type="checkbox"/> Information above complete | <input type="checkbox"/> AR Flood Waiver required | <input type="checkbox"/> Planning Approval |
| <input type="checkbox"/> Violation files checked | <input type="checkbox"/> Flood Elevation Certificate Required | <input type="checkbox"/> Design Review Approval |
| <input type="checkbox"/> Standard setbacks | <input type="checkbox"/> Water Development Infill Area | <input type="checkbox"/> Special Fee Districts Apply : _____ |
| <input type="checkbox"/> County Sewer | | |

NEW STRUCTURES & ADDITIONS

*THE FOLLOWING MUST BE PROVIDED IN ORDER TO SUBMIT FOR PLAN REVIEW

- | | |
|---|---|
| <input type="checkbox"/> 2 COMPLETE PLANS, LEGIBLE & DRAWN TO SCALE | * Plans to include: site plan, floor plan, elevations, roof/ceiling plan, foundation and structural framing details, and structural calculations for non-conforming structures. |
| <input type="checkbox"/> 3 SETS IF PROJECT IS IN A DESIGN REVIEW AREA | |
| <input type="checkbox"/> Title 24 Energy Compliance documentation | <input type="checkbox"/> 11" x 17" copy of floor plan for County Assessor |
| <input type="checkbox"/> Grading and Erosion Control Questionnaire | <input type="checkbox"/> Plan Review Fees |

Date: _____ Received by: (staff) _____

ACTIVITY/PERMIT #

CERTIFICATION OF INSULATION

PART I GENERAL

40 Opus

LOT # 38

- P.O. BOX 854, WEST SACRAMENTO, CA 95691 LIC. #202026
- 1309 MELODY ROAD, MARYSVILLE, CA 95901 LIC. #202026
- P.O. BOX 9651, FRESNO, CA 93793-9651 LIC. #202026
- P.O. BOX 1631, RENO, NV 89505 LIC. #10675
- 3326 A PONDEROSA WAY, LAS VEGAS, NV 89118 LIC. #10675

DATE INSULATION COMPLETED

PART II AREAS INSULATED

WALLS		CEILINGS			FLOORS	
SQUARE FEET		SQUARE FEET			SQUARE FEET	
TYPE OF INSULATION		TYPE OF INSULATION			TYPE OF INSULATION	
MATERIAL FIBERGLASS		MATERIAL FIBERGLASS			MATERIAL FIBERGLASS	
FORM BATTS		FORM BATTS & BLOW			FORM BATTS	
MANUFACTURER'S PRODUCT I D		MANUFACTURER'S PRODUCT I D			MANUFACTURER'S PRODUCT I D	
MANUFACTURER		MANUFACTURER			MANUFACTURER	
OCF		OCF			OCF	
APPLIED THICKNESS		APPLIED THICKNESS			APPLIED THICKNESS	
R-VALUE INSTALLED		R-VALUE INSTALLED			R-VALUE INSTALLED	
13		38				

KNEE WALLS IF R-VALUE IS OTHER THAN WALLS ABOVE

MATERIAL FIBERGLASS	FORM BATTS	R VALUE	MANUFACTURER OCF
-------------------------------	----------------------	---------	----------------------------

AIR INFILTRATION SEALANT

MATERIAL FOAM	MANUFACTURER W R GRACE
-------------------------	----------------------------------

VERIFY THAT INSULATION AND/OR SEALANT HAS BEEN INSTALLED IN CONFORMANCE WITH APPLICABLE CODES, STANDARDS AND REGULATIONS.

SIGNATURE—INSULATION CONTRACTOR	TITLE MANAGER	DATE
SIGNATURE—GENERAL CONTRACTOR	TITLE	DATE

REMARKS

20077



INSTALLATION CARD

Job Address:

Beazer Homes
Memories Lot # 5038
40 Opus Cir. SAC

Stucco System Trade Name: KWIK KOTE
Name Stucco Manufacturer: KWIK KOTE CORP.

ICBO Evaluation Service, Inc.
Report No. 3607
Date of Job Completion

Stucco Contractor: *Kenyon Construction*
Name: *John W. Kenyon, III*
Address: *P.O. Box 2077*
North Highlands, CA 95660
Telephone Number: *(916) 349-8191*
Approved Contractor Number as issued by the Stucco Manufacturer: *1*

This is to certify that the stucco system on the building exterior at the above address had been installed in accordance with the evaluation report specified above and the manufacturer's instructions.

Signature of authorized representative of stucco contractor

Date

9/20/2007

• HOMES •
BEAZER

November 29, 2000

Mr. Nick Buchberger
Chief Building Inspector
City of Sacramento
Building Inspection Division
1231 "I" Street, Room 200
Sacramento, CA 95814

RE: Memories II – All Lots

Dear Mr. Buchberger:

Due to the current weather conditions and existing ground conditions, Beazer Homes is requesting a building final without established grade, landscape, or fencing on the above-referenced project.

We fully understand that within sixty days from final we will have all of the above conditions established. Beazer Homes will also make the homeowner completely aware of the above conditions.

Thank you for your cooperation.

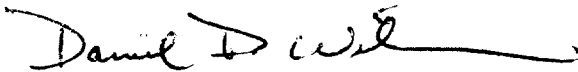

Daniel D. Wilson
Vice President, Construction

/le

cc: David Hay, Building Inspector II
Tony Tonso
Roger Stanton
Rhonda Scangarello
Alan Newman
Gary Ogg
Sales
Superintendent

BZH Beazer Homes Northern California

NYSE 3009 Douglas Boulevard, Suite 150 / Roseville California 95661
Phone (916)773-3888 • Fax (916) 773-4971 • <http://www.beazer.com>

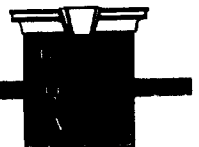



WALLACE - KUHL & ASSOCIATES INC.

Copy with file

September 12, 2000

Mr. Rob Coon
Norman Scheel Structural Engineer
6939 Sunrise Boulevard, Suite 123
Citrus Heights, California 95610

Slab/Reinforcement
GATEWAY WEST (MEMORIES)
Sacramento, California
WKA No. 3895.15

Our geotechnical engineering report for the subject subdivision (WKA No. 3895.05, dated September 8, 1998) recommends minimum interior slab-on-grade reinforcement consisting of 6 x 6/W2.9 x W2.9 welded wire fabric or No. 4 rebar at 18-inch center each way. Welded wire fabric provides crack control and the heavier gage wire is recommended based on our experience that it is easier to control the location of the reinforcement in the slab. The lighter gage wire (6 x 6/W1.4 x W1.4) is more difficult to achieve proper location (vertically) in the slab. However, if properly located, it can provide the desired crack control, although this is highly dependent on the experience and care of the concrete contractor. *OK @ 09/14/00*

Due to concerns over proper location of the reinforcement in the slab, we recommend that the 6 x 6/W2.9 x W2.9 welded wire be used on future house slabs constructed in the subdivision. *In future homes @ 9/14/00*

Wallace-Kuhl & Associates, Inc.

Stephen L.

Stephen L. French
Senior Engineer



S.L.F:dlr

Copies: (1) Beazer Homes

H:\wplaza\3895.15\091200\slf.doc

*cc: Gary Off.
Roger Standa
Jesse Burns
Tony Toms
Dorrie W.*

RECEIVED
SEP 12 2000
BEAZER HOMES

City of Sac.

RECEIVED
SEP 08 2000
BEAZER HOMES

Copy with file

September 13, 2000

Beazer Homes
3009 Douglas Blvd. Suite 150
Roseville, CA 95661

**Re: Memories (Job #99112)
Slab Reinforcement**

To Whom It May Concern:

This letter is to clarify that the 6x6/10x10 or 6x6/W1.4xW1.4 wire mesh is adequate if installed properly. The letter from Wallace Kuhl states that on future pours 6x6/W2.9xW2.9 wire mesh should be used to help insure proper placement in the slab. The wire mesh should be installed in the middle of the slab and is used for crack control only.

If you have any questions, please contact Rob Coon.

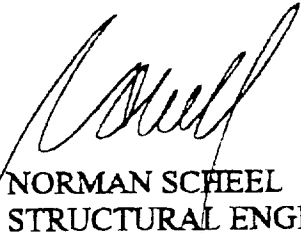
NORMAN SCHEEL
STRUCTURAL ENGINEER

Norman

Scheel

Structural

Engineer

Sacramento
939 Sunrisc Blvd. #123
Citrus Heights, CA 95610
(916) 726-0612
(916) 726-3189 (fax)

NORMAN SCHEEL
Structural Engineer
mail: norm@nsse.com

ROBERT COON
Project Manager
mail: rob@nsse.com

PAULO IBANEZ
Project Manager
mail: paulo@nsse.com

TIM SLOAN
Project Manager
mail: tim@nsse.com

CASANDRA COURTILLET
Design Engineer
mail: casandra@nsse.com

MARY PHUNG
Design Engineer
mail: marv@nsse.com

STEVE COOKSEY
AD Supervisor
mail: steve@nsse.com

STACY MARLIN
Office Manager
mail: stacy@nsse.com

DAVIS
13 E Street Suite B
Davis, CA 95616
(30)753-5300
(30)753-5380(fax)

TRACY HARRIS P.E.
Project Engineer
mail: tracy@nsse.com

DARRELL PEREIRA
Design Engineer
mail: darrrell@nsse.com

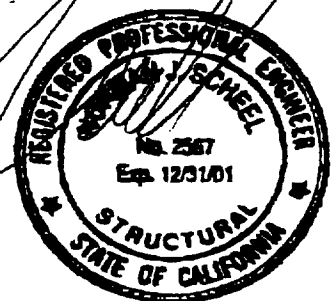

THIS PLOT PLAN IS NOT FOR SALES PURPOSES. THIS PLOT PLAN IS FOR THE PURPOSES OF INDICATING COMPLIANCE WITH ZONING SET BACKS, GENERAL DRAINAGE DIRECTION, AND APPROXIMATE UTILITY CONNECTION. ALL OTHER DATA SHOWN HEREON IS CONCEPTUAL. THIS PLOT PLAN DOES NOT REFLECT AS-BUILT CONDITION, RETAINING WALL ARE OPTIONAL AND MAY OR MAY NOT BE CONSTRUCTED.

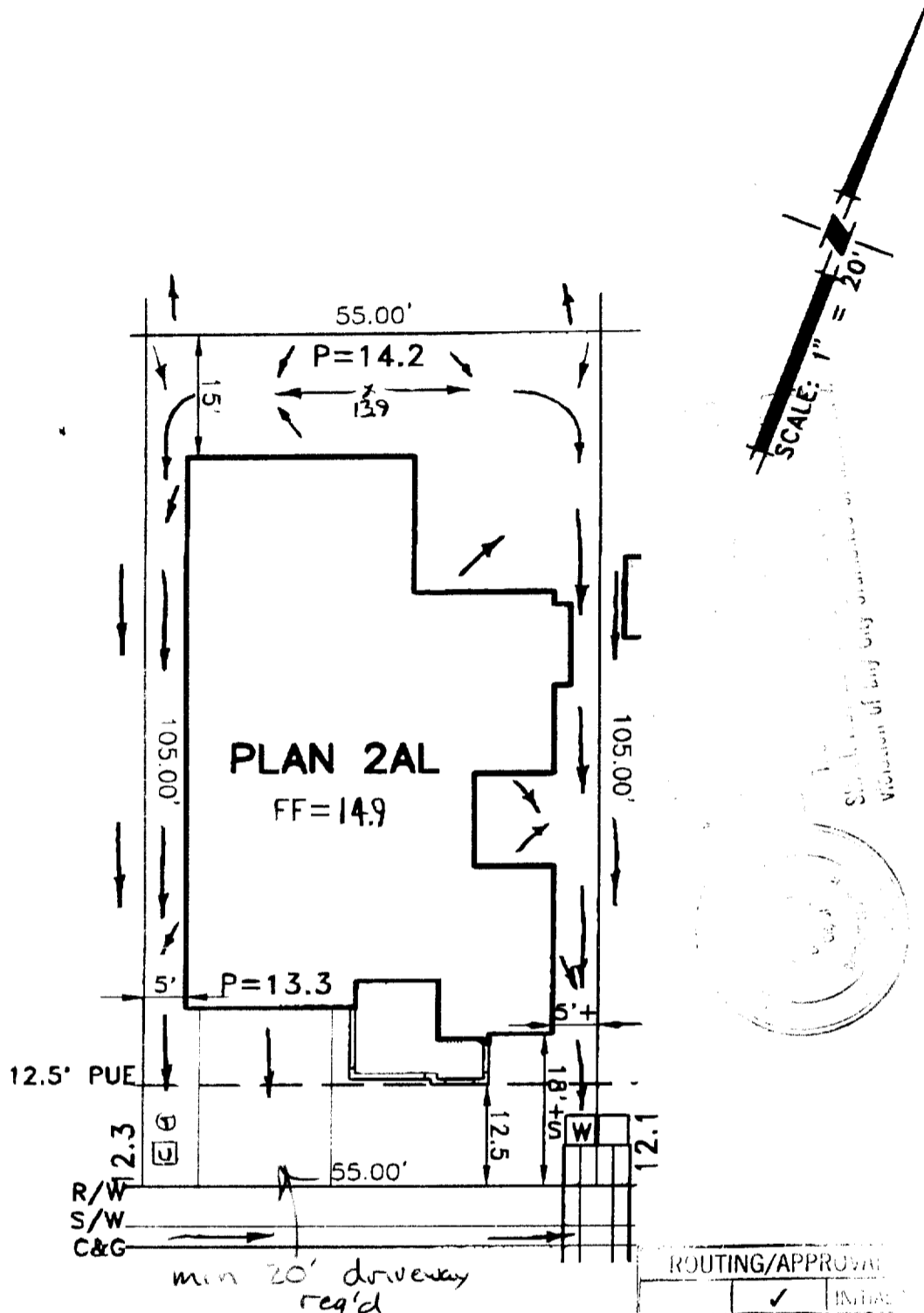

OPUS CIRCLE

ROUTING/APPROVAL		
	✓	INITIALS
Construction	✓	RD
Marking	✓	g

⊙ = TELEPHONE PEDESTAL

⊞ = UTILITY SERVICE BOX

LOT COVERAGE = 40%

PLOT PLAN
LOT 38
GATEWAY WEST VILLAGE NO.5
FOR
BEAZER HOMES
CITY OF SACRAMENTO CALIFORNIA

WOOD-RODGER INC.

DATE: JULY2000	DRAWN: D.P.B.	CHECKED: JWH 7-15-00	PROJECT NO: 1031.017
-------------------	------------------	----------------------------	-------------------------