

CITY OF SACRAMENTO

1231 I Street, Sacramento, CA 95814

Permit No: 0515417

Insp Area: 1

Thos Bros: 297F5

Site Address: 2609 P ST SAC

Parcel No: 007-0266-016

Sub-Type: REM

Housing (Y/N): N

CONTRACTOR
KITCHEN CABINET CENTER
1433 FULTON AVE
SACRAMENTO, CA 95825

OWNER
NAVARI SYLVIA
2609 P ST
SACRAMENTO, CA 95816

ARCHITECT

Nature of Work: Add (6) outlets & circuit, add (8) can lights w/switch, (2) puck lights & (2) flourescent fixtures, install custom supplied appliances, plumb sink, faucet garbage disposal, and install french door (increase size and adding heading)

CONSTRUCTION LENDING AGENCY : I hereby affirm under penalty of perjury that there is a construction lending agency for the performance of the work for which this permit is issued (Sec. 3097, Civ. C).

Lender's Name \_\_\_\_\_ Lender's Address \_\_\_\_\_

LICENSED CONTRACTORS DECLARATION: I hereby affirm under penalty of perjury that I am licensed under provisions of Chapter 9 (commencing with section 7000) of Division 3 of the Business and Professions Code and my license is in full force and effect.

License Class B License Number 788416 Date \_\_\_\_\_ Contractor Signature [Signature]

OWNER-BUILDER DECLARATION: I hereby affirm under penalty of perjury that I am exempt from the contractors License Law for the following reason (Sec. 7031.5, Business and Professions Code; any city or county which requires a permit to construct, alter, improve, demolish, or repair any structure, prior to its issuance, also requires the applicant for such permit to file a signed statement that he or she is licensed pursuant to the provisions of the Contractors License Law (Chapter 9 (commencing with Section 7000) of Division 8 of the Business and Professions Code) or that he or she is exempt therefrom and the basis for the alleged exemption. Any violation of Section 7031.5 by any applicant for a permit subjects the applicant to a civil penalty of not more than five hundred dollars (\$500.00);

I, as a owner of the property, or my employees with wages as their sole compensation, will do the work, and the structure is not intended or offered for sale (Sec. 7044, Business and Professional Code: The Contractors License Law does not apply to an owner of property who builds or improves thereon, and who does such work himself or herself or through his/her own employees, provided that such improvements are not intended or offered for sale. If, however, the building or improvement is sold within one year of completion, the owner-builder will have the burden of proving that he/she did not build or improve for the purpose of sale.)

I, as owner of the property, am exclusively contracting with licensed contractors to construct the project (Sec. 7044, Business and Professions Code: The Contractors License Law does not apply to an owner of property who builds or improves thereon, and who contracts for such projects with a contractor(s) licensed pursuant to the Contractors License Law).

I am exempt under Sec. \_\_\_\_\_ B & PC for this reason: \_\_\_\_\_

Date \_\_\_\_\_ Owner Signature \_\_\_\_\_

IN ISSUING THIS BUILDING PERMIT, the applicant represents, and the city relies on the representation of the applicant, that the applicant verified all measurements and locations shown on the application or accompanying drawings and that the improvement to be constructed does not violate any law or private agreement relating to permissible or prohibited locations for such improvements. This building permit does not authorize any illegal location of any improvement or the violation of any private agreement relating to location of improvements.

I certify that I have read this application and state that all information is correct. I agree to comply with all city and county ordinances and state laws relating to building construction and herby authorize representative(s) of this city to enter upon the abovementioned property for inspection purposes.

Date 9-30-05 Applicant/Agent Signature [Signature]

WORKER'S COMPENSATION DECLARATION: I hereby affirm under penalty of perjury one of the following declarations:

I have and will maintain a certificate of consent to self-insure for workers' compensation as provided for by Section 3700 of the Labor Code, for the performance of work for which the permit is issued.

X I have and will maintain workers' compensation insurance, as required by Section 3700 of the Labor Code, for the performance of the work for which this permit is issued. My workers' compensation insurance carrier and policy number are:

Carrier STATE FUND Policy Number 373-0010897 Exp Date 07/01/2006

1778377-05

(This section need not be completed if the permit is for \$100 or less) I certify that in the performance of the work for which this permit is issued, I shall not employ any person in any manner so as to become subject to the workers' compensation laws of California and agree that if I should become subject to the workers' compensation provisions of Section 3700 of the Labor Code, I shall forthwith comply with those provisions.

Date 9-30-05 Applicant Signature [Signature]

WARNING: FAILURE TO SECURE WORKER'S COMPENSATION COVERAGE IS UNLAWFUL AND SHALL SUBJECT AN EMPLOYER TO CRIMINAL PENALTIES AND CIVIL FINES UP TO ONE HUNDRED THOUSAND DOLLARS (\$100,000) IN ADDITION TO THE COST OF COMPENSATION, DAMAGES AS PROVIDED FOR IN SECTION 3706 OF THE LABOR CODE, INTEREST AND ATTORNEY'S FEE.

KITCHEN CABINET EXPO  
 9778 A BUSINESS PARK DRIVE  
 RANCHO CORDOVA, CA. 95827  
 916-364-5400 FAX 916-364-5455  
 DESIGNED BY: RAYMOND WINDER

# CITY COPY

[09-28-05]  
 Room #3 1

SILVIA & JUANITA  
 2609 P ST.  
 SACRAMENTO, CA. 95816  
 916-452-4612  
 COLUMBIA BP460 WHITE MATTE MAPLE

Not To Scale

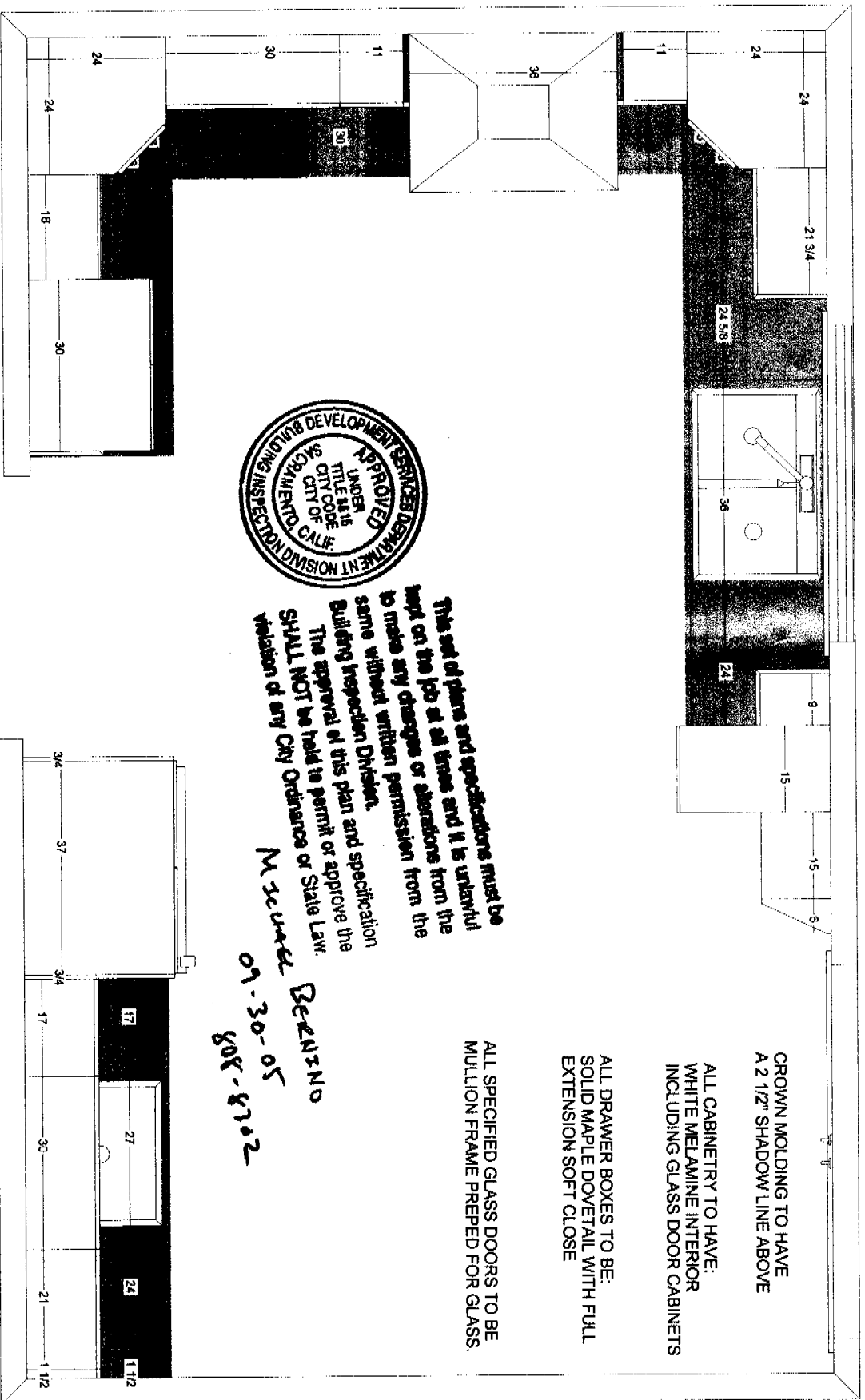

This set of plans and specifications must be kept on the job at all times and it is unlawful to make any changes or alterations from the same without written permission from the Building Inspection Division. The approval of this plan and specification SHALL NOT be held to permit or approve the violation of any City Ordinance or State Law.

*M. J. Winder*  
 09-30-05  
 808-8702

- CROWN MOLDING TO HAVE A 2 1/2" SHADOW LINE ABOVE
- ALL CABINETRY TO HAVE: WHITE MELAMINE INTERIOR INCLUDING GLASS DOOR CABINETS
- ALL DRAWER BOXES TO BE: SOLID MAPLE DOVETAIL WITH FULL EXTENSION SOFT CLOSE
- ALL SPECIFIED GLASS DOORS TO BE MULLION FRAME PREPED FOR GLASS.

#1  
 76 1/4"

#5  
 133 1/4"

**ISSUED**  
**CITY OF SACRAMENTO**  
 SEP 30 2005  
 DOWNTOWN PERMIT  
 CENTER

#4  
 139 1/2"

KITCHEN CABINET EXPO  
 6778 A BUSINESS PARK DRIVE  
 RANCHO CORDOVA, CA. 95827  
 916-364-5400 FAX 916-364-5455  
 DESIGNED BY: RAYMOND WINDER

[09-28-05]

Room 1 - Wall 1

SILVIA & JUANITA  
 2609 P ST.  
 SACRAMENTO, CA. 95816  
 916-452-4612  
 COLUMBIA BP460 WHITE MATTE MAPLE

Not To Scale

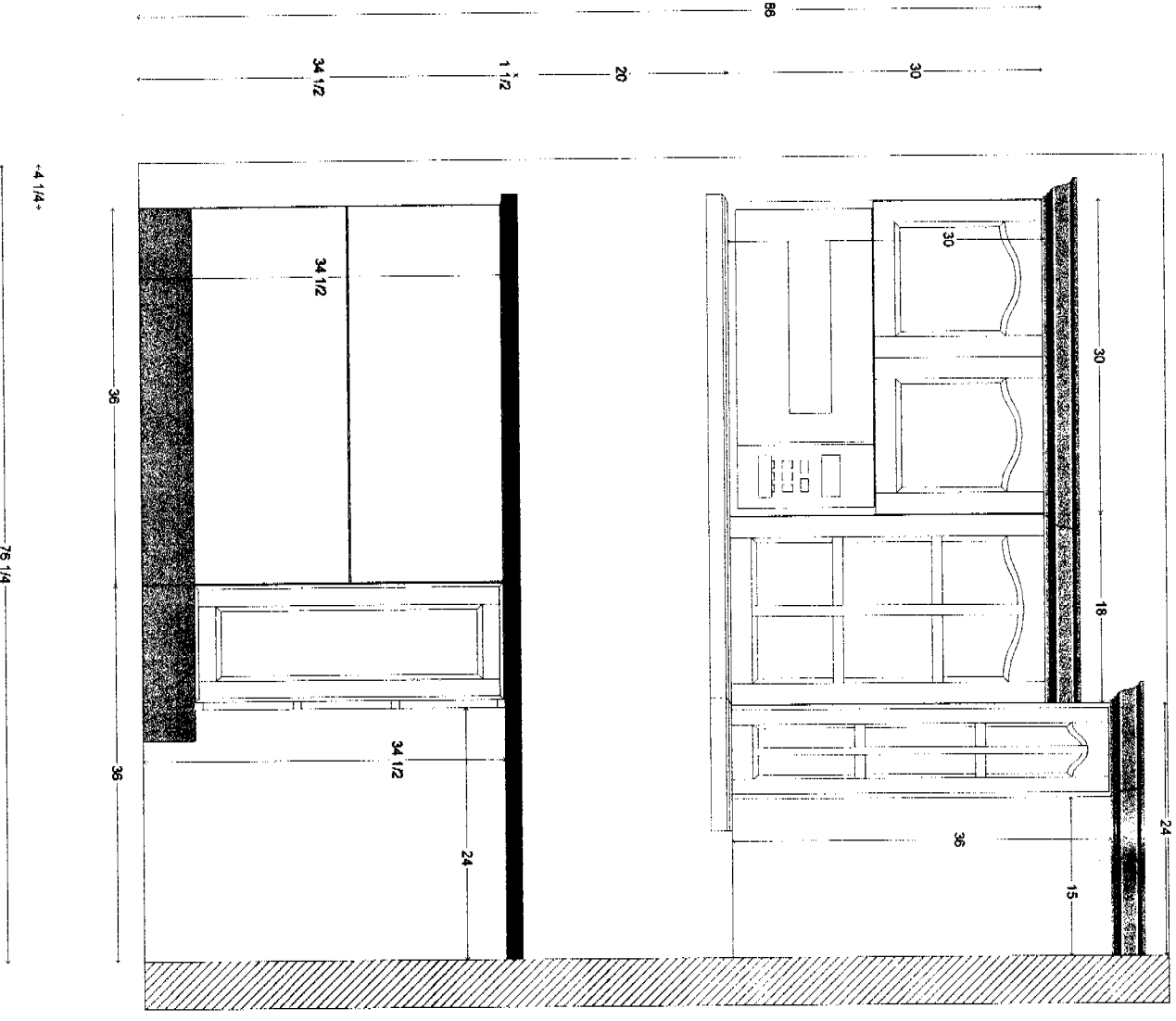

**ISSUED**  
**CITY OF SACRAMENTO**  
 SEP 3 0 2005  
 DOWNTOWN PERMIT  
 CENTER

This set of plans and specifications must be kept on the job at all times and it is unlawful to make any changes or alterations from the same without written permission from the Building Inspection Division.  
 The approval of this plan and specification SHALL NOT be held to permit or approve the violation of any City Ordinance or State Law.

KITCHEN CABINET EXPO  
 3778 A BUSINESS PARK DRIVE  
 RANCHO CORDOVA, CA. 95827  
 916-364-5400 FAX 916-364-5455  
 DESIGNED BY: RAYMOND WINDER

[09-28-05]  
 Room 1 - Wall 2

SILVIA & JUANITA  
 2609 P ST.  
 SACRAMENTO, CA. 95816  
 916-452-4612  
 COLUMBIA BP460 WHITE MATTE MAPLE

Not To Scale

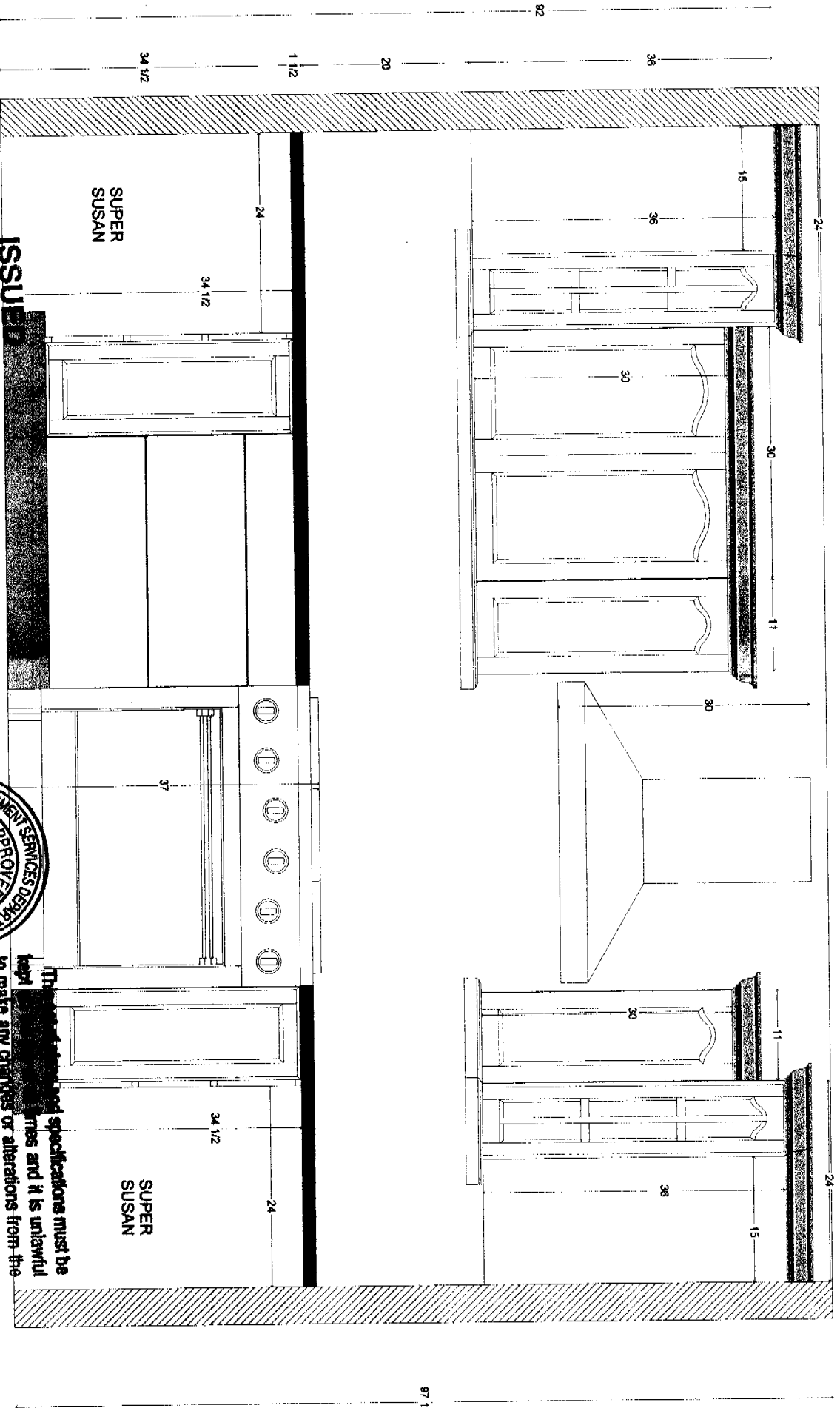

**ISSUED**  
 CITY OF SACRAMENTO

SEP 30 2005

DOWNTOWN PERMIT  
 CENTER

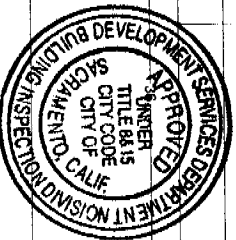

The [redacted] specifications must be kept [redacted] and it is unlawful to make any changes or alterations from the same without written permission from the Building Inspection Division.  
 The approval of this plan and specification SHALL NOT be held to permit or approve the violation of any City Ordinance or State Law.

97 1/2

KITCHEN CABINET EXPO  
 9778 A BUSINESS PARK DRIVE  
 RANCHO CORDOVA, CA. 95827  
 916-364-5400 FAX 916-364-5455  
 DESIGNED BY: RAYMOND WINDER

[09-28-05]  
 Room 1 - Wall 3

SILVIA & JUANITA  
 2609 P ST.  
 SACRAMENTO, CA. 95816  
 916-452-4612  
 COLUMBIA BP460 WHITE MATTE MAPLE

Not To Scale

ISSUED  
 CITY OF SACRAMENTO  
 SEP 30 2005  
 DOWNTOWN PERMIT  
 CENTER

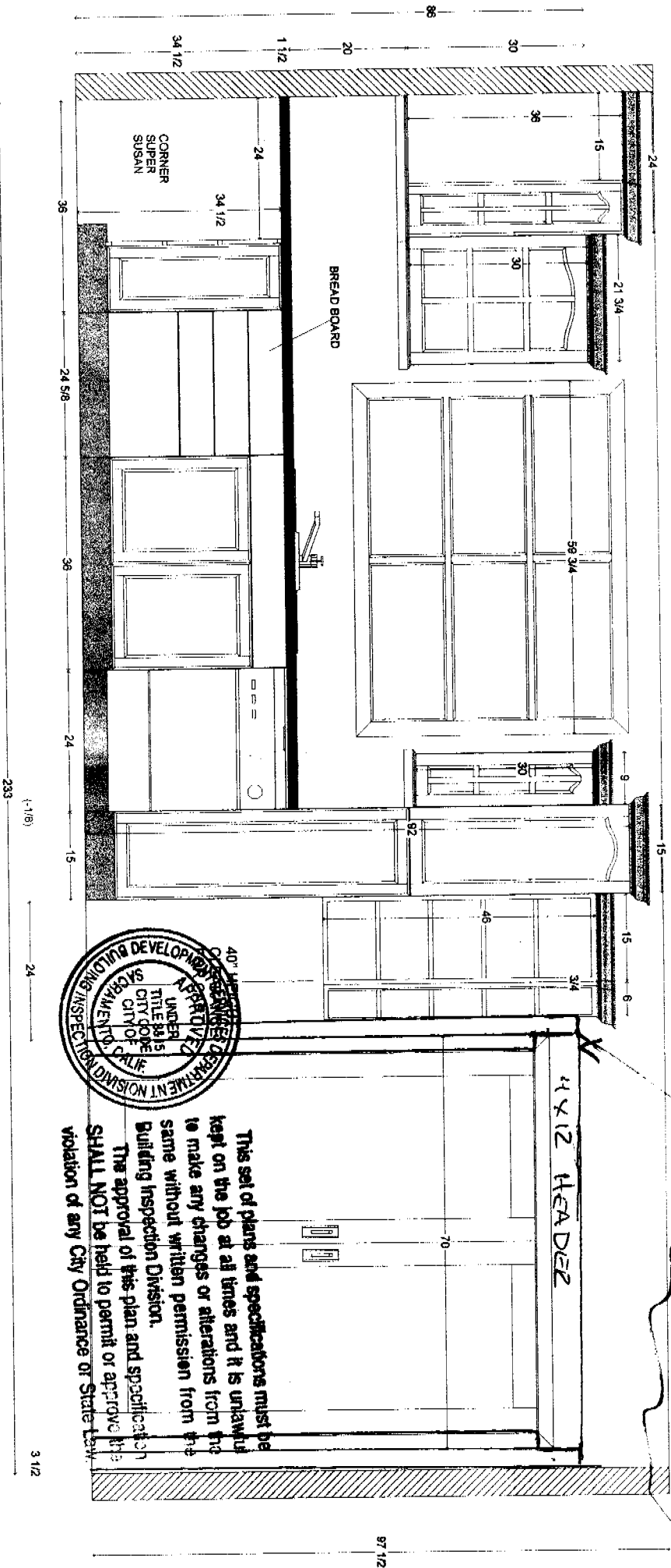

KITCHEN CABINET EXPO  
 6778 A BUSINESS PARK DRIVE  
 RANCHO CORDOVA, CA. 95827  
 916-364-5400 FAX 916-364-5455  
 DESIGNED BY: RAYMOND WINDER

[09-28-05]  
 Room 1 - Wall 5

SILVIA & JUANITA  
 2609 P ST.  
 SACRAMENTO, CA. 95816  
 916-452-4612  
 COLUMBIA BP460 WHITE MATTE MAPLE

Not To Scale

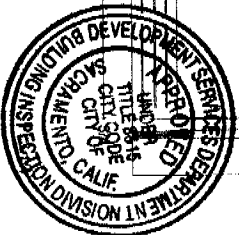
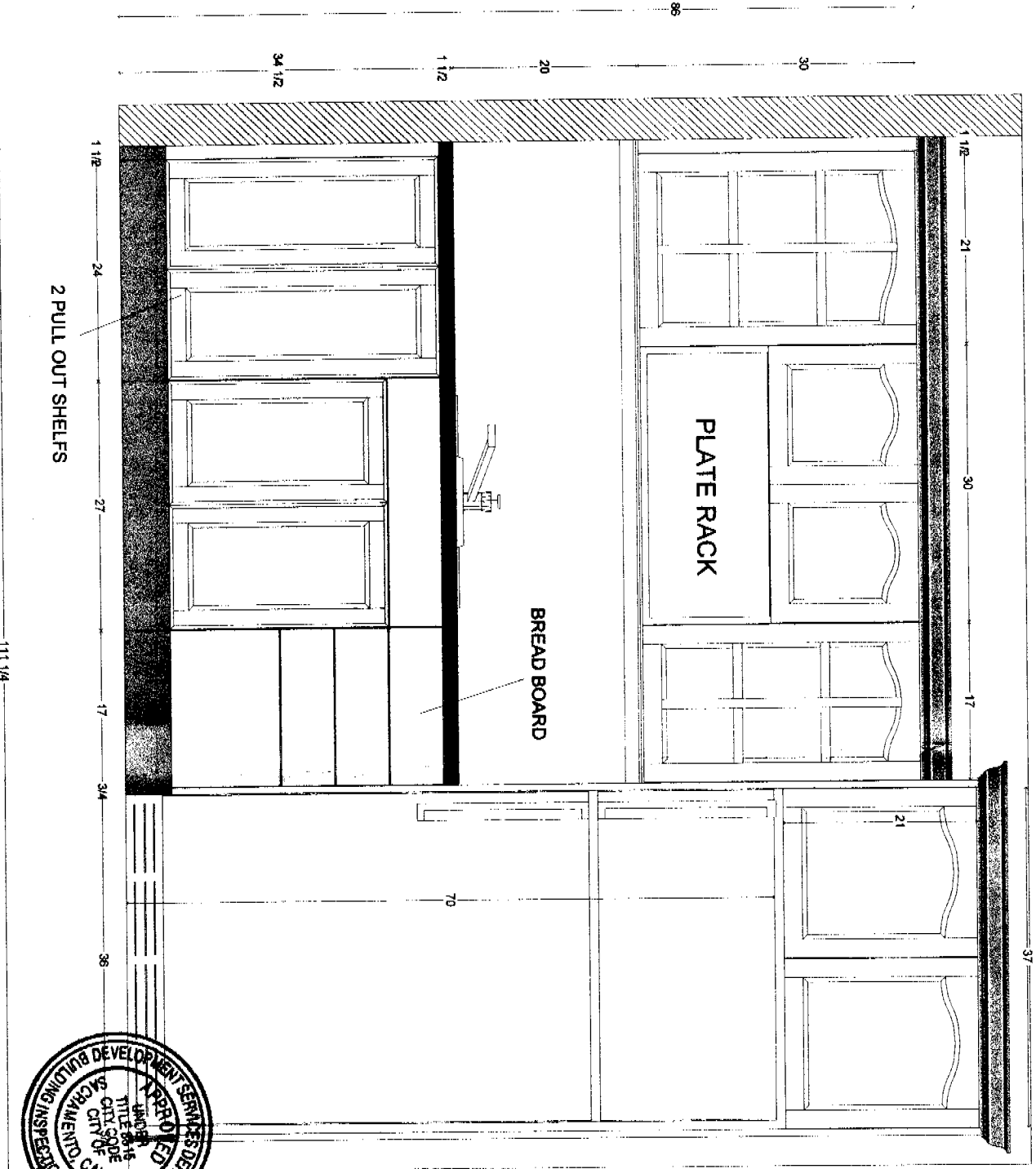

ISSUED  
 CITY OF SACRAMENTO  
 SEP 30 2005  
 DOWNTOWN PERMIT  
 CENTER

This set of plans and specifications must be kept on the job at all times and it is unlawful to make any changes or alterations from the same without written permission from the Building Inspection Division.  
 The approval of this plan and specification SHALL NOT be held to permit or approve the violation of any City Ordinance or State Law.