

**CITY OF SACRAMENTO**  
1231 I Street, Sacramento, CA 95814

**Permit No: 0105611**

**Insp Area: 4**

**Site Address: 4727 SAVOIE WY SAC**  
Parcel No: 225-1570-024  
N

WESTBOROUGH VIL. 1 PHASE 1 LOT 63

Sub-Type: NSFR  
Housing (Y/N):

**CONTRACTOR**  
WOODSIDE HOMES OF N CALIF  
15 AUTO PLAZA DR #102  
FOLSOM CA. 95630

**OWNER**

**ARCHITECT**

**Nature of Work: MP 2653 W/ 6 BD OPT 2 STORY 10 ROOM SFR**

**CONSTRUCTION LENDING AGENCY:** I hereby affirm under penalty of perjury that there is a construction lending agency for the performance of the work for which this permit is issued (Sec. 3097, Civ. C.)

Lender's Name \_\_\_\_\_ Lender's Address \_\_\_\_\_

**LICENSED CONTRACTORS DECLARATION:** I hereby affirm under penalty of perjury that I am licensed under provisions of Chapter 9 (commencing with section 7000) of Division 3 of the Business and Professions Code and my license is in full force and effect.

License Class B License Number 744379 Date 5/11/09 Contractor Signature Kosai Mahesh

**OWNER-BUILDER DECLARATION:** I hereby affirm under penalty of perjury that I am exempt from the contractors License Law for the following reason (Sec. 7031.5, Business and Professions Code; any city or county which requires a permit to construct, alter, improve, demolish, or repair any structure, prior to its issuance, also requires the applicant for such permit to file a signed statement that he or she is licensed pursuant to the provisions of the Contractors License Law (Chapter 9 (commencing with Section 7000) of Division 8 of the Business and Professions Code) or that he or she is exempt therefrom and the basis for the alleged exemption. Any violation of Section 7031.5 by any applicant for a permit subjects the applicant to a civil penalty of not more than five hundred dollars (\$500.00);

\_\_\_\_\_, I, as a owner of the property, or my employees with wages as their sole compensation, will do the work, and the structure is not intended or offered for sale (Sec. 7044, Business and Professional Code: The Contractors License Law does not apply to an owner of property who builds or improves thereon, and who does such work himself or herself or through his/her own employees, provided that such improvements are not intended or offered for sale. If, however, the building or improvement is sold within one year of completion, the owner-builder will have the burden of proving that he/she did not build or improve for the purpose of sale.)

\_\_\_\_\_, I, as owner of the property, am exclusively contracting with licensed contractors to construct the project (Sec. 7044, Business and Professions Code: The Contractors License Law does not apply to an owner of property who builds or improves thereon, and who contracts for such projects with a contractor(s) licensed pursuant to the Contractors License Law).

\_\_\_\_\_, I am exempt under Sec. \_\_\_\_\_ B & PC for this reason: \_\_\_\_\_

Date \_\_\_\_\_ Owner Signature \_\_\_\_\_

**IN ISSUING THIS BUILDING PERMIT,** the applicant represents, and the city relies on the representation of the applicant, that the applicant verified all measurements and locations shown on the application or accompanying drawings and that the improvement to be constructed does not violate any law or private agreement relating to permissible or prohibited locations for such improvements. This building permit does not authorize any illegal location of any improvement or the violation of any private agreement relating to location of improvements.

I certify that I have read this application and state that all information is correct. I agree to comply with all city and county ordinances and state laws relating to building construction and hereby authorize representative(s) of this city to enter upon the abovementioned property for inspection purposes.

Date 5/11/09 Applicant/Agent Signature Kosai Mahesh

**WORKER'S COMPENSATION DECLARATION:** I hereby affirm under penalty of perjury one of the following declarations:

\_\_\_\_\_, I have and will maintain a certificate of consent to self-insure for workers' compensation as provided for by Section 3700 of the Labor Code, for the performance of work for which the permit is issued.

I have and will maintain workers' compensation insurance, as required by Section 3700 of the Labor Code, for the performance of the work for which this permit is issued. My workers' compensation insurance carrier and policy number are:

Carrier INSURANCE CO. OF THE WEST Policy Number WEANN001 Exp Date 12/12/2001

\_\_\_\_\_, (This section need not be completed if the permit is for \$500 or less) I certify that in the performance of the work for which this permit is issued, I shall not employ any person in any manner so as to become subject to the workers' compensation laws of California and agree that if I should become subject to the workers' compensation provisions of Section 3700 of the Labor Code, I shall forthwith comply with those provisions.

Date 5/11/09 Applicant Signature Kosai Mahesh

**WARNING: FAILURE TO SECURE WORKER'S COMPENSATION COVERAGE IS UNLAWFUL AND SHALL SUBJECT AN EMPLOYER TO CRIMINAL PENALTIES AND CIVIL FINES UP TO ONE HUNDRED THOUSAND DOLLARS (\$100,000) IN ADDITION TO THE COST OF COMPENSATION, DAMAGES AS PROVIDED FOR IN SECTION 3706 OF THE LABOR CODE, INTEREST AND ATTORNEY'S FEE.**

**THIS PERMIT SHALL EXPIRE BY LIMITATION IF WORK IS NOT COMMENCED WITHIN 180 DAYS.**

RESIDENTIAL SUBDIVISION BUILDING PERMIT APPLICATION

Project Address: 4727 Savoie Way Assessor Parcel # 225-1570-024
Lot Number: 63 Subdivision Westborough-Village 1

OWNER INFORMATION:

Legal Property Owner: Woodside Westlake, Inc. Phone# (916) 608-9600
Owner Address: 15 Plaza Drive #102 City Folsom State CA Zip 95630

CONTRACTOR INFORMATION:

Contractor: Woodside Homes of CA, Inc. Lic. # 744379B Phone # 608-9600 Fax 608-9940

PROJECT INFORMATION:

Land Use Zone R1A Occupancy Group R3 Construction Type VN Fed Code 1A
No. of Stories: 2 No. of Rooms: Street Width:
1st Floor Area 1526 2nd Floor Area 1274 Basement N/A Roof Material Concrete Tile
AREA IN SQUARE FOOT OF:
Dwelling/Living 2800
Garage/Storage 499
Decks/Balconies N/A
Carports N/A
SCOPE OF WORK: New Residential Construction

Handwritten note: 4040/E

FOR OFFICE USE ONLY

- Information Above Complete AR Flood Waiver Required Planning Approval
Violation Files Checked Flood Elevation Certificate Required Design Review Approval
Standard Setbacks Water Development Infill Area Special Fee Districts Apply:
County Sewer

THE FOLLOWING MUST BE PROVIDED IN ORDER TO SUBMIT FOR PERMIT

- 2 COMPLETE PLOT PLANS, LEGIBLE & DRAWN TO SCALE
11 X 17 COPY OF FLOOR PLAN WITH FOLLOWING INFORMATION
a) Assessor's Parcel Number c) Owners Name
b) New Floor Area d) Project Address

# OMEGA PRODUCTS CORP.

DIAMOND WALL INSULATING STUCCO SYSTEM

ICBO Report #4004

JOB ADDRESS:

WESTLAKE - WOODSIDE HOMES  
LOT 63 4727 SAVOIE WAY

Date of Job Completion \_\_\_\_\_

PLASTERING CONTRACTOR:

Name: STELLAR ENTERPRISES INC.

Address: 29054 GOETZ RD, STE 14, CANYON LAKE, CA. 92587

Telephone No: (909) 244-0525

Contractor Number of Diamond Wall System 1034

This is to certify that the exterior coating system on the building exterior at the above address has been installed in accordance with the evaluation report specified above and the manufacturer's instructions.

10-26-01  
Date

[Signature]  
Signature of authorized representative of  
Plastering Contractor

This installation card must be presented to the building inspector after completion of work and before final inspection.

Lot 63  
4727 SAVOIE

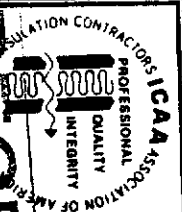

**RECEIVED**

SEP 19 2001

**WesPac**

**insulation**

a MASCO Company



809 North Market Blvd., Ste. 11 • Sacramento, CA 95834  
(916) 927-7149 • Fax (916) 927-4257  
Lic. #487478

**Installed Insulation Certificate**

We certify that the bidding insulation listed herein is installed in conformance with current energy conservation regulations, California Administrative Code, Title 24, State of California

R FACTOR	AREA	TYPE	INCHES/BAGS (BROWN)
R30	CEILING AREA	FIBERGLASS BATT	12" / 35 BAGS
R30	CEILING AREA	FIBERGLASS BATT	10.25"
R13	EXT. WALL AREA	FIBERGLASS BATT	3.5"

Certified by 

Title Secretary

WOOD SIDE HOMES/RESIDUAL  
Address or Lot Number 4444444444444444

Date Installed 09/11/01

Phase #

SCALE : 1"=20'

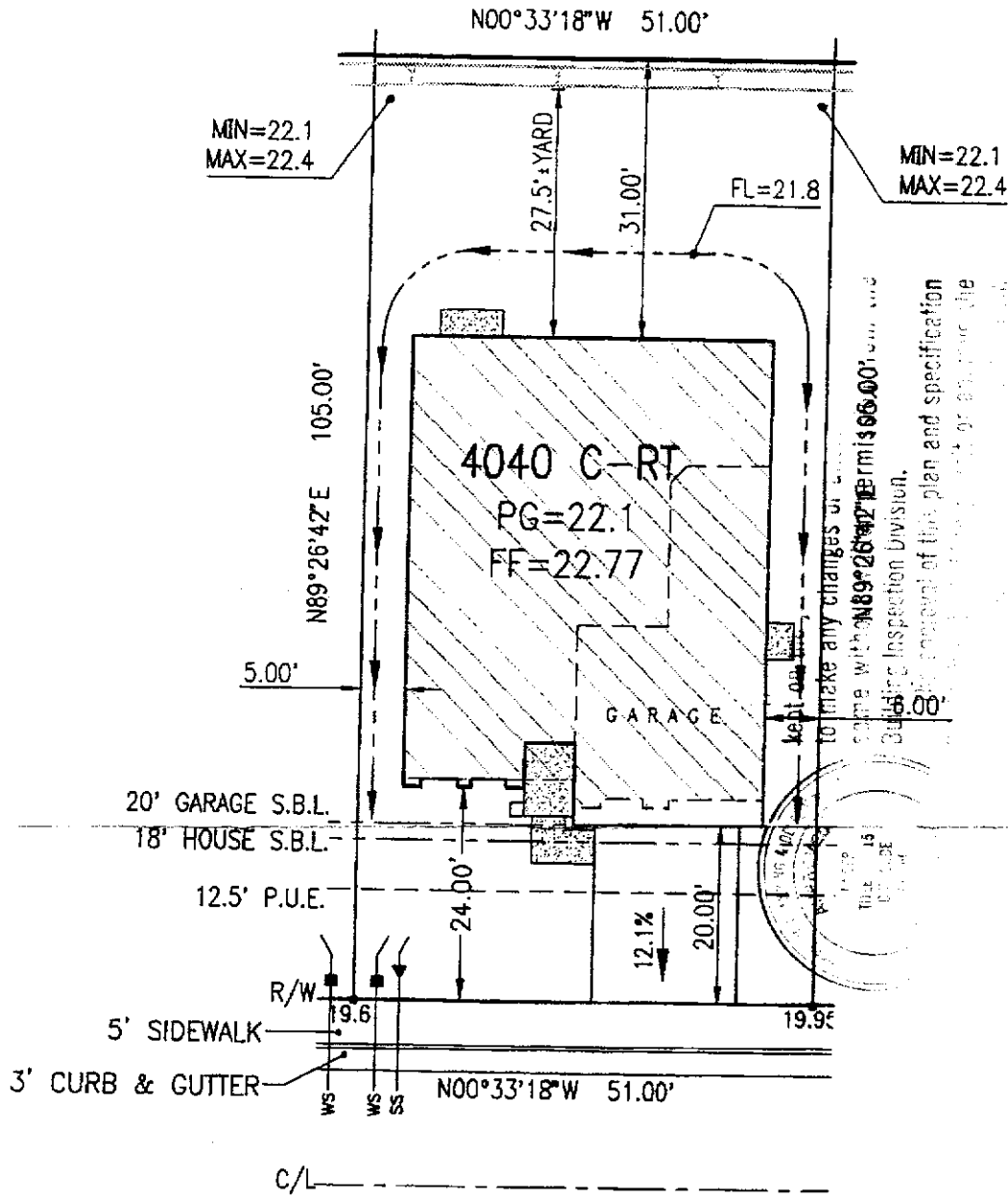

**PLAN 4040**  
 2-STORY  
 2-CAR GARAGE  
 LIVABLE 1st=1 s.f.  
 LIVABLE 2nd=1 s.f.  
 GARAGE AREA= 646 s.f.  
 ENTRY AREA= 64 s.f.  
 FOOTPRINT 2070.5 s.f.

SAVOIE WAY

**PLOT PLAN FOR LOT 63**  
  
 WOODSIDE HOMES OF CA, INC.

**Westborough ~ Village 1 , Phase 1**  
 ADDRESS: 4727 SAVOIE WAY  
 CITY OF SACRAMENTO, NATOMAS  
 SACRAMENTO COUNTY, CALIFORNIA  
 A.P.N.: 225-1570-024  
 Lot Area: 5355 s.f.  
 Lot Coverage: 38.7%

SCALE : 1"=20'  
 Date: April 1, 2001  
 Revised:  
 Drawn By: T.D.B.  
 Job No: 00-11-132