

CITY OF SACRAMENTO

1231 I Street, Sacramento, CA 95814

Permit No: 9905337

Insp Area: 4

Site Address: 3842 STEMMLER DR SAC

Parcel No: 225-1180-051

GATEWAY WEST LOT 51

Sub-Type: NSFR

Housing (Y/N): N

CONTRACTOR

KAUFMAN AND BROAD
3300 DOUGLAS BLVD. STE 330
ROSEVILLE CA. 95661

OWNER

ARCHITECT

Nature of Work: MP 1968 2 STORY SFR

CONSTRUCTION LENDING AGENCY : I hereby affirm under penalty of perjury that there is a construction lending agency for the performance of the work for which this permit is issued (Sec. 3097, Civ. C).

Lender's Name _____ Lender's Address _____

LICENSED CONTRACTORS DECLARATION: I hereby affirm under penalty of perjury that I am licensed under provisions of Chapter 9 (commencing with section 7000) of Division 3 of the Business and Professions Code and my license is in full force and effect.

License Class D License Number 2584107 Date 6/10/99 Contractor Signature A. Gollins

OWNER-BUILDER DECLARATION: I hereby affirm under penalty of perjury that I am exempt from the contractors License Law for the following reason (Sec. 7031.5, Business and Professions Code; any city or county which requires a permit to construct, alter, improve, demolish, or repair any structure, prior to its issuance, also requires the applicant for such permit to file a signed statement that he or she is licensed pursuant to the provisions of the Contractors License Law (Chapter 9 (commencing with Section 7000) of Division 8 of the Business and Professions Code) or that he or she is exempt therefrom and the basis for the alleged exemption. Any violation of Section 7031.5 by any applicant for a permit subjects the applicant to a civil penalty of not more than five hundred dollars (\$500.00):

____ I, as a owner of the property, or my employees with wages as their sole compensation, will do the work, and the structure is not intended or offered for sale (Sec. 7044, Business and Professional Code: The Contractors License Law does not apply to an owner of property who builds or improves thereon, and who does such work himself or herself or through his/her own employees, provided that such improvements are not intended or offered for sale. If, however, the building or improvement is sold within one year of completion, the owner-builder will have the burden of proving that he/she did not build or improve for the purpose of sale.)

____ I, as owner of the property, am exclusively contracting with licensed contractors to construct the project (Sec. 7044, Business and Professions Code: The Contractors License Law does not apply to an owner of property who builds or improves thereon, and who contracts for such projects with a contractor(s) licensed pursuant to the Contractors License Law).

____ I am exempt under Sec. _____ B & PC for this reason: _____

Date _____ Owner Signature _____

IN ISSUING THIS BUILDING PERMIT, the applicant represents, and the city relies on the representation of the applicant, that the applicant verified all measurements and locations shown on the application or accompanying drawings and that the improvement to be constructed does not violate any law or private agreement relating to permissible or prohibited locations for such improvements. This building permit does not authorize any illegal location of any improvement or the violation of any private agreement relating to location of improvements.

I certify that I have read this application and state that all information is correct. I agree to comply with all city and county ordinances and state laws relating to building construction and hereby authorize representative(s) of this city to enter upon the abovementioned property for inspection purposes.

Date 6/10/99 Applicant/Agent Signature A. Gollins

WORKER'S COMPENSATION DECLARATION: I hereby affirm under penalty of perjury one of the following declarations:

____ I have and will maintain a certificate of consent to self-insure for workers' compensation as provided for by Section 3700 of the Labor Code, for the performance of work for which the permit is issued.

____ I have and will maintain workers' compensation insurance, as required by Section 3700 of the Labor Code, for the performance of the work for which this permit is issued. My workers' compensation insurance carrier and policy number are:

Carrier CONTINENTAL CAS. CO. Policy Number WC188899094 Exp Date 05/01/2000

____ (This section need not be completed if the permit is for \$100 or less) I certify that in the performance of the work for which this permit is issued, I shall not employ any person in any manner so as to become subject to the workers' compensation laws of California and agree that if I should become subject to the workers' compensation provisions of Section 3700 of the Labor Code, I shall forthwith comply with those provisions.

Date 6/10/99 Applicant Signature A. Gollins

WARNING: FAILURE TO SECURE WORKER'S COMPENSATION COVERAGE IS UNLAWFUL AND SHALL SUBJECT AN EMPLOYER TO CRIMINAL PENALTIES AND CIVIL FINES UP TO ONE HUNDRED THOUSAND DOLLARS (\$100,000) IN ADDITION TO THE COST OF COMPENSATION, DAMAGES AS PROVIDED FOR IN SECTION 3706 OF THE LABOR CODE, INTEREST AND ATTORNEY'S FEE.

THIS PERMIT SHALL EXPIRE BY LIMITATION IF WORK IS NOT COMMENCED WITHIN 180 DAYS.

Natomas Unified School District
 1515 Sports Drive, #1 • Sacramento, CA 95834-1905
 Phone 916/641-3300 • Fax 916/928-1629

CERTIFICATE OF COMPLIANCE
SCHOOL DISTRICT DEVELOPMENT FEES

PART I: TO BE COMPLETED BY APPLICANT	
Property Owner's Name	<i>K. Hoffman & Board</i>
Owner's Address	<i>611 Grange Drive Yuba City CA 95687</i>
Project Address	<i>3842 Stearns Lane Drive Lot 51</i>
Parcel Number	<i>PARKWAY 000</i>
Subdivision Name	<i>Gateway West Village 1 Unit 4</i>
Number of Units	<i>1</i>
Print Applicant's Name	<i>D Collins</i>
Title of Applicant	<i>Open</i>
Date	<i>5/23/99</i>
Applicant's Signature	<i>[Signature]</i>
Telephone Number	<i>991-1200</i>
PART II: TO BE COMPLETED BY BUILDING DEPARTMENT	
Plan Identification Number	
Building Type (Check One)	
<input checked="" type="checkbox"/> Residential	<input type="checkbox"/> Apartment/Condominium
<input type="checkbox"/> Commercial/Industrial	
Square Feet of Chargeable Building Area	<i>1968</i>
Signature	<i>[Signature]</i>
Title	
Date	<i>5-24-99</i>
PART III: TO BE COMPLETED BY NATOMAS UNIFIED SCHOOL DISTRICT	
District Certification Number	<i>99-362</i>
Fees Collected:	
Residential:	<i>1968</i> Sq. Ft. X \$ <i>4.57</i> = \$ 8970.21 <i>8993.76</i>
Apartment/Condominium:	Sq. Ft. X \$ = \$
Commercial/Industrial:	Sq. Ft. X \$ = \$
NOTICE TO APPLICANT: Pursuant to government code section 66020 (d), this will serve to notify you that the 90-day approval period in which you may protest the fees, or other payment identified above, will begin to run on the date in which the building or installation permit for this project is issued, or on which they are paid to the District, or to another public entity authorized to collect them on behalf of the District, whichever is earlier.	
Applicant Signature: _____	Date: _____

This certification covers only the amount of square footage indicated above. Any additions or corrections to the square footage for this project will require an amendment to the Certificate of Compliance.

As the authorize Natomas Unified School District official, I hereby certify that the requirements of Government Code Section 95995 have been complied with by the above signed applicant.

SIGNATURE: *[Signature]* DATE: *6-1-99*
 TITLE: *Facilities Planner*

COUNTY SANITATION DISTRICT NO. 1
 SACRAMENTO REGIONAL COUNTY SANITATION DISTRICT
SEWER IMPACT FEE
 PERMIT AND CALCULATION SHEET

APPLICATION NO:		BLDG PERMIT NO: <i>City</i>	
GENERAL INFORMATION		THIS PERMIT GOOD ONLY WHEN VALIDATED BY THE CASHIER <i>252104 6-9-99</i>	
		- DEPT 26 \$2,414.00 - TR TRAN 390887 06/09/99 - RECEIPT 703029 C#1 \$2,414.00	
		THIS PERMIT TO CONNECT EXPIRES ONE YEAR FROM DATE OF ISSUANCE	
FEE CALCULATION		BUILDING USE	
INSPECTION		RESIDENTIAL SF <input type="checkbox"/>	MF <input type="checkbox"/>
CSD-1	<i>29</i>	COMMERCIAL USE	UNITS
SRCSD	<i>2385</i>		
CONSTRUCTION			
IN-LIEU			
TOTAL FEE	<i>2414</i>		
APN:	PARUNKN000		
DESCRIPTION/ SUBDIVISION	Gateway West Village #1 Unit #4 LOT: 51 <i>51</i>		
PROPERTY ADDRESS	3842 Stemmler Drive		
OWNER	Kaufman & Broad		
MAILING ADDRESS	611 Orange Drive		
CITY-STATE-ZIP	Vacaville, Ca. 95687		PHONE (707) 469-2400
ADDITIONAL FEES MAY BE DUE IF CHANGES IN USE INCREASE SEWER IMPACT.			
APPLICANT SIGNATURE	<i>Dorinda Gallina</i>		
CONSOLIDATED UTILITY BILLING USE ONLY			
ACCT _____	INPUT _____	START _____	
BILLING COPY			

SCALE: 1" = 20'

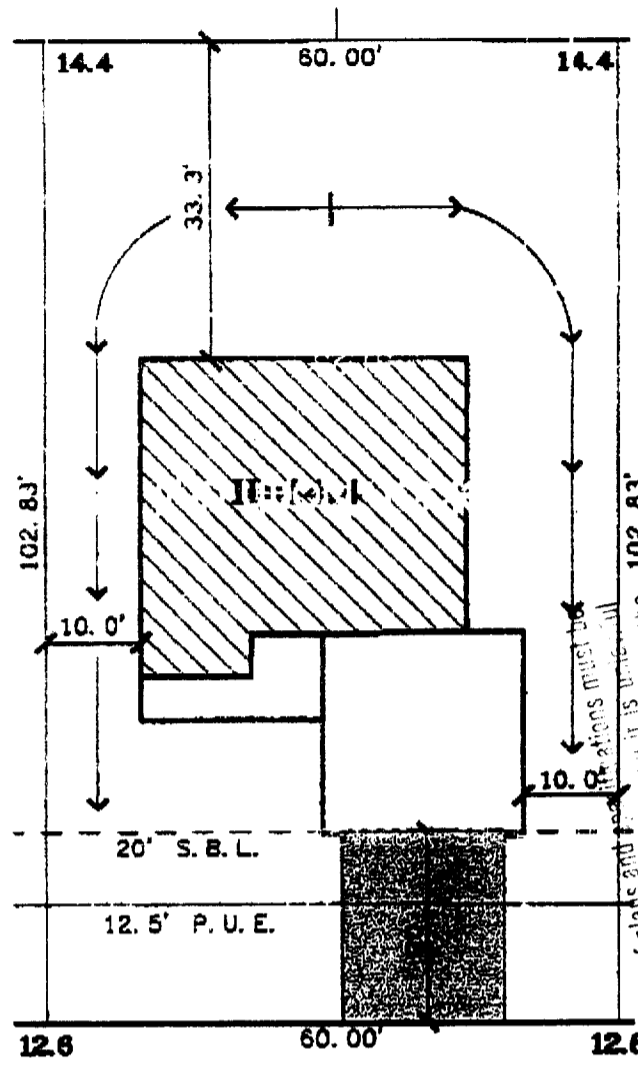

STEMMLER DRIVE

This set of plans and specifications must be kept on the job at all times. It is the responsibility of the contractor to make any changes or alterations to the plans and specifications to conform with the same without the approval of the engineer. The contractor shall be responsible for the accuracy of the information furnished on these plans. The contractor shall be responsible for the accuracy of the information furnished on these plans.

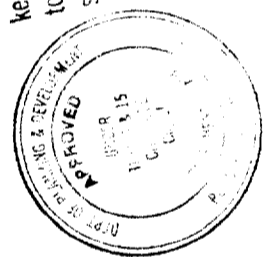

DATE: 4-23-99
 A.P.N.:
 ADDRESS: 3842 STEMMLER DRIVE

LOT AREA: 6,170 SF
 LOT COVERAGE: 26%

The Splink Corporation
 2590 VENTURE OAKS WAY
 SACRAMENTO, CA 95833
 PH: (916) 925-3550 FAX: (916) 921-9274

GATEWAY WEST
 VILLAGE 1 UNIT 4
 LOT 51
 PLAN 24

GATEWAY WEST
 CITY OF SACRAMENTO, CA.
 CLIENT: KAUFMAN & BROAD
 100 N. ...
 TOTAL P. 08