

CITY OF SACRAMENTO
1231 I Street, Sacramento, CA 95814

Permit No: 9913413
Insp Area: 4

Site Address: 2691 PICKERING WY SAC
Parcel No: 274-0540-031 LOT 31-3 HERITAGE PLACE

Sub-Type: NSFR
Housing (Y/N): N

CONTRACTOR

OWNER

ARCHITECT

EPICK INC.
1263 THE ESPLANADE
CHICO, CA 95926

Nature of Work: NSFR MP1987 8 RMS, 1 STORY

CONSTRUCTION LENDING AGENCY: I hereby affirm under penalty of perjury that there is a construction lending agency for the performance of the work for which this permit is issued (Sec. 3097, Civ. C).

Lender's Name 1st Bank Lender's Address 1525 Douglas Blvd Roseville 95661

LICENSED CONTRACTORS DECLARATION: I hereby affirm under penalty of perjury that I am licensed under provisions of Chapter 9 (commencing with section 7000) of Division 3 of the Business and Professions Code and my license is in full force and effect.

License Class ES License Number 463709 Date 8/16/00 Contractor Signature [Signature]

OWNER-BUILDER DECLARATION: I hereby affirm under penalty of perjury that I am exempt from the contractors License Law for the following reason (Sec. 7031.5, Business and Professions Code; any city or county which requires a permit to construct, alter, improve, demolish, or repair any structure, prior to its issuance, also requires the applicant for such permit to file a signed statement that he or she is licensed pursuant to the provisions of the Contractors License Law (Chapter 9 (commencing with Section 7000) of Division 8 of the Business and Professions Code) or that he or she is exempt therefrom and the basis for the alleged exemption). Any violation of Section 7031.5 by any applicant for a permit subjects the applicant to a civil penalty of not more than five hundred dollars (\$500.00);

I, as a owner of the property, or my employees with wages as their sole compensation, will do the work, and the structure is not intended or offered for sale (Sec. 7044, Business and Professional Code). The Contractors License Law does not apply to an owner of property who builds or improves thereon, and who does such work himself or herself or through his/her own employees, provided that such improvements are not intended or offered for sale. If, however, the building or improvement is sold within one year of completion, the owner-builder will have the burden of proving that he/she did not build or improve for the purpose of sale.)

I, as owner of the property, am exclusively contracting with licensed contractors to construct the project (Sec. 7044, Business and Professions Code). The Contractors License Law does not apply to an owner of property who builds or improves thereon, no contracts for such projects with a contractor(s) licensed pursuant to the Contractors License Law).

I am exempt under Sec. _____ B & PC for this reason: _____

Date _____ Owner Signature _____

PAID
CITY OF SACRAMENTO
AUG 17 2000
NEIGHBORHOODS, PLANNING
& DEVELOPMENT SERVICES

IN ISSUING THIS BUILDING PERMIT, the applicant represents, and the city relies on the representation of the applicant, that the applicant verified all measurements and locations shown on the application or accompanying drawings and that the improvement to be constructed does not violate any law or private agreement relating to permissible or prohibited locations for such improvements. This building permit does not authorize any illegal location of any improvement or the violation of any private agreement relating to location of improvements.

I certify that I have read this application and state that all information is correct. I agree to comply with all city and county ordinances and state laws relating to building construction and hereby authorize representative(s) of this city to enter upon the above mentioned property for inspection purposes.

Date 8/16/00 Applicant/Agent Signature [Signature]

WORKER'S COMPENSATION DECLARATION: I hereby affirm under penalty of perjury one of the following declarations:

I have and will maintain a certificate of consent to self-insure for workers' compensation as provided for by Section 3700 of the Labor Code, for the performance of work for which the permit is issued.

I have and will maintain workers' compensation insurance, as required by Section 3700 of the Labor Code, for the performance of the work for which this permit is issued. My workers' compensation insurance carrier and policy number are:

Carrier STATE FUND Policy Number 1442812-98 Exp Date 10/01/1999

(This section need not be completed if the permit is for \$100 or less) I certify that in the performance of the work for which this permit is issued, I shall not employ any person in any manner so as to become subject to the workers' compensation laws of California and agree that if I should become subject to the workers' compensation provisions of Section 3700 of the Labor Code, I shall forthwith comply with those provisions.

Date 8/16/00 Applicant Signature [Signature]

WARNING - FAILURE TO SECURE WORKER'S COMPENSATION COVERAGE IS UNLAWFUL AND SHALL SUBJECT AN EMPLOYER TO CRIMINAL PENALTIES AND CIVIL FINES UP TO ONE HUNDRED THOUSAND DOLLARS (\$100,000) IN ADDITION TO THE COST OF COMPENSATION, DAMAGES AS PROVIDED FOR IN SECTION 3706 OF THE LABOR CODE, INTEREST AND ATTORNEY'S FEE.

THIS PERMIT SHALL EXPIRE BY LIMITATION IF WORK IS NOT COMMENCED WITHIN 180 DAYS.

RESIDENTIAL BUILDING PERMIT APPLICATION

New Construction Addition Remodels Other

Project Address: 2691 Pickering Way Assessor Parcel # 274-0540-031
Lot 31-3

OWNER INFORMATION:

Legal Property Owner: Epick Homes #1 LLC Phone # (530) 891-4757
 Owner Address: 1263 The Esplanade *C City Chico State Calif Zip 95926

CONTRACTOR INFORMATION:

Contractor: Epick Inc. Lic. # 463708 Phone # (530) 891-4757 Fax (530) 891-4206

PROJECT INFORMATION:

Land Use Zone RIA Occupancy Group R3 Construction Type VN Fed Code 1A
 No. of stories: 1 No. of rooms: 8 Street width: _____
 1st Floor Area 1987 2nd Floor Area _____ Basement _____ Roof Material conc. tile

AREA IN SQUARE FOOT OF:	EXISTING	NEW
Dwelling/Living	_____	<u>1987</u>
Garage/Storage	_____	<u>594 (434) opt.</u>
Decks/Balconies	_____	_____
Carports	_____	_____

SCOPE OF WORK: S.F.D.
M.P. 1987 (+ 100' retreat opt.)

FOR OFFICE USE ONLY:

- | | | |
|---|---|--|
| <input type="checkbox"/> Information above complete | <input type="checkbox"/> AR Flood Waiver required | <input type="checkbox"/> Planning Approval |
| <input type="checkbox"/> Violation files checked | <input type="checkbox"/> Flood Elevation Certificate Required | <input type="checkbox"/> Design Review Approval |
| <input type="checkbox"/> Standard setbacks | <input type="checkbox"/> Water Development Infill Area | <input type="checkbox"/> Special Fee Districts Apply : _____ |
| <input type="checkbox"/> County Sewer | | |

NEW STRUCTURES & ADDITIONS

❖ THE FOLLOWING MUST BE PROVIDED IN ORDER TO SUBMIT FOR PLAN REVIEW

- | | |
|---|---|
| <input type="checkbox"/> 2 COMPLETE PLANS, LEGIBLE & DRAWN TO SCALE | ❖ Plans to include: site plan, floor plan, elevations, roof/ceiling plan, foundation and structural framing details, and structural calculations for non-conforming structures. |
| <input type="checkbox"/> 3 SETS IF PROJECT IS IN A DESIGN REVIEW AREA | |
| <input type="checkbox"/> Title 24 Energy Compliance documentation | <input type="checkbox"/> 11" x 17" copy of floor plan for County Assessor |
| <input type="checkbox"/> Grading and Erosion Control Questionnaire | <input type="checkbox"/> Plan Review Fees |

Date: _____ Received by: (staff) _____

ACTIVITY/PERMIT #

NOV 15 2009
 Building Inspection Division



**INSULATION CONTRACTORS
ASSOCIATION
OF AMERICA**

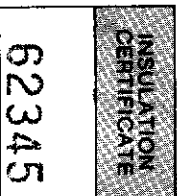

1321 DUKE STREET, SUITE 303 • ALEXANDRIA, VA 22314 • (703) 739-0356

THIS IS TO CERTIFY THAT INSULATION HAS BEEN INSTALLED IN CONFORMANCE WITH CURRENT ENERGY REGULATIONS, CALIFORNIA ADMINISTRATIVE CODE, TITLE 24, STATE OF CALIFORNIA, IN THE BUILDING LOCATED AT:

SPMC HOME'S INC. LOT # *315* TRACT # _____

STREET *2691 Redwing Way* CITY *SALTMARINE*

EXTERIOR WALLS:

MANUFACTURER _____ THICKNESS/TYPE _____ VALUE **R-**

CEILING:

BATTS: _____ THICKNESS/TYPE _____ VALUE **R-**

MANUFACTURER _____ THICKNESS/TYPE _____ VALUE _____

BLOWN IN: _____ MINIMUM _____ VALUE **R-**

MANUFACTURER *Rockwool* THICKNESS _____ VALUE **38**

SQUARE FOOTAGE COVERED _____ NUMBER OF BAGS USED *15* VALUE **15**

FLOORS: _____ THICKNESS/TYPE _____ VALUE **R-**

MANUFACTURER _____ THICKNESS/TYPE _____ VALUE _____

SLAB ON GRADE: _____ THICKNESS/TYPE _____ VALUE **R-**

MANUFACTURER _____ THICKNESS/TYPE _____ VALUE _____

WIDTH OF INSULATION _____ INCHES

FOUNDATION WALLS: _____ THICKNESS/TYPE _____ VALUE **R-**

MANUFACTURER _____ THICKNESS/TYPE _____ VALUE **1**

GENERAL CONTRACTOR _____ DATE _____
CALIFORNIA CONTRACTORS LICENSE # _____

SIGNATURE _____ TITLE _____

INSULATION CONTRACTOR **ARCADE INSULATION** DATE *4-12-01*
CALIFORNIA CONTRACTORS LICENSE #263784

SIGNATURE _____ TITLE _____

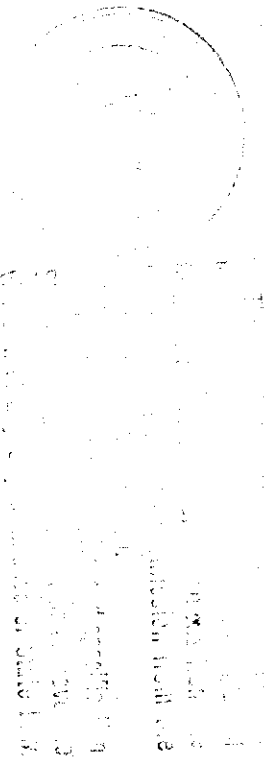
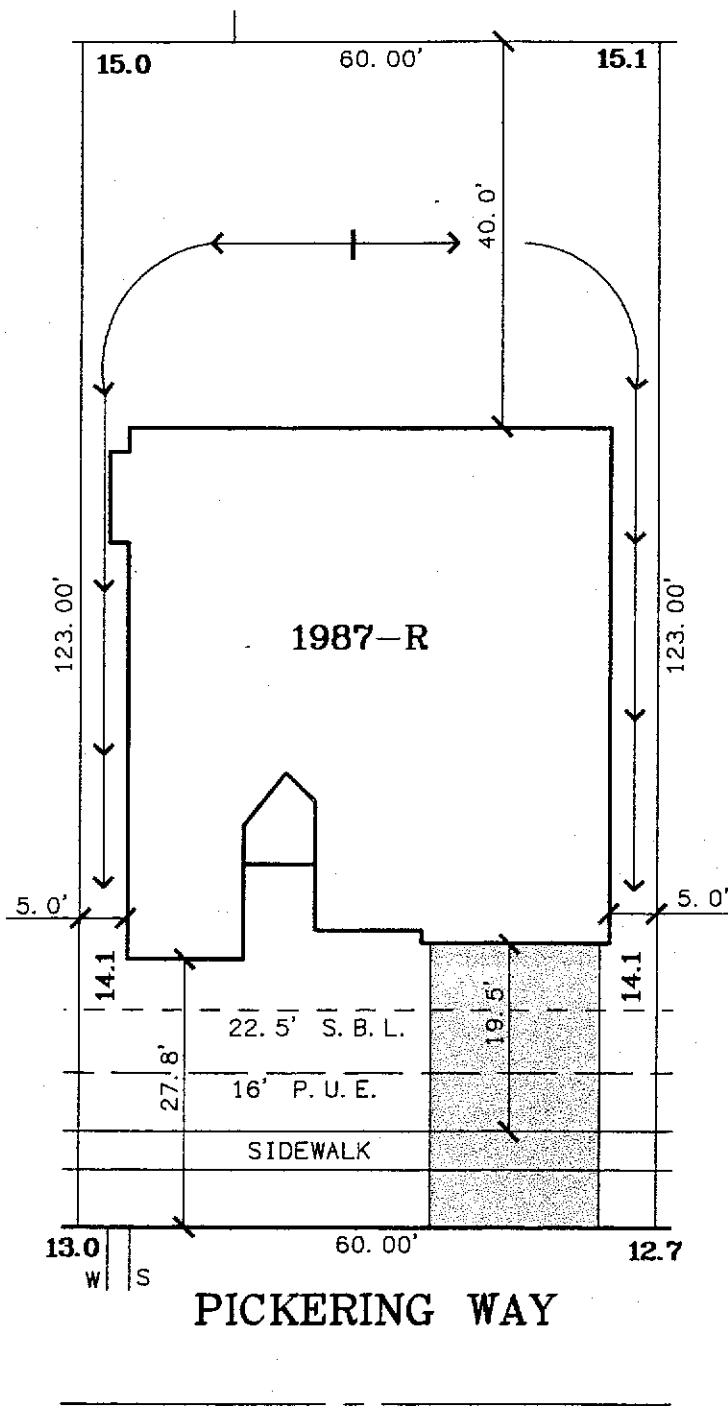

LOT AREA: 7,380 SQ.FT.

DRAWN: 11-15-99

A. P. N. :

ADDRESS : 2691 PICKERING WAY

APPROVED BY _____

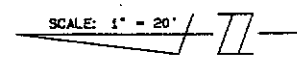

The Spink Corporation

2590 VENTURE OAKS WAY
SACRAMENTO, CA 95833

PH:(916)925-5550 FAX:(916)921-9274

HERITAGE PLACE

UNIT NO. 3

LOT 31-3

PLAN 1987

RIVERSGATE

CITY OF SACRAMENTO, CA.
CLIENT: EPICK HOMES #1, L.L.C.
JOB NO.: 2808-004