

CITY OF SACRAMENTO
1231 I Street, Sacramento, CA 95814

Permit No: 0104611
Insp Area: 2

Site Address: 7559 WHITMORE ST SAC
Parcel No: 117-1380-046 LAGUNA V N 2 LOT 129

Sub-Type: NSFR
Housing (Y/N): N

CONTRACTOR
D. R. HORTON INC
110 BLUE RAVINE RD STE. 209
FOLSOM CA. 95630

OWNER

ARCHITECT

Nature of Work: MP 1591 2 STORY 7 ROOM SFR

CONSTRUCTION LENDING AGENCY: I hereby affirm under penalty of perjury that there is a construction lending agency for the performance of the work for which this permit is issued (Sec. 3097, Civ. C).

Lender's Name _____ Lender's Address _____

LICENSED CONTRACTORS DECLARATION: I hereby affirm under penalty of perjury that I am licensed under provisions of Chapter 9 (commencing with section 7000) of Division 3 of the Business and Professions Code and my license is in full force and effect.

License Class D License Number 750190 Date 04/20/01 Contractor Signature N. Collins

OWNER-BUILDER DECLARATION: I hereby affirm under penalty of perjury that I am exempt from the contractors License Law for the following reason (Sec. 7031.5, Business and Professions Code): any city or county which requires a permit to construct, alter, improve, demolish, or repair any structure, prior to its issuance, also requires the applicant for such permit to file a signed statement that he or she is licensed pursuant to the provisions of the Contractors License Law (Chapter 9 (commencing with Section 7000) of Division 8 of the Business and Professions Code) or that he or she is exempt therefrom and the basis for the alleged exemption. Any violation of Section 7031.5 by any applicant for a permit subjects the applicant to a civil penalty of not more than five hundred dollars (\$500.00).

I, as a owner of the property, or my employees with wages as their sole compensation, will do the work, and the structure is not intended or offered for sale (Sec. 7044, Business and Professions Code). The Contractors License Law does not apply to an owner of property who builds or improves thereon, and who does such work himself or herself or through his/her own employees, provided that such improvements are not intended or offered for sale. If, however, the building or improvement is sold within one year of completion, the owner-builder will have the burden of proving that he/she did not build or improve for the purpose of sale.

I, as owner of the property, am exclusively contracting with licensed contractors to construct the project (Sec. 7044, Business and Professions Code). The Contractors License Law does not apply to an owner of property who builds or improves thereon, and who contracts for such projects with a contractor(s) licensed pursuant to the Contractors License Law.

I am exempt under Sec. _____ B & PC for this reason: _____

Date _____ Owner Signature _____

IN ISSUING THIS BUILDING PERMIT, the applicant represents, and the city relies on the representation of the applicant, that the applicant verified all measurements and locations shown on the application or accompanying drawings and that the improvement to be constructed does not violate any law or private agreement relating to permissible or prohibited locations for such improvements. This building permit does not authorize any illegal location of any improvement or the violation of any private agreement relating to location of improvements.

I certify that I have read this application and state that all information is correct. I agree to comply with all city and county ordinances and state laws relating to building construction and hereby authorize representative(s) of this city to enter upon the abovementioned property for inspection purposes.

Date 04/20/01 Applicant Agent Signature N. Collins

WORKER'S COMPENSATION DECLARATION: I hereby affirm under penalty of perjury one of the following declarations:

I have and will maintain a certificate of consent to self-insure for workers' compensation as provided for by Section 3700 of the Labor Code, for the performance of work for which the permit is issued.

I have and will maintain workers' compensation insurance, as required by Section 3700 of the Labor Code, for the performance of the work for which this permit is issued. My workers' compensation insurance carrier and policy number are:

Carrier ARGONAUT INS CO Policy Number WC62600115505 Exp Date 07/01/2000

(This section need not be completed if the permit is for \$100 or less) I certify that in the performance of the work for which this permit is issued, I shall not employ any person in any manner so as to become subject to the workers' compensation laws of California and agree that if I should become subject to the workers' compensation provisions of Section 3700 of the Labor Code, I shall forthwith comply with those provisions.

Date 04/20/01 Applicant Signature N. Collins

WARNING: FAILURE TO SECURE WORKER'S COMPENSATION COVERAGE IS UNLAWFUL AND SHALL SUBJECT AN EMPLOYER TO CRIMINAL PENALTIES AND CIVIL FINES UP TO ONE HUNDRED THOUSAND DOLLARS (\$100,000) IN ADDITION TO THE COST OF COMPENSATION, DAMAGES AS PROVIDED FOR IN SECTION 3706 OF THE LABOR CODE, INTEREST AND ATTORNEY'S FEE.

THIS PERMIT SHALL EXPIRE BY LIMITATION IF WORK IS NOT COMMENCED WITHIN 180 DAYS.

RESIDENTIAL SUBDIVISION BUILDING PERMIT APPLICATION

Project Address: 7559 Whitmore Street Assessor Parcel # _____
 Lot Number: 129 Subdivision Laguna Vega

OWNER INFORMATION:

Legal Property Owner: D.R. HORTON Phone# 965-2200
 Owner Address: 4401 Hazel Ave. #135, City Fair Oaks, State Ca Zip 95628

0104611

CONTRACTOR INFORMATION:

Contractor: DA HORTON Lic. # 750190 Phone # 965-2200 Fax 956-22

PROJECT INFORMATION:

Land Use Zone R1A Occupancy Group R3 Construction Type VN Fed Code 1A
 No. of Stories: 2 No. of Rooms: 7 Street Width: _____
 1st Floor Area 716 2nd Floor Area 875 Basement _____ Roof Material _____

AREA IN SQUARE FOOT OF:

Dwelling/Living 1591
 Garage/Storage 435
 Decks/Balconies 72
 Carports _____

SCOPE OF WORK: _____

FOR OFFICE USE ONLY

- Information Above Complete
- Violation Files Checked
- Standard Setbacks
- County Sewer
- AR Flood Waiver Required
- Flood Elevation Certificate Required
- Water Development Infill Area
- Planning Approval
- Design Review Approval
- Special Fee Districts Apply:

THE FOLLOWING MUST BE PROVIDED IN ORDER TO SUBMIT FOR PERMIT

- 2 COMPLETE PLOT PLANS, LEGIBLE & DRAWN TO SCALE
- 11 X 17 COPY OF FLOOR PLAN WITH FOLLOWING INFORMATION
 - a) Assessor's Parcel Number
 - b) New Floor Area
 - c) Owners Name
 - d) Project Address

OMEGA PRODUCTS CORP.

DIAMOND WALL INSULATING STUCCO SYSTEM

JOB ADDRESS:

7559 WHITMORE ST
ELK GROVE, CA 95758

ICBO Report #4004

Date of Job Completion Aug 29 2001

PLASTERING CONTRACTOR:

Name: STUCCO WORKS INC.
Address: 5900 WAREHOUSE WAY, SACRAMENTO, CALIFORNIA 95826
Telephone No: (916) 383-6699

Contractor Number of Diamond Wall System 2175

This is to certify that the exterior coating system on the building exterior at the above address has been installed in accordance with the evaluation report specified above and the manufacturer's instructions.

Date

Oct. 3 2001

Signature of authorized representative of
Plastering Contractor

This installation card must be presented to the building inspector after completion of work and before final inspection.

CERTIFICATION OF INSULATION

| | |
|--|--|
| ADDRESS OR TRACT <div style="font-size: 2em; font-family: cursive;">D.A. HORTON</div> <div style="margin-left: 200px;">LOT # 129</div> <div style="margin-top: 20px; font-size: 1.5em; font-family: cursive;">LAGUNA VEGA</div> | SACRAMENTO INSULATION CONTRACTORS <input checked="" type="checkbox"/> P.O. BOX 854, WEST SACRAMENTO, CA 95691 LIC. #202026 <input type="checkbox"/> 1309 MELODY ROAD, MARYSVILLE, CA 95901 LIC. #202026 <input type="checkbox"/> P.O. BOX 9651, FRESNO, CA 93793-9651 LIC. #202026 <input type="checkbox"/> P.O. BOX 1631, RENO, NV 89505 LIC. #10675 <input type="checkbox"/> 3326 A PONDEROSA WAY, LAS VEGAS, NV 89118 LIC. #10675 DATE INSULATION COMPLETED |
|--|--|

| WALLS | | CEILING | | | FLOORS | |
|---|-------------------|------------------------------|-------------------|---------------------------------------|-----------------------------|-------------------|
| (SQUARE FEET) | | (SQUARE FEET) | | | (SQUARE FEET) | |
| TYPE OF INSULATION | | TYPE OF INSULATION | | | TYPE OF INSULATION | |
| MATERIAL FIBERGLASS | | MATERIAL FIBERGLASS | | | MATERIAL FIBERGLASS | |
| FORM BATTS | | FORM BATTS & BLOW | | | FORM BATTS | |
| MANUFACTURER'S PRODUCT I.D. | | MANUFACTURER'S PRODUCT I.D. | | | MANUFACTURER'S PRODUCT I.D. | |
| MANUFACTURER | | MANUFACTURER | | | MANUFACTURER | |
| OCF | | OCF | | | OCF | |
| BAGS | | | | | | |
| R-VALUE INSTALLED | APPLIED THICKNESS | R-VALUE INSTALLED | APPLIED THICKNESS | MIN. INSTALLED WEIGHT PER SQUARE FOOT | R-VALUE INSTALLED | APPLIED THICKNESS |
| 13 19 | 3 1/4" 5 1/2" | 30 30 | 9" 12" | | | |
| KNEE WALLS IF R-VALUE IS OTHER THAN WALLS ABOVE | | | | | | |
| MATERIAL FIBERGLASS | | FORM BATTS | | R VALUE | MANUFACTURER OCF | |
| AIR INFILTRATION SEALANT | | | | | | |
| MATERIAL FOAM | | | | MANUFACTURER W R GRACE | | |

THIS IS TO CERTIFY THAT INSULATION AND/OR SEALANT HAS BEEN INSTALLED IN CONFORMANCE WITH APPLICABLE CODES, MATERIAL STANDARDS AND REGULATIONS.

| | | |
|---|------------------|-----------------|
| SIGNATURE—INSULATION CONTRACTOR <i>Bill Taylor</i> | TITLE MANAGER | DATE 8-13-01 |
| SIGNATURE—GENERAL CONTRACTOR | TITLE | DATE |
| REMARKS | | |

149

148

45.00'

128

130

LOT 129
PLAN 3B
FF 28.4
PAD 27.9

NOTE:

THE FOOTPRINTS AND DIMENSIONS SHOWN HEREON ARE FOR PLANNING PURPOSES & SHOULD ONLY BE USED AS A GUIDE. ACTUAL AS-BUILT CONDITIONS MAY VARY AND ARE BEYOND THE CONTROL OF MORTON & PITALO, INC. AND D.R. HORTON, INC. MINIMUM SETBACK REQUIREMENTS SHALL BE ADHERED TO AND ALL OTHER DIMENSIONS AS SHOWN MAY BE ADJUSTED ACCORDINGLY.

AREAS:

HOUSE AND GARAGE = 1174 SF
TOTAL LOT AREA = 4,674 SF
LOT COVERAGE = 25.1%

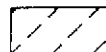
 = SECOND FLOOR

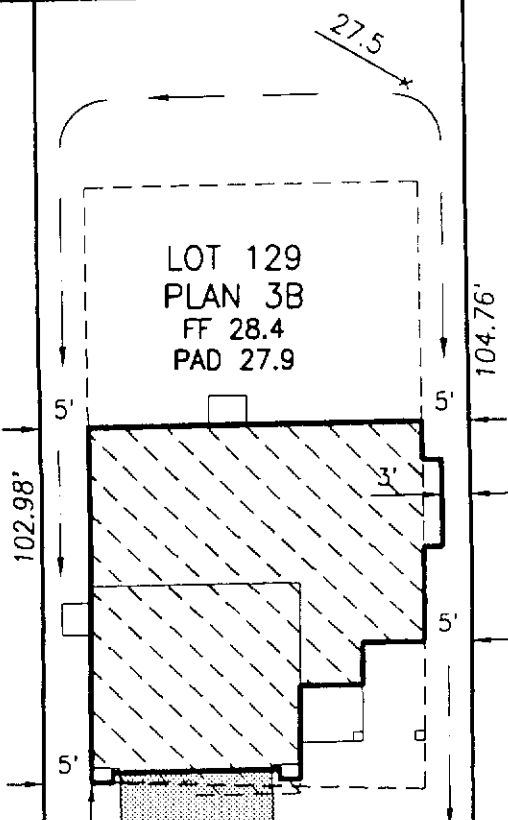

15' SBL
12.5' PUE

20'

DWY

41.51'

3.52'

26.1

WS
SS

WS
SS

WS
SS

WHITMORE STREET

X:\PROJ\000077.01\DWG\00077129.DWG 03-05-01 10:31 am



MORTON & PITALO, INC.

CIVIL ENGINEERING • PLANNING • SURVEYING
1788 TRIBUTE ROAD • SUITE 200 • SACRAMENTO, CA 95815
PHONE: 916/927-2400 • FAX: 916/567-0120

PLOT PLAN

**LAGUNA VEGA NORTH
VILLAGE 2
LOT 129**

SACRAMENTO, CALIFORNIA

| | | | |
|----------|----------|---------|-----------|
| DRAWN: | GBH | JOB NO: | 000077.01 |
| CHECKED: | GBH | DATE: | MAR 2001 |
| SCALE: | 1" = 20' | SHEET: | 1 of 1 |