

**RESOLUTION NO.** 2005-047

**ADOPTED BY THE CITY OF SACRAMENTO**  
**ON DATE:** FEB 01 2005

**RESOLUTION TO APPROVE THE LINDEN PARK NAME, MASTER PLAN, AND CERTIFY THE ENVIRONMENTAL DOCUMENTS CIP (PN: LW61).**

WHEREAS, the Environmental Coordinator has prepared an Addendum to the adopted Natomas Crossing-Alleghany Area #2 Negative Declaration for the above project;

WHEREAS, in accordance with Section 21081.6 of the California Public Resources Code, the City of Sacramento requires that a Mitigation Reporting Plan be developed for implementing mitigation measures as identified in the Initial Study for the project;

WHEREAS, the Environmental Coordinator has prepared a Mitigation Reporting Plan for ensuring compliance and implementation of the mitigation measures as prescribed in the Initial Study for the above identified project;

WHEREAS, this Addendum to the Natomas Crossing-Alleghany Area #2 Negative Declaration reflects the lead agency's independent judgment and analysis;

WHEREAS, the City Council has considered the Addendum and the Negative Declaration and determined that the environmental impacts of the proposed Linden Park are within the scope of analysis contained in the Natomas Crossing-Alleghany Area #2 Mitigated Negative Declaration and no new impacts have been identified.

Based upon the record as a whole, including the Initial Study and in the City Council's exercise of its independent judgment, there is no substantial evidence, either individually limited or cumulatively considerable, that the project will have a significant effect on the environment.

---

**FOR CITY COUNCIL USE ONLY**

**RESOLUTION NO.:** 2005-047

**DATE ADOPTED:** FEB 01 2005

**NOW, THEREFORE BE IT RESOLVED BY THE SACRAMENTO CITY COUNCIL THAT:**

The City Council, hereby:

1. Reaffirms the Addendum to the adopted Natomas Crossing-Alleghany Area #2 Mitigated Negative Declaration;
2. Approves the name change for Park 4B to "Linden Park;" and
3. Approves the Linden Park Master Plan.

**HEATHER FARGO**

\_\_\_\_\_  
MAYOR

ATTEST:  
SHIRLEY CONCOLINO

\_\_\_\_\_  
CITY CLERK

---

**FOR CITY COUNCIL USE ONLY**

RESOLUTION NO.: \_\_\_\_\_

2005-047

DATE ADOPTED: \_\_\_\_\_

FEB 0 1 2005

EXHIBIT A

MASTER PLAN

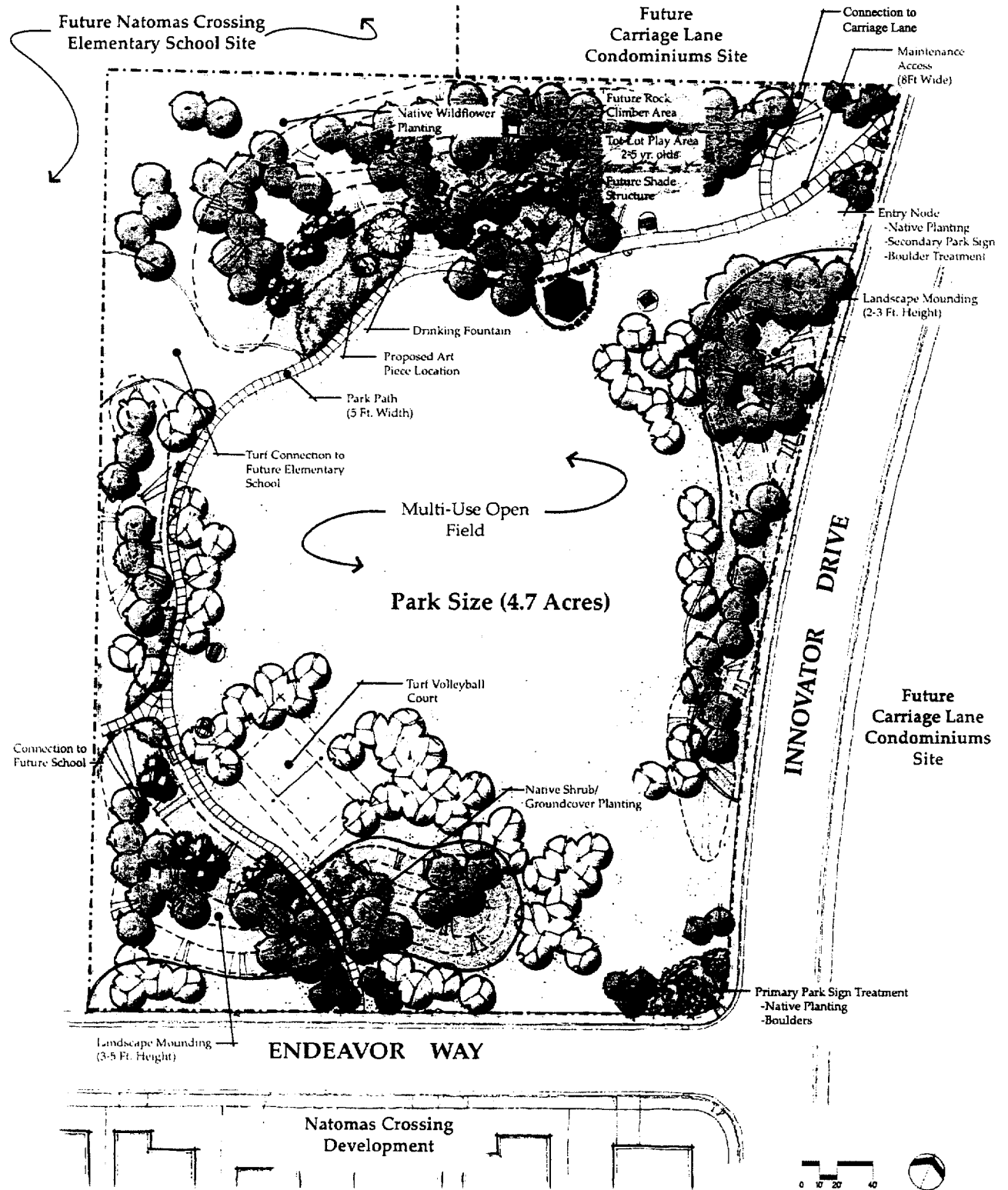

Callander Associates Landscape Architecture, Inc.

Parks and Recreation Planning  
Landscape Architecture

September 3, 2004

LINDEN PARK

The City of Sacramento

Park Planning/ Design Development Division

7

EXHIBIT B

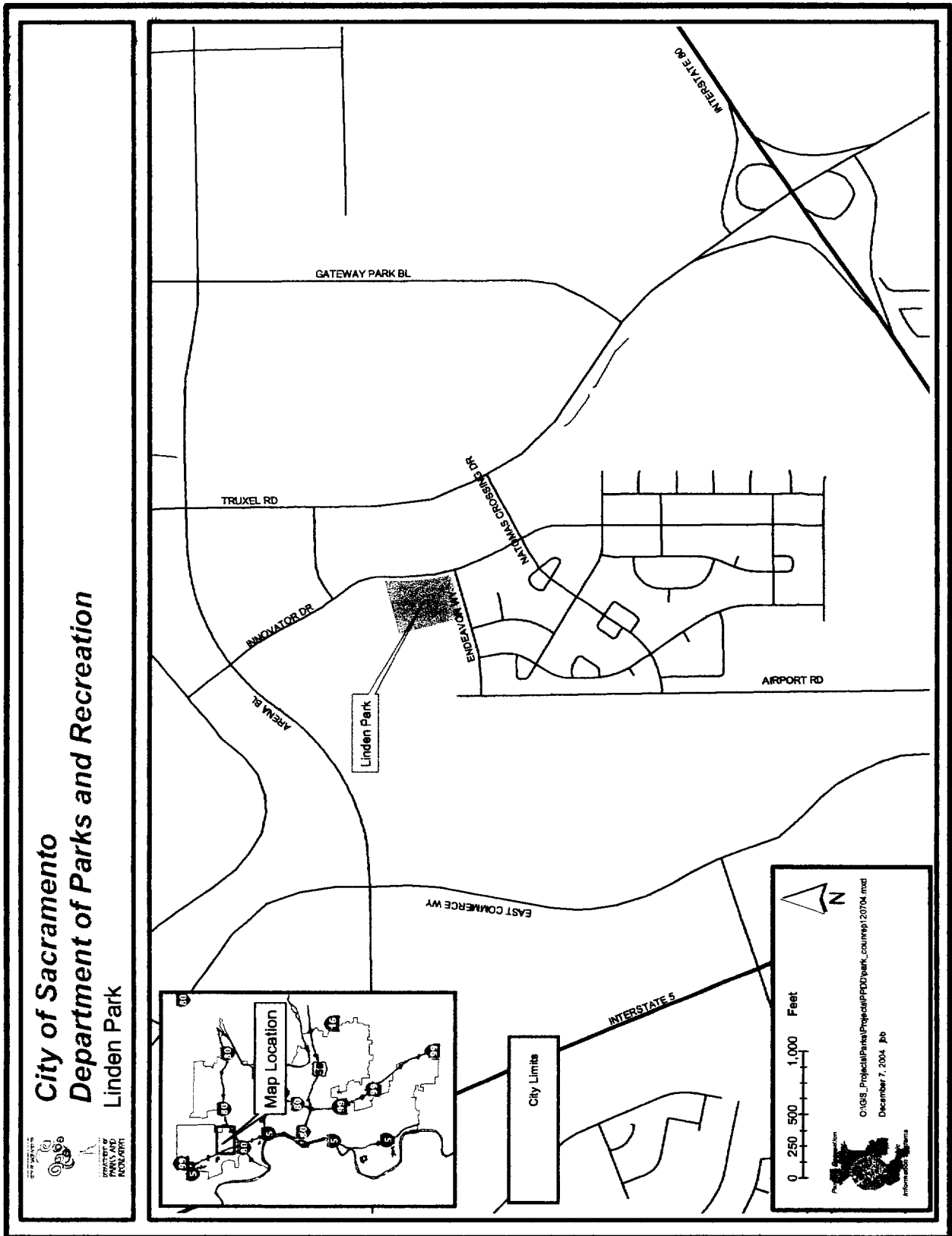

## EXHIBIT C

### **Linden Park 4B (CIP#LW61) Mitigation Reporting Plan**

In January 1989, Assembly Bill 3180 went into effect requiring the City to monitor all mitigation measures included in this Negative Declaration. For this project, mitigation reporting will be performed by the City of Sacramento, Department of Parks and Recreation in accordance with the monitoring and reporting program developed by the City to implement AB 3180.

This Mitigation Reporting Plan is being prepared by the Development Services Department, Environmental Planning Services, 1231 I Street, Suite 300, Sacramento, CA 95814, (916) 808-5375, pursuant to the California Environmental Quality Guidelines, Section 21081.

The Department of Parks and Recreation will submit its completed Reporting Plan to the Environmental Planning Services for inclusion in the annual report to the City Council.

**Project Number:** CIP# LW61

**Project Name:** Linden Park 4B

**Project Location:** The project site is located at 4001 Innovator Drive, APN 225-1250-015 within the North Natomas Community Plan area. The project site is located at the northwest corner of Endeavor Way and Innovator Drive.

**Project Description:** The City of Sacramento, Parks and Recreation Department is proposing to construct an 4.7± acre sized park with improvements including a turf volleyball court, open field, landscaping, walkway, drinking fountain, and tot lot.

**LINDEN PARK PROJECT (CIP#LW61)  
MITIGATION MONITORING PLAN**

Mitigation Measure		VERIFICATION OF COMPLIANCE			
Implementing Responsibility	Monitoring Responsibility	Compliance Standards	Timing	Verification of Compliance (Initials/Date)	
<p><b>Air</b></p> <p>Mitigation Measure #2: The project proponent shall comply with the following short term construction mitigation:</p> <ol style="list-style-type: none"> <li>1. All sites shall be graded such that the new topography makes a smooth transition to existing adjacent topography.</li> <li>2. Dust and soil erosion control measures shall be implemented during the construction phases of all projects. These measures are intended to minimize soil erosion and fugitive dust emissions. Suggested measures include:               <ol style="list-style-type: none"> <li>a. watering exposed soils;</li> <li>b. covering exposed soils with straw or other materials;</li> <li>c. adopting measures to prevent construction vehicles from tracking mud onto adjacent roadways;</li> <li>d. covering trucks containing loose and dry soil; and</li> <li>e. providing interim drainage measures during the construction period</li> </ol> </li> <li>3. In non-pavement areas, any vegetation covered or removed during grading or construction (including slope protection) should be replanted following the construction activities.</li> </ol>	<p>City of Sacramento, Dept. of Parks and Recreation</p>	<p>SMAQMD</p>	<p>Construction documents showing the mitigation measure.</p> <p style="text-align: center;">During construction</p>	<p style="text-align: center;">EXHIBIT D</p>	

**LINDEN PARK PROJECT (CIP#LW61)  
MITIGATION MONITORING PLAN**

Mitigation Measure	VERIFICATION OF COMPLIANCE			
	Implementing Responsibility	Monitoring Responsibility	Compliance Standards	Timing Verification of Compliance (Initials/Date)
<p><b>Plant and Animal Life:</b></p> <p>Mitigation Measure #6 shall be replaced with the following:</p> <p>Mitigation Measure: The project proponent shall: (i) comply with all requirements of the 2003 NBHCP, together with any additional requirements specified in the North Natomas Community Plan EIR; (ii) comply with any additional mitigation measures identified in the NBHCP EIR/EIS; and (iii) comply with all conditions in the ITPs issued by the USFWS and CDFG.</p>	<p>City of Sacramento, Dept. of Parks and Recreation</p>	<p>USFWS, DFG</p>	<p>Submittal of a pre-construction survey.</p>	<p>Prior to grading activities.</p>

**LINDEN PARK PROJECT (CIP#LW61)  
MITIGATION MONITORING PLAN**

Mitigation Measure	VERIFICATION OF COMPLIANCE			
	Implementing Responsibility	Monitoring Responsibility	Compliance Standards	Timing Verification of Compliance (Initials/Date)
<p><b>Cultural Resources</b></p> <p>Mitigation Measure #12: If subsurface archaeological or historical remains (including unusual amounts of bones, stones, or shells) are discovered during excavation or construction of the site, work shall stop immediately and a qualified archaeologist and a representative of the Native American Heritage Commission shall be consulted to develop, if necessary, further mitigation measures to reduce any archaeological impact to a less-than-significant level before construction continues.</p>	City Parks and Recreation Dept.	City Development Services Department	Note shall be included on the Map and within the Standard Construction Specifications	Measures shall be implemented in field during grading and construction activities.

12



**FINDINGS****Introduction**

Pursuant to the California Environmental Quality Act (Public Resources Code Section 21000) (CEQA) and Section 15153 of the CEQA Guidelines, the City has concluded that the Negative Declaration for the Natomas Crossing – Alleghany Area #2 PUD (#P96-083) adequately describes the environmental effects of the proposed Linden Park project. The Adopted Negative Declaration was a programmatic evaluation of potential environmental impacts resulting from the development and implementation of the Natomas Crossing – Alleghany Area #2 PUD. The addendum to the Adopted Negative Declaration provides a description of the proposed park project and an evaluation of the potential differences in environmental impacts relative to what was disclosed in the original Adopted Negative Declaration.

**Relationship of the Proposed Project to the Natomas Crossing – Alleghany Area #2 PUD (#P96-083) Negative Declaration**

The original Negative Declaration for the Natomas Crossing – Alleghany Area #2 PUD evaluated the necessary entitlements to develop the PUD. The entitlements for the Natomas Crossing – Alleghany Area #2 PUD included the development of parks within the PUD, including the proposed Linden Park. The proposed development of Linden Park will not result in any new impacts or any more severe impacts than those previously evaluated and identified in the original Natomas Crossing – Alleghany Area #2 PUD Negative Declaration (#P96-083).

It has been determined that implementation of the Proposed Project would not create any new or additional significant environmental impacts that were not already evaluated in the adopted Negative Declaration, nor would it increase the severity of any such impacts. As a result, an addendum to the Adopted Negative Declaration was prepared in accordance with State CEQA Guidelines 15164. Therefore, no new findings with respect to the impacts of the proposed project are warranted. The addendum summarizes the details and/or modifications to the Adopted Negative Declaration.

**Decision not to prepare a Subsequent Negative Declaration/Conclusion**

CEQA Section 15162 requires the preparation of a Subsequent Negative Declaration when substantial changes to a project will require revisions to a previous Negative Declaration due to:

- involvement of new significant environmental effects; or
- a substantial increase in severity of previously identified environmental effects; or
- new information of substantial importance, which was not known and could not have been known with the exercise of reasonable diligence at the time the negative declaration was adopted; or
- mitigation measures previously found not to be feasible would in fact be feasible and would substantially reduce one or more significant effects of the project, but the project proponents decline to adopt the mitigation measure; or

## EXHIBIT E

### Exhibit E

- mitigation measures which are considerably different from those analyzed in the previous negative declaration would substantially reduce one or more significant effects on the environment, but the project proponents decline to adopt the mitigation measure

Under the proposed project, the City has decided that an Addendum is appropriate to make the Negative Declaration for Natomas Crossing – Alleghany Area #2 PUD (#P96-083) adequate to address the impacts of the Linden Park Project (CIP# LW61). The adopted mitigation measures and impact conclusions in the Natomas Crossing – Alleghany Area #2 PUD Negative Declaration (#P96-083) remain unchanged.

R 2005-048

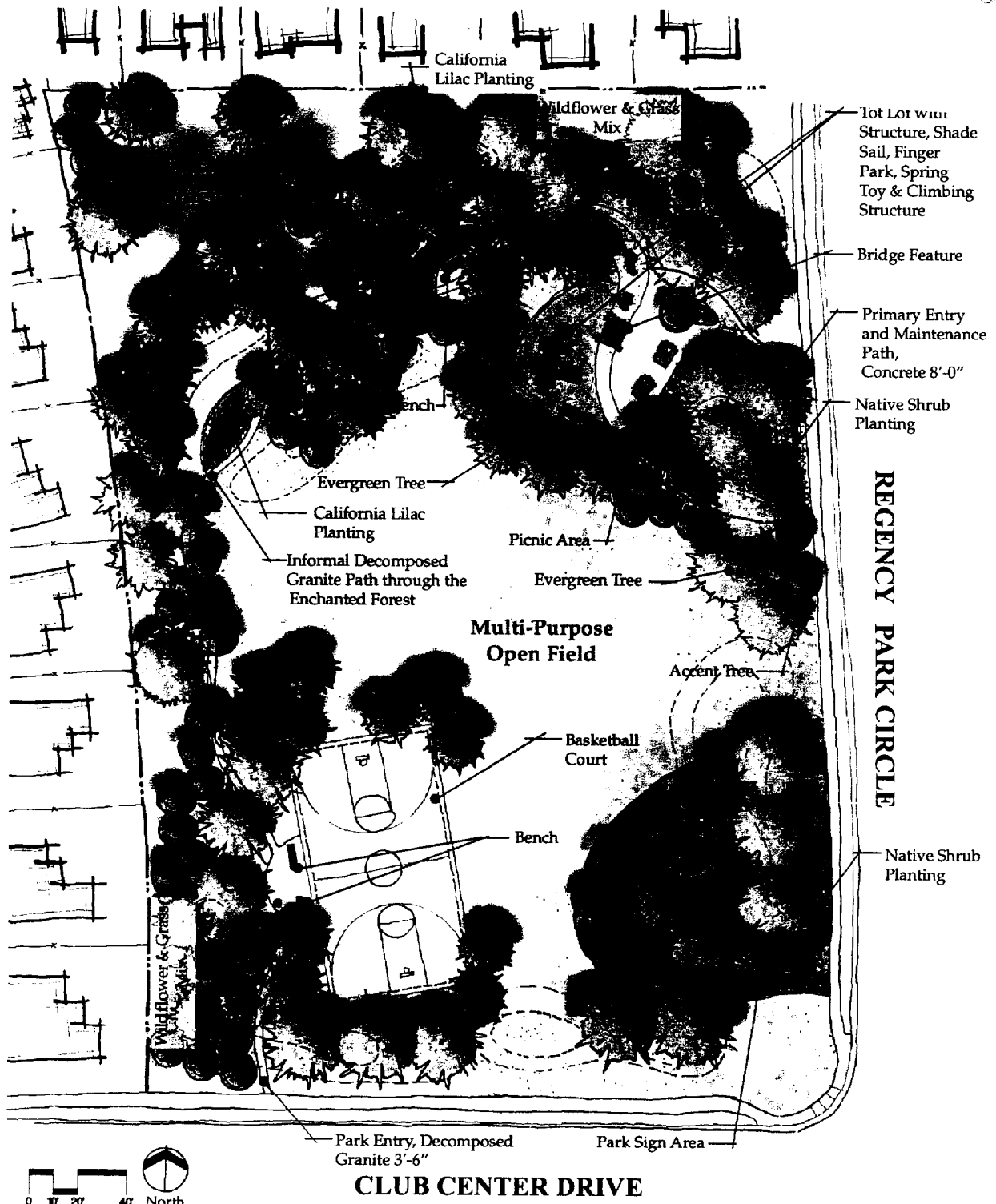

Callander Associates Landscape Architecture, Inc.

Parks and Recreation Planning  
Landscape Architecture

September 15, 2004

CALIFORNIA LILAC PARK

The City of Sacramento

Park Planning/ Design Development Division

11-201 California M&T Park - 11/15/04 (revised) 2004 Callander Associates Landscape Architecture, Inc.

EXHIBIT B

City of Sacramento  
 Department of Parks and Recreation  
 California Lilac Park

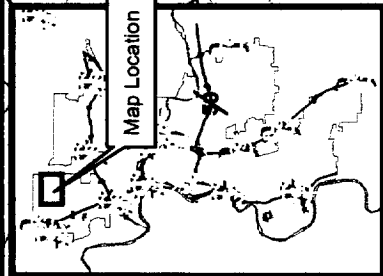
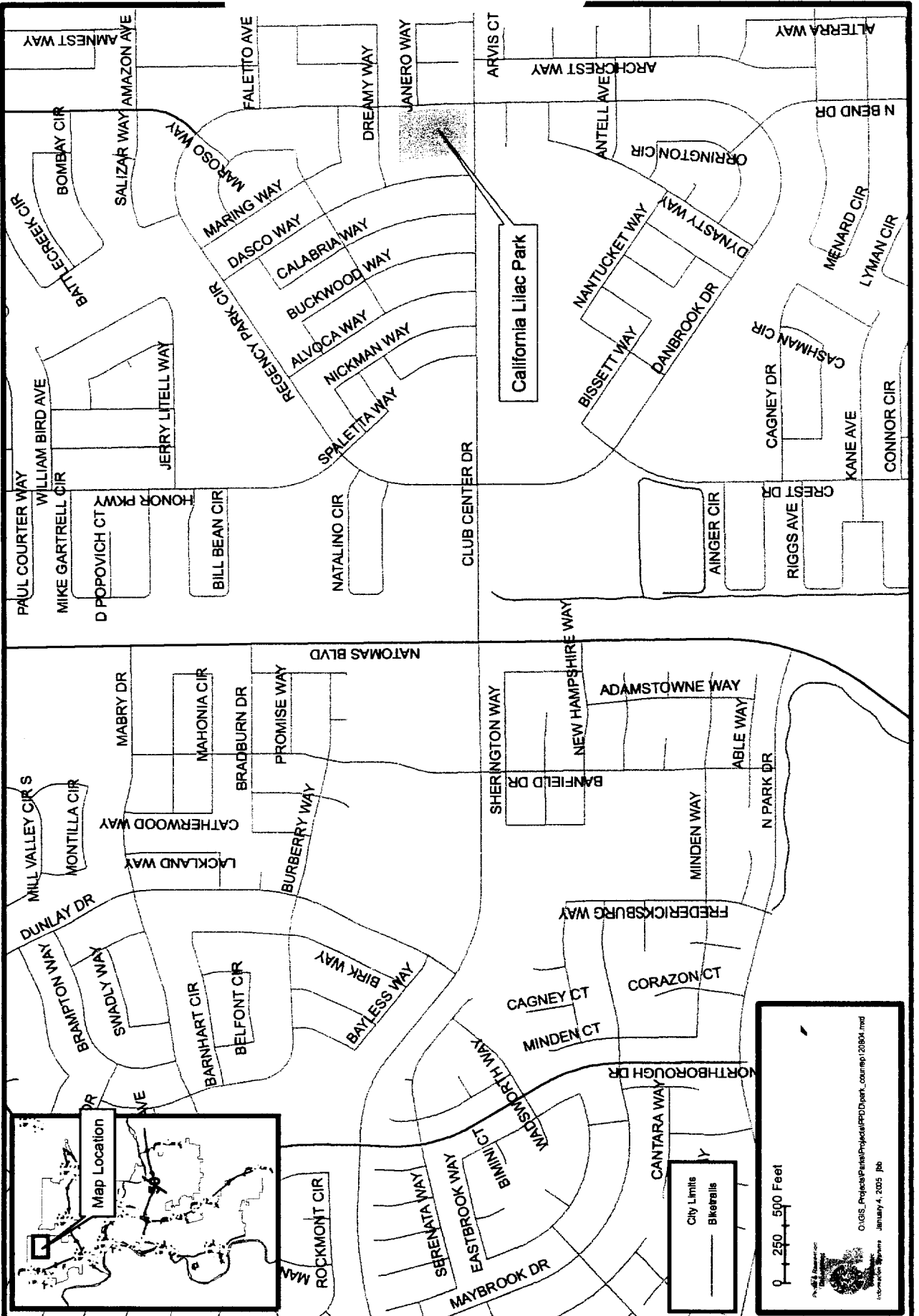

City Limits  
 Bikepaths

0 250 500 Feet

GIS Project: Parks/Projects/PPD/Dept\_courmap120804.mxd  
 January 4, 2005 jbb

## EXHIBIT C

### California Lilac Park (CIP#LW66) Mitigation Reporting Plan

In January 1989, Assembly Bill 3180 went into effect requiring the City to monitor all mitigation measures included in this Negative Declaration. For this project, mitigation reporting will be performed by the City of Sacramento, Department of Parks and Recreation in accordance with the monitoring and reporting program developed by the City to implement AB 3180.

This Mitigation Reporting Plan is being prepared by the Development Services Department, Environmental Planning Services, 1231 I Street, Suite 300, Sacramento, CA 95814, (916) 808-5375, pursuant to the California Environmental Quality Guidelines, Section 21081.

The Department of Parks and Recreation will submit its completed Reporting Plan to the Environmental Planning Services for inclusion in the annual report to the City Council.

**Project Number:** CIP# LW66

**Project Name:** California Lilac Park

**Project Location:** The proposed project is located at 1601 Club Center Drive, APN 201-0540-038 within the North Natomas Community Plan area. The project site is located at the northwest corner of Club Center Drive and Regency Park Circle.

**Project Description:** The proposed project consists of a perennial garden area, landscaping, tot lot with a structure, shade sail, finger park, spring toy and climbing structure, a bridge feature, a decomposed granite pathway, a multi-purpose open field, benches, a basketball court, and a picnic area.

**CALIFORNIA LILAC PARK PROJECT (CIP#LW66)  
MITIGATION MONITORING PLAN**

Mitigation Measure	Implementing Responsibility	Monitoring Responsibility	VERIFICATION OF COMPLIANCE	
			Compliance Standards	Timing Verification of Compliance (Initials/Date)
<p><b>Plant and Animal Life:</b></p> <p>Mitigation Measures #5 and #6 shall be replaced with the following:</p> <p>Mitigation Measure: The project proponent shall: (i) comply with all requirements of the 2003 NBHCP, together with any additional requirements specified in the North Natomas Community Plan EIR; (ii) comply with any additional mitigation measures identified in the NBHCP EIR/EIS; and (iii) comply with all conditions in the ITPs issued by the USFWS and CDFG.</p>	<p>City of Sacramento, Dept. of Parks and Recreation</p>	<p>USFWS, DFG</p>	<p>Submittal of a pre-construction survey.</p>	<p>Prior to grading activities.</p>
<p>Mitigation Measure #7</p> <p>The project proponent shall comply with the following short term construction mitigation:</p> <ol style="list-style-type: none"> <li>All sites shall be graded such that the new topography makes a smooth transition to existing adjacent topography.</li> <li>Dust and soil erosion control measures shall be implemented during the construction phases of all projects. These measures are intended to minimize soil erosion and fugitive dust emissions. Suggested measures include: <ul style="list-style-type: none"> <li>a. watering exposed soils;</li> <li>b. covering exposed soils with straw or other materials;</li> <li>c. adopting measures to prevent construction vehicles from tracking mud onto adjacent roadways;</li> <li>d. covering trucks containing loose and dry soil; and</li> <li>e. providing interim drainage measures during the construction period</li> </ul> </li> <li>In non-pavement areas, any vegetation covered or</li> </ol>	<p>City of Sacramento, Dept. of Parks and Recreation</p>	<p>SMAQMD</p>	<p>Notation of mitigation measures on all construction documents.</p>	<p>EXHIBIT D</p>

**CALIFORNIA LILAC PARK PROJECT (CIP#LW66)  
MITIGATION MONITORING PLAN**

Mitigation Measure	Implementing Responsibility	Monitoring Responsibility	VERIFICATION OF COMPLIANCE		
			Compliance Standards	Timing	Verification of Compliance (Initials/Date)
removed during grading or construction (including slope protection) should be replanted following the construction activities.					

**CALIFORNIA LILAC PARK PROJECT (CIP#LW66)  
MITIGATION MONITORING PLAN**

Mitigation Measure	VERIFICATION OF COMPLIANCE			
	Implementing Responsibility	Monitoring Responsibility	Compliance Standards	Timing Verification of Compliance (Initials/Date)
<p><b>Cultural Resources</b></p> <p>Mitigation Measure #13: If subsurface archaeological , or pre-historical, or historical remains (including unusual amounts of bones, stones, or shells) are discovered during excavation or construction of the site, work shall stop immediately and a qualified archaeologist and a representative of the Native American Heritage Commission shall be consulted to develop, if necessary, further mitigation measures to reduce any archaeological impact to a less-than-significant level before construction continues.</p>	City Dept. of Parks and Recreation	City Development Services Department	Note shall be included on the Map and within the Standard Construction Specifications	Measures shall be implemented in field during grading and construction activities.



## FINDINGS

### **Introduction**

Pursuant to the California Environmental Quality Act (Public Resources Code Section 21000) (CEQA) and Section 15153 of the CEQA Guidelines, the City has concluded that the Negative Declaration for the Northpointe Park (PUD) (#P96-058) adequately describes the environmental effects of the proposed California Lilac Park project. The Adopted Negative Declaration was a programmatic evaluation of potential environmental impacts resulting from the development and implementation of the Northpointe Park PUD. The addendum to the Adopted Negative Declaration provides a description of the proposed park project and an evaluation of the potential differences in environmental impacts relative to what was disclosed in the original Adopted Negative Declaration.

### **Relationship of the Proposed Project to the Northpointe Park PUD (#P96-058) Negative Declaration**

The original Negative Declaration for the Northpointe Park PUD evaluated the necessary entitlements to develop the PUD. The entitlements for the Northpointe Park PUD included the development of parks within the PUD, including the proposed California Lilac Park. The proposed development of California Lilac Park will not result in any new impacts or any more severe impacts than those previously evaluated and identified in the original Northpointe Park PUD Negative Declaration (#P96-058).

It has been determined that implementation of the Proposed Project would not create any new or additional significant environmental impacts that were not already evaluated in the adopted Negative Declaration, nor would it increase the severity of any such impacts. As a result, an addendum to the Adopted Negative Declaration was prepared in accordance with State CEQA Guidelines 15164. Therefore, no new findings with respect to the impacts of the proposed project are warranted. The addendum summarizes the details and/or modifications to the Adopted Negative Declaration.

### **Decision not to prepare a Subsequent Negative Declaration/Conclusion**

CEQA Section 15162 requires the preparation of a Subsequent Negative Declaration when substantial changes to a project will require revisions to a previous Negative Declaration due to:

- involvement of new significant environmental effects; or
- a substantial increase in severity of previously identified environmental effects; or
- new information of substantial importance, which was not known and could not have been known with the exercise of reasonable diligence at the time the negative declaration was adopted; or
- mitigation measures previously found not to be feasible would in fact be feasible and would substantially reduce one or more significant effects of the project, but the project proponents decline to adopt the mitigation measure; or

Exhibit E

- mitigation measures which are considerably different from those analyzed in the previous negative declaration would substantially reduce one or more significant effects on the environment, but the project proponents decline to adopt the mitigation measure

Under the proposed project, the City has decided that an Addendum is appropriate to make the Negative Declaration for Northpointe Park PUD (#P96-058) adequate to address the impacts of the California Lilac Park Project (CIP# LT26). The adopted mitigation measures and impact conclusions in the Northpointe Park PUD Negative Declaration (#P96-058) remain unchanged.