

CITY OF SACRAMENTO
1231 I Street, Sacramento, CA 95814

Permit No: 0108086
Insp Area: 4

Site Address: 3747 INNOVATOR DR SAC
Parcel No: 225-1340-057 NATOMAS CROSSING 21 LOT 28
N

Sub-Type: NSFR
Housing (Y/N):

CONTRACTOR
KIMBALL HILL HOMES
10535 EAST STOCKTON BL. STE. K
ELK GROVE CA. 95624

OWNER

ARCHITECT

Nature of Work: MP 1642 1 STORY 7 ROOM SFR

CONSTRUCTION LENDING AGENCY: I hereby affirm under penalty of perjury that there is a construction lending agency for the performance of the work for which this permit is issued (Sec. 3097, Civ. C.)

Lender's Name _____ Lender's Address _____

LICENSED CONTRACTORS DECLARATION: I hereby affirm under penalty of perjury that I am licensed under provisions of Chapter 9 (commencing with section 7000) of Division 8 of the Business and Professions Code and my license is in full force and effect.

License Class B License Number 701803 Date 6/27/01 Contractor Signature N. Collins

OWNER-BUILDER DECLARATION: I hereby affirm under penalty of perjury that I am exempt from the contractors License Law for the following reason (Sec. 7031.5, Business and Professions Code, any city or county which requires a permit to construct, alter, improve, demolish, or repair any structure, prior to its issuance, also requires the applicant for such permit to file a signed statement that he or she is licensed pursuant to the provisions of the Contractors License Law (Chapter 9 commencing with Section 7000) of Division 8 of the Business and Professions Code) or that he or she is exempt therefrom and the basis for the alleged exemption: Any violation of Section 7031.5 by any applicant for a permit subjects the applicant to a civil penalty of not more than five hundred dollars (\$500.00).

____ I, as a owner of the property, or my employees with wages as their sole compensation, will do the work, and the structure is not intended or offered for sale (Sec. 7044, Business and Professions Code). The Contractors License Law does not apply to an owner of property who builds or improves thereon, and who does such work himself or he/she or through his/her own employees, provided that such improvements are not intended or offered for sale. If, however, the building or improvement is sold within one year of completion, the owner-builder will have the burden of proving that he/she did not build or improve for the purpose of sale.)

____ I, as owner of the property, am exclusively contracting with licensed contractors to construct the project (Sec. 7044, Business and Professions Code). The Contractors License Law does not apply to an owner of property who builds or improves thereon, and who contracts for such projects with a contractor(s) licensed pursuant to the Contractors License Law).

____ I am exempt under Sec. _____ B & PC for this reason: _____

Date _____ Owner Signature _____

IN ISSUING THIS BUILDING PERMIT, the applicant represents, and the city relies on the representation of the applicant, that the applicant verified all measurements and locations shown on the application or accompanying drawings and that the improvement to be constructed does not violate any law or private agreement relating to permissible or prohibited locations for such improvements. This building permit does not authorize any illegal location of any improvement or the violation of any private agreement relating to location of improvements.

I certify that I have read this application and state that all information is correct. I agree to comply with all city and county ordinances and state laws relating to building construction and hereby authorize representative(s) of this city to enter upon the abovementioned property for inspection purposes.

Date 6/27/01 Applicant/Agent Signature N. Collins

WORKER'S COMPENSATION DECLARATION: I hereby affirm under penalty of perjury one of the following declarations:

____ I have and will maintain a certificate of consent to self-insure for workers' compensation as provided for by Section 3700 of the Labor Code, for the performance of work for which the permit is issued.

I have and will maintain workers' compensation insurance, as required by Section 3700 of the Labor Code, for the performance of the work for which this permit is issued. My workers' compensation insurance carrier and policy number are:

Carrier CLAREDON NATIONAL CO. Policy Number SCF98-3482-000 Exp Date 10/01/2000

____ (This section need not be completed if the permit is for \$100 or less) I certify that in the performance of the work for which this permit is issued, I shall not employ any person in any manner so as to become subject to the workers' compensation laws of California and agree that if I should become subject to the workers' compensation provisions of Section 3700 of the Labor Code, I shall forthwith comply with those provisions.

Date 6/27/01 Applicant Signature N. Collins

WARNING: FAILURE TO SECURE WORKER'S COMPENSATION COVERAGE IS UNLAWFUL AND SHALL SUBJECT AN EMPLOYER TO CRIMINAL PENALTIES AND CIVIL FINES UP TO ONE HUNDRED THOUSAND DOLLARS (\$100,000) IN ADDITION TO THE COST OF COMPENSATION, DAMAGES AS PROVIDED FOR IN SECTION 3706 OF THE LABOR CODE, INTEREST AND ATTORNEY'S FEE.

THIS PERMIT SHALL EXPIRE BY LIMITATION IF WORK IS NOT COMMENCED WITHIN 180 DAYS.

RESIDENTIAL BUILDING PERMIT APPLICATION

Lot 28

- New Construction
- Addition
- Remodels
- Other

Project Address: 3747 Innovator Drive Assessor Parcel # 225-1340-057

OWNER INFORMATION: Natomos Crossing Phase 2/1

Legal Property Owner: Kimball Hill Homes Phone # 714-1153
 Owner Address: 10535 East Stockton Blvd City Elk Grove State Ca Zip ~~95625~~ 95624

CONTRACTOR INFORMATION:

Contractor: Kimball Hill Homes Lic. # 701-803 Phone # 714-1153 Fax# 714-1425

PROJECT INFORMATION:

Land Use Zone R-14 Occupancy Group R-3 Construction Type VN Fed Code 1A
 No. of stories: 1 No. of rooms: 7 Street width: _____
 1st Floor Area 1642 2nd Floor Area Basement Roof Material

AREA IN SQUARE FOOT OF:	EXISTING	NEW
Dwelling/Living	_____	<u>1642</u>
Garage/Storage	_____	<u>386</u>
Decks/Balconies	_____	<u>51</u>
Carports	_____	_____

SCOPE OF WORK: _____

FOR OFFICE USE ONLY

- Information above complete
- Violation files checked
- Standard setbacks
- County Sewer
- AR Flood Waiver required
- Flood Elevation Certificate Required
- Water Development Infill Area
- Planning Approval
- Design Review Approval
- Special Fee Districts Apply : _____

NEW STRUCTURES & ADDITIONS

❖ THE FOLLOWING MUST BE PROVIDED IN ORDER TO SUBMIT FOR PLAN REVIEW

- 2 COMPLETE PLANS, LEGIBLE & DRAWN TO SCALE
- 3 SETS IF PROJECT IS IN A DESIGN REVIEW AREA
- Title 24 Energy Compliance documentation
- Grading and Erosion Control Questionnaire
- ❖ Plans to include: site plan, floor plan, elevations, roof/ceiling plan, foundation and structural framing details, and structural calculations for non-conforming structures.
- 11" x 17" copy of floor plan for County Assessor
- Plan Review Fees

Date: _____ Received by: (staff) _____

ACTIVITY/PERMIT # _____



**INSULATION CONTRACTORS
ASSOCIATION
OF AMERICA**

INSULATION
CERTIFICATE
429668

1321 DUKE STREET, SUITE 303 • ALEXANDRIA, VA 22314 • (703) 739-0356

THIS CERTIFICATE OF INSULATION CONTRACTORS ASSOCIATION HAS BEEN ISSUED TO ALEXANDRIA CONTRACTORS ASSOCIATION, INC. FOR THE INSULATION CONTRACTORS ASSOCIATION OF AMERICA. THE INSULATION CONTRACTORS ASSOCIATION OF AMERICA IS A 501(C)(6) NON-PROFIT ORGANIZATION. THE INSULATION CONTRACTORS ASSOCIATION OF AMERICA IS A MEMBER OF THE NATIONAL ASSOCIATION OF PROFESSIONAL ORGANIZATIONS.

LOT # 28 TRACT # _____

K.L.H. STREET 3247 Innovator CITY _____

EXTERIOR WALLS:

MANUFACTURER _____ THICKNESS/TYPE 3 R- VALUE 13

CEILINGS:

BATTS: MANUFACTURER _____ THICKNESS/TYPE 1/2 R- VALUE 30

BLOWN IN: MANUFACTURER _____ MINIMUM THICKNESS 4 1/2 R- VALUE 30

MANUFACTURER _____ THICKNESS _____ R- VALUE _____

SQUARE FOOTAGE COVERED 1440 NUMBER OF BAGS USED 26

FLOORS: MANUFACTURER _____ THICKNESS/TYPE _____ R- VALUE _____

SLAB ON GRADE: MANUFACTURER _____ THICKNESS/TYPE _____ R- VALUE _____

MANUFACTURER _____ THICKNESS/TYPE _____ R- VALUE _____

WIDTH OF INSULATION _____ INCHES

FOUNDATION WALLS: MANUFACTURER _____ THICKNESS/TYPE _____ R- VALUE _____

MANUFACTURER _____ THICKNESS/TYPE _____ R- VALUE _____

GENERAL CONTRACTOR _____ DATE _____

CALIFORNIA CONTRACTORS LICENSE # _____ TITLE _____

INSULATION CONTRACTOR **ARCADE INSULATION** _____ TITLE _____

CALIFORNIA CONTRACTORS LICENSE #263784 1-7-02 DATE _____

[Signature] SIGNATURE 7901 Ke TITLE _____

INSTALLATION CARD

OMEGA DIAMOND WALL INSULATING ONE COAT SYSTEM
OMEGA PRODUCTS INTERNATIONAL, INC.

Job Address:

3747 INNOVATOR DR.

ICBO Evaluation Service, Inc.
Report 4004

12/13/02
Date of Job Completion

Plastering Contractor:

Name: Mid Valley Plastering, Inc.
Address: 4807 S. Airport Way, Unit # D
Stockton, CA 95206-4924

Telephone: (209) 234-2671

Approved Contractor Number as
Issued by the Coating Manufacturer Omega Diamond Wall No. 2315

This is to certify that the exterior system on the building exterior at the above address has been installed in accordance with the evaluation report specified above and the manufacturer's instructions

Jeff Shan
Signature of Plastering Contractor

12/18/02
Date

This installation card must be presented to the building inspector after completion of work and before final inspection

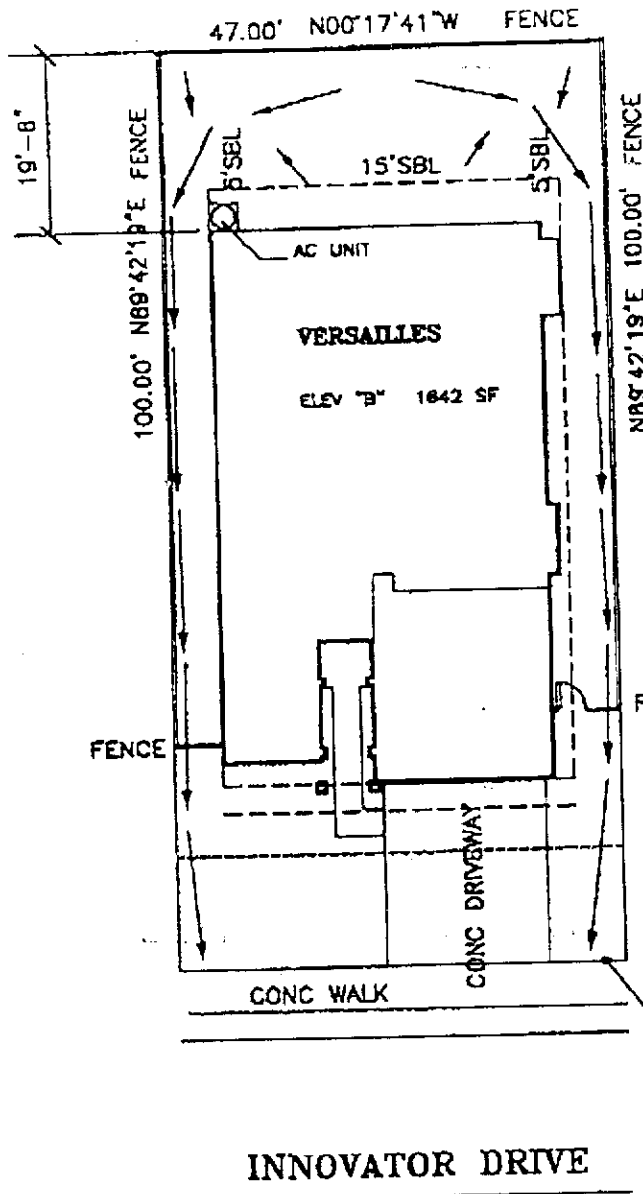

1642
386
51

FENCE
20'SBL
17'SBL
12.5'PUE
47.00'
N00°17'41\"/>

INNOVATOR DRIVE



BLOOM
Architectural
Developments
Incorporated
4437 Kenneth Avenue
Fair Oaks, CA 95628
(916)981-1553
(916)987-3011 Fax

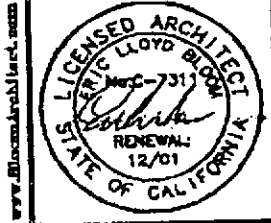

Plot Plan Disclosure This plot plan approximates a general representation of lot dimensions, easements, fence and home placement, etc. This illustration is not a condition of Kimball Hill Homes sales agreement. The actual placement and measurements demonstrated on this diagram are subject to change without notice.

Signature _____
KHH California, Inc. (916)714-1153
10536 E.Stockton Blvd. Ste.K, Elk Grove, CA 95758

Job# 164128 Plan# 1642
Date Feb 23 01 Draft 1
Plan VERSAILLES Elev B
Project Natomas Crossing
Lot 28 Unit 21
Address 3747 Innovator Dr
City Sacramento State CA
APN _____-0000

PLOT PLAN
Scale 1"=20'