

CITY OF SACRAMENTO

1231 I Street, Sacramento, CA 95814

Permit No: 0115452

Insp Area: 4

Site Address: 2845 MAYBROOK DR SAC

Thos Bros:

Parcel No: NORTHBOROUGH II VIL. 9 LOT 75  
N

Sub-Type: NSFR

Housing (Y/N):

CONTRACTOR

CENTEX HOMES  
3300 DOUGLAS BLVD  
STE. 210 95661

OWNER

ARCHITECT

Nature of Work: MP 2890 W/OPT. 2 STORY 11 ROOMS SFR

CONSTRUCTION LENDING AGENCY: I hereby affirm under penalty of perjury that there is a construction lending agency for the performance of the work for which this permit is issued (Sec. 3097, Civ. C).

Lender's Name: N/A

Lender's Address:

LICENSED CONTRACTORS DECLARATION: I hereby affirm under penalty of perjury that I am licensed under provisions of Chapter 9 (commencing with section 7000) of Division 3 of the Business and Professions Code and my license is in full force and effect.

License Class: B License Number: 734094

Date: 12/12/01

Contractor Signature:

Debbie Stowers

OWNER-BUILDER DECLARATION: I hereby affirm under penalty of perjury that I am exempt from the contractors License Law for the following reason (Sec. 7031.5, Business and Professions Code; any city or county which requires a permit to construct, alter, improve, demolish, or repair any structure, prior to its issuance, also requires the applicant for such permit to file a signed statement that he or she is licensed pursuant to the provisions of the Contractors License Law (Chapter 9 (commencing with Section 7000) of Division 8 of the Business and Professions Code) or that he or she is exempt therefrom and the basis for the alleged exemption. Any violation of Section 7031.5 by any applicant for a permit subjects the applicant to a civil penalty of not more than five hundred dollars (\$500.00);

I, as a owner of the property, or my employees with wages as their sole compensation, will do the work, and the structure is not intended or offered for sale (Sec. 7044, Business and Professional Code: The Contractors License Law does not apply to an owner of property who builds or improves thereon, and who does such work himself or herself or through his/her own employees, provided that such improvements are not intended or offered for sale. If, however, the building or improvement is sold within one year of completion, the owner-builder will have the burden of proving that he/she did not build or improve for the purpose of sale.)

I, as owner of the property, am exclusively contracting with licensed contractors to construct the project (Sec. 7044, Business and Professions Code: The Contractors License Law does not apply to an owner of property who builds or improves thereon, and who contracts for such projects with a contractor(s) licensed pursuant to the Contractors License Law).

I am exempt under Sec. B & PC for this reason:

Date:

Owner Signature:

IN ISSUING THIS BUILDING PERMIT, the applicant represents, and the city relies on the representation of the applicant, that the applicant verified all measurements and locations shown on the application or accompanying drawings and that the improvement to be constructed does not violate any law or private agreement relating to permissible or prohibited locations for such improvements. This building permit does not authorize any illegal location of any improvement or the violation of any private agreement relating to location of improvements.

I certify that I have read this application and state that all information is correct. I agree to comply with all city and county ordinances and state laws relating to building construction and hereby authorize representative(s) of this city to enter upon the abovementioned property for inspection purposes.

Date: 12/12/01

Applicant/Agent Signature:

Debbie Stowers

WORKER'S COMPENSATION DECLARATION: I hereby affirm under penalty of perjury one of the following declarations:

I have and will maintain a certificate of consent to self-insure for workers' compensation as provided for by Section 3700 of the Labor Code, for the performance of work for which the permit is issued.

X I have and will maintain workers' compensation insurance, as required by Section 3700 of the Labor Code, for the performance of the work for which this permit is issued. My workers' compensation insurance carrier and policy number are:

Carrier: ZURICH AMERICAN INS CO

Policy Number: WC8322098WI

Exp Date: 10/01/2002

(This section need not be completed if the permit is for \$100 or less) I certify that in the performance of the work for which this permit is issued, I shall not employ any person in any manner so as to become subject to the workers' compensation laws of California and agree that if I should become subject to the workers' compensation provisions of Section 3700 of the Labor Code, I shall forthwith comply with those provisions.

Date: 12/12/01

Applicant Signature:

Debbie Stowers

WARNING: FAILURE TO SECURE WORKER'S COMPENSATION COVERAGE IS UNLAWFUL AND SHALL SUBJECT AN EMPLOYER TO CRIMINAL PENALTIES AND CIVIL FINES UP TO ONE HUNDRED THOUSAND DOLLARS (\$100,000) IN ADDITION TO THE COST OF COMPENSATION, DAMAGES AS PROVIDED FOR IN SECTION 3706 OF THE LABOR CODE, INTEREST AND ATTORNEY'S FEE.

THIS PERMIT SHALL EXPIRE BY LIMITATION IF WORK IS NOT COMMENCED WITHIN 180 DAYS.

COUNTY SANITATION DISTRICT NO. 1  
 SACRAMENTO REGIONAL COUNTY SANITATION DISTRICT  
**SEWER IMPACT FEE** *SPB*  
 PERMIT AND CALCULATION SHEET *12-4-9*  
*205*

APPLICATION NO:		BLDG PERMIT NO: <i>SMW2101-00703</i>	
GENERAL INFORMATION		THIS PERMIT GOOD ONLY WHEN VALIDATED BY THE CASHIER	
THIS PERMIT TO CONNECT EXPIRES ONE YEAR FROM DATE OF ISSUANCE		BUILDING USE	
FEE CALCULATION		BUILDING USE	
INSPECTION	<i>0</i>	RESIDENTIAL	SF <input type="checkbox"/> MF <input type="checkbox"/>
CSD-1	<i>600.00</i>	COMMERCIAL USE	UNITS
SRCSD	<i>3500.00</i>		
CONSTRUCTION			
IN-LIEU			
<b>TOTAL FEE</b>	<b>4100.00</b>		
APN: <i>201-0310-026</i>			
DESCRIPTION/ SUBDIVISION <i>Northborough II, Village 9 LOT: 75</i>			
PROPERTY ADDRESS <i>2845 Maybrook Drive</i>			
OWNER <i>Center Homes</i>			
MAILING ADDRESS <i>3700 Douglas Blvd #150</i>			
CITY-STATE-ZIP <i>Roseville CA 95661</i> PHONE <i>786-8693</i>			
ADDITIONAL FEES, MAY BE DUE IF CHANGES IN USE INCREASE SEWER IMPACT.			
APPLICANT SIGNATURE <i>Debra Stowers</i>			
CONSOLIDATED UTILITY BILLING USE ONLY			
ACCT _____	INPUT _____	START _____	

**Natomas Unified School District**  
 1515 Sports Drive, #1 • Sacramento, CA 95834-1905  
 Phone 916/641-3300 • Fax 916/928-1629

**CERTIFICATION OF COMPLIANCE**  
**SCHOOL DISTRICT DEVELOPMENT FEES**

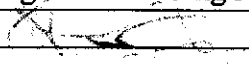
<b>PART I: TO BE COMPLETED BY APPLICANT</b>			
Property Owner's Name	Cortez Harris		
Owner's Address	3700 Douglas Blvd # 150, Roseville 95661		
Project Address	2345 Maybrook Drive	LOT 75	
Parcel Number			
Subdivision Name	Northwood II, Village 9		
Number of Units	1		
Print Applicant's Name	Debbie Stovall	Applicant's Signature	Debbie Stovall
Title of Applicant	Permit Coordinator		
Date	12-2-01	Telephone Number	736-3673
<b>PART II: TO BE COMPLETED BY BUILDING DEPARTMENT</b>			
Plan Identification Number	MC 2510		
Building Type (Check One)	<input checked="" type="checkbox"/> Residential <input type="checkbox"/> Apartment/Condominium <input type="checkbox"/> Commercial/Industrial		
Square Feet of Chargeable Building Area	3063 sq ft		
Signature			
Title	Date		
<b>PART III: TO BE COMPLETED BY NATOMAS UNIFIED SCHOOL DISTRICT</b>			
District Certification Number	02-742		
Fees Collected:			
Residential:	3063	Sq. Ft. X \$ 3.25	= \$ 10,277.40
Apartment/Condominium:		Sq. Ft. X \$	= \$
Commercial/Industrial:		Sq. Ft. X \$	= \$
<b>NOTICE TO APPLICANT:</b> Pursuant to government code section 66020 (d), this will serve to notify you that the 90-day approval period in which you may protest the fees, or other payment identified above, will begin to run on the date in which the building or installation permit for this project is issued, or on which they are paid to the District, or to another public entity authorized to collect them on behalf of the District, whichever is earlier.			
Applicant Signature:	Debbie Stovall		Date: 12-3-01

This certification covers only the amount of square footage indicated above. Any additions or corrections to the square footage for this project will require an amendment to the Certificate of Compliance.

As the authorize Natomas Unified School District official, I hereby certify that the requirements of Government Code Section 95995 have been complied with by the above signed applicant.

SIGNATURE: Michael Morman DATE: 12/5/01  
 TITLE: Facilities Planning Director

**RESIDENTIAL BUILDING PERMIT APPLICATION**

New Construction

Addition

Remodels

Other

Project Address: 2845 Maybrook Drive

Assessor Parcel # \_\_\_\_\_

**OWNER INFORMATION:**

Lot 75

Legal Property Owner: Center Homes Phone # 786-8693  
 Owner Address: 3700 Douglas Blvd #150 City Roseville State CA Zip 95661

**CONTRACTOR INFORMATION:**

Contractor: Center Homes Lic. # 734094 Phone # 786-8693 Fax# 786-6802

**PROJECT INFORMATION:**

0115452

Land Use Zone RIA Occupancy Group R3 Construction Type VN Fed Code 1A

No. of stories: 2 No. of rooms: \_\_\_\_\_ Street width: \_\_\_\_\_

1<sup>st</sup> Floor Area 1694 2<sup>nd</sup> Floor Area 1374 Basement \_\_\_\_\_ Roof Material \_\_\_\_\_

**AREA IN SQUARE FOOT OF:**

	<u>EXISTING</u>	<u>NEW</u>
Dwelling/Living	_____	<u>3068</u>
Garage/Storage	_____	<u>727</u>
Decks/Balconies	_____	_____
Carports	_____	_____

SCOPE OF WORK: MP 2890 New SFR

**FOR OFFICE USE ONLY**

- |   |   |   |
|---|---|---|
| <input type="checkbox"/> Information above complete | <input type="checkbox"/> AR Flood Waiver required             | <input type="checkbox"/> Planning Approval                  |
| <input type="checkbox"/> Violation files checked    | <input type="checkbox"/> Flood Elevation Certificate Required | <input type="checkbox"/> Design Review Approval             |
| <input type="checkbox"/> Standard setbacks          | <input type="checkbox"/> Water Development Infill Area        | <input type="checkbox"/> Special Fee Districts Apply: _____ |
| <input type="checkbox"/> County Sewer               |   |   |

**NEW STRUCTURES & ADDITIONS**

◆ THE FOLLOWING MUST BE PROVIDED IN ORDER TO SUBMIT FOR PLAN REVIEW

- |   |   |
|---|---|
| <input type="checkbox"/> 2 COMPLETE PLANS, LEGIBLE & DRAWN TO SCALE   | ◆ Plans to include: site plan, floor plan, elevations, roof/ceiling plan, foundation and structural framing details, and structural calculations for non-conforming structures. |
| <input type="checkbox"/> 3 SETS IF PROJECT IS IN A DESIGN REVIEW AREA |   |
| <input type="checkbox"/> Title 24 Energy Compliance documentation     | <input type="checkbox"/> 11" x 17" copy of floor plan for County Assessor   |
| <input type="checkbox"/> Grading and Erosion Control Questionnaire    | <input type="checkbox"/> Plan Review Fees   |

Date: \_\_\_\_\_

Received by: (staff) \_\_\_\_\_

ACTIVITY/PERMIT # \_\_\_\_\_

**CENTEX APPROVALS**

LAND DEVELOPMENT	DATE 11/9/01
CONSTR. MANAGER	DATE
SALES APPR.	DATE
FIELD MANAGER	DATE

SCALE: 1" = 20'

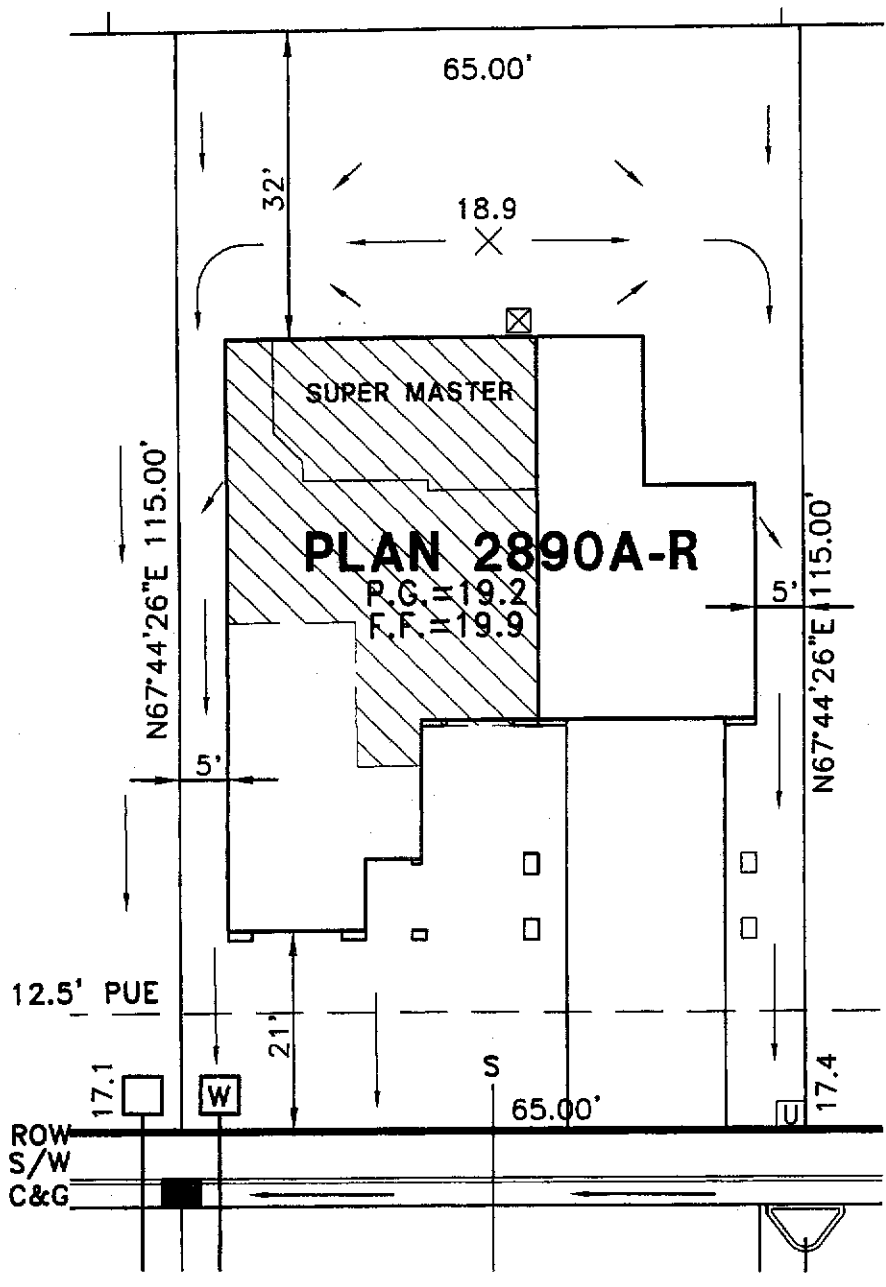

**MAYBROOK DRIVE**

THIS PLOT PLAN HAS BEEN PREPARED FOR THE PURPOSE OF SHOWING THE BUILDING FOUNDATION RELATIONSHIP TO THE PROPERTY LINE, PROPOSED DRAINAGE ELEVATIONS AND DIRECTIONS OF FLOW TO CONFORM TO LOCAL ORDINANCES AND FOR THE PURPOSE OF BUILDING PERMIT ISSUANCE, INFORMATION SHOWN IS APPROXIMATE EXCEPT FOR THOSE SETBACKS WHICH ARE MINIMUMS REQUIRED BY ORDINANCE. THIS PLOT DOES NOT REFLECT AS-BUILT CONDITIONS WHICH WILL LIKELY VARY FROM THIS PLAN. RETAINING WALLS MAY BE ADDED, DELETED, OR CHANGED AS FIELD CONDITIONS WARRANT.

LEGEND: W - WATER SERVICE      S - SEWER SERVICE      [U] - UTILITY SERVICE      [T] - TRANSFORMER

**NORTHBOROUGH II VILLAGE 9**  
**PLOT PLAN FOR LOT 75**

**CENTEX HOMES**  
 3700 Douglas Blvd, Ste 150  
 Roseville, CA 95661

A.P.N.:  
 LOT FOOTAGE: 7475 SQ. FT.  
 ADDRESS: MAYBROOK DRIVE  
 COUNTY: SACRAMENTO COUNTY

**WOOD RODGERS INC.**  
 ENGINEERING PLANNING MAPPING SURVEYING  
 3301 D STREET, BLDG. 100-B SACRAMENTO, CA 95816  
 PHONE: (916) 341-7760 FAX: (916) 341-7767

OCT 2001      1015.057 *SR*

File: J:\JOBS\NORTHBOROUGH II\DWG\CIVIL\VILLAGE 08-1\PLOT PLANS\LOT-075.DWG Last edited: 10/31/01 @ 13:35 by: hbonfantine