

CITY OF SACRAMENTO  
1231 I Street, Sacramento, CA 95814

Permit No: 0508060  
Insp Area: 2  
Thos Bros:  
Sub-Type: NSFR  
Housing (Y/N): N

Site Address: 8615 STATUE WY SAC  
Parcel No: SHELDON WHITEHOUSE LOT # 37

**CONTRACTOR**  
CENTEX HOMES  
2527 CAMINO RAMON STE. #250  
SAN RAMON, CA 94583

**OWNER**

**ARCHITECT**  
RITNER ARCHITECTURAL GROUP  
20201 SW BIRCH ST. STE. 150  
NEWPORT BEACH, CA 92660

Nature of Work: MP2806 2 STORY 11 RM SFR

**CONSTRUCTION LENDING AGENCY:** I hereby affirm under penalty of perjury that there is a construction lending agency for the performance of the work for which this permit is issued (Sec. 3097, Civ. C).

Lender's Name NIA Lender's Address \_\_\_\_\_

**LICENSED CONTRACTORS DECLARATION:** I hereby affirm under penalty of perjury that I am licensed under provisions of Chapter 9 (commencing with section 7000) of Division 3 of the Business and Professions Code and my license is in full force and effect.

License Class B License Number 825943 Date 6/16/05 Contractor Signature Debbi Stowers

**OWNER-BUILDER DECLARATION:** I hereby affirm under penalty of perjury that I am exempt from the contractors License Law for the following reason (Sec. 7031.5, Business and Professions Code; any city or county which requires a permit to construct, alter, improve, demolish, or repair any structure, prior to its issuance, also requires the applicant for such permit to file a signed statement that he or she is licensed pursuant to the provisions of the Contractors License Law (Chapter 9 (commencing with Section 7000) of Division 8 of the Business and Professions Code) or that he or she is exempt therefrom and the basis for the alleged exemption. Any violation of Section 7031.5 by any applicant for a permit subjects the applicant to a civil penalty of not more than five hundred dollars (\$500.00);

I, as a owner of the property, or my employees with wages as their sole compensation, will do the work, and the structure is not intended or offered for sale (Sec. 7044, Business and Professional Code: The Contractors License Law does not apply to an owner of property who builds or improves thereon, and who does such work himself or herself or through his/her own employees, provided that such improvements are not intended or offered for sale. If, however, the building or improvement is sold within one year of completion, the owner-builder will have the burden of proving that he/she did not build or improve for the purpose of sale.)

I, as owner of the property, am exclusively contracting with licensed contractors to construct the project (Sec. 7044, Business and Professions Code: The Contractors License Law does not apply to an owner of property who builds or improves thereon, and who contracts for such projects with a contractor(s) licensed pursuant to the Contractors License Law).

I am exempt under Sec. \_\_\_\_\_ B & PC for this reason: \_\_\_\_\_

Date \_\_\_\_\_ Owner Signature \_\_\_\_\_

PAID  
CITY OF SACRAMENTO  
JUN 16 2005

**IN ISSUING THIS BUILDING PERMIT,** the applicant represents, and the city relies on the representation of the applicant, that the applicant verified all measurements and locations shown on the application or accompanying drawings and that the improvement to be constructed does not violate any law or private agreement relating to permissible or prohibited locations for such improvements. This building permit does not authorize any illegal location of any improvement or the violation of any private agreement relating to location of improvements.

I certify that I have read this application and state that all information is correct. I agree to comply with all city and county ordinances and state laws relating to building construction and hereby authorize representative(s) of this city to enter upon the abovementioned property for inspection purposes.

Date 6/16/05 Applicant/Agent Signature Debbi Stowers

**WORKER'S COMPENSATION DECLARATION:** I hereby affirm under penalty of perjury one of the following declarations:

I have and will maintain a certificate of consent to self-insure for workers' compensation as provided for by Section 3700 of the Labor Code, for the performance of work for which the permit is issued.

I have and will maintain workers' compensation insurance, as required by Section 3700 of the Labor Code, for the performance of the work for which this permit is issued. My workers' compensation insurance carrier and policy number are:

Carrier ZURICH AMERICAN INSUR Policy Number WC8322097-08 Exp Date 10/01/2005

(This section need not be completed if the permit is for \$100 or less) I certify that in the performance of the work for which this permit is issued, I shall not employ any person in any manner so as to become subject to the workers' compensation laws of California and agree that if I should become subject to the workers' compensation provisions of Section 3700 of the Labor Code, I shall forthwith comply with those provisions.

Date 6/16/05 Applicant Signature Debbi Stowers

WARNING: FAILURE TO SECURE WORKER'S COMPENSATION COVERAGE IS UNLAWFUL AND SHALL SUBJECT AN EMPLOYER TO CRIMINAL PENALTIES AND CIVIL FINES UP TO ONE HUNDRED THOUSAND DOLLARS (\$100,000) IN ADDITION TO THE COST OF COMPENSATION, DAMAGES AS PROVIDED FOR IN SECTION 3706 OF THE LABOR CODE, INTEREST AND ATTORNEY'S FEE.

**THIS PERMIT SHALL EXPIRE BY LIMITATION IF WORK IS NOT COMMENCED WITHIN 180 DAYS.**

THIS PLOT PLAN IS NOT FOR SALES PURPOSES. THIS PLOT PLAN IS FOR THE PURPOSES OF INDICATING COMPLIANCE WITH ZONING SET BACKS, GENERAL DRAINAGE DIRECTION, AND APPROXIMATE UTILITY CONNECTION. ALL OTHER DATA SHOWN HEREON IS CONCEPTUAL. THIS PLOT PLAN DOES NOT REFLECT AS-BUILT CONDITION, RETAINING WALLS ARE OPTIONAL AND MAY OR MAY NOT BE CONSTRUCTED.

SCALE: 1" = 20'

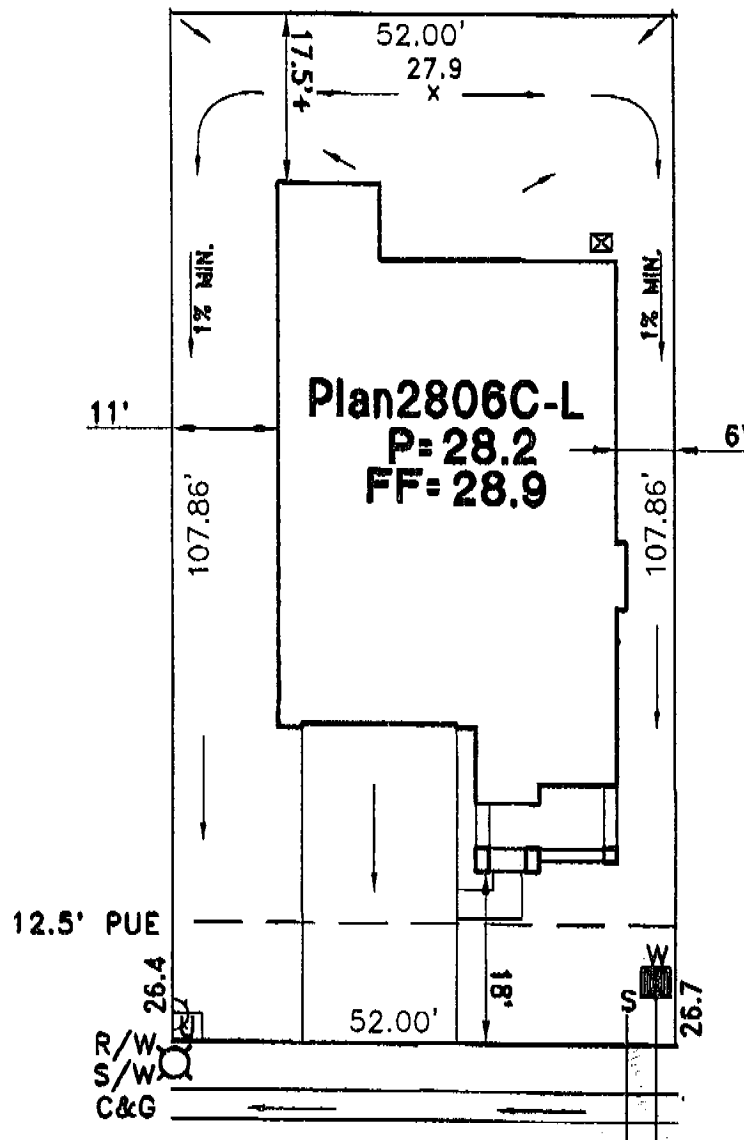

### STATUE WAY

#### LEGEND

- ☒ AC UNIT LOCATION
- ⊠ DRAIN INLET
- ⊠ SEWER SERVICE
- ⊠ WATER SERVICE
- ⊠ STREET LIGHT
- ⊠ TRANSFORMER
- ⊠ UTILITY BOX
- ⊠ STREET LIGHT SERVICE POINT
- ⊠ FIRE HYDRANT
- ⊠ STOP SIGN

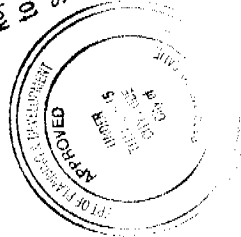

## SHELDON WHITEHOUSE - PHASE 1

CENTEX HOMES  
PLOT PLAN FOR LOT 37

APN:XXX-XXXX-XXX  
 LOT AREA: 5,609 S.F.  
 ADDRESS: XXX STATUE WAY  
 CITY OF SACRAMENTO, CALIFORNIA

**WOOD RODGERS**  
 ENGINEERING • PLANNING • MAPPING • SURVEYING  
 3301 C STREET, BLDG. 100-B, SACRAMENTO, CA 95816  
 PHONE: (916) 841-7750 FAX: (916) 841-7767

5/17/2005

DAM

1212.003

J:\Jobs\1212- Sheldon - Whitehouse\Sheldon - Whitehouse Phase 1\Civil\Plotplan\LOT 37.dwg 6/10/05 11:02am dmerio