

CITY OF SACRAMENTO
1231 I Street, Sacramento, CA 95814

Permit No: **0504784**
Insp Area: **4**
Thos Bros:
Sub-Type: NSFR
Housing (Y/N): N

Site Address: **3483 RIVER SHOAL AV SAC**
Parcel No: **RIVERBEND VIL A LOT #82**

CONTRACTOR
TIM LEWIS COMMUNITIES
5750 SUNRISE BLVD
CITRUS HIGHTS 95610

OWNER

ARCHITECT

Nature of Work: **MP2289 2 STORY 9RM SFR**

CONSTRUCTION LENDING AGENCY : I hereby affirm under penalty of perjury that there is a construction lending agency for the performance of the work for which this permit is issued (Sec. 3097, Civ. C).

Lender's Name _____ Lender's Address _____

LICENSED CONTRACTORS DECLARATION: I hereby affirm under penalty of perjury that I am licensed under provisions of Chapter 9 (commencing with section 7000) of Division 3 of the Business and Professions Code and my license is in full force and effect.

License Class B License Number 492827 Date 5.3.05 Contractor Signature [Signature]

OWNER-BUILDER DECLARATION: I hereby affirm under penalty of perjury that I am exempt from the contractors License Law for the following reason (Sec. 7031.5, Business and Professions Code; any city or county which requires a permit to construct, alter, improve, demolish, or repair any structure, prior to its issuance, also requires the applicant for such permit to file a signed statement that he or she is licensed pursuant to the provisions of the Contractors License Law (Chapter 9 (commencing with Section 7000) of Division 8 of the Business and Professions Code) or that he or she is exempt therefrom and the basis for the alleged exemption. Any violation of Section 7031.5 by any applicant for a permit subjects the applicant to a civil penalty of not more than five hundred dollars (\$500.00);

____ I, as a owner of the property, or my employees with wages as their sole compensation, will do the work, and the structure is not intended or offered for sale (Sec. 7044, Business and Professional Code: The Contractors License Law does not apply to an owner of property who builds or improves thereon, and who does such work himself or herself or through his/her own employees, provided that such improvements are not intended or offered for sale. If, however, the building or improvement is sold within one year of completion, the owner-builder will have the burden of proving that he/she did not build or improve for the purpose of sale.)

X I, as owner of the property, am exclusively contracting with licensed contractors to construct the project (Sec. 7044, Business and Professions Code: The Contractors License Law does not apply to an owner of property who builds or improves thereon, and who contracts for such projects with a contractor(s) licensed pursuant to the Contractors License Law).

I am exempt under Sec. _____ B& PC for this reason: _____
Date _____ Owner Signature _____

PAID
CITY OF SACRAMENTO
MAY 03 2005
NORTH PERMIT CENTER

IN ISSUING THIS BUILDING PERMIT, the applicant represents, and the city relies on the representation of the applicant, that the applicant verified all measurements and locations shown on the application or accompanying drawings and that the improvement to be constructed does not violate any law or private agreement relating to permissible or prohibited locations for such improvements. This building permit does not authorize any illegal location of any improvement or the violation of any private agreement relating to location of improvements.

I certify that I have read this application and state that all information is correct. I agree to comply with all city and county ordinances and state laws relating to building construction and hereby authorize representative(s) of this city to enter upon the abovementioned property for inspection purposes.

Date 5.3.05 Applicant/Agent Signature [Signature]

WORKER'S COMPENSATION DECLARATION: I hereby affirm under penalty of perjury one of the following declarations:
____ I have and will maintain a certificate of consent to self-insure for workers' compensation as provided for by Section 3700 of the Labor Code, for the performance of work for which the permit is issued.

X I have and will maintain workers' compensation insurance, as required by Section 3700 of the Labor Code, for the performance of the work for which this permit is issued. My workers' compensation insurance carrier and policy number are:

Carrier STATE FUND Policy Number 040-118-2004 Exp Date _____

____ (This section need not be completed if the permit is for \$100 or less) I certify that in the performance of the work for which this permit is issued, I shall not employ any person in any manner so as to become subject to the workers' compensation laws of California and agree that if I should become subject to the workers' compensation provisions of Section 3700 of the Labor Code, I shall forthwith comply with those provisions.

Date 5.3.05 Applicant Signature [Signature]

WARNING: FAILURE TO SECURE WORKER'S COMPENSATION COVERAGE IS UNLAWFUL AND SHALL SUBJECT AN EMPLOYER TO CRIMINAL PENALTIES AND CIVIL FINES UP TO ONE HUNDRED THOUSAND DOLLARS (\$100,000) IN ADDITION TO THE COST OF COMPENSATION, DAMAGES AS PROVIDED FOR IN SECTION 3706 OF THE LABOR CODE, INTEREST AND ATTORNEY'S FEE.

THIS PERMIT SHALL EXPIRE BY LIMITATION IF WORK IS NOT COMMENCED WITHIN 180 DAYS.

THIS PLOT PLAN IS NOT FOR SALES PURPOSES. THIS PLOT PLAN IS FOR THE PURPOSES OF INDICATING COMPLIANCE WITH ZONING SET BACKS, GENERAL DRAINAGE DIRECTION, AND APPROXIMATE UTILITY CONNECTION. ALL OTHER DATA SHOWN HEREON IS CONCEPTUAL. THIS PLOT PLAN DOES NOT REFLECT AS-BUILT CONDITION, RETAINING WALLS ARE OPTIONAL AND MAY OR MAY NOT BE CONSTRUCTED.

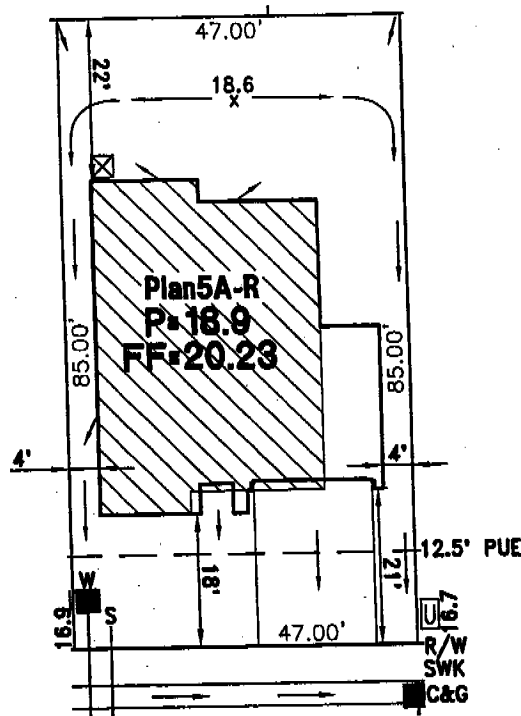
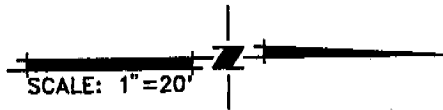

3483 RIVER SHOAL AVENUE

- UTILITY SERVICE BOX
- DRAIN INLET
- FIRE HYDRANT
- STREET LIGHT
- TRANSFORMER
- SERVICE POINT

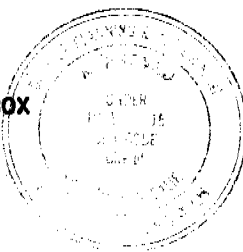

This set of plans and specifications must be kept on the job at all times and it is unlawful to make any changes or alterations from the same without written permission from the Building Inspection Division.

The approval of this plan and specification SHALL NOT be held to permit or approve the violation of any City Ordinance or State Law.

RIVERBEND VILLAGE A PHASE 8

TIM LEWIS COMMUNITIES
PLOT PLAN FOR LOT 82

A.P.N.:
LOT AREA: 3995 S.F.
ADDRESS: 3483 RIVER SHOAL AVENUE
CITY OF SACRAMENTO, CALIFORNIA

WOOD RODGERS
engineering • planning • mapping • surveying
3301 C STREET, BLDG. 100-B, SACRAMENTO, CA 95816
phone: (916) 341-7760 fax: (916) 341-7767

03-03-05	DRAWN: FJ	1178.008
----------	-----------	----------

J:\Jobs\1178-Riverbend\Riverbend\Civil\Plans\Plans\Lot 82.dwg 3/24/05 9:44am jowenlych



LOT 82

Planning and Building Department
Building Division

CITY OF SACRAMENTO
CALIFORNIA

Downtown Permits Center
1231 I Street, #200
Sacramento, CA 95814-2998
North Permits Center
2101 Arena Blvd., Suite 200
Sacramento, CA 95834

ADDRESS 3483 River Street Apt 2 PERMIT NO. 0504782

INSPECTION COMMENTS	PERMIT DOCUMENTS
5-11-05 c/u FORMS MP	P4042245 LMS
5-17-05 B10 AP Bm	
5-25-05 B11.12 AP 334	
6-23-05 667 AP Bm	
7-5-05 B17 c/u RLB	
7-6-05 667.26 AP RLB	
7-26-05 - B81.18 AP-TM	
7/28/05 B14 AP SJ	Able Steep Appeal
8/1/05 P47 AP Vic Graber	

FINAL APPROVALS	
BUILDING	
ELECTRICAL	
PLUMBING	
MECHANICAL	
FIRE	
SITE	

INSTALLATION CARD
Diamond Wall One Coat System
Omega Products International, Inc.

ICBO Evaluation Service, Inc.
Evaluation Report ER-4004

Date of Job Completion 8-4-5

Job Address
Tim Lewis
Riverbend Lot 82
3483 River Shoal Avenue

Plastering Contractor

Name: Energetic Lath & Plaster, Inc.

Address: 3030 Orange Grove Avenue North Highlands, CA 95660

Telephone No.: (916) 488-8455

Approved contractor number as
issued by coating manufacturer: _____
Applicator # 318

This is to certify that the exterior coating system on the building exterior at the above address has been installed in accordance with the
evaluation report specified above and the manufacturer's instructions.

Signature of authorized representative [Signature]
or plastering contractor _____
Date 9-14-5

This installation card must be presented to the building inspector after completion of work and before final inspection.

FIGURE 3

QUALITY INTERIORS, INC.

3483 River Shoal Avenue

Number and Street

Sacramento

City

Shores at Riverbend

TIM LEWIS COMMUNITIES

Sacramento

County

Climate Zone

Subdivision/Builder

82

Lot Number

Description of Insulation	Thickness	R-Value
Exterior Wall Insulation Type: <u>Formaldehyde Free Batts</u>	<u>3.50"</u>	<u>R-13</u>
Flat Ceiling Insulation Type: <u>Formaldehyde-Free Batts where inaccessible</u>	<u>10.25"</u>	<u>R-30</u>
Cathedral Ceiling Insulation Type: _____	_____	_____
Garage ceiling to living area above Insulation Type: <u>Formaldehyde Free Batts</u>	<u>6.50"</u>	<u>R-19</u>
Exterior 2x6 Wall Insulation Type: <u>Formaldehyde Free Batts</u>	<u>6.50"</u>	<u>R-19</u>
Foundation Wall Insulation Type: _____	_____	_____
Slab on Grade Insulation Type: _____	_____	_____
Blown Ceiling Insulation Type: <u>Formaldehyde-Free Fiberglass where accessible</u>	<u>12.75"</u>	<u>R-30</u>
Densepack Ceiling Insulation Type: _____	_____	_____
Blown Wall Insulation Type: _____	_____	_____

Declaration

I hereby certify that the above insulation was installed in the building at the above location in conformance with the current Energy Efficient Standards for Residential Buildings (Title 24, Part 6, California Code of Regulations) as indicated on the Certificate of Compliance, where applicable.

802519

License #

Signature

09 / 15 / 05
Date

QUALITY INTERIORS, INC.

Insulation Subcontractor (Co. name)

4111 82nd St. Sacramento, CA 95826 / License No. 802519/Ph (916) 454-0840/Fax (916) 454-0848
INSULATION CONTRACTING

3483 RIVER SHOAL AVE
Site Address

0504784
Permit Number

An installation certificate is required to be posted at the building site or made available for all appropriate inspections. (The information provided on this form is required; however, use of this form to provide the information is optional.) After completion of final inspection, a copy must be provided to the building department (upon request) and the building owner at occupancy, per Section 10-103(b).

HVAC SYSTEMS:

Heating Equipment

Equip. Type (pkg. heat pump)	CEC Certified Mfr Name and Model Number	# of Identical Systems	Efficiency (AFUE, etc.) ¹ [\geq CF-1R value]	Duct Location (attic, etc.)	Duct or Piping R-value	Heating Load (Btu/hr)	Heating Capacity (Btu/hr)

Cooling Equipment

Equip. Type (pkg. heat pump)	CEC Certified Compressor Unit Mfr Name and Model Number	# of Identical Systems	Efficiency (SEER, etc.) ¹ [\geq CF-1R value]	Duct Location (attic, etc.)	Duct R-value	Cooling Load (Btu/hr)	Cooling Capacity (Btu/hr)

1. \geq reads greater than or equal to.

I, the undersigned, verify that equipment listed above is: 1) is the actual equipment installed, 2) equivalent to or more efficient than that specified in the certificate of compliance (Form CF-1R) submitted for compliance with the *Energy Efficiency Standards* for residential buildings, and 3) equipment that meets or exceeds the appropriate requirements for manufactured devices (from the *Appliance Efficiency Regulations* or Part 6), where applicable.

Signature, Date

Installing Subcontractor (Co. Name)
OR General Contractor (Co. Name) OR Owner

WATER HEATING SYSTEMS:

Heater Type	CEC Certified Mfr Name & Model Number	Distribution Type (Std, Point-of-Use)	If Recirculation, Control Type	# of Identical Systems	Rated ² Input (kW or Btu/hr)	Tank Volume (gallons)	Efficiency ² (EF, RE)	Standby ² Loss (%)	External Insulation R-value ³
GAS	A.O. Smith GVR50					50	.62		

- 2. For small gas storage (rated input of less than or equal to 75,000 Btu/hr), electric resistance and heat pump water heaters, list Energy Factor. For large gas storage water heaters (rated input of greater than 75,000 Btu/hr), list Recovery Efficiency, Standby Loss and Rated Input. For instantaneous gas water heaters, list Recovery Efficiency and Rated Input.
- 3. R-12 external insulation is mandatory for storage water heaters with an energy factor of less than 0.58.

Faucets & Shower Heads:

All faucets and showerheads installed are certified to the Commission, pursuant to Title 24, Part 6, Section 111.

I, the undersigned, verify that equipment listed above my signature is: 1) the actual equipment installed; 2) equivalent to or more efficient than that specified in the certificate of compliance (Form CF-1R) submitted for compliance with the *Energy Efficiency Standards* for residential buildings; and 3) equipment that meets or exceeds the appropriate requirements for manufactured devices (from the *Appliance Efficiency Regulations* or Part 6), where applicable.

Mick A. Bjo 6/21/05
Signature, Date

RCR Companies
Installing Subcontractor (Co. Name) OR
General Contractor (Co. Name) OR Owner

COPY TO: Building Department
HERS Provider (if applicable)
Building Owner at Occupancy

INSTALLATION CERTIFICATE

(Page 2 of 13)

LOT 82
CF-6R

3483 RIVER SHOAL AVK 0504784

Site Address **TIM LEWIS SHORES @ RIVERBEND** Permit Number

FENESTRATION/GLAZING: **ALCIDE - ALPINE 7000 SERIES WINDOWS** PLAN 5A

Manufacturer/Brand Name (GROUP LIKE PRODUCTS)	Product U-Factor ¹ (s CF-1R value) ²	Product SHGC ¹ (s CF-1R value) ²	# of Panes	Total Quantity of Like Product (Optional)	Square Feet	Exterior Shading Device or Overhang	Comments/Location/Special Features
1. SLIDERS	.35	.32	2		193		LOW-E GLASS
2. SINGLE HUNG	.35	.32	2		172		
3. PICTURE WINDOWS	.34	.35	2		0		
4. PATIO DOORS	.35	.34	2		48		
5.							
6.							
7.							
8.							
9.							
10.							
11.							
12.							
13.							
14.							
15.							

¹ Manufactured fenestration products use the values from the product label. Field fabricated fenestration products use the default values from Section 116 of the Energy Efficiency Standards.
² Installed U-Factor must be less than or equal to values from CF-1R. Installed SHGC must be less than or equal to values from CF-1R, or a shading device (exterior or overhang) is installed as specified on the CF-1R. Alternatively, installed weighted average U-Factors for the total fenestration area are less than or equal to values from CF-1R.

I, the undersigned, verify that the fenestration/glazing listed above my signature: 1) is the actual fenestration product installed; 2) is equivalent to or has a lower U-Factor and lower SHGC than that specified in the certificate of compliance (Form CF-1R) submitted for compliance with the Energy Efficiency Standards for residential buildings; and 3) the product meets or exceeds the appropriate requirements for manufactured devices (from Part 6), where applicable.

2, 4, 6, 8
 Item #s (if applicable) Signature, Date [Signature] 6-30-05 Y.T. GLASS & WINDOWS INC.
 3200 DWIGHT RD STE 400
 Installing Subcontractor (Co. Name) OR General Contractor (Co. Name) OR Owner OR Window Distributor

Item #s (if applicable) Signature, Date _____ Installing Subcontractor (Co. Name) OR General Contractor (Co. Name) OR Owner OR Window Distributor

Item #s (if applicable) Signature, Date _____ Installing Subcontractor (Co. Name) OR General Contractor (Co. Name) OR Owner OR Window Distributor

COPY TO: Building Department
 HERS Provider (if applicable)
 Building Owner at Occupancy

Lot 82

Beutler Heating & Air Conditioning, Inc.

(Micropas Version 6.01)

August 18, 2004

Title 24 Energy Compliance Requirements

Tim Lewis Communities - Riverbend
Sacramento, CA - Climate Zone 12

	Plan 1	Plan 2	Plan 3	Plan 4	Plan 5	Plan 6
Number of Stories	1	1	2	2	2	2
Square Footage	1518	1690	1842	2001	2289	2447
Wall 2x4 (3 Coat Stucco)	R-13	R-13	R-13	R-13	R-13	R-13
Wall 2x6 (3 Coat Stucco)	N/A	R-19	R-19	R-19	N/A	R-19
Attic Insulation	R-30	R-30	R-30	R-30	R-30	R-30
Attic Insulation (At Furnace)	R-19	R-19	R-19	R-19	R-19	R-19
Floor Over Garage	N/A	N/A	R-19	R-19	R-19	R-19
AFUE (Furnace)	0.80	0.80	0.80	0.80	0.80	0.80
SEER (A/C Unit)	12.0	12.0	12.0	12.0	12.0	12.0
Duct Insulation	R-4.2	R-4.2	R-4.2	R-4.2	R-4.2	R-4.2
*Low Leakage (Tight) Ducts	N/A	Yes	N/A	Yes	N/A	N/A
Water Heater Energy Factor	0.62	0.62	0.62	0.60	0.60	0.60
Tank Capacity / Gallons	40	40	40	50	50	50
Glass U-Values						(Alpine Windows or Equivalent)
Horizontal Slider	0.30	0.30	0.30	0.30	0.30	0.30
Vertical Slider	0.30	0.30	0.30	0.30	0.30	0.30
Fixed	0.30	0.30	0.30	0.30	0.30	0.30
Sliding Glass Door (CEC Default Values)	0.35	0.35	0.35	0.35	0.35	0.35
French Door (CEC Default Values)	0.55	0.55	0.55	0.55	0.55	0.55
Solar Heat Gain Coefficient						French Door = 0.65
	HS&VS = 0.35	Fixed = 0.35	Sliding Glass Door = 0.32			
Glazing Percent	18.6%	22.0%	18.1%	23.2%	17.8%	17.6%
Compliance Margin	0.07	1.43	0.52	1.14	0.02	0.36

*Low Leakage (Tight) Ducts is a HERS item. All HERS items require third party testing and/or field verification by a Certified HERS rater when used for Title 24 Compliance.