

CITY OF SACRAMENTO

1231 I Street, Sacramento, CA 95814

Permit No: 0109791

Insp Area: 3

Thos Bros: 317F2

Sub-Type: HSG

Housing (Y/N): Y

Site Address: 3949 34TH ST SAC

Parcel No 020-0052-00-

CONTRACTOR

PETER NIKOLAVICH MILO NIKOV
1929 SHIRLEY AV
SACRAMENTO CA 95808

OWNER

DUCK ARMSTRONG
3949 34TH ST
SACRAMENTO CA 95820

ARCHITECT

Nature of Work: DEMO OF GARAGE, PUMP HOUSE AND BARN.

CONSTRUCTION LENDING AGENCY: I hereby affirm under penalty of perjury that there is a construction lending agency for the performance of the work for which this permit is issued (Sec. 3097, C.C.P.).

Lender's Name _____ Lender's Address _____

LICENSED CONTRACTORS DECLARATION: I hereby affirm under penalty of perjury that I am licensed under provisions of Chapter 9 commencing with section 7000 of Division 3 of the Business and Professions Code and my license is in full force and effect.

License Class B License Number 724356 Date 08/02/01 Contractor Signature L. Melnikoff

OWNER-BUILDER DECLARATION: I hereby affirm under penalty of perjury that I am exempt from the contractors License Law for the following reason (Sec. 7031.5 Business and Professions Code, any city or county which requires a permit to construct, alter, improve, demolish, or repair any structure, prior to its issuance, also requires the applicant for such permit to file a signed statement that he or she is licensed pursuant to the provisions of the Contractors License Law (Chapter 9 commencing with Section 7000) of Division 8 of the Business and Professions Code) or that he or she is exempt therefrom and the basis for the alleged exemption. Any violation of Section 7031.5 by any applicant for a permit subjects the applicant to a civil penalty of not more than five hundred dollars (\$500.00).

I, as a owner of the property, or my employees who wages as their sole compensation, will do the work, and the structure is not intended or offered for sale (Sec. 7044, Business and Professional Code). The Contractors License Law does not apply to an owner of property who builds or improves thereon, and who does such work himself or herself or through his/her own employees, provided that such improvements are not intended or offered for sale. If, however, the building or improvement is sold within one year of completion, the owner-builder will have the burden of proving that he/she did not build or improve for the purpose of sale.

I, as owner of the property, am exclusively contracting with licensed contractors to construct the project (Sec. 7044, Business and Professions Code). The Contractors License Law does not apply to an owner of property who builds or improves thereon, and who contracts for such projects with a contractor(s) licensed pursuant to the Contractors License Law.

I am exempt under Sec. _____ B & P for this reason _____

Date _____ Owner Signature _____

IN ISSUING THIS BUILDING PERMIT, the applicant represents, and the city relies on the representation of the applicant, that the applicant verified all measurements and locations shown on the application or accompanying drawings and that the improvement to be constructed does not violate any law or private agreement relating to permissible or prohibited locations for such improvements. This building permit does not authorize any illegal location of any improvement or the violation of any private agreement relating to location of improvements.

I certify that I have read this application and state that all information is correct. I agree to comply with all city and county ordinances and state laws relating to building construction and hereby authorize representative(s) of this city to enter upon the above-mentioned property for inspection purposes.

Date 08/02/01 Applicant/Agent Signature L. Melnikoff

WORKER'S COMPENSATION DECLARATION: I hereby affirm under penalty of perjury one of the following declarations:

I have and will maintain a certificate of consent to self-insure for workers' compensation as provided for by Section 3700 of the Labor Code, for the performance of work for which the permit is issued.

M I have and will maintain workers' compensation insurance, as required by Section 3700 of the Labor Code, for the performance of the work for which this permit is issued. My workers' compensation insurance carrier and policy number are:

Carrier ACCEPTANCE INDEMNITY INS CO Policy Number FW99983688 Exp Date 12/03/2001

(This section need not be completed if the permit is for \$100 or less.) I certify that in the performance of the work for which this permit is issued, I shall not employ any person in any manner so as to become subject to the workers' compensation laws of California and agree that if I should become subject to the workers' compensation provisions of Section 3700 of the Labor Code, I shall forthwith comply with those provisions.

Date 08/02/01 Applicant Signature L. Melnikoff

WARNING: FAILURE TO SECURE WORKER'S COMPENSATION COVERAGE IS UNLAWFUL AND SHALL SUBJECT AN EMPLOYER TO CRIMINAL PENALTIES AND CIVIL FINES UP TO ONE HUNDRED THOUSAND DOLLARS (\$100,000) IN ADDITION TO THE COST OF COMPENSATION, DAMAGES AS PROVIDED FOR IN SECTION 3706 OF THE LABOR CODE, INTEREST AND ATTORNEY'S FEE.

DEVELOPMENT SERVICES
DIVISION

916-264-7619
FAX 916-264-7046

APPLICATION FOR WRECKING PERMIT

LOCATION

ADDRESS: 3949 34th St. Sacramento, CA 95818

LOT: _____ TRACT: _____

LOT DEPTH: _____ LOT WIDTH: _____ CORNER LOT: _____ INTERIOR LOT _____

OWNER: P. Melnikor D. ARMSTRONG

ADDRESS: 5929 Shirley Ave, Colusa, CA 95608
715-1262

BUILDING DATA

LENGTH: 20 WIDTH 10 FIRST FLOOR AREA 400 (SQ.FT.) NO. STORIES 1

USE OF BUILDING: BARN CONSTRUCTION TYPE PLWD HEIGHT 6'

OF UNITS 1 REAR YARD SIDE YARD _____ SET BACK 69'

CITY SEWER N/A WATER N/A SEPTIC N/A WELL N/A

CONTRACTOR

NAME: P. Melnikor STATE LICENSE NO. B724336

ADDRESS: 5929 Shirley Ave, Colusa, CA 95608

PHONE: 450-6360 FAX: _____

LIABILITY INSURANCE P.L. FW999983688 P.D. 12/03/01 POLICY ON FILE _____

CODE REQUIREMENTS

NOTIFICATION OF ADJACENT PROPERTY OWNERS _____ DATE: 07/27/01

COPY OF NOTIFICATION ON FILE: _____ USE OF PROPERTY REQUIRED: _____

PEDESTRIAN PROTECTION REQUIRED: _____ REQUIREMENTS ATTACHED _____

BASEMENTS OR OTHER EXCAVATIONS ON LOT: _____ TO BE FILLED _____ FENCED _____

PREPARE PLOT PLAN SHOWING LOCATION OF BUILDING ON LOT AND TYPE AND LOCATION OF BUILDING BARRICADE.

SPECIAL CONDITIONS:

I have read the above application and know the contents thereof; the same is true and correct. I further state that I am familiar with the laws governing the demolition of buildings within the City of Sacramento and the State of California and that the above structure will be razed in conformity therewith. I further state that I understand that this permit may be revoked for any violation of the provisions of the Code of the City of Sacramento pertaining to or affected by the demolition procedure to be used on the above building.

No. W _____

DATE: _____

FEE: _____

APPLICANT: Luda Melnikor

TITLE: owner applicant

(APPLICANT/OWNER)

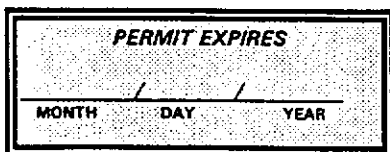

✓ THIS IS A REVOCABLE PERMIT

DEVELOPMENT SERVICES
DIVISION

916-264-7619
FAX 916-264-7046

APPLICATION FOR WRECKING PERMIT

LOCATION

ADDRESS: 3949 3Ath ST

LOT: _____ TRACT: _____

LOT DEPTH: _____ LOT WIDTH: _____ CORNER LOT: _____ INTERIOR LOT _____

OWNER: D. ADRIANO + P. MELNIKOV

ADDRESS: 5929 Shirley Av. Carmichael CA 95608
715-1262

BUILDING DATA

LENGTH: 10 WIDTH 20 FIRST FLOOR AREA 200 (SQ.FT.) NO. STORIES 1

USE OF BUILDING: BARN CONSTRUCTION TYPE PLWOOD HEIGHT 6'

OF UNITS 1 REAR YARD SIDE YARD _____ SET BACK _____

CITY SEWER N/A WATER N/A SEPTIC N/A WELL N/A

CONTRACTOR

NAME: PETER MELNIKOV STATE LICENSE NO. B 724336

ADDRESS: 5929 Shirley Ave, Carmichael CA 95608

PHONE: 484-6360 FAX: Same

LIABILITY INSURANCE P.L. FW 99983688 P.D. 12/03/01 POLICY ON FILE _____

CODE REQUIREMENTS

NOTIFICATION OF ADJACENT PROPERTY OWNERS _____ DATE: _____

COPY OF NOTIFICATION ON FILE: _____ USE OF PROPERTY REQUIRED: _____

PEDESTRIAN PROTECTION REQUIRED: _____ REQUIREMENTS ATTACHED _____

BASEMENTS OR OTHER EXCAVATIONS ON LOT: N/A TO BE FILLED _____ FENCED _____

PREPARE PLOT PLAN SHOWING LOCATION OF BUILDING ON LOT AND TYPE AND LOCATION OF BUILDING BARRICADE.

SPECIAL CONDITIONS:

I have read the above application and know the contents thereof; the same is true and correct. I further state that I am familiar with the laws governing the demolition of buildings within the City of Sacramento and the State of California and that the above structure will be razed in conformity therewith. I further state that I understand that this permit may be revoked for any violation of the provisions of the Code of the City of Sacramento pertaining to or affected by the demolition procedure to be used on the above building.

No. W _____

DATE: _____

FEE: _____

APPLICANT: P. Melnikov

TITLE: owner agent

(APPLICANT/OWNER)

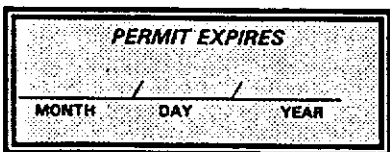

✓ THIS IS A REVOCABLE PERMIT

DEVELOPMENT SERVICES
DIVISION

916-264-7619
FAX 916-264-7046

APPLICATION FOR WRECKING PERMIT

LOCATION ADDRESS: 3949 34th ST, Sacramento, CA 95818

LOT: _____ TRACT: _____

LOT DEPTH: _____ LOT WIDTH: _____ CORNER LOT: _____ INTERIOR LOT: _____

OWNER: P. Melnikov P. ARMISTROWY

ADDRESS: 5929 Shirley Av. Carmichael CA 95608
8300 FAIR OAKS 715-1262

BUILDING DATA

LENGTH: 10 WIDTH: 15 FIRST FLOOR AREA: 150 (SQ.FT.) NO. STORIES: 1

USE OF BUILDING: garage CONSTRUCTION TYPE: plwd HEIGHT: 6'

OF UNITS: 1 REAR YARD: yes SIDE YARD: _____ SET BACK: _____

CITY SEWER: N/A WATER: N/A SEPTIC: N/A WELL: N/A

CONTRACTOR

NAME: P. Melnikov STATE LICENSE NO. B 724336

ADDRESS: 5929 Shirley Av. Carmichael CA 95608

PHONE: 484-6362 FAX: same

LIABILITY INSURANCE P.L. FW99983688 P.D. 12/05/01 POLICY ON FILE _____

CODE REQUIREMENTS

NOTIFICATION OF ADJACENT PROPERTY OWNERS _____ DATE: _____

COPY OF NOTIFICATION ON FILE: _____ USE OF PROPERTY REQUIRED: _____

PEDESTRIAN PROTECTION REQUIRED: _____ REQUIREMENTS ATTACHED _____

BASEMENTS OR OTHER EXCAVATIONS ON LOT: _____ TO BE FILLED _____ FENCED _____

PREPARE PLOT PLAN SHOWING LOCATION OF BUILDING ON LOT AND TYPE AND LOCATION OF BUILDING BARRICADE.

SPECIAL CONDITIONS:

I have read the above application and know the contents thereof; the same is true and correct. I further state that I am familiar with the laws governing the demolition of buildings within the City of Sacramento and the State of California and that the above structure will be razed in conformity therewith. I further state that I understand that this permit may be revoked for any violation of the provisions of the Code of the City of Sacramento pertaining to or affected by the demolition procedure to be used on the above building.

No. W _____

DATE: _____

FEE: _____

APPLICANT: P. Melnikov

TITLE: owner agent

(APPLICANT/OWNER)



✓ THIS IS A REVOCABLE PERMIT



DEPARTMENT OF
PLANNING AND DEVELOPMENT

CITY OF SACRAMENTO
CALIFORNIA

1231 I STREET
ROOM 200
SACRAMENTO, CA
95814-2998

WRECKING PERMIT # _____

BUILDING INSPECTIONS
916-264-5716
Permit Services
916-264-7619
FAX 916-264-7046

DEMOLITION PERMIT NOTIFICATION

A Demolition Permit for a 1 ^{Beer} story building at:

3949 34th St

(Address)

Parcel number: 020-0052-005

has been issued on _____
(date)

The structure is scheduled for demolition within 30 days.

Please update your service and billing records accordingly.

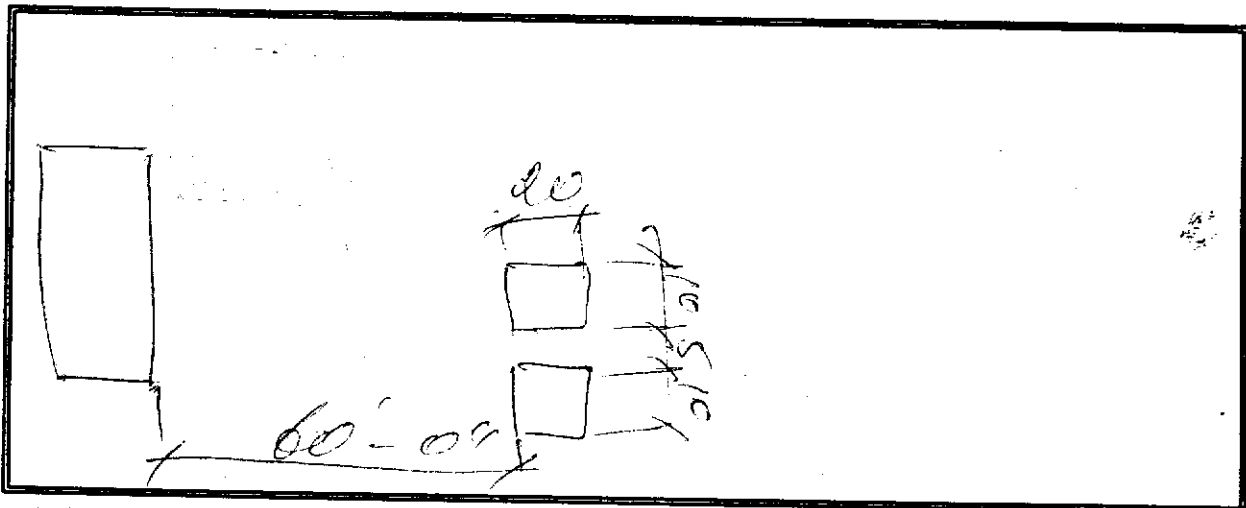

(SAMPLE SITE PLAN)

cc: P.G. & E (Terry Clark)
SMUD
SOLIDWASTE (3141)
UTILITIES (3350)
UTILBILLING (1125)
FIREDEPT. (2510)

INITIAL: _____ DATE: _____



DEPARTMENT OF
PLANNING AND DEVELOPMENT

CITY OF SACRAMENTO
CALIFORNIA

1231 I STREET
ROOM 200
SACRAMENTO, CA
95814-2998

WRECKING PERMIT # _____

BUILDING INSPECTIONS
916-264-5716
Permit Services
916-264-7619
FAX 916-264-7046

DEMOLITION PERMIT NOTIFICATION

A Demolition Permit for a 1 story building at:

3949 34 STR

(Address)

Parcel number: 020-0052-005

has been issued on _____
(date)

The structure is scheduled for demolition within 30 days.

Please update your service and billing records accordingly.

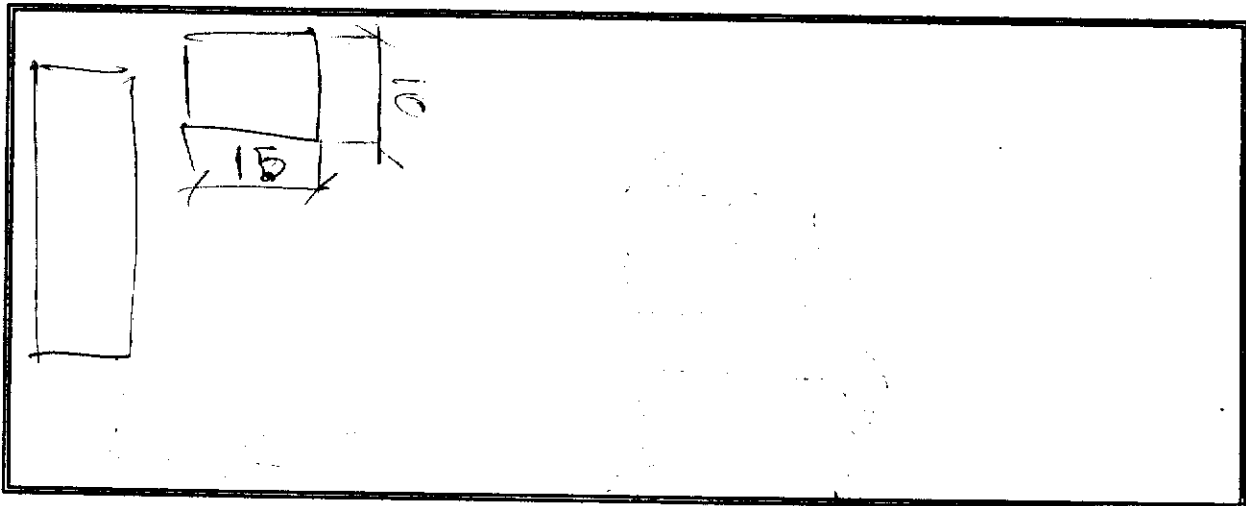

(SAMPLE SITE PLAN)

cc: P.G. & E (Terry Clark)
SMUD
SOLIDWASTE (3141)
UTILITIES (3350)
UTILBILLING (1125)
FIREDEPT. (2510)

INITIAL: _____ DATE: _____



DEPARTMENT OF
PLANNING AND DEVELOPMENT

CITY OF SACRAMENTO
CALIFORNIA

1231 I STREET
ROOM 200
SACRAMENTO, CA
95814-2998

WRECKING PERMIT # _____

BUILDING INSPECTIONS
916-264-5716
Permit Services
916-264-7619
FAX 916-264-7046

DEMOLITION PERMIT NOTIFICATION

A Demolition Permit for a 1 story building at:

3949 34th ST.

(Address)

Parcel number: 020-0052-005

has been issued on _____
(date)

The structure is scheduled for demolition within 30 days.

Please update your service and billing records accordingly.

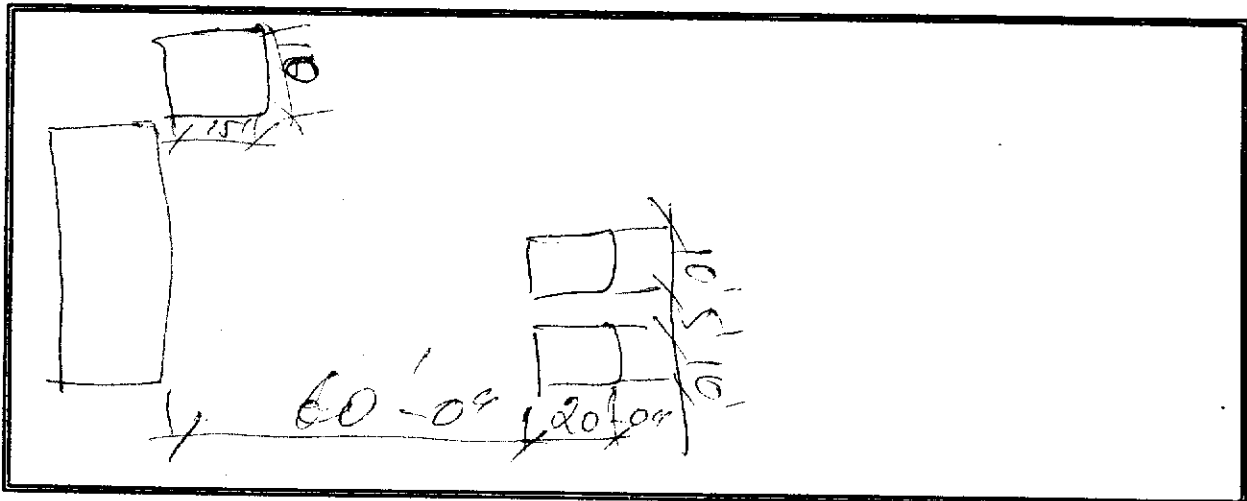

(SAMPLE SITE PLAN)

- cc: P.G. & E (Terry Clark)
- SMUD
- SOLIDWASTE (3141)
- UTILITIES (3350)
- UTIL.BILLING (1125)
- FIREDEPT. (2510)

INITIAL: _____ DATE: _____

①

2 INSPECTION PERMIT

ADDRESS: 3949 34th STR. Sacramento, CA 95818
OWNER: ~~P. Melvin~~ P. Armstrong

Approval by the following City Departments must be obtained prior to the issuance of a wrecking permit by the Building Inspection Division. Design Review approval required on all wrecking permits in Central City/Alhambra Blvd. corridor prior to sewer disconnect permit being issued.

DESIGN REVIEW <i>Presewer</i> <i>Quad fees 3 permits</i> 1231 I Street, Room 200 (916)264-5604 <i>D. Smith</i> <i>8/1/01</i>
PLUMBING DIVISION (All) 1231 I Street, Room 200 (916)264-7619 (or) Housing (916)264-5404
WATER DEPARTMENT (All) 1391 35 TH Avenue (916)264-5371
FIRE DEPARTMENT (All) 1231 I Street, Room 401 (916)264-5416 <i>Liana M. Gale</i>
TRAFFIC ENGINEER (Commercial) 1000 I Street (916)264-5307
ARBORIST/TREE SERVICE (<u>Downtown</u> and <u>Commercial</u> Buildings) 5730 24 th Street (916)433-6345

- 1.) Route to Planning and Fire
- 2.) Sewer Disconnect after we call 264-5371 Kill Tap
Bring Permit (signed off by plumbing inspector) back to the building department to add Wrecking.

* Unless City Awarded Contract.

ISSUED

- 3.) Commercial Buildings Required to have Asbestos Form and not to be issued Before Air Quality Date on Asbestos Form (bottom right corner)

AUG 02 2001

Sacramento Building Division

2

2 INSPECTION PERMIT

3949 34th St.

Apr: 020-0052-0052
Bldg: 932

ADDRESS:

3949 34th St. Sacramento, CA 95818

OWNER:

~~P. [unclear]~~ D. Armstrong
year built 1914.
IR01-122 IR01-059
OR01-122

Approval by the following City Departments must be obtained prior to the issuance of a wrecking permit by the Building Inspection Division. Design Review approval required on all wrecking permits in Central City/Alhambra Blvd. corridor prior to sewer disconnect permit being issued.

Smith Quad fee 8/1/01

DESIGN REVIEW 1231 I Street, Room 200 (916)264-5604	<i>This is not a request to demolish a house - This request is to demolish a barn on the property. Per IR01-059, Preservation Director determined buildings to have historic value.</i>
PLUMBING DIVISION (All) 1231 I Street, Room 200 (916)264-7619 (or) Housing (916)264-5404	
WATER DEPARTMENT (All) 1391 35 th Avenue (916)264-5371	
FIRE DEPARTMENT (All) 1231 I Street, Room 401 (916)264-5416	<i>Diana M. York</i>
TRAFFIC ENGINEER (Commercial) 1000 I Street (916)264-5307	
ARBORIST/TREE SERVICE (Downtown and Commercial Buildings) 5730 24 th Street (916)433-6345	

2

- 1.) Route to Planning and Fire
- 2.) Sewer Disconnect after we call 264-5371 Kill Tap
Bring Permit (signed off by plumbing inspector) back to the building department to add Wrecking.
* Unless City Awarded Contract.
- 3.) Commercial Buildings Required to have Asbestos Form and not to be issued Before Air Quality Date on Asbestos Form (bottom right corner)

ISSUED
AUG 02 2003
Sacramento Building Division

3

2 INSPECTION PERMIT

ADDRESS: 3949 34th STR.

OWNER: D. ARMSTRONG + P. ~~del~~

Approval by the following City Departments must be obtained prior to the issuance of a wrecking permit by the Building Inspection Division. Design Review approval required on all wrecking permits in Central City/Alhambra Blvd. corridor prior to sewer disconnect permit being issued.

1

DESIGN REVIEW

1231 I Street, Room 200
(916)264-5604

[Signature] 8/1/01 Qual fee

3

PLUMBING DIVISION (All)

1231 I Street, Room 200
(916)264-7619 (or) Housing (916)264-5404

WATER DEPARTMENT (All)

1391 35TH Avenue
(916)264-5371

2

FIRE DEPARTMENT (All)

1231 I Street, Room 401
(916)264-5416

[Signature: Diana M. Yates]

TRAFFIC ENGINEER (Commercial)

1000 I Street
(916)264-5307

ARBORIST/TREE SERVICE (Downtown and Commercial Buildings)

5730 24th Street
(916)433-6345

- 1.) Route to Planning and Fire
- 2.) Sewer Disconnect after we call 264-5371 Kill Tap
Bring Permit (signed off by plumbing inspector) back to the building department to add Wrecking.
* Unless City Awarded Contract.
- 3.) Commercial Buildings Required to have Asbestos Form and not to be issued Before Air Quality Date on Asbestos Form (bottom right corner)

ISSUED

AUG 6 9 2001

Temple

demo

- ①
- ②
- ③

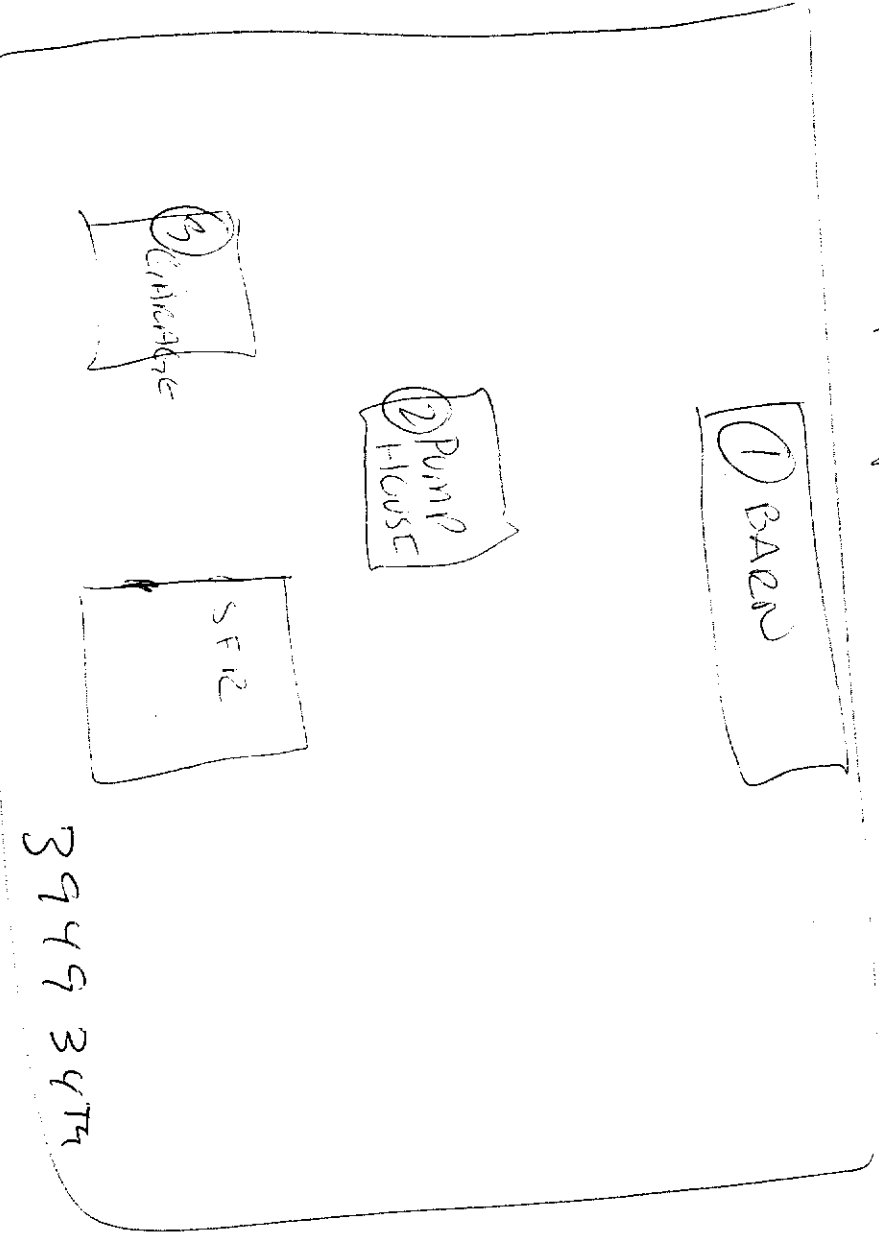

34th St

3949 34th

Guard Fees
 Demo'd
 prior to
 permit

See Don Smith
 if questions

ISSUED

AUG 02 2001

Sacramento Building Division